

PLAN

BEARING LAYOUT DETAIL
See Sheet S-7 for Bearing Details

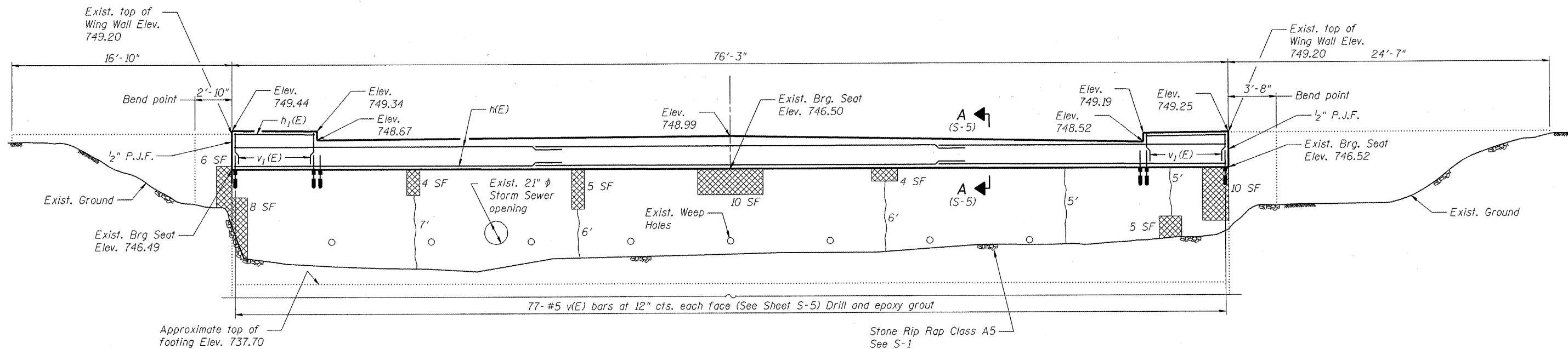
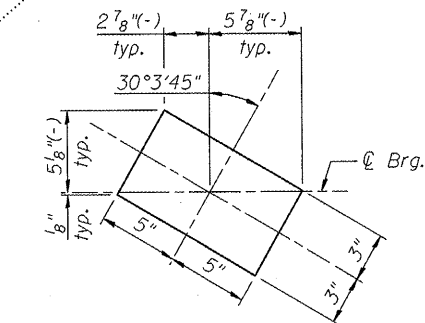

ELEVATION

Notes:
Proposed Elevations are given at the back of abutment.
See S-9 for Removal Section Thru Abutment
See Sheet S-6 for superstructure Bill of Materials. Drilling and epoxy grouting bars shall be in accordance with Section 584 of the Standard Specifications. The cost for drilling and epoxy grouting bars shall be included in Reinforcement Bars, Epoxy Coated.
Existing reinforcement shall be cleaned and incorporated into the new construction. Cost included with Removal of Existing Superstructures.

LEGEND

- x SF Indicates Structural Repair of Concrete (Depth less than or Equal to 5")
- x' Indicates Epoxy Crack Injection
- Indicates Removal Item

COMPANY NAME: HRGreen
 PROJECT CONTACT: HRGreen
 CLIENT: HRGreen
 FILE NAME: HRGreen
 PLOT DRIVER: HRGreen
 PEN TABLE: HRGreen

	USER NAME = Karft PLOT SCALE = N.T.S. PLOT DATE = 3/31/2011	DESIGNED - KMA CHECKED - RGD DRAWN - WJH CHECKED - 3/31/11	REVISED - REVISED - REVISED - REVISED -	STATE OF ILLINOIS DEPARTMENT OF TRANSPORTATION	NORTH ABUTMENT DETAILS FAIRVIEW BOULEVARD - S.N. 101-6060 SHEET NO. S-10 OF S-11 SHEETS	F.A. RTE. 5141	SECTION 10-00573-00-BR	COUNTY WINNEBAGO	TOTAL SHEETS 20	SHEET NO. 18
	ILLINOIS FED. AID PROJECT									