









**LEGEND**

-  ARROW BOARD
-  WORK AREA
-  WORKER
-  SIGN
-  DIRECTIONAL INDICATOR BARRICADE WITH STEADY BURN MONODIRECTIONAL LIGHT
-  TYPE II BARRICADE, DRUM, OR VERTICAL BARRICADE WITH STEADY BURN MONODIRECTIONAL LIGHT
-  FLAGGER WITH TRAFFIC CONTROL SIGN
-  TYPE II BARRICADE OR DRUMS
-  DRUMS WITH STEADY BURNING MONODIRECTIONAL LIGHT

MATCHLINE STA. 1354+00

MATCHLINE STA. 1369+00

FILE NAME = D6378692-SHT02-STAGE1-W038.dgn

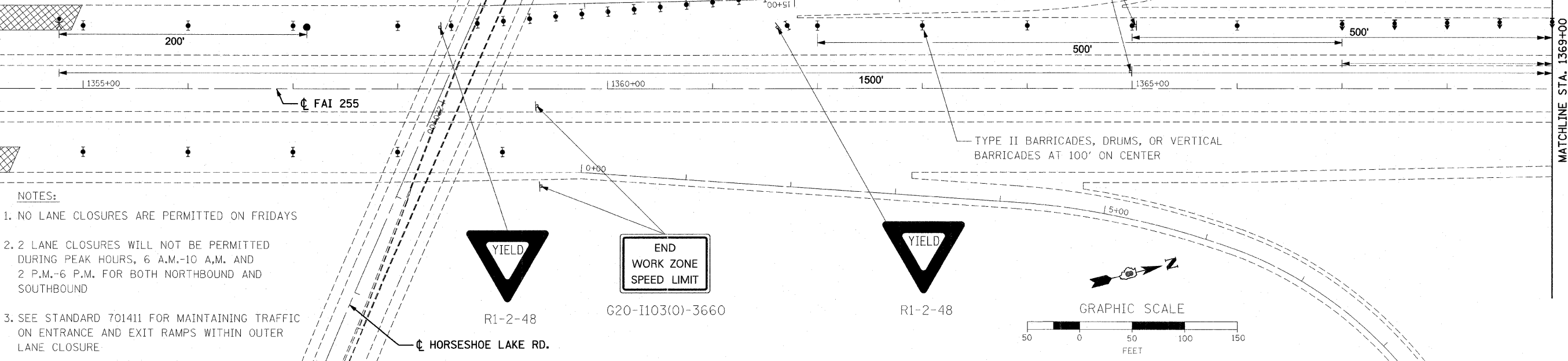

- NOTES:**
1. NO LANE CLOSURES ARE PERMITTED ON FRIDAYS
  2. 2 LANE CLOSURES WILL NOT BE PERMITTED DURING PEAK HOURS, 6 A.M.-10 A.M. AND 2 P.M.-6 P.M. FOR BOTH NORTHBOUND AND SOUTHBOUND
  3. SEE STANDARD 701411 FOR MAINTAINING TRAFFIC ON ENTRANCE AND EXIT RAMP WITHIN OUTER LANE CLOSURE

DIRECTIONAL INDICATOR BARRICADES AT 50' ON CENTER

MATCHLINE STA. 1369+00

USER NAME = j\_bailej

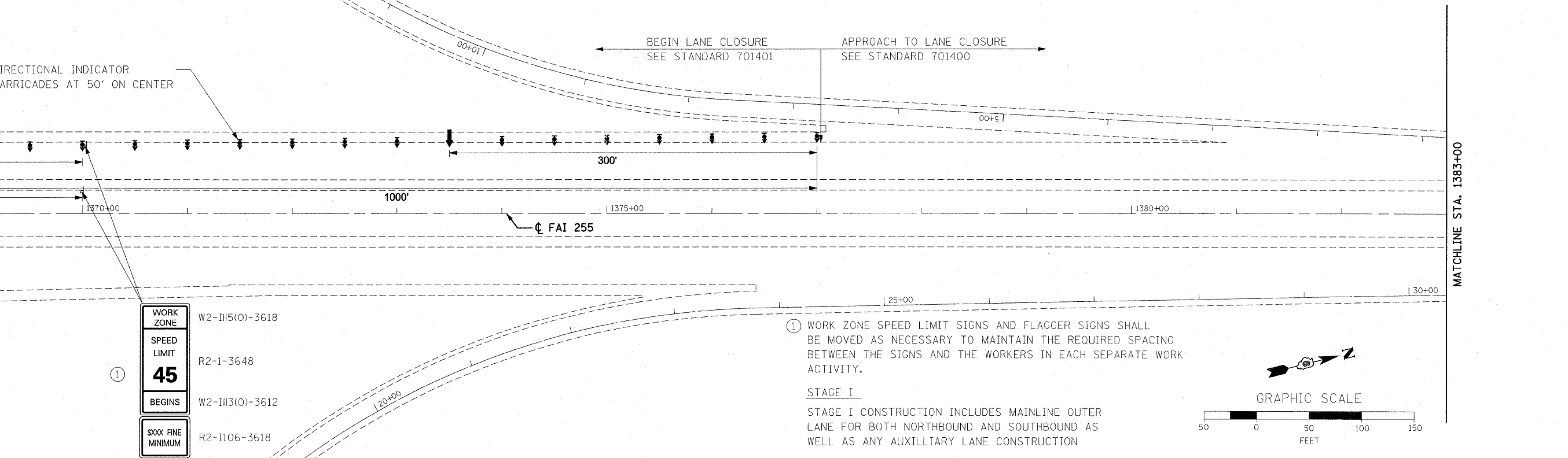

**WORK ZONE**  
**SPEED LIMIT**  
**45**  
**BEGINS**  
**MINIMUM**

① WORK ZONE SPEED LIMIT SIGNS AND FLAGGER SIGNS SHALL BE MOVED AS NECESSARY TO MAINTAIN THE REQUIRED SPACING BETWEEN THE SIGNS AND THE WORKERS IN EACH SEPARATE WORK ACTIVITY.

**STAGE I**  
 STAGE I CONSTRUCTION INCLUDES MAINLINE OUTER LANE FOR BOTH NORTHBOUND AND SOUTHBOUND AS WELL AS ANY AUXILLIARY LANE CONSTRUCTION

PLOT SCALE = 5/8"=50' / IN.  
 PLOT DATE = 3/30/2011

DESIGNED - D SOMMER  
 DRAWN - J BAILEY  
 CHECKED - T NITTLER  
 DATE - 03/23/11

**STATE OF ILLINOIS  
 DEPARTMENT OF TRANSPORTATION**

**STAGE I TRAFFIC CONTROL**

SCALE: 1"=50' SHEET NO. 2 OF 2 SHEETS STA. 1354+00 TO STA. 1384+00

F.A.I. RTE.	SECTION	COUNTY	TOTAL SHEETS	SHEET NO.
255	60-(7, 8) RS-1	MADISON	29	17
CONTRACT NO. 76E98			ILLINOIS FED. AID PROJECT	