

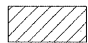

NOTES

1. LOCATIONS OF BRIDGE APPROACH SLABS AND BRIDGE ABUTMENTS ARE APPROXIMATE. THE CONTRACTOR SHALL FIELD VERIFY ALL LOCATIONS.
2. SEE SHEET 29 FOR DETAILS OF SURFACE REMOVAL AT BRIDGE APPROACHES.

LEGEND

-  HOT MIX ASPHALT SURFACE REMOVAL, 2 1/4". RESURFACE WITH POYLMERIZED HOT MIX ASPHALT SURFACE COURSE, MIX "E", N90.
-  PORTLAND CEMENT CONCRETE SURFACE REMOVAL, 2 1/4". RESURFACE WITH POYLMERIZED HOT MIX ASPHALT SURFACE COURSE, MIX "E", N90.

MATCHLINE STA. 1343+00

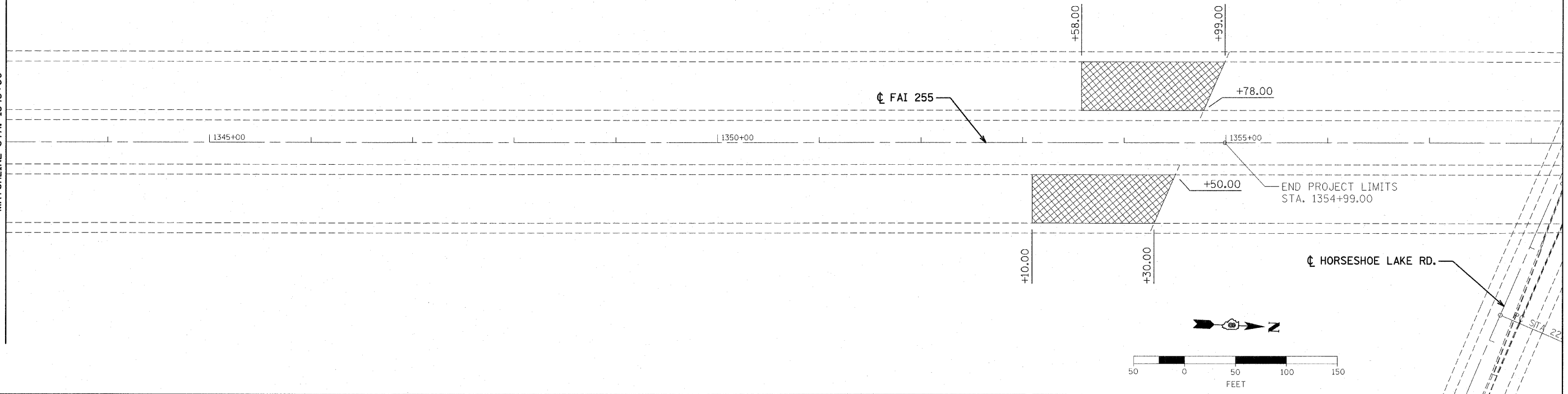

FILE NAME = DB378082-SHT05-PLAN.W830.dgn

USER NAME = jbailey
 PLOT SCALE = 50.0000' / IN.
 PLOT DATE = 3/30/2011

DESIGNED - D SOMMER
 DRAWN - J BAILEY
 CHECKED - T NITTLER
 DATE - 03/23/11

REVISED -
 REVISED -
 REVISED -
 REVISED -

**STATE OF ILLINOIS
 DEPARTMENT OF TRANSPORTATION**

**F.A.I. 255 (I-255)
 RESURFACING PLAN SHEET**

SCALE: 1"=50' SHEET NO. 5 OF 5 SHEETS STA. 1343+00 TO STA. 1354+99

F.A.I. RTE.	SECTION	COUNTY	TOTAL SHEETS	SHEET NO.
255	60-(7, 8) RS-1	MADISON	29	15
CONTRACT NO. 76E98			ILLINOIS FED. AID PROJECT	