





LEGEND

-  HOT MIX ASPHALT SURFACE REMOVAL, 2 1/4".
RESURFACE WITH POYLMERIZED HOT MIX ASPHALT SURFACE COURSE,
MIX "E", N90.
-  PORTLAND CEMENT CONCRETE SURFACE REMOVAL, 2 1/4".
RESURFACE WITH POYLMERIZED HOT MIX ASPHALT SURFACE COURSE,
MIX "E", N90.

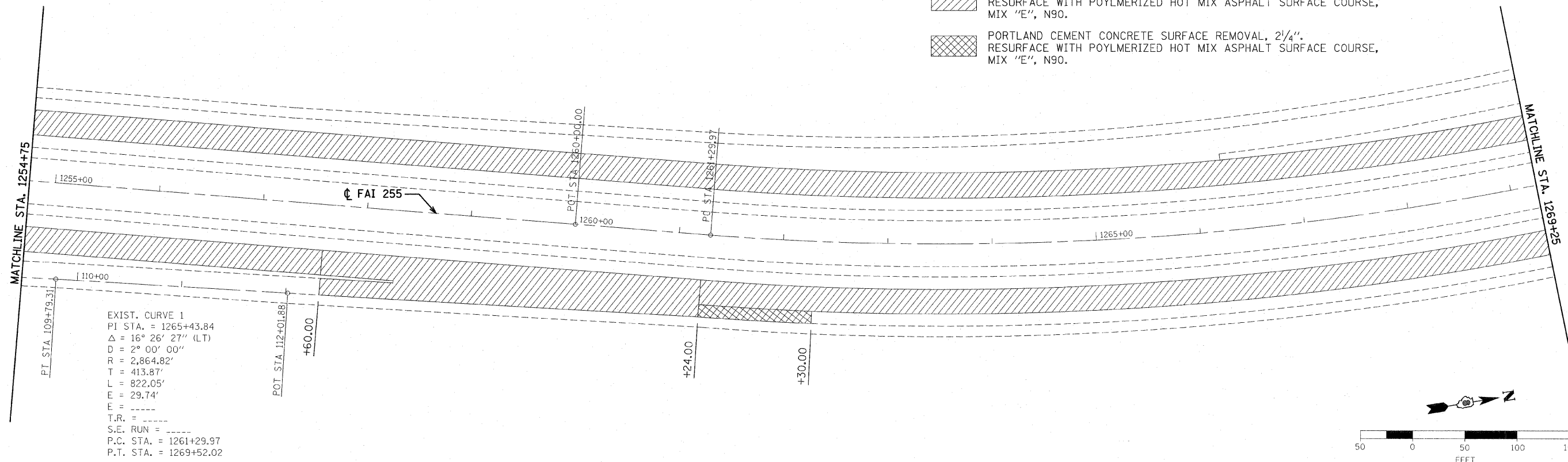
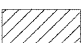

LEGEND

-  HOT MIX ASPHALT SURFACE REMOVAL, 2 1/4".
RESURFACE WITH POYLMERIZED HOT MIX ASPHALT SURFACE COURSE,
MIX "E", N90.
-  PORTLAND CEMENT CONCRETE SURFACE REMOVAL, 2 1/4".
RESURFACE WITH POYLMERIZED HOT MIX ASPHALT SURFACE COURSE,
MIX "E", N90.

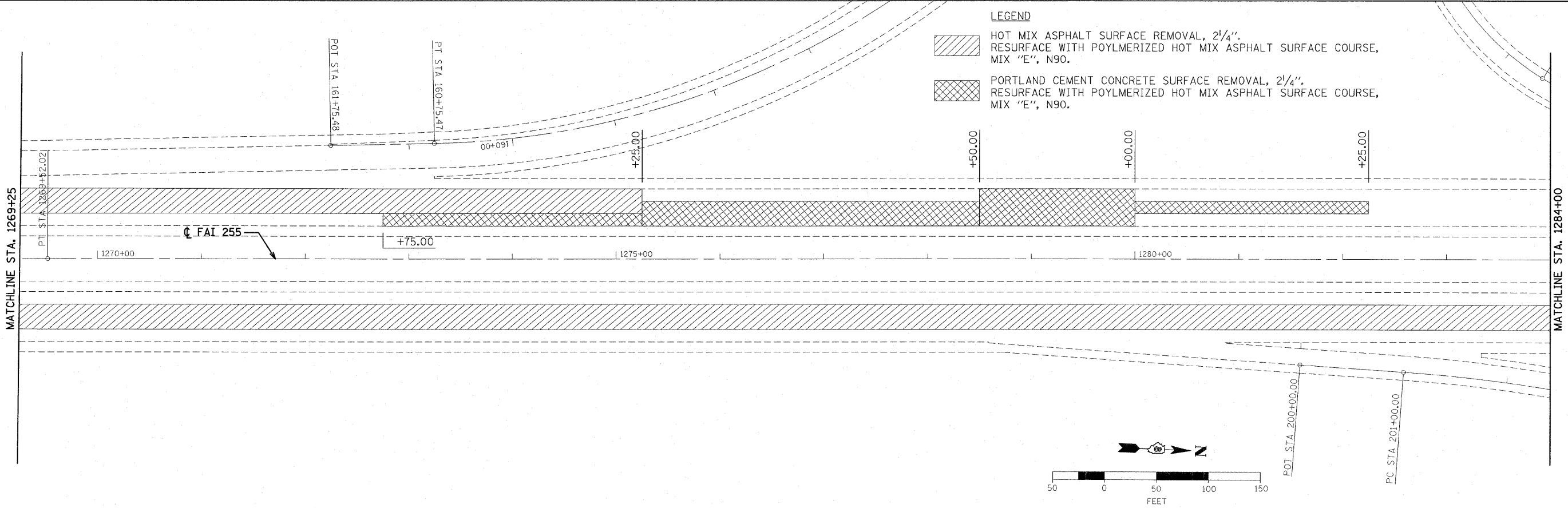

FILE NAME =
 DB379602-SHT02-PLAN.W830.dgn

USER NAME = jbailej	DESIGNED - D SOMMER	REVISED -
	DRAWN - J BAILEY	REVISED -
PLOT SCALE = 50.0000' / IN.	CHECKED - T NITTLER	REVISED -
PLOT DATE = 3/30/2011	DATE - 03/23/11	REVISED -

**STATE OF ILLINOIS
 DEPARTMENT OF TRANSPORTATION**

**F.A.I. 255 (I-255)
 RESURFACING PLAN SHEET**

SCALE: 1"=50' SHEET NO. 2 OF 5 SHEETS STA. 1254+75 TO STA. 1284+00

F.A.I. RTE.	SECTION	COUNTY	TOTAL SHEETS	SHEET NO.
255	60-(7, 8) RS-1	MADISON	29	12
CONTRACT NO. 76E98			ILLINOIS FED. AID PROJECT	