

OUTSIDE ELEVATION OF PARAPET

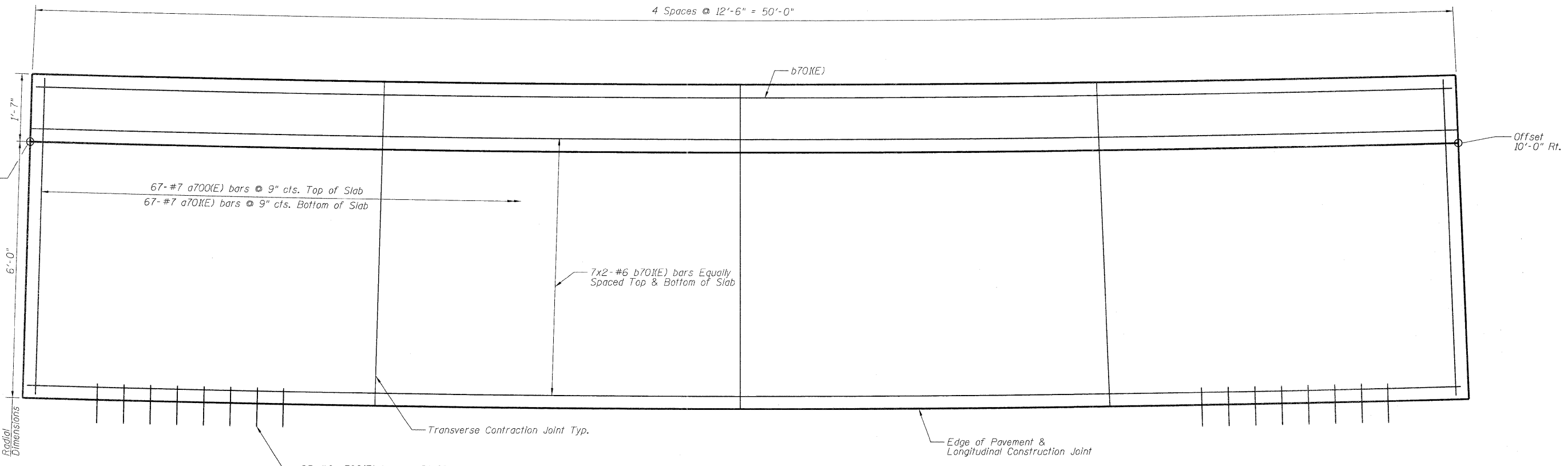

PLAN - PARAPET AND ANCHORAGE SLAB
(Offsets from 55S70W)

MIN. BAR LAPS

#4 bars	= 2'-0"
#6 bars	= 3'-0"
#8 bars	= 5'-2"

- Notes:
1. For Section A-A, see Sheet No. 3.
 2. Optional full depth construction joints with 1/2" chamfers may be provided in anchorages slab and parapet a contraction joint location.
 3. Bars indicated thus 9x2-#6 etc. indicates 9 lines with 2 lengths per line.
 4. For drainage structure location, type and size see Sheet No. 58 thru. 60.

USER NAME = bhettA	DESIGNED - DEV	REVISED -
PLOT SCALE = 28.0000' / 1"	DRAWN - JHR	REVISED -
PLOT DATE = \$DATE\$	CHECKED - DD	REVISED -
	DATE - 04-07-2011	REVISED -

STATE OF ILLINOIS
DEPARTMENT OF TRANSPORTATION

PARAPET & ANCHORAGE SLAB II

F.A.I. RTE.	SECTION	COUNTY	TOTAL SHEETS	SHEET NO.
70	82-1-B-1	ST. CLAIR	319	288
FED. ROAD DIST. NO.			ILLINOIS FED. AID PROJECT	

SHEET NO. S-2 OF S-3 SHEETS STA. 65+00.00 TO STA. 65+50.00