

**OUTSIDE ELEVATION OF PARAPET**

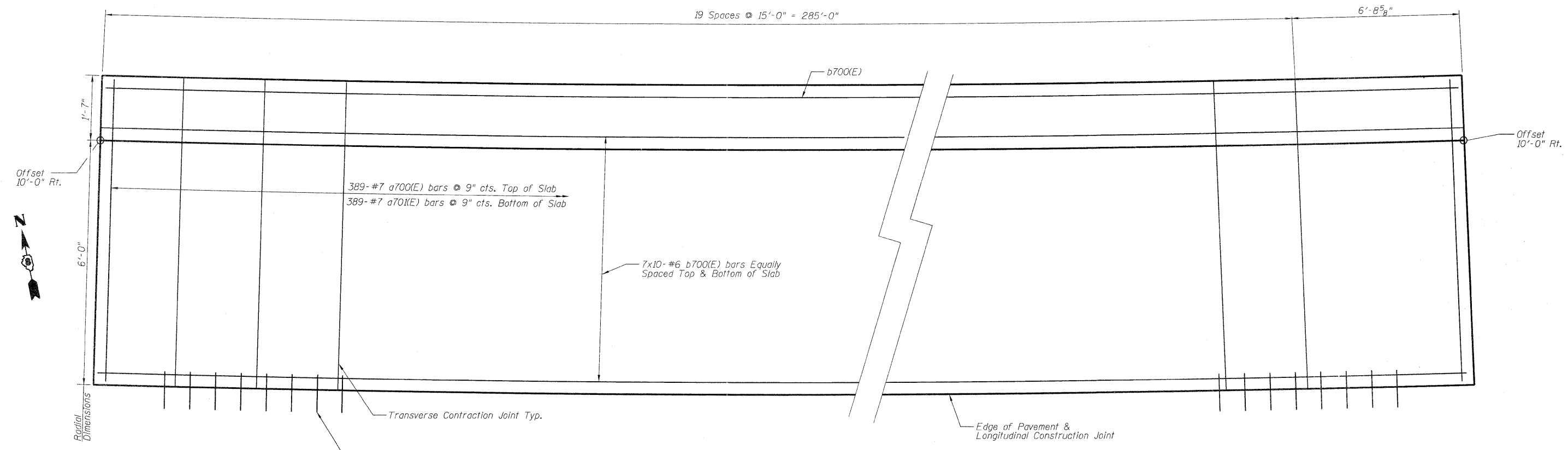

**PLAN - PARAPET AND ANCHORAGE SLAB**  
(Offsets from 55S70W)

- Notes:
1. For Section A-A, see Sheet No. 3.
  2. Optional full depth construction joints with 1/2" chamfers may be provided in anchorages slab and parapet at 120' intervals and placed at a contraction joint location.
  3. Bars indicated thus 7x10-#6 etc. indicates 7 lines with 10 lengths per line.
  4. For drainage structure location, type and size see Sheet No. 5B thru. 60.

**MIN. BAR LAPS**

#4 bars	= 2'-0"
#6 bars	= 3'-0"
#8 bars	= 5'-2"

USER NAME = BhattA	DESIGNED - DEV	REVISED -	<b>STATE OF ILLINOIS DEPARTMENT OF TRANSPORTATION</b>	<b>PARAPET &amp; ANCHORAGE SLAB I</b>	F.A.I. RTE. 70	SECTION 82-1-B-1	COUNTY ST. CLAIR	TOTAL SHEETS 319	SHEET NO. 287	
PLOT SCALE = 20.0000 "/ in.	DRAWN - JHR	REVISED -			SHEET NO. S-1 OF S-3 SHEETS	STA. 70+90.00 TO STA. 73+81.72	FED. ROAD DIST. NO.	ILLINOIS FED. AID PROJECT	CONTRACT NO. 76CT5	
PLOT DATE = sDATEs	CHECKED - DD	REVISED -								
	DATE - 04-07-2011	REVISED -								