

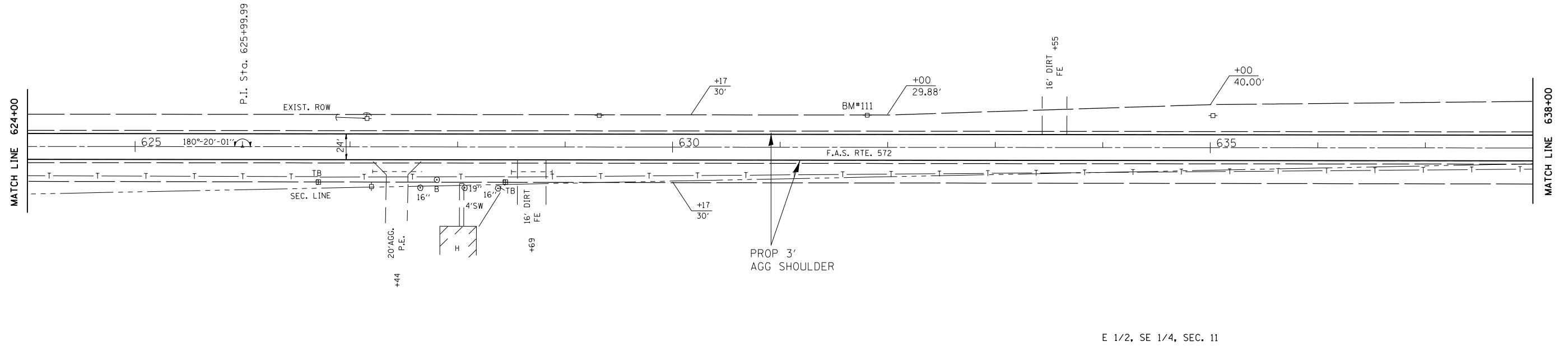

W 1/2, SW 1/4, SEC. 12  
T 21 N., R 7 W., 3rd P.M.



W 1/2, SW 1/4, SEC. 12  
T 21 N., R 7 W., 3rd P.M.

W 1/2, NW 1/4, SEC. 13  
T 21 N., R 7 W., 3rd P.M.

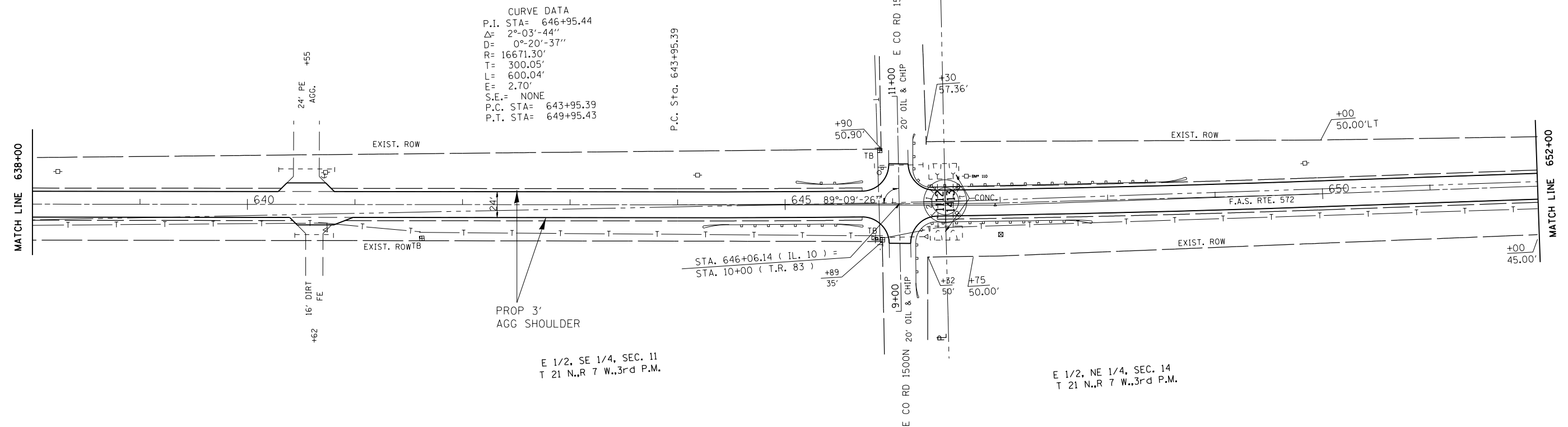

CURVE DATA  
P.I. STA= 646+95.44  
 $\Delta$ = 2°-03'-44"  
D= 0°-20'-37"  
R= 16671.30'  
T= 300.05'  
L= 600.04'  
E= 2.70'  
S.E.= NONE  
P.C. STA= 643+95.39  
P.T. STA= 649+95.43

STATE OF ILLINOIS  
DEPARTMENT OF TRANSPORTATION

PLAN SHEETS

FILE NAME =	USER NAME = Sparksgw	DESIGNED -	REVISED -
c:\pwork\work\pwork\sparksgw\0258631\0672E32-sht-plansheets.dgn		DRAWN -	REVISED -
PLOT SCALE = 100.0000' / 1"		CHECKED -	REVISED -
PLOT DATE = Mar-25-2011 04:19:37PM		DATE -	REVISED -

SCALE:	SHEET NO.	OF	SHEETS	STA.	TO STA.
--------	-----------	----	--------	------	---------

F.A. RTE.	SECTION	COUNTY	TOTAL SHEETS	SHEET NO.
572	3RS-4	MASON	38	15
CONTRACT NO. 72E32				
ILLINOIS FED. AID PROJECT				