

STATE OF ILLINOIS
DEPARTMENT OF TRANSPORTATION
DIVISION OF HIGHWAYS

**PROPOSED
HIGHWAY PLANS**

FAP ROUTE 713 (IL 61)
SECTION (102)RS-9,T

RESURFACING & STORM
SEWER REPAIR
HANCOCK COUNTY
C-96-025-11

F.A.P. RTE.	SECTION	COUNTY	TOTAL SHEETS	SHEET NO.
713	(102)RS-9,T	HANCOCK	11	1
		ILLINOIS	CONTRACT NO. 72E05	

D-96-025-11

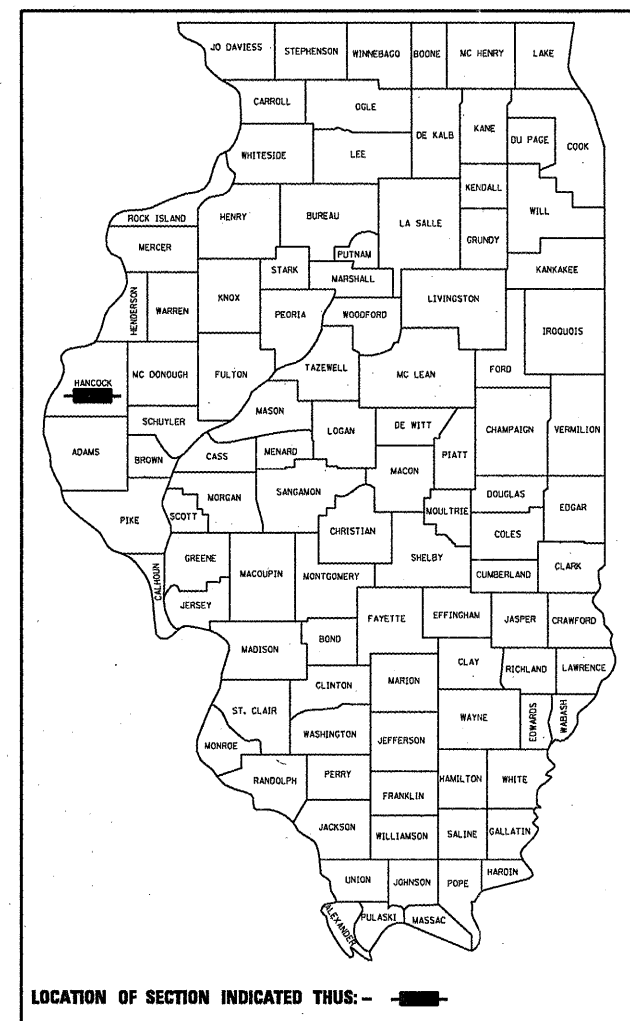

FOR INDEX OF SHEETS, SEE SHEET NO. 2

HIGHWAY CLASSIFICATION

F.A.P. ROUTE 713 (IL 61)

CLASSIFICATION: MINOR ARTERIAL

ADT: 2,200 (2009)

PV = 92.0%

ADT: 2,335 (2011) (CONST. YEAR)

SU = 6.0%

ADT: 3,269 (2029)

MU = 2.0%

DESIGN SPEED: 30 MPH

POSTED SPEED: 30 MPH

R 5 W

T 3 N

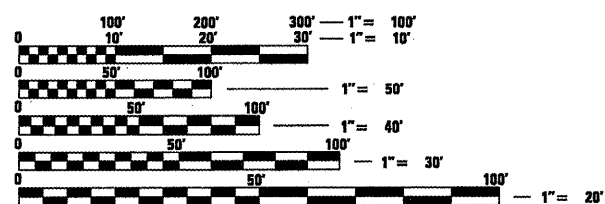

FULL SIZE PLANS HAVE BEEN PREPARED USING STANDARD ENGINEERING SCALES. REDUCED SIZED PLANS WILL NOT CONFORM TO STANDARD SCALES. IN MAKING MEASUREMENTS ON REDUCED PLANS, THE ABOVE SCALES MAY BE USED.

J.U.L.I.E.
JOINT UTILITY LOCATION INFORMATION FOR EXCAVATION
1-800-892-0123
OR 811

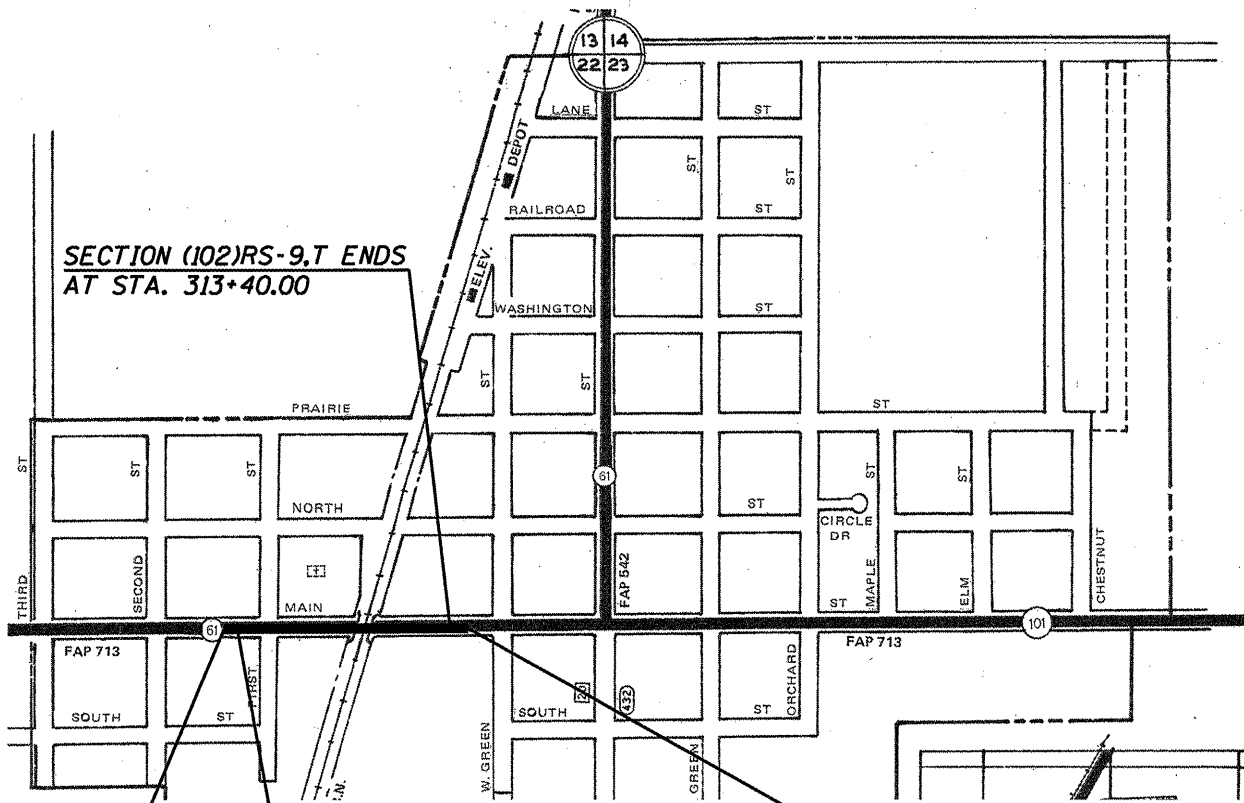

SECTION (102)RS-9,T ENDS
AT STA. 313+40.00

LIMITS OF IMPROVEMENT
AT STA. 303+80.00

AUGUSTA

LIMITS OF IMPROVEMENT
AT STA. 313+50.00

PROJECT ENGINEER: JEFF MYERS (217) 782-4761
PROJECT MANAGER: RENE CABRERA (217) 557-9062

CONTRACT NO. 72E05

SECTION (102)RS-9,T BEGINS
AT STA. 303+90.00

GROSS LENGTH = 970 FT. = 0.18 MILE
NET LENGTH = 950 FT. = 0.18 MILE

STATE OF ILLINOIS
DEPARTMENT OF TRANSPORTATION
DIVISION OF HIGHWAYS

SUBMITTED MARCH 31 20 11
Rogan L. Driskell
DEPUTY DIRECTOR OF HIGHWAYS, REGION ENGINEER

MAY 13 20 11
Scott E. Still P.E.
ENGINEER OF DESIGN AND ENVIRONMENT

MAY 13 20 11
Christine M. Reedler
DIRECTOR OF HIGHWAYS, CHIEF ENGINEER

PRINTED BY THE AUTHORITY
OF THE STATE OF ILLINOIS

INDEX OF SHEETS

GENERAL NOTES

- ① WHERE SECTION OR SUBSECTION MONUMENTS ARE ENCOUNTERED, THE ENGINEER SHALL BE NOTIFIED BEFORE SUCH MONUMENTS ARE REMOVED. THE CONTRACTOR SHALL PROTECT AND CAREFULLY PRESERVE ALL PROPERTY MARKS AND MONUMENTS UNTIL THE OWNER, AND AUTHORIZED SURVEYOR OR AGENT HAS WITNESSES OR OTHERWISE REFERENCED THEIR LOCATION.
- ② THE NOMINAL THICKNESS FOR BASE AND SURFACE COURSES ARE SHOWN ON THE TYPICAL SECTIONS, STANDARDS, SCHEDULES, OR SPECIAL DETAILS. THE CONSTRUCTED THICKNESS OF THE ABOVE ITEM SHALL NOT BE LESS THAN 90 PERCENT OF THE NOMINAL THICKNESS AT ANY LOCATION.
- ③ THE THICKNESS OF THE HMA MIXTURE SHOWN ON THE PLANS IS THE NOMINAL THICKNESS. DEVIATIONS FROM THE NOMINAL THICKNESS WILL BE PERMITTED WHEN SUCH DEVIATION OCCUR DUE TO IRREGULARITIES IN THE EXISTING SURFACE OR BASE ON WHICH THE BITUMINOUS MIXTURE IS PLACED.
- ④ ANY REFERENCE TO A STANDARD IN THE PLANS SHALL BE INTERPRETED TO MEAN THE EDITION, AS INDICATED BY THE SUB-NUMBER LISTED IN THE INDEX OF SHEETS, OR THE COPY OF THE STANDARD INCLUDED IN THE PLANS.
- ⑤ THE CONTRACTOR SHALL BE RESPONSIBLE FOR PROTECTING UTILITY PROPERTY FROM CONSTRUCTION OPERATIONS AS OUTLINED IN ARTICLE 107.31 OF THE STANDARD SPECIFICATIONS. THE JULIE NUMBER IS 800-892-0123. A MINIMUM OF FORTY-EIGHT HOURS ADVANCED NOTICE IS REQUIRED. ANY DAMAGE TO THE UNDERGROUND FACILITIES CAUSED BY THE CONTRACTOR SHALL BE REPAIRED TO THE SATISFACTION OF THE DEPARTMENT AT THE CONTRACTOR'S EXPENSE, INCLUDING TEMPORARY REPAIRS WHICH MAY BE REQUIRED TO KEEP THE FACILITY OPERATIONAL WHILE MATERIAL IS BEING OBTAINED TO MAKE PERMANENT REPAIRS.
- ⑥ THE LOCATIONS OF THOSE BURIED AND ABOVEGROUND UTILITIES SHOWN ARE APPROXIMATE, ARE SHOWN FOR CONTRACTOR INFORMATIONAL USE ONLY, AND ARE NOT TO BE REFERENCED FOR CONSTRUCTION PURPOSES. THE IMPLIED PRESENCE OR ABSENCE OF UTILITIES IS NOT TO BE CONSTRUED BY THE OWNER, ENGINEER, CONTRACTOR OR SUBCONTRACTORS TO BE AN ACCURATE AND COMPLETE REPRESENTATION OF UTILITIES THAT MAY OR MAY NOT EXIST ON THE CONSTRUCTION SITE. BURIED AND ABOVE GROUND UTILITY LOCATIONS, IDENTIFICATION, AND MARKING ARE THE SOLE RESPONSIBILITY OF THE CONTRACTOR. REROUTING, DISCONNECTION, PROTECTION, ...ETC OF ANY UTILITIES MUST BE COORDINATED BETWEEN CONTRACTOR, UTILITY COMPANY, AND OWNER. SITE SAFETY, INCLUDING THE AVOIDANCE OF HAZARDOUS ASSOCIATED WITH BURIED AND ABOVE GROUND UTILITIES REMAIN THE SOLE RESPONSIBILITY OF THE CONTRACTOR.

⑦ THE FOLLOWING MIXTURE REQUIREMENTS ARE APPLICABLE:

LOCATION(S):	IL 61
MIXTURE USE(S):	HMA CONC SURF CSE
AC/PG:	PG 64-22
DESIGN AIR VOIDS	4.0 @ N design = 50
MIXTURE COMPOSITION (Gradation Mixture)	IL 9.5 OR 12.5
FRICTION AGGREGATE	MIX "C"

- ⑧ IN ADDITION TO FIELD AND AERIAL SURVEYS, PLAN DIMENSIONS AND DETAILS RELATIVE TO THE EXISTING FACILITIES HAVE BEEN TAKEN FROM EXISTING PLANS AND ARE SUBJECT TO CONSTRUCTION VARIATIONS. IT SHALL BE THE CONTRACTOR'S RESPONSIBILITY TO VERIFY SUCH DIMENSIONS AND DETAILS IN THE FIELD. SUCH VARIATIONS SHALL NOT BE A CAUSE FOR ADDITIONAL COMPENSATION DUE TO A CHANGE IN THE SCOPE OF WORK. HOWEVER, THE CONTRACTOR WILL BE PAID FOR THE QUANTITY ACTUALLY FURNISHED AT THE UNIT PRICE BID FOR THE WORK.
- ⑨ HOT-MIX ASPHALT RESURFACING OF THE EXISTING PAVEMENT SHALL BE DONE IN SUCH A MANNER AS TO ENSURE A MINIMUM VERTICAL CLEARANCE OF 14'-0" AT THE BURLINGTON NORTHERN RAILWAY STRUCTURE. THE MINIMUM VERTICAL CLEARANCE SHALL BE MAINTAINED FROM EDGE TO EDGE OF THE ROADWAY PRIOR TO BEGINNING ANY WORK. THE CONTRACTOR, IN THE PRESENCE OF THE ENGINEER, SHALL MEASURE AND DOCUMENT THE EXISTING VERTICAL CLEARANCE AT THE STRUCTURE. MEASUREMENTS SHALL BE TAKEN AT THE EDGE OF EACH LANE, AND ANY SPLICE PLATES OVER THE PAVEMENT. FOLLOWING PLACEMENT OF THE HOT-MIX ASPHALT SURFACE COURSE, THE CONTRACTOR, IN THE PRESENCE OF THE ENGINEER SHALL MEASURE AND DOCUMENT THE VERTICAL CLEARANCE AS DESCRIBED ABOVE. IF THE MINIMUM VERTICAL CLEARANCE IS LESS THAN 14'-0", THE CONTRACTOR, AT HIS OWN EXPENSE, SHALL REMOVE AND REPLACE THE HOT-MIX ASPHALT SURFACE COURSE AS DIRECTED BY THE ENGINEER. THE COST OF WORK WILL NOT BE PAID FOR SEPARATELY BUT SHALL BE INCLUDED IN THE COST OF THE VARIOUS HOT-MIX ASPHALT ITEMS.

RATES OF APPLICATION TABLES

THE FOLLOWING RATES OF APPLICATION HAVE BEEN ASSUMED IN CALCULATING PLAN QUANTITIES.

BITUMINOUS MATERIALS (PRIME COAT): 0.00038 TON / 50 YD (ON PAVEMENT)
 0.001425 TON / 50 YD (ON AGGREGATE)
 AGGREGATE MATERIALS (PRIME COAT): 0.002 TON / 50 YD
 HMA SURFACE MIX C / BINDER (112 LBS): 0.056 TON / 50 YD • In

COMMITMENTS

(NONE)

INDEX OF SHEETS

- 1 COVER SHEET
- 2 INDEX OF SHEETS
- 3 SUMMARY OF QUANTITIES
- 4 TYPICAL SECTIONS
- 5 - 7 SCHEDULE OF QUANTITIES (3)
- 8 - 9 PLAN VIEW (2)
- 10 - 11 DRAINAGE DETAILS (2)

STANDARDS

000001-06	STANDARD SYMBOLS, ABBREVIATIONS, AND PATTERNS
602301-03	INLET - TYPE A
602401-03	MANHOLE - TYPE A
602601-02	PRECAST REINFORCED CONCRETE FLAT SLAB TOP
604011-04	FRAME AND GRATE - TYPE 3V
606001-04	CONCRETE CURB TYPE B AND COMBINATION CONCRETE CURB AND GUTTER
635011-02	REFLECTOR MARKER AND MOUNTING DETAIL
701301-04	LANE CLOSURE 2L, 2W SHORT TIME OPERATIONS <i>(MARKING PATCHES & CLEAN-UP)</i>
701311-03	LANE CLOSURE 2L, 2W MOVING OPERATIONS - DAY ONLY <i>(PAVEMENT MARKING & CLEANUP)</i>
701501-06	URBAN LANE CLOSURE 2L, 2W UNDIVIDED
701801-04	LANE CLOSURE MULTILANE 1W OR 2W CROSSWALK OR SIDEWALK CLOSURE
701901-01	TRAFFIC CONTROL DEVICES
780001-02	TYPICAL PAVEMENT MARKING
781001-03	TYPICAL APPLICATIONS OF RAISED REFLECTIVE PAVEMENT MARKINGS

THE ITALICIZED TEXT DESCRIBING STANDARDS ARE GENERAL USES FOR THE APPLICATION SPECIFIED AND NOT LIMITED TO THEM.

DISTRICT SIX

EXAMINED March 29 20 11

Chris Walker

OPERATIONS ENGINEER

EXAMINED MARCH 23 20 11

Jimmy F. L.

PROGRAM IMPLEMENTATION ENGINEER

EXAMINED MARCH 11 20 11

John C. Weyant

PROGRAM DEVELOPMENT ENGINEER

FILE NAME =	USER NAME = cabrera	DESIGNED - RSC	REVISED -	STATE OF ILLINOIS DEPARTMENT OF TRANSPORTATION	INDEX OF SHEETS	F.A.P. RTE.	SECTION	COUNTY	TOTAL SHEETS	SHEET NO.	
at\pwwork\pwwork\cabrera\d0239921\06	2E05-shr-gennote.dgn	DRAWN - JWC	REVISED -			713	(102)RS-9,T	HANCOCK	11	2	
	PLOT SCALE = 48.0000' / IN.	CHECKED - RSC	REVISED -			CONTRACT NO. 72E05					
	PLOT DATE = Mar-28-2011 01:13:25PM	DATE	REVISED -			ILLINOIS FED. AID PROJECT					
				SCALE: 50	SHEET NO. 1 OF 1 SHEETS	STA.	TO STA.				

LEGEND

- ① EXIST. P.C.C. PAVEMENT (9"-6"-9")
- ② EXIST. BITUMINOUS OVERLAY
- ③ EXIST. BITUMINOUS BASE COURSE WIDENING, 9"
- ④ EXIST. BITUMINOUS SHOULDERS
- ⑤ EXIST. CONCRETE CURB AND GUTTER, TYPE B-6.30
- ⑥ EXIST. CONCRETE SIDEWALK, 4"
- ⑦ EXIST. CONCRETE GUTTER, TYPE A
- ⑧ PROP. HOT-MIX ASPHALT SURFACE REMOVAL, 2"
- ⑨ PROP. HOT-MIX ASPHALT SURFACE COURSE, MIX C, N50 2"
- ⑩ PROP. PAINT PAVEMENT MARKING - LINE 5"

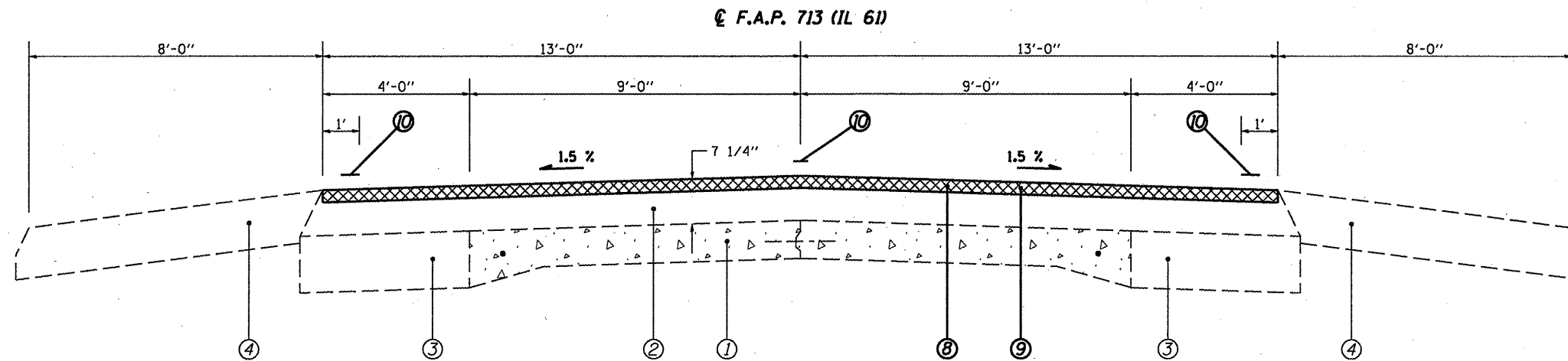

(1) STA 303+90.00 TO STA 305+27.00 [137']

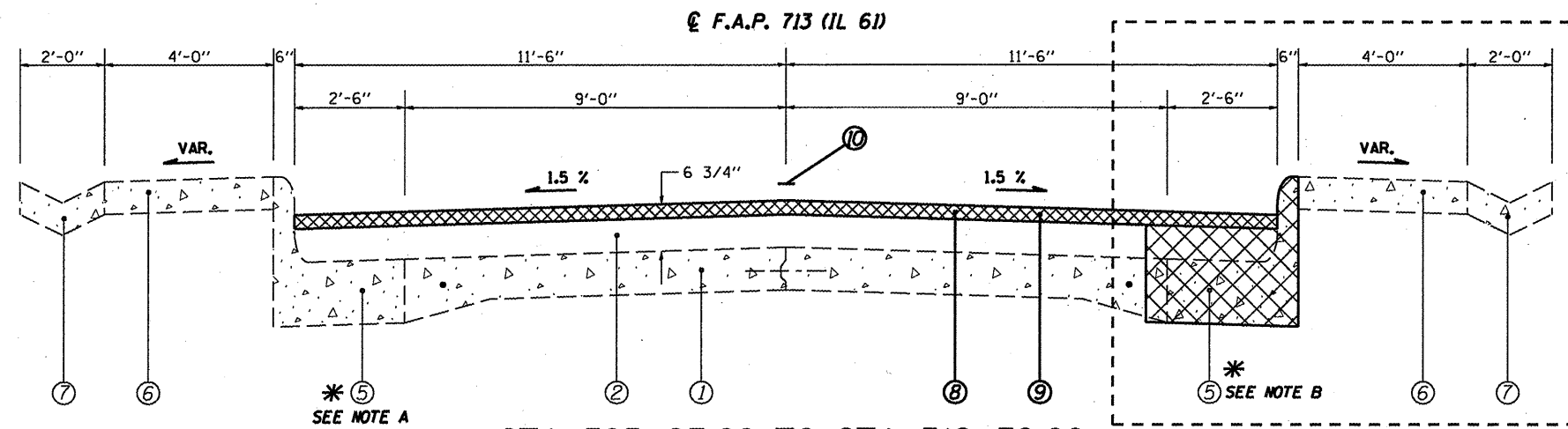

(2) STA 305+27.00 TO STA 312+76.00 [749']

*** NOTE A:**
EXIST. CONC. CURB & GUTTER BEGINS @ STA 305+19.00 LT

* SEE NOTE A

SEE SHEETS 10 & 11 FOR DRAINAGE DETAILS

*** NOTE B:**
PROP. COMB CURB & GUTTER REM SP AND COMB CONC CURB AND GUTTER TYPE B SP BEGINS @ STA 308+87.00 AND ENDS @ STA 309+67.50 RT

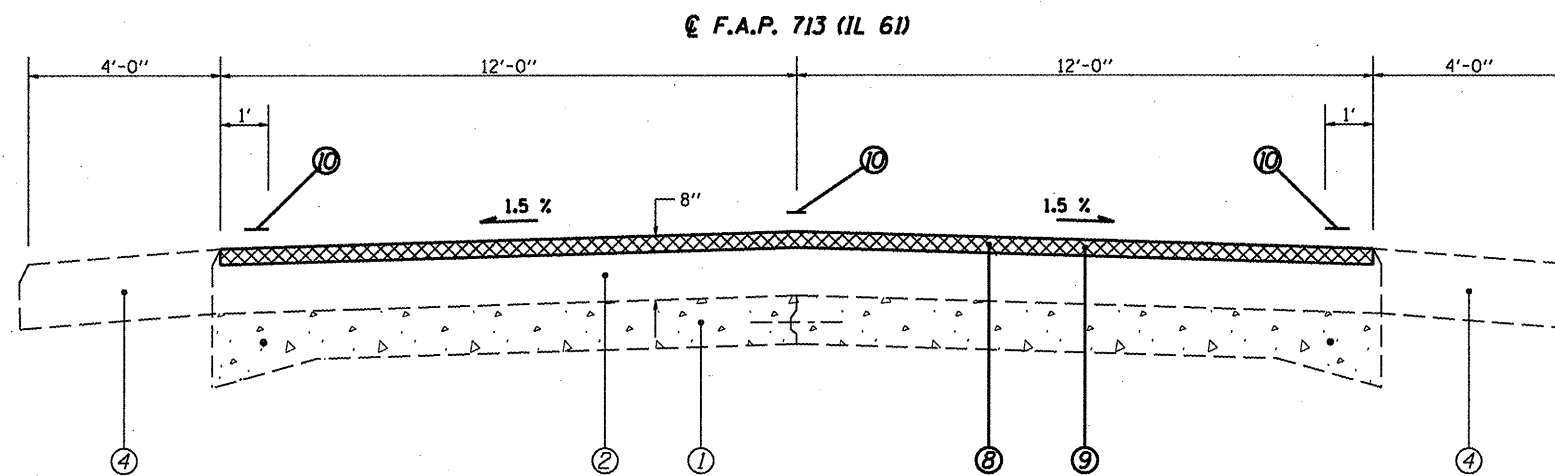

(3) STA 312+76.00 TO STA 313+40.00 [64']

FILE NAME =	USER NAME = ccbreerars	DESIGNED - JWC	REVISED -	STATE OF ILLINOIS DEPARTMENT OF TRANSPORTATION	TYPICAL SECTIONS			F.A.P. RTE. 713	SECTION (102)RS-9.T	COUNTY HANCOCK	TOTAL SHEETS 11	SHEET NO. 4
cd:\pwwork\pwwork\cbreerars\d0239921\06	ZE05-shr-typical.dgn	DRAWN - JWC	REVISED -		SCALE: NTS	SHEET NO. 1 OF 1 SHEETS	STA. 303+90.00 TO STA. 313+40.00	ILLINOIS FED. AID PROJECT				
		CHECKED - RSC	REVISED -									
		DATE -	REVISED -									

HOT-MIX ASPHALT SURFACE REMOVAL

TYP. SEC. #	LOCATION	QUANTITY	
		BUTT JOINT	2"
		(SQ YD)	(SQ YD)
F. A. P. 713 (IL 61)			
(1)	STA. 303+80.00 TO STA. 303+90.00	28.89	
(1)	STA. 303+90.00 TO STA. 305+19.00		372.67
(1)	STA. 305+19.00 TO STA. 305+27.00		21.78
(2)	STA. 305+27.00 TO STA. 308+89.00		925.11
(2)	STA. 308+89.00 TO STA. 309+65.00		177.33
(2)	STA. 309+65.00 TO STA. 312+76.00		794.78
(3)	STA. 312+76.00 TO STA. 313+40.00		170.67
(3)	STA. 313+40.00 TO STA. 313+50.00	26.67	
PROJECT TOTAL		56	2,463

COMBINATION CURB AND GUTTER REMOVAL (SPECIAL)

TYP. SEC. #	LOCATION	QUANTITY (FOOT)
F. A. P. 713 (IL 61)		
(2)	STA. 308+87.00 TO STA. 309+67.50 RT	80.5
PROJECT TOTAL		81

STORM SEWER REMOVAL 6"

TYP. SEC. #	LOCATION	QUANTITY (FOOT)
F. A. P. 713 (IL 61)		
(2)	STA. 308+90.00 TO STA. 309+64.00 RT	74
PROJECT TOTAL		74

REMOVING INLETS

TYP. SEC. #	LOCATION	QUANTITY (EACH)
F. A. P. 713 (IL 61)		
(2)	308+89.00, 10.5' RT	1
(2)	309+65.00, 10.16' RT	1
PROJECT TOTAL		2

SIDEWALK REMOVAL

TYP. SEC. #	LOCATION	QUANTITY (SQ FT)
F. A. P. 713 (IL 61)		
(2)	STA. 308+87.00 TO STA. 308+91.00 RT	8
(2)	STA. 309+61.50 TO STA. 309+67.50 RT	27
PROJECT TOTAL		35

RAISED REFLECTIVE PAVEMENT MARKER REMOVAL

LOCATION	QUANTITY (EACH)
F. A. P. 713 (IL 61)	
COUNTED IN FIELD	20
PROJECT TOTAL	20

TEMPORARY RAMP

TYP. SEC. #	LOCATION	QUANTITY (SQ YD)
F. A. P. 713 (IL 61)		
(1)	STA. 303+80.00 TO STA. 303+85.00	14.44
(3)	STA. 313+45.00 TO STA. 313+50.00	13.33
PROJECT TOTAL		28

INLETS, TYPE A

TYP. SEC. #	LOCATION	QUANTITY (EACH)
F. A. P. 713 (IL 61)		
(2)	308+89.00, 10.35' RT	1
PROJECT TOTAL		1

STORM SEWER, CLASS A, TYPE 1 12"

TYP. SEC. #	LOCATION	QUANTITY (FOOT)
	F. A. P. 713 (IL 61)	
(2)	STA. 308+89.50 TO STA. 309+63.00 RT	73.5
PROJECT TOTAL		74

CONTROLLED LOW-STRENGTH MATERIAL

TYP. SEC. #	LOCATION	QUANTITY (CU YD)
	F. A. P. 713 (IL 61)	(Coef = 0.163)
	Depth (avg) 2.30, D(pipe) 12"	
(2)	STA. 308+89.50 TO STA. 309+63.00 RT	11.98
PROJECT TOTAL		12

FRAMES AND GRATES, TYPE 3V

TYP. SEC. #	LOCATION	QUANTITY (EACH)
	F. A. P. 713 (IL 61)	
(2)	308+89.00, 10.35' RT	1
PROJECT TOTAL		1

COMBINATION CONCRETE CURB AND GUTTER, TYPE B (SPECIAL)

TYP. SEC. #	LOCATION	QUANTITY (FOOT)
	F. A. P. 713 (IL 61)	
(2)	STA. 308+87.00 TO STA. 309+67.50 RT	80.5
PROJECT TOTAL		81

PORTLAND CEMENT CONCRETE SIDEWALK 4 INCH

TYP. SEC. #	LOCATION	QUANTITY (SQ FT)
	F. A. P. 713 (IL 61)	
(2)	STA. 308+87.00 TO STA. 308+91.00 RT	8
(2)	STA. 309+61.50 TO STA. 309+67.50 RT	27
PROJECT TOTAL		35

MANHOLES, TYPE A, 4' DIAMETER, TYPE 3V FRAME AND GRATE

TYP. SEC. #	LOCATION	QUANTITY (EACH)
	F. A. P. 713 (IL 61)	
(2)	309+65.00, 10.29' RT	1
PROJECT TOTAL		1

SHORT-TERM PAVEMENT MARKING

TYP. SEC. #	LOCATION	QUANTITY (FOOT)
	F. A. P. 713 (IL 61)	
(1-3)	STA. 303+80.00 TO STA. 313+50.00	
SUBTOTAL (After Milling)		88.18
SUBTOTAL (After Surface)		88.18
PROJECT TOTAL		177

WORK ZONE PAVEMENT MARKING REMOVAL

LOCATION	QUANTITY (SQ FT)
(Removal of Short-Term Pavement Marking) (After Surface Course)	
(88.18)(4/12)	29.39
PROJECT TOTAL	30

PAINT PAVEMENT MARKING - LINE

TYP. SEC. #	LOCATION	5"		
		YELLOW		WHITE
		SOLID (FOOT)	SKIP-DASH (FOOT)	SOLID (FOOT)
	F. A. P. 713 (IL 61)			
(1)	STA. 303+80.00 TO STA. 305+27.00			294
(1-3)	STA. 303+80.00 TO STA. 306+69.00	289		
(1-3)	STA. 303+80.00 TO STA. 313+50.00		242.50	
(3)	STA. 312+76.00 TO STA. 313+50.00			148
	SUBTOTAL	289	242.50	442
	PROJECT TOTAL		974	

RAISED REFLECTIVE PAVEMENT MARKER

TYP. SEC. #	LOCATION	QUANTITY (EACH)
	F. A. P. 713 (IL 61) 40' SPACING	
(1-3)	STA. 303+80.00 TO STA. 313+50.00	25
	PROJECT TOTAL	25

PAVEMENT SCHEDULE

TYP SEC #	LOCATION STATION TO STATION	LENGTH	PAVEMENT WIDTH	HMA SURF THICKNESS	HMA SURF REM BUTT JOINT	HMA SURF REMOVAL 2"	HMA CONC SURF CSE "C" N50	BIT MAT PRIME COAT	AGG PRIME COAT
		FOOT	FOOT	INCH	SQ YD	SQ YD	TON	TON	TON
	F. A. P. 713 (IL 61)	-	-	-	-	-	-	-	-
(1)	STA. 303+80.00 TO STA. 303+90.00	10	26	-	28.89	-	-	0.01	0.06
(1)	STA. 303+80.00 TO STA. 305+19.00	139	26	2	-	-	44.97	-	-
(1)	STA. 303+90.00 TO STA. 305+19.00	129	26	-	-	372.67	-	0.14	0.75
(1)	STA. 305+19.00 TO STA. 305+27.00	8	24.5	2	-	21.78	2.44	0.01	0.04
(2)	STA. 305+27.00 TO STA. 312+76.00	749	23	2	-	-	214.38	-	-
(2)	STA. 305+27.00 TO STA. 308+89.00	362	23	-	-	925.11	-	0.35	1.85
(2)	STA. 308+89.00 TO STA. 309+65.00	76	21	2	-	177.33	-	0.07	0.35
(2)	STA. 309+65.00 TO STA. 312+76.00	311	23	2	-	794.78	-	0.30	1.59
(3)	STA. 312+76.00 TO STA. 313+50.00	74	24	2	-	-	22.10	-	-
(3)	STA. 312+76.00 TO STA. 313+40.00	64	24	2	-	170.67	-	0.06	0.34
(3)	STA. 313+40.00 TO STA. 313+50.00	10	24	-	26.67	-	-	0.01	0.05
	PROJECT TOTAL	-	-	-	56	2,463	284	1	5

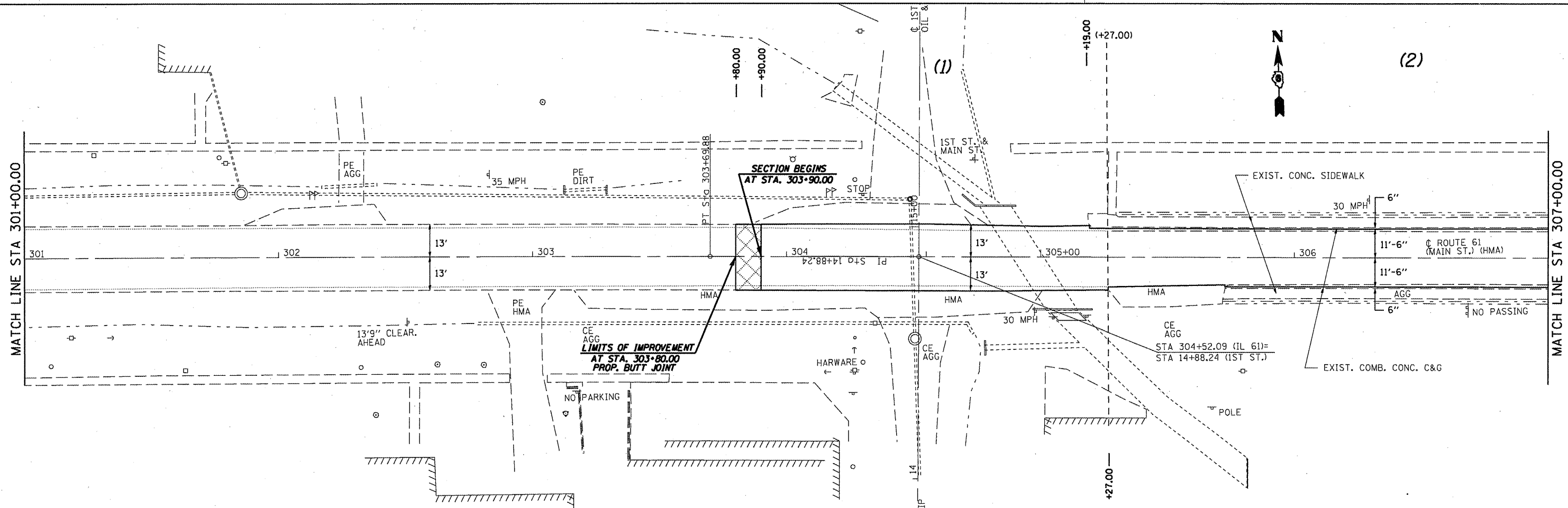
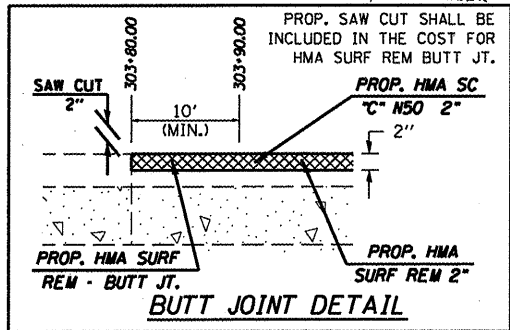
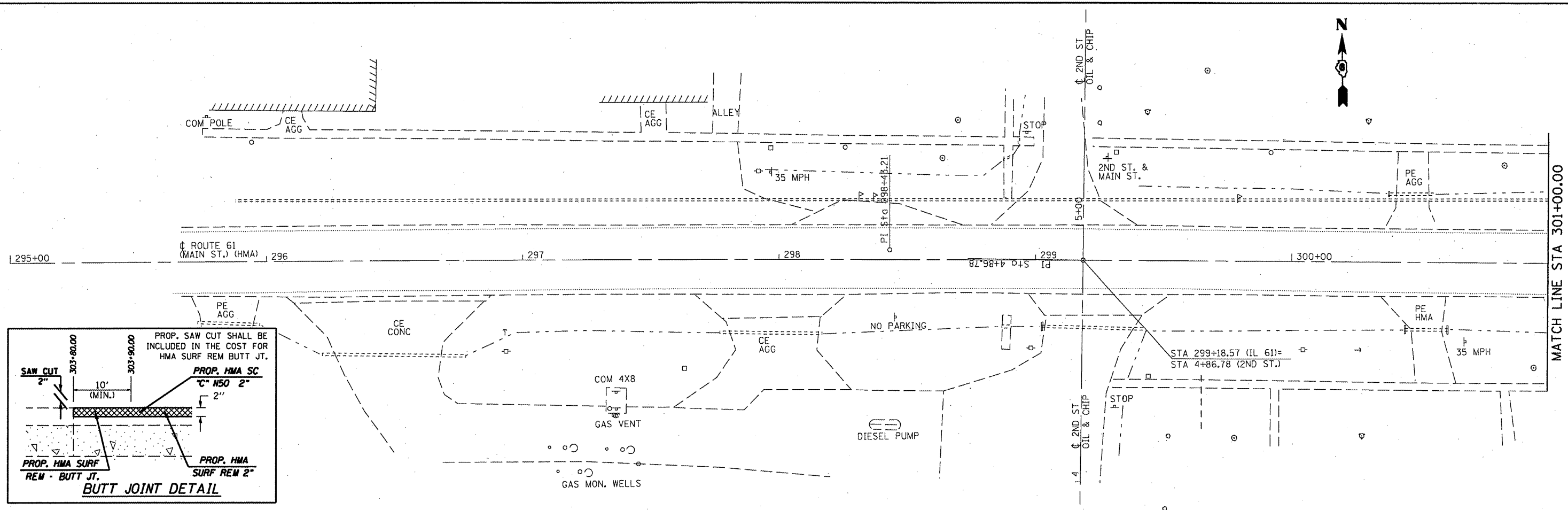

FILE NAME = c:\pwwork\pwwork\cabrerers\d0239921\0672E05-sht-plan.dgn	USER NAME = cabrerers	DESIGNED - JWC	REVISED -	STATE OF ILLINOIS DEPARTMENT OF TRANSPORTATION	PLAN SHEETS				F.A.P. RTE.	SECTION	COUNTY	TOTAL SHEETS	SHEET NO.
	PLOT SCALE = 40.0000' / IN.	DRAWN - JWC	REVISED -		713	(102)RS-9.T	HANCOCK	11	8				
	PLOT DATE = Mar-28-2011 11:57:20AM	CHECKED - RSC	REVISED -		SCALE: 20 SHEET NO. 1 OF 2 SHEETS STA. 295+50.00 TO STA. 307+00.00				CONTRACT NO. 72E05				
		DATE -	REVISED -		ILLINOIS FED. AID PROJECT								

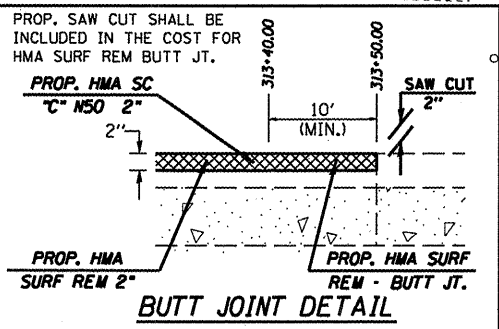
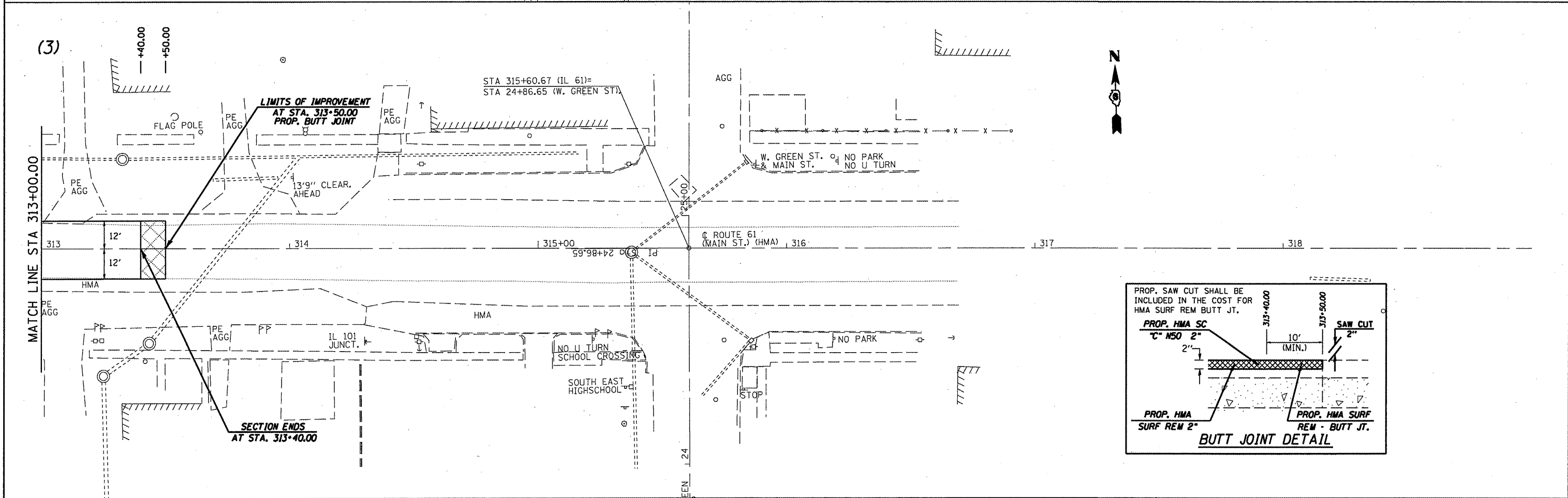
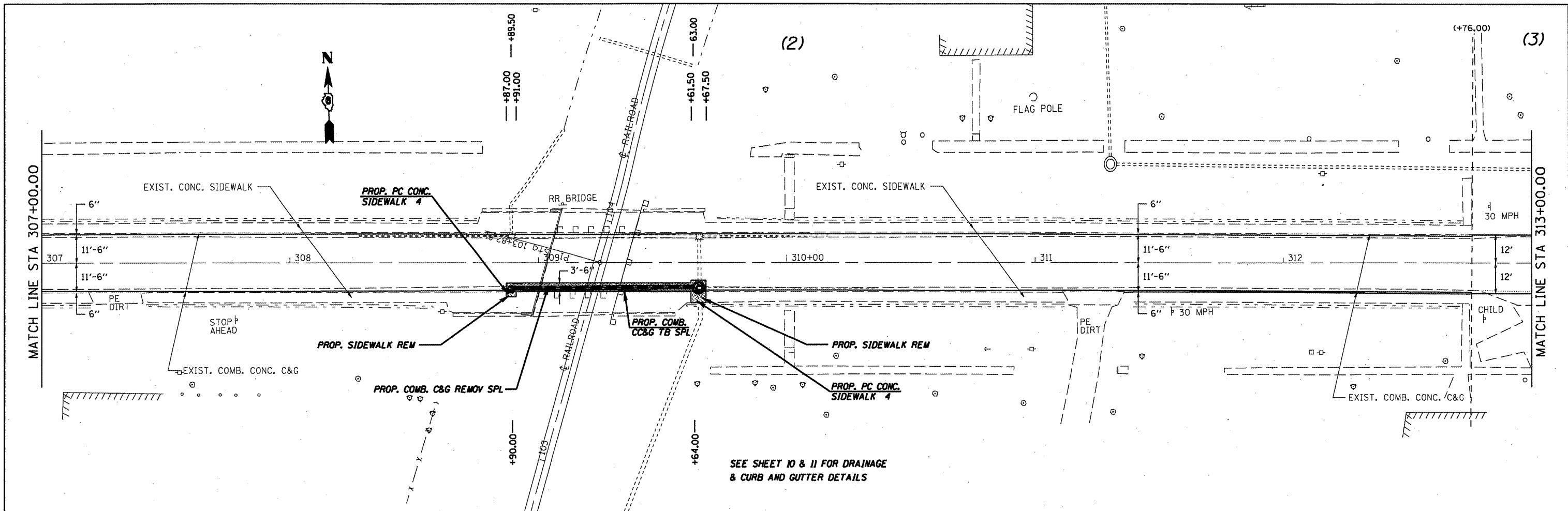

FILE NAME =	USER NAME = cbrerars	DESIGNED - JWC	REVISED -	STATE OF ILLINOIS DEPARTMENT OF TRANSPORTATION	PLAN SHEETS			F.A.P. RTE. 713	SECTION (102)RS-9,T	COUNTY HANCOCK	TOTAL SHEETS 11	SHEET NO. 9
ct:\p\work\ps\d0239921\082E05-shr-plant.dgn	PLOT SCALE = 48.0000 "/td> <td>DRAWN - JWC</td> <td>REVISED -</td> <td>SCALE: 20</td> <td>SHEET NO. 2 OF 2 SHEETS</td> <td>STA. 307+00.00 TO STA. 318+50.00</td> <td colspan="5" style="text-align: center;">CONTRACT NO. 72E05</td>	DRAWN - JWC	REVISED -		SCALE: 20	SHEET NO. 2 OF 2 SHEETS	STA. 307+00.00 TO STA. 318+50.00	CONTRACT NO. 72E05				
	PLOT DATE = Mar-28-2011 11:57:37AM	CHECKED - RSC	REVISED -		ILLINOIS FED. AID PROJECT							
		DATE -	REVISED -									

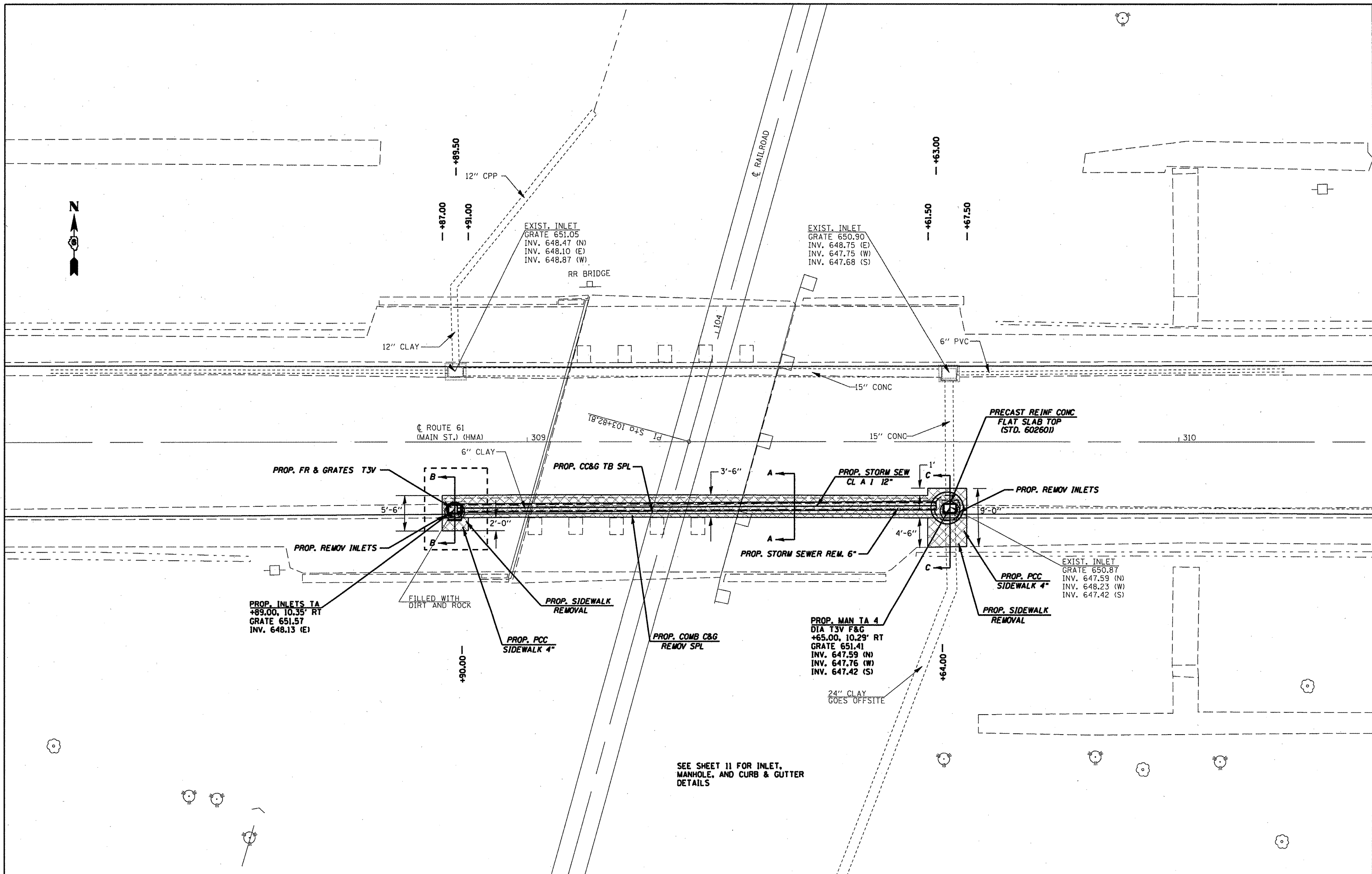

SEE SHEET 11 FOR INLET, MANHOLE, AND CURB & GUTTER DETAILS

FILE NAME =	USER NAME = cabrerens
ct:\pwwork\pkidot\cabrerens\0239921\08	2E05-shd-drain.dgn
PLOT SCALE = 100.0000' / 1" IN.	CHECKED - RSC
PLOT DATE = Mar-29-2011 01:20:20PM	DATE -

DESIGNED - RSC	REVISED -
DRAWN - RSC	REVISED -
CHECKED - RSC	REVISED -
DATE -	REVISED -

**STATE OF ILLINOIS
DEPARTMENT OF TRANSPORTATION**

DRAINAGE DETAILS		
SCALE: 50	SHEET NO. 1 OF 2 SHEETS	STA. 308+20.00 TO STA. 310+30.00

F.A.P. RTE.	SECTION	COUNTY	TOTAL SHEETS	SHEET NO.
713	(102)RS-9,T	HANCOCK	11	10
CONTRACT NO. 72E05				
ILLINOIS FED. AID PROJECT				

