

DATE	BY
DATE	BY
DATE	BY

DATE	BY
DATE	BY
DATE	BY

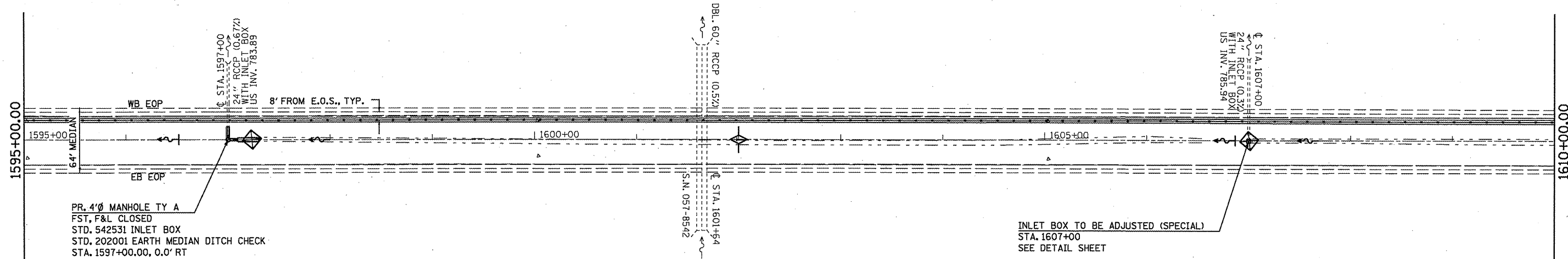

MEDIAN INLET BOX REMOVAL - 1 EACH
 PIPE CULVERT, CL A, TY1, 24" - 19 FOOT
 CONCRETE COLLAR - 0.45 CU YD

LEGEND

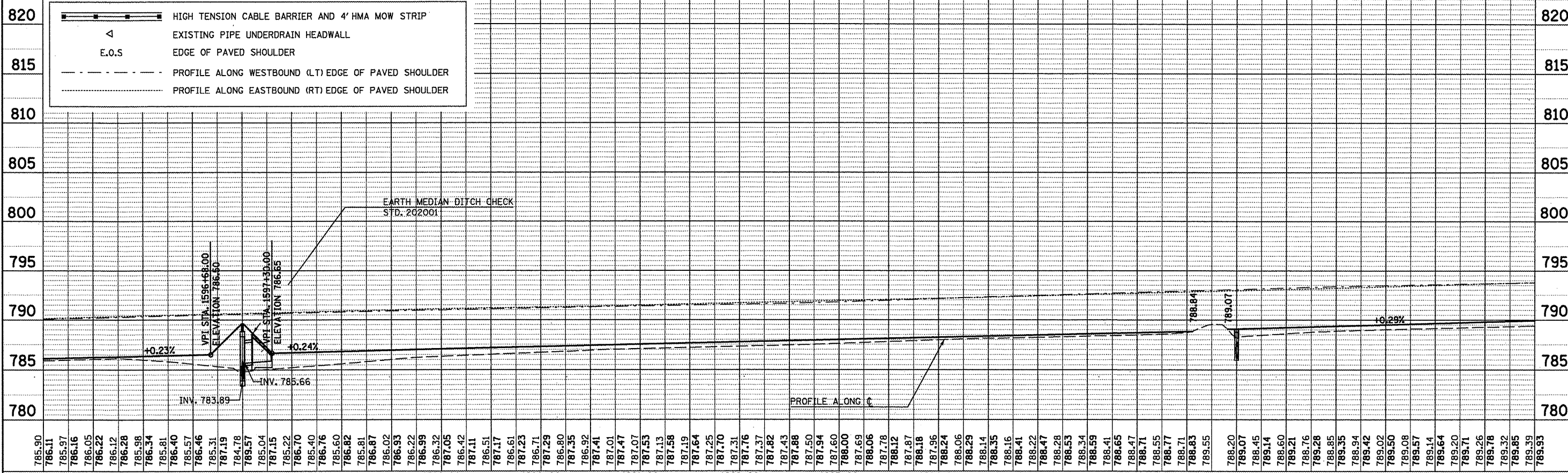

FILE NAME =	USER NAME = keyarb	DESIGNED -	REVISED -
at:\pwwork\pridat\keyarb\20261049\0578927	sh-tplng-f_50.dgn	DRAWN -	REVISED -
PLOT SCALE = 100.0000' / in.	CHECKED -	REVISED -	REVISED -
PLOT DATE = 5/5/2011	DATE -	REVISED -	REVISED -

STATE OF ILLINOIS
 DEPARTMENT OF TRANSPORTATION

REVISED SHEET
 6-6-11

PLAN AND PROFILE

SCALE: SHEET NO. OF SHEETS STA. TO STA.

F.A.I. RTE.	SECTION	COUNTY	TOTAL SHEETS	SHEET NO.
74	FY11 HSIP-5	MCLEAN	101	12
CONTRACT NO. 70927			ILLINOIS FED. AID PROJECT	