

EXISTING TRAFFIC SIGNAL AND REMOVAL NOTES

1. THE REMOVAL ITEMS ARE AS INDICATED ON THE PLANS. THE CONTRACTOR SHALL VERIFY ALL REMOVAL ITEMS PRIOR TO BIDDING.
2. THE EXISTING TRAFFIC SIGNALS SHALL REMAIN IN OPERATION DURING THE CONSTRUCTION OF THE TEMPORARY TRAFFIC SIGNALS.
3. ANY MAINTENANCE OF THE EXISTING SIGNALS SHALL BE CONSIDERED EXTRA WORK IN ACCORDANCE WITH ARTICLE 109.04 OF THE STANDARD SPECIFICATIONS.
4. FULL DEPTH SAW CUTS SHALL BE REQUIRED AT ALL REMOVAL LIMITS. IF THE CONTRACTOR REMOVES OR DAMAGES THE EXISTING SIDEWALK OR BITUMINOUS SURFACE OUTSIDE THE REMOVAL LIMITS DESIGNATED BY THE ENGINEER, THE CONTRACTOR SHALL REMOVE AND/OR REPLACE THAT PORTION AT THE CONTRACTOR'S EXPENSE.
5. THE EXISTING HANDHOLES SHALL BE REMOVED. THIS WORK WILL BE PAID FOR AS "REMOVE EXISTING HANDHOLE".

REMOVE EXISTING HANDHOLE - QTY. 6.0 EA.	
QTY.	LOCATIONS
1.0 EA.	HH-1, HH-2, HH-3, HH-4, HH-5, HH-6

REMOVE EXISTING CONCRETE FOUNDATIONS - QTY. 5.0 EA.	
QTY.	LOCATIONS
1.0 EA.	MA-1, MA-2, MA-3, MA-4, CONTROLLER

SCHEDULE OF QUANTITIES		
ITEM DESCRIPTION	UNIT	QUANTITY
REMOVE EXISTING TRAFFIC SIGNAL EQUIPMENT	EACH	1.0
REMOVE EXISTING CONCRETE FOUNDATIONS	EACH	5.0
REMOVE EXISTING HANDHOLE	EACH	6.0

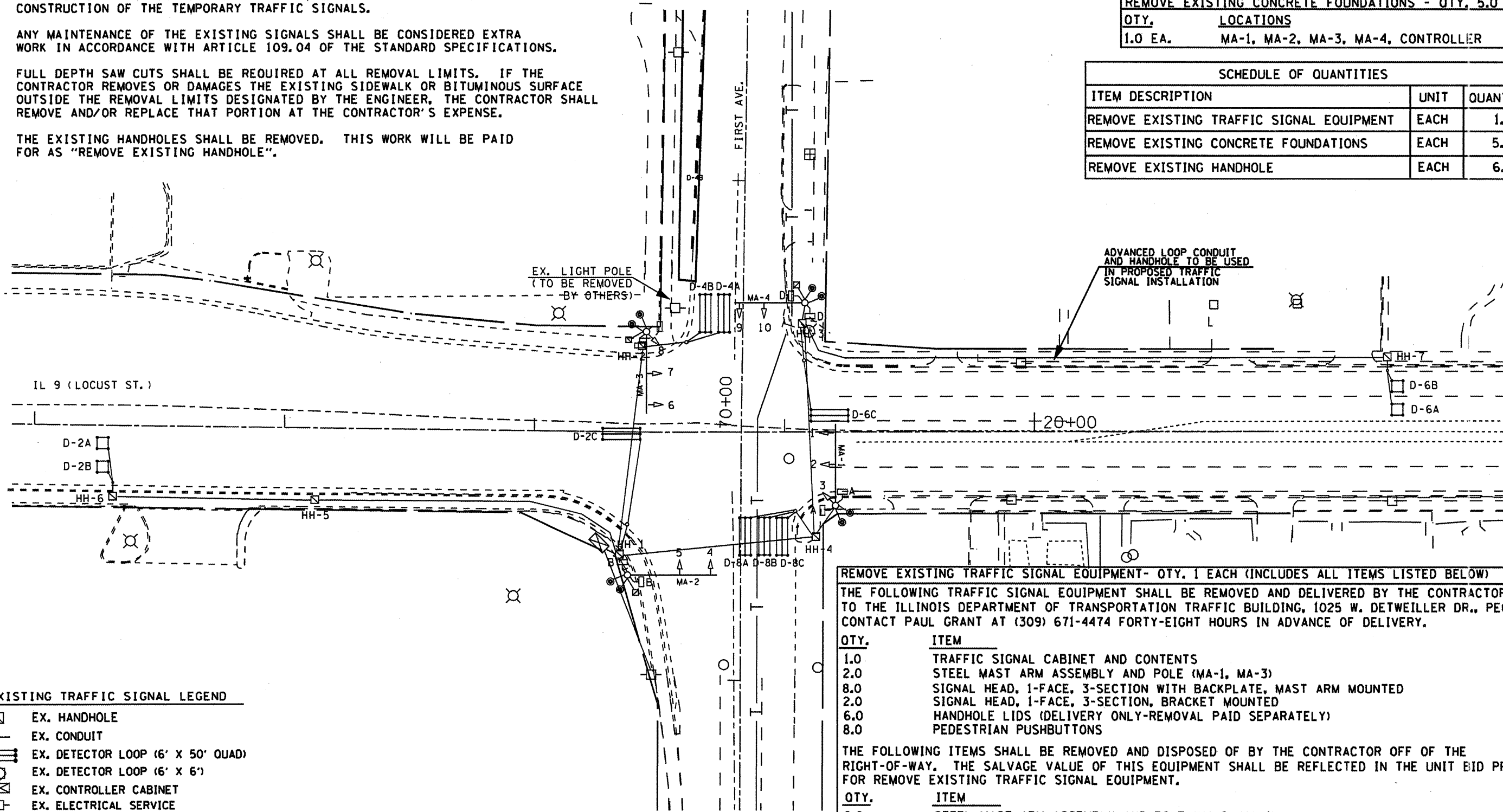

EXISTING TRAFFIC SIGNAL LEGEND

- ☐ EX. HANDHOLE
- EX. CONDUIT
- ▤ EX. DETECTOR LOOP (6' X 50' QUAD)
- ▤ EX. DETECTOR LOOP (6' X 6')
- ⊠ EX. CONTROLLER CABINET
- ⊠ EX. ELECTRICAL SERVICE
- ⊠ EX. TRAFFIC SIGNAL HEAD
- ⊠ EX. TRAFFIC SIGNAL HEAD W/ BACKPLATE
- ⊠ EX. STL MAST ARM ASSEMBLY AND POLE
- ⊠ EX. LUMINAIRE

REMOVE EXISTING TRAFFIC SIGNAL EQUIPMENT - QTY. 1 EACH (INCLUDES ALL ITEMS LISTED BELOW)

THE FOLLOWING TRAFFIC SIGNAL EQUIPMENT SHALL BE REMOVED AND DELIVERED BY THE CONTRACTOR TO THE ILLINOIS DEPARTMENT OF TRANSPORTATION TRAFFIC BUILDING, 1025 W. DETWEILLER DR., PEORIA. CONTACT PAUL GRANT AT (309) 671-4474 FORTY-EIGHT HOURS IN ADVANCE OF DELIVERY.

QTY.	ITEM
1.0	TRAFFIC SIGNAL CABINET AND CONTENTS
2.0	STEEL MAST ARM ASSEMBLY AND POLE (MA-1, MA-3)
8.0	SIGNAL HEAD, 1-FACE, 3-SECTION WITH BACKPLATE, MAST ARM MOUNTED
2.0	SIGNAL HEAD, 1-FACE, 3-SECTION, BRACKET MOUNTED
6.0	HANDHOLE LIDS (DELIVERY ONLY-REMOVAL PAID SEPARATELY)
8.0	PEDESTRIAN PUSHBUTTONS

THE FOLLOWING ITEMS SHALL BE REMOVED AND DISPOSED OF BY THE CONTRACTOR OFF OF THE RIGHT-OF-WAY. THE SALVAGE VALUE OF THIS EQUIPMENT SHALL BE REFLECTED IN THE UNIT BID PRICE FOR REMOVE EXISTING TRAFFIC SIGNAL EQUIPMENT.

QTY.	ITEM
2.0	STEEL MAST ARM ASSEMBLY AND POLE (MA-2, MA-4)
4.0	PEDESTRIAN SIGNAL HEAD, 2-FACE, 1-SECTION
1.0	SERVICE INSTALLATION
ALL	ELECTRIC CABLE

NOT TO SCALE
TRAFFIC SIGNALS
SHEET 14 OF 23