

**MAINTENANCE OF TRAFFIC TYPICAL SECTION
LOCUST STREET (IL 978) STAGES 1A AND 1B**
STA. 16+92.6 TO STA. 18+42.6

•-STA. 16+92.55-STA. 16+96.00 (13.0')
STA. 16+96.00-STA. 18+06.21 (5.0')

NOTE:
UTILIZE EXISTING DRAINAGE STRUCTURE STA. 15+88 RT. FOR EXISTING & TEMPORARY PAVEMENT DRAINAGE, STAGE 1A & 1B. TEMPORARY PAVEMENT TO BE SLOPED TOWARDS STRUCTURE.

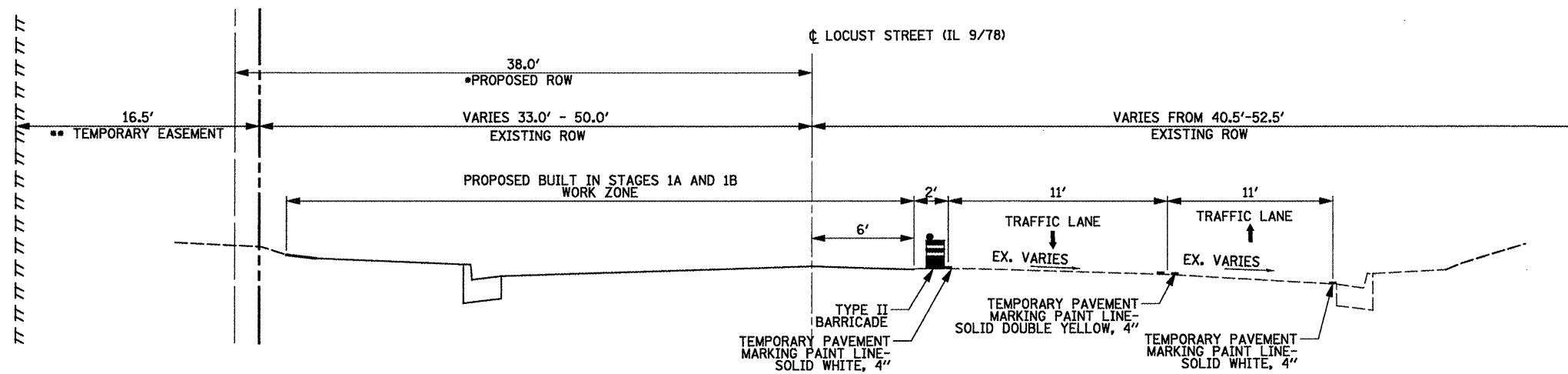

**MAINTENANCE OF TRAFFIC TYPICAL SECTION
LOCUST STREET (IL 978) STAGES 1A AND 1B**
STA. 10+21.8 TO STA. 15+08.7

•-STA. 10+45.46-STA. 13+11.15
••-STA. 12+15.00-STA. 13+67.18

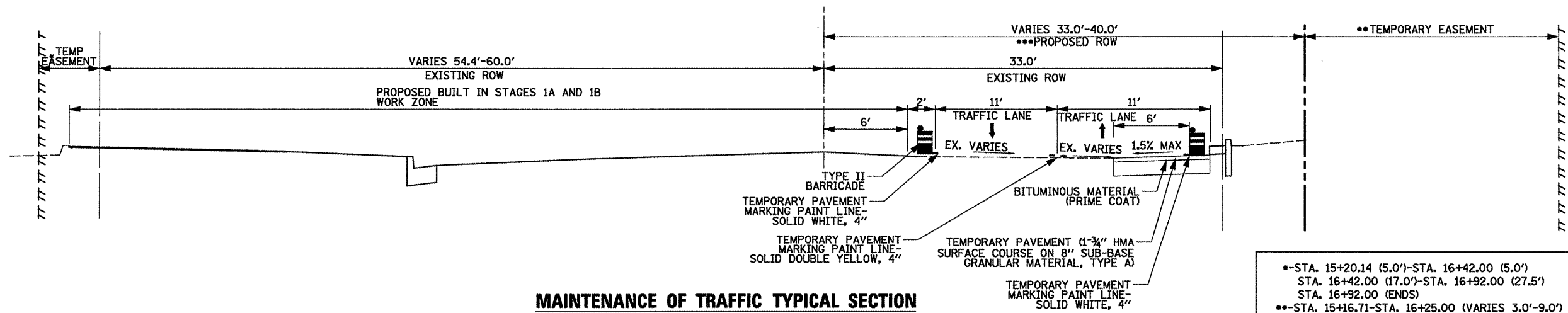

**MAINTENANCE OF TRAFFIC TYPICAL SECTION
LOCUST STREET (IL 978) STAGES 1A AND 1B**
STA. 15+08.7 TO STA. 16+92.6

•-STA. 15+20.14 (5.0')-STA. 16+42.00 (5.0')
STA. 16+42.00 (17.0')-STA. 16+92.00 (27.5')
STA. 16+92.00 (ENDS)
••-STA. 15+16.71-STA. 16+25.00 (VARIES 3.0'-9.0')
STA. 16+25.00-STA. 16+92.55 (VARIES 12.0'-13.0')
•••-STA. 15+20.00 (40.0')-STA. 16+40.00 (33.0')

FILE NAME = P:\P-09\2193 - IDOT DUR\Task-04\DWG\SHIT\09a_04-9400909-MOT01A.dgn	USER NAME = _2193 Task 4_	DESIGNED LC	REVISED -
PLOT SCALE = NTS	CHECKED JRS	REVISOR	REVISOR
PLOT DATE = 12/21/2010	DATE 12/21/2010	REVISOR	REVISOR



**STATE OF ILLINOIS
DEPARTMENT OF TRANSPORTATION**

MAINTENANCE OF TRAFFIC LOCUST STREET-RECONSTRUCTION STAGES 1A AND 1B	
SCALE: NTS	SHEET NO. 02 OF 06 SHEETS
STA. 10+21.8	TO STA. 18+42.6

F.A.P. RTE. 685/22	SECTION (41Z, 135) R, N, (ICS) I	COUNTY FULTON	TOTAL SHEETS 125	SHEET NO. 34
CONTRACT NO. 68877				
ILLINOIS FED. AID PROJECT 04-94-009-09				