

AVENUE A

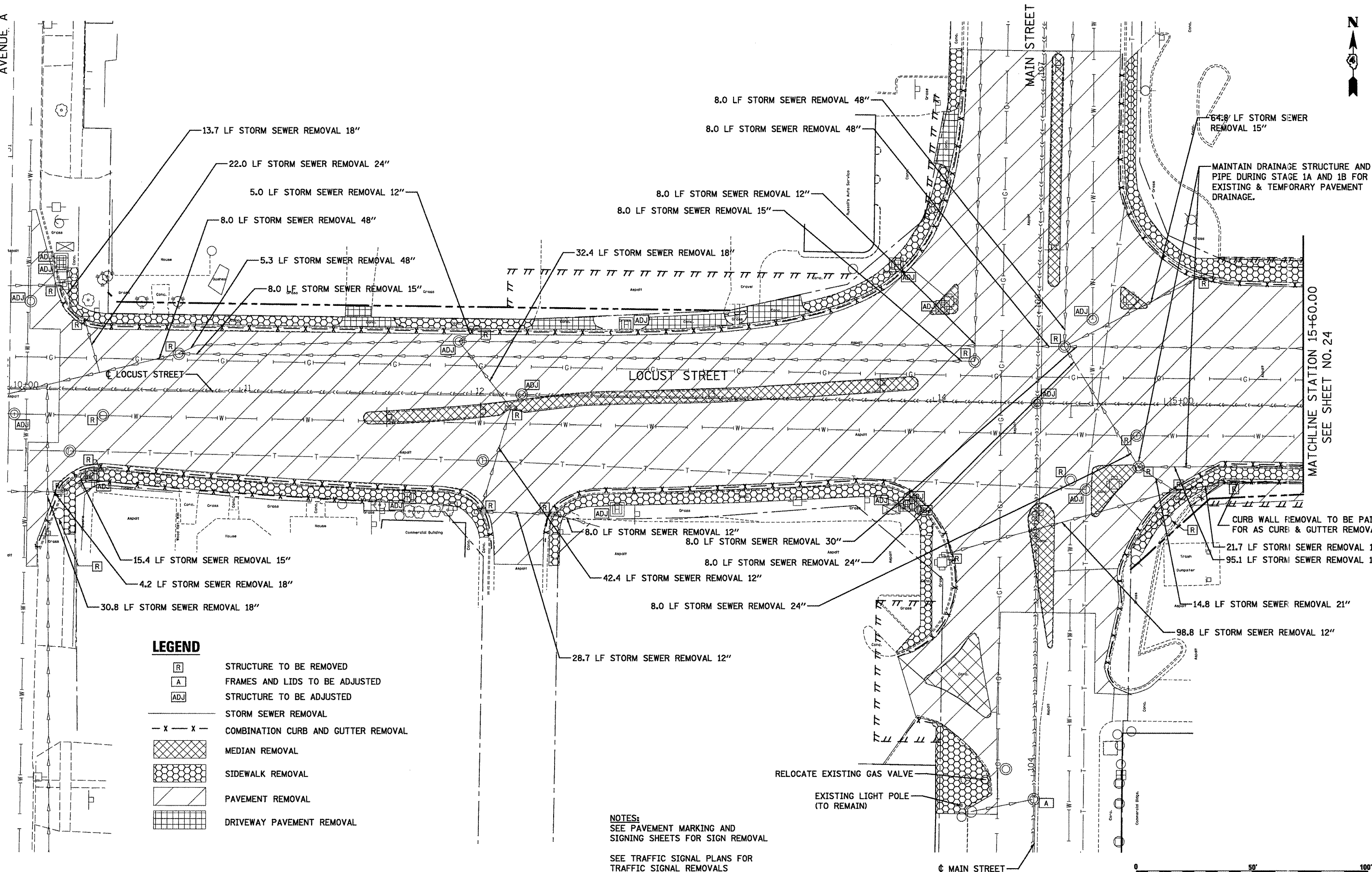

**LEGEND**

- R STRUCTURE TO BE REMOVED
- A FRAMES AND LIDS TO BE ADJUSTED
- ADJ STRUCTURE TO BE ADJUSTED
- X --- X --- STORM SEWER REMOVAL
- X --- X --- COMBINATION CURB AND GUTTER REMOVAL
- MEDIAN REMOVAL
- SIDEWALK REMOVAL
- PAVEMENT REMOVAL
- DRIVEWAY PAVEMENT REMOVAL

**NOTES:**  
 SEE PAVEMENT MARKING AND SIGNING SHEETS FOR SIGN REMOVAL  
 SEE TRAFFIC SIGNAL PLANS FOR TRAFFIC SIGNAL REMOVALS

MAINTAIN DRAINAGE STRUCTURE AND PIPE DURING STAGE 1A AND 1B FOR EXISTING & TEMPORARY PAVEMENT DRAINAGE.

CURB WALL REMOVAL TO BE PAID FOR AS CURB & GUTTER REMOVAL

MATCHLINE STATION 15+60.00  
SEE SHEET NO. 24



FILE NAME = P:\P-09\2193 - IDOT DUR\Task-04\DWG\SH1\07_D4-9480929-rem01.dgn	USER NAME = ..2193 Task 4..	DESIGNED RP	REVISED -
		DRAWN SV	REVISED -
		CHECKED JRS	REVISED -
		DATE 12/21/2010	REVISED -

**INFRASTRUCTURE ENGINEERING**  
 456 Fulton Street | Suite 104 | Peoria, IL 61602  
 P: 309.691.2000 | F: 309.691.9200 | www.infrastructure-eng.com

**STATE OF ILLINOIS  
 DEPARTMENT OF TRANSPORTATION**

<b>REMOVAL PLAN</b>	
<b>LOCUST STREET-RECONSTRUCTION</b>	
SCALE: 1"=20'	SHEET NO. 01 OF 03 SHEETS
STA. 10+00.00	TO STA. 15+60.00

F.A.P. RTE. 685/22	SECTION (41Z, 135) R, N; (1CS) I	COUNTY FULTON	TOTAL SHEETS 125	SHEET NO. 23
CONTRACT NO. 68877				ILLINOIS FED. AID PROJECT D4-94-009-09