

EXISTING PAVEMENT SAWING DETAIL
(AGAINST BITUMINOUS SHOULDER)

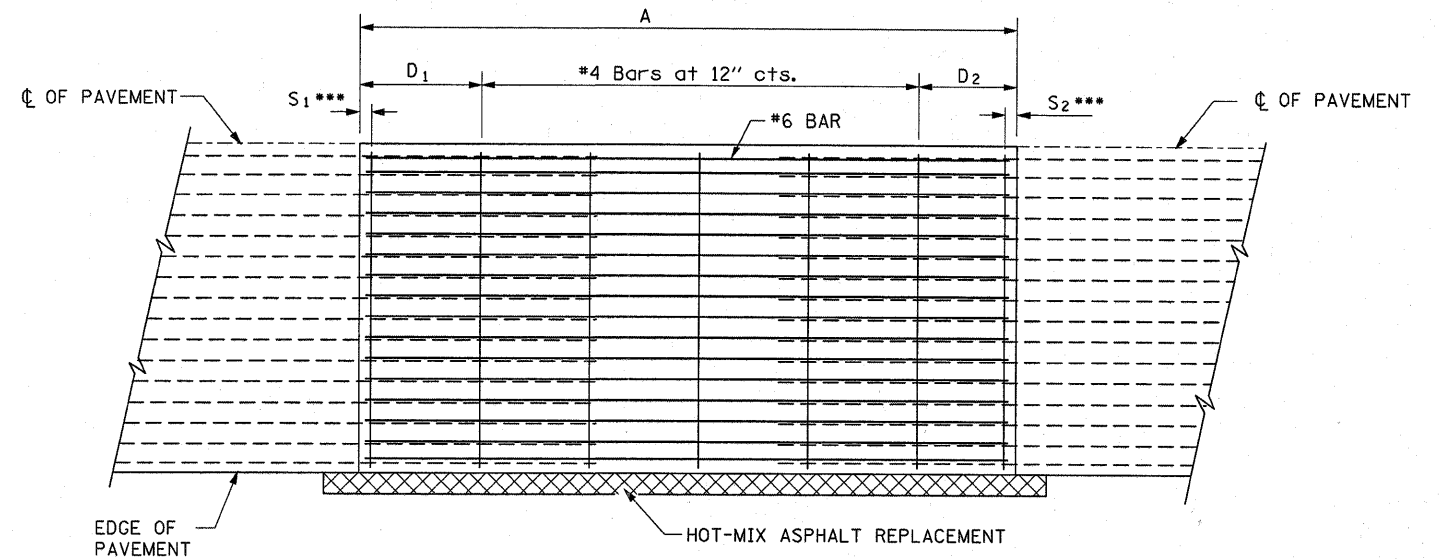

PROPOSED PAVEMENT DETAIL
(AGAINST BITUMINOUS SHOULDER)

EXISTING LONGITUDINAL REINFORCEMENT BARS	A (min.)	B (min.)	C (min.)
No. 6	6'-0"	24"	19"

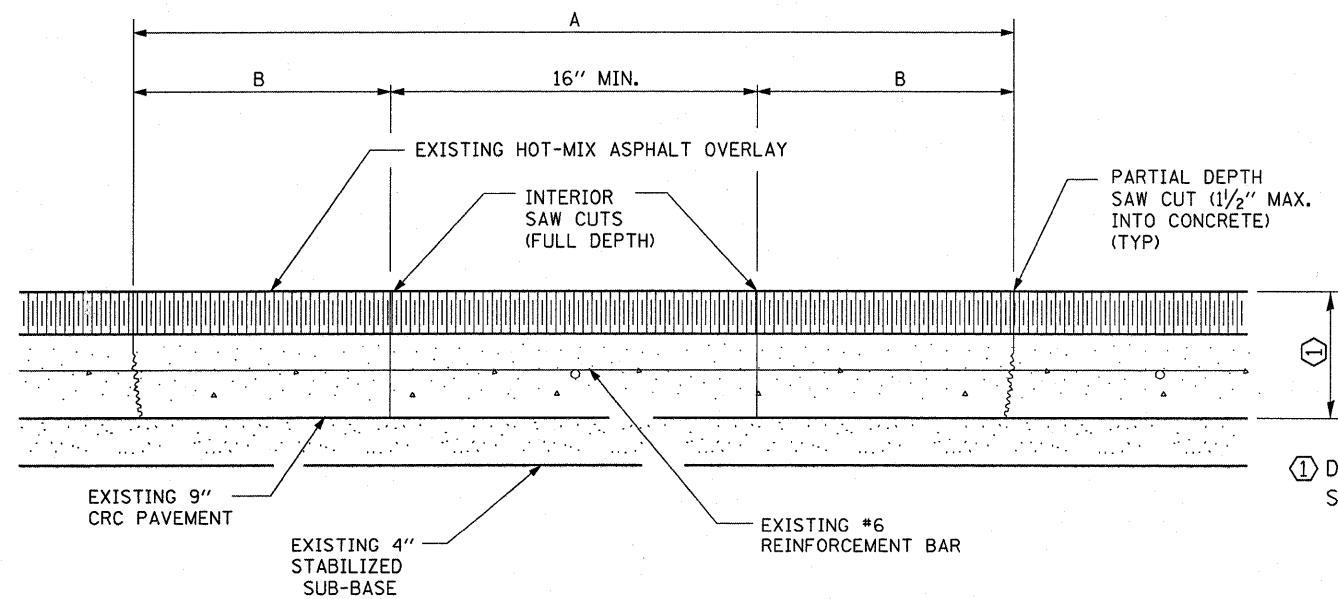

EXISTING PAVEMENT SAW CUTTING DETAIL

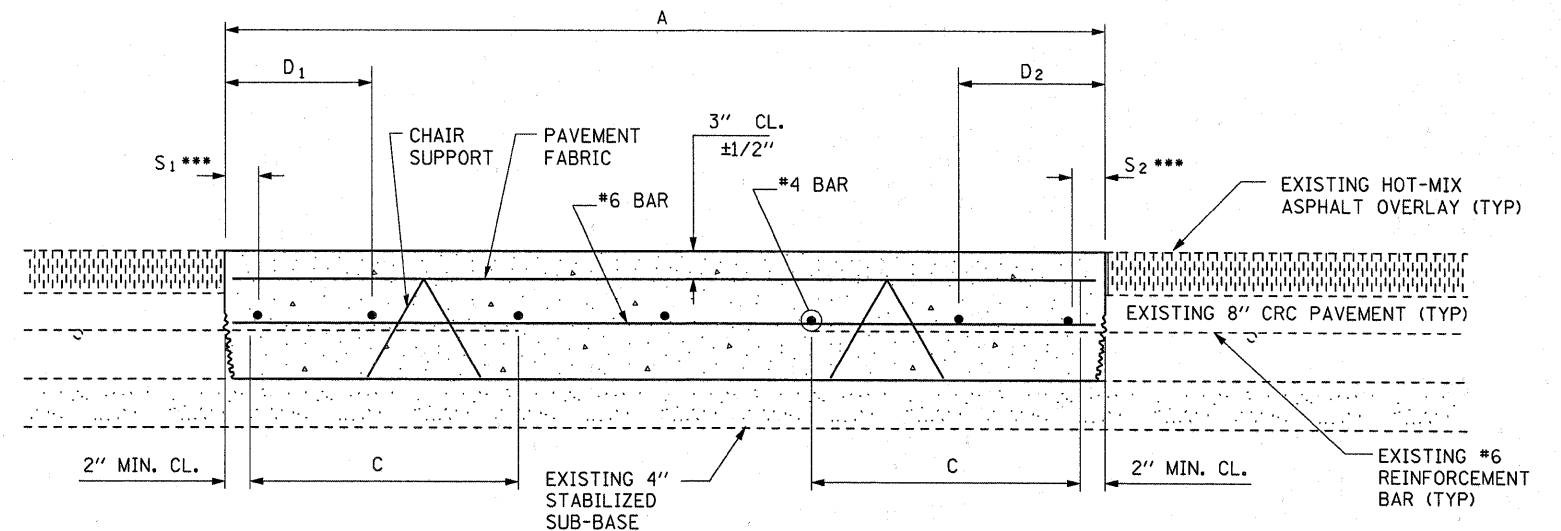

PROPOSED CLASS A PATCHING DETAIL

① DEPTH VARIES
SEE TYPICAL SECTIONS

NOTES:

- EVERY 3rd INTERSECTION MUST BE TIED
- LAP NEW REINFORCEMENT WITH EXISTING LONGITUDINAL REINFORCEMENT
- VARIABLES: WHERE S₁ AND S₂ ARE 2 1/2" MIN. AND 12" MAX. D₁ = 2(S₁) AND D₂ = 2(S₂)

FILE NAME =	USER NAME = braboypc	DESIGNED - RON WOODSHANK	REVISED -
c:\pwork\pwork\braboypc\d0264631\036837-sht-detail.dgn		DRAWN - RON WOODSHANK	REVISED -
PLT SCALE = 50.0000' / IN.		CHECKED -	REVISED -
PLT DATE = Apr 04, 2011 - 09:01:24 AM		DATE -	REVISED -

**STATE OF ILLINOIS
DEPARTMENT OF TRANSPORTATION**

**CLASS A PATCHING DETAILS
WITH HMA OVERLAY**

SCALE: _____ SHEET NO. 1 OF 1 SHEETS STA. _____ TO STA. _____

RTE.	SECTION	COUNTY	TOTAL SHEETS	SHEET NO.
FAI 55	D3 PATCHING 2012-2	GRUNDY	13	12
CONTRACT NO. 66B37			ILLINOIS	