

- NOTE 1: MANHOLES TO B ADJUSTED WITH NEW TYPE 1 FRAME, CLOSED LID.
- NOTE 2: INLET TO BE ADJUSTED WITH TYPE 3 FRAME AND GRATE.
- NOTE 3: INLET TO BE ADJUSTED WITH TYPE 11 FRAME AND GRATE.
- NOTE 4: WATER VALVE TO BE ADJUSTED.

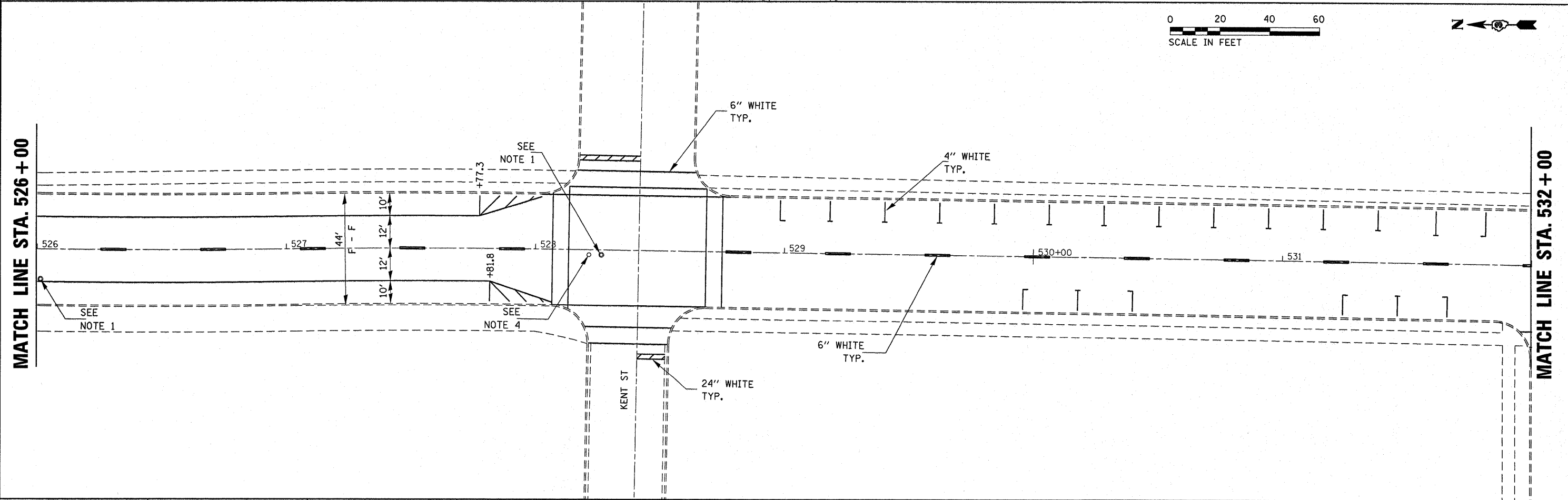
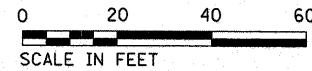

FILE NAME =	USER NAME = wsg1ewskim	DESIGNED -	REVISED -	STATE OF ILLINOIS DEPARTMENT OF TRANSPORTATION	IL. RTE. 23 - PARK ST. PAVEMENT MARKING				F.A.P. RTE.	SECTION	COUNTY	TOTAL SHEETS	SHEET NO.
c:\pr_work\p\dot\wsg1ewskim\d0248423\0366839-shr-details.DGN		DRAWN -	REVISED -		68	(52,99,100)RS-3, (37)RS-2	*	50	36				
		PLOT SCALE = 20.0000 "/ IN.	REVISED -		SCALE: SHEET NO. OF SHEETS STA. TO STA.				* LASALLE & LIVINGSTON		CONTRACT NO. 66839		
		PLOT DATE = Mar 25, 2011 - 03:24:13 PM	REVISED -		ILLINOIS FED. AID PROJECT								