

- LEGEND**
- - 
  - 
  - 
  - 
  - 
  -

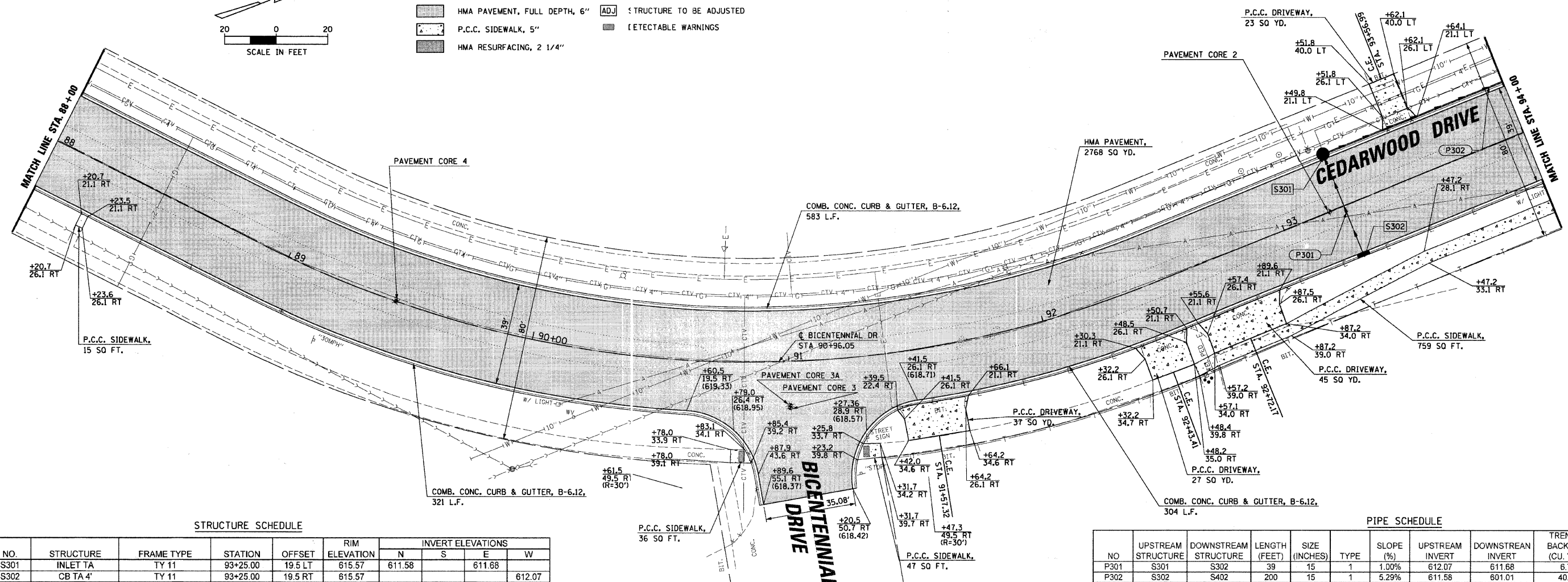

**STRUCTURE SCHEDULE**

NO.	STRUCTURE	FRAME TYPE	STATION	OFFSET	RIM ELEVATION	INVERT ELEVATIONS			
						N	S	E	W
S301	INLET TA	TY 11	93+25.00	19.5 LT	615.57	611.58		611.68	
S302	CB TA 4'	TY 11	93+25.00	19.5 RT	615.57				612.07

**PIPE SCHEDULE**

NO	UPSTREAM STRUCTURE	DOWNSTREAM STRUCTURE	LENGTH (FEET)	SIZE (INCHES)	TYPE	SLOPE (%)	UPSTREAM INVERT	DOWNSTREAM INVERT	TRENCH BACKFILL (CU. YD.)
P301	S301	S302	39	15	1	1.00%	612.07	611.68	6.7
P302	S302	S402	200	15	1	5.29%	611.58	601.01	40.1

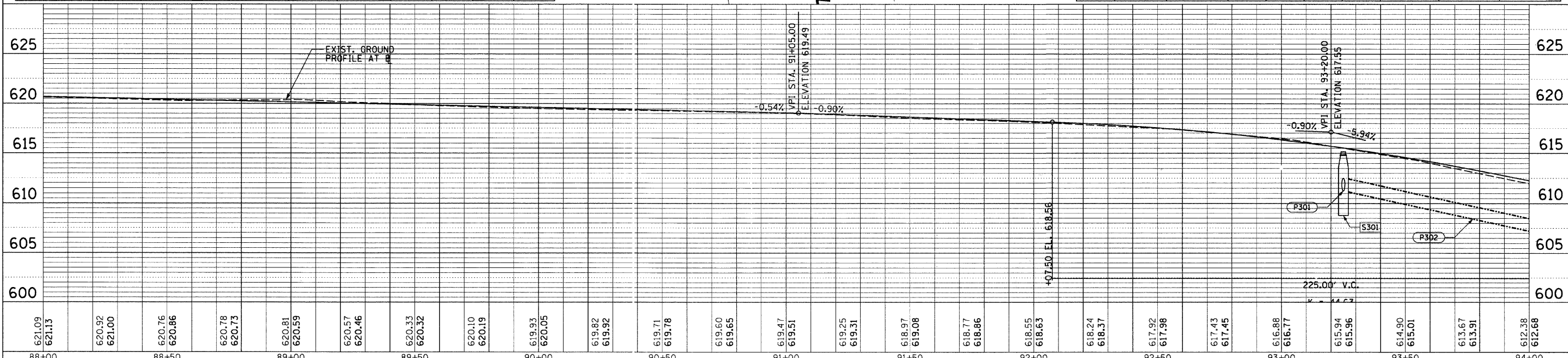

621.09	621.13	620.92	621.00	620.76	620.86	620.78	620.73	620.81	620.59	620.57	620.46	620.33	620.32	620.10	620.19	619.93	620.05	619.82	619.92	619.71	619.78	619.60	619.65	619.47	619.51	619.25	619.31	618.97	619.08	618.77	618.86	618.55	618.63	618.24	618.37	617.92	617.98	617.43	617.45	616.88	616.77	615.94	615.96	614.90	615.01	613.67	613.91	612.38	612.68									
88+00				88+50				89+00						89+50							90+00								90+50																					93+00								94+00

**STATE OF ILLINOIS  
DEPARTMENT OF TRANSPORTATION**

**ROADWAY PLAN AND PROFILE  
CEDARWOOD DRIVE, CREST HILL**

FILE NAME =	USER NAME = CMCCOLLO	DESIGNED -	REVISED -
Na\CRESTHILL\100397\Civil\NRPP_3_100397.DGN		DRAWN -	REVISED -
		CHECKED -	REVISED -
		DATE -	REVISED -

SCALE:	SHEET NO. 3 OF 4 SHEETS	STA. 88+00 TO STA. 94+00	F.A. RTE. 328	SECTION 10-00040-00-PV	COUNTY WILL	TOTAL SHEETS 31	SHEET NO. 15
							CONTRACT NO. 63586
ILLINOIS FED. AID PROJECT							

DATE: \_\_\_\_\_ BY: \_\_\_\_\_  
 PLAN  
 SURVEYED \_\_\_\_\_  
 CHECKED \_\_\_\_\_  
 ALIGNED \_\_\_\_\_  
 NOTE BOOK NO. \_\_\_\_\_  
 FILE NAME \_\_\_\_\_

DATE: \_\_\_\_\_ BY: \_\_\_\_\_  
 PROFILE  
 SURVEYED \_\_\_\_\_  
 GRADES CHECKED \_\_\_\_\_  
 NOTE BOOK NO. \_\_\_\_\_  
 FILE NAME \_\_\_\_\_