

STATE OF ILLINOIS  
DEPARTMENT OF TRANSPORTATION  
DIVISION OF HIGHWAYS

PLANS FOR PROPOSED  
FEDERAL AID HIGHWAY

FAU RTE 1548 (79th ST) & FAU RTE 2757 (ROBERTS RD)  
SIDEWALK CONSTRUCTION  
CORK AVE TO ROBERTS RD ON 79th ST  
79th ST TO I-294 TOLLWAY ON ROBERTS RD  
SECTION NO. 01-00024-00-SW  
PROJECT NO: CMM-9003(287)  
JOB NO: C-91-499-09  
VILLAGE OF JUSTICE  
COOK COUNTY

FAU RTEs.	SECTION	COUNTY	TOTAL SHEETS	SHEET NO.
1547, 2757	01-00024-00-SW	COOK	24	1
STA. 09+99		TO STA. 112+83		
FED. ROAD DIST. NO.	ILLINOIS	FED. AID PROJECT		
CONTRACT NO. 63441				



INDEX TO SHEETS:

SHEET NO.	DESCRIPTION
1.	COVER SHEET
2.	GENERAL NOTES
3.	SUMMARY OF QUANTITIES
4-6.	TYPICAL SECTIONS
7-15.	PLAN SHEETS
15.	SIGN INVENTORY
16-18.	EROSION AND SEDIMENT CONTROL PLANS
19.	EROSION AND SEDIMENT CONTROL NOTES
20.	STREET RETURN DETAILS, PIPE HANDRAIL DETAIL, RETAINING WALL DETAIL & HOT-MIX ASPHALT MIXTURE CHART
21.	DISTRICT 1 DETAIL-TC10-TRAFFIC CONTROL AND PROTECTION FOR SIDE ROADS
22.	DISTRICT 1 DETAIL-TC13-TYPICAL PAVEMENT MARKINGS
23-24.	CROSS-SECTIONS; ROBERTS ROAD R.O.W.

HIGHWAY STANDARDS:

STANDARD NO.	DESCRIPTION
000001-06:	STANDARD SYMBOLS, ABBREVIATIONS AND PATTERNS
280001-05:	TEMPORARY EROSION CONTROL SYSTEMS
424001-05:	CURB RAMPS FOR SIDEWALKS
604036-02:	GRATE TYPE B
606001-04:	CONCRETE CURB TYPE B AND COMBINATION CONCRETE CURB AND GUTTER
701606-07:	URBAN LANE CLOSURE, MULTILANE, 2W WITH MOUNTABLE MEDIAN
701801-04:	LANE CLOSURE, MULTILANE 1W OR 2W CROSSWALK OR SIDEWALK CLOSURE
701901-01:	TRAFFIC CONTROL DEVICES
780001-02:	TYPICAL PAVEMENT MARKINGS

ADT=32,500 (2006) 79th STREET  
=22,500 (2006) ROBERTS ROAD  
SPEED LIMIT=35 MPH (ROBERTS RD)  
=45 MPH (79th ST)  
DESIGN SPEED = 35 MPH (ROBERTS RD)  
=45 MPH (79th ST)

DESIGN DESIGNATION = MINOR ARTERIAL

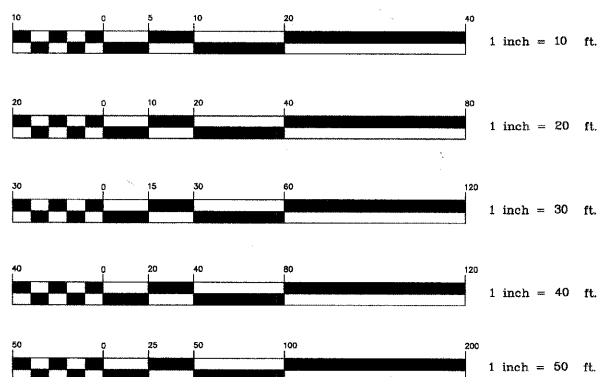

FULL SIZE PLANS HAVE BEEN PREPARED USING STANDARD ENGINEERING SCALES. REDUCED SIZED PLANS WILL NOT CONFORM TO STANDARD SCALES. IN MAKING MEASUREMENTS ON REDUCED PLANS, THE ABOVE SCALES MAY BE USED

J.U.L.I.E.  
JOINT UTILITY LOCATION FOR EXCAVATION  
1-800-892-0123 -OR- 811

CONTRACT NO. 63441

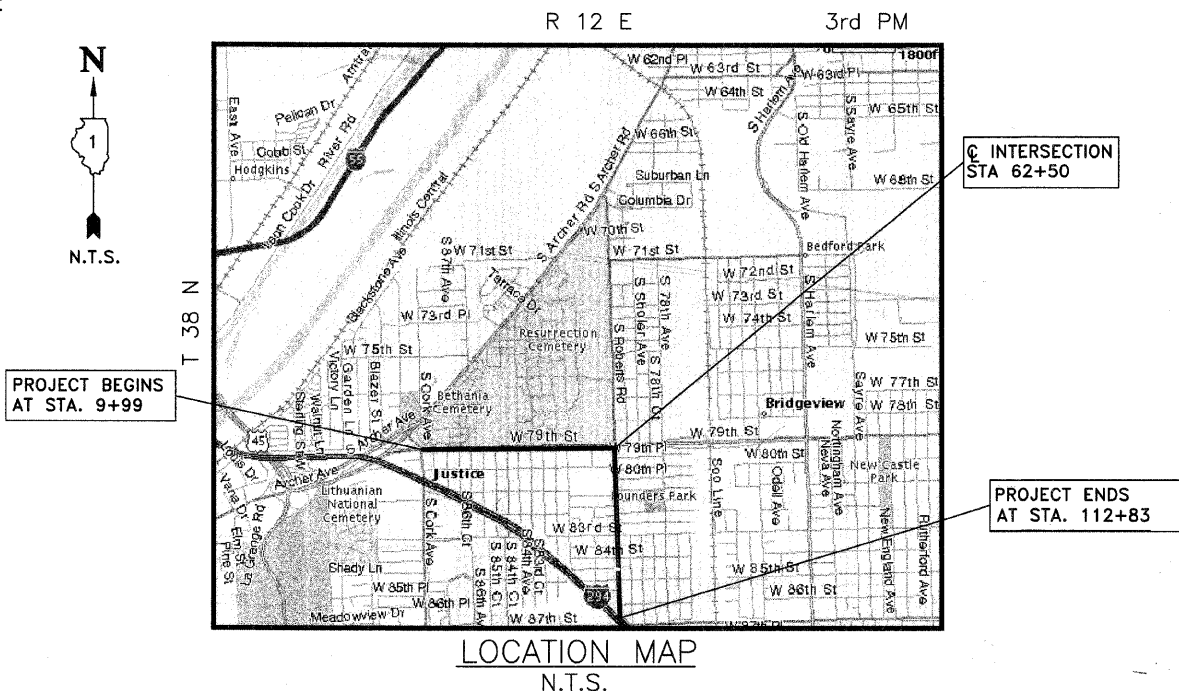

**hbe Hoeffler-Butler Engineering, Inc.**  
Consulting Civil Engineers - Land Surveyors  
PROFESSIONAL DESIGN FIRM LICENSE NO. 184-000819  
8714 S. ROBERTS ROAD HICKORY HILLS, ILLINOIS 60457  
(708) 599-8980 FAX (708) 599-8790

GROSS LENGTH OF PROJECT 10,284 FEET (1.95 MILES)  
NET LENGTH OF PROJECT 10,284 FEET (1.95 MILES)

STATE OF ILLINOIS  
DEPARTMENT OF TRANSPORTATION  
DIVISION OF HIGHWAYS

APPROVED 3-28 . 2011  
*[Signature]*  
VILLAGE OF JUSTICE PRESIDENT

PASSED APRIL 11 . 2011  
*[Signature]*  
DISTRICT ONE ENGINEER OF LOCAL ROADS & STREETS

RELEASING FOR BID  
BASED ON LIMITED  
REVIEW APRIL 11 . 2011  
*[Signature]*  
DEPUTY DIRECTOR OF HIGHWAYS, REGION ONE ENGINEER

**STEPHEN A. LEIBER**  
38352  
REGISTERED PROFESSIONAL ENGINEER  
OF ILLINOIS

*[Signature]*  
SIGNATURE  
3/28/11  
DATE

EXPIRES 11-30-11  
PRINTED BY AUTHORITY OF THE STATE OF ILLINOIS

PROGRAM AND OFFICE ENGINEER: CHARLES F. RIDDLER, PE 1-847-705-4406 SCHAUMBURG, IL  
CONSULTANT: HOEFFLER-BUTLER ENGINEERING, INC. 1-708-599-8980

HBE JOB# 09-705