

IMPROVEMENT BEGINS
STA. 45 + 41.72
Q/S = 25', LT.

IMPROVEMENT ENDS
STA. 57 + 92.92
Q/S = 84.70', LT.

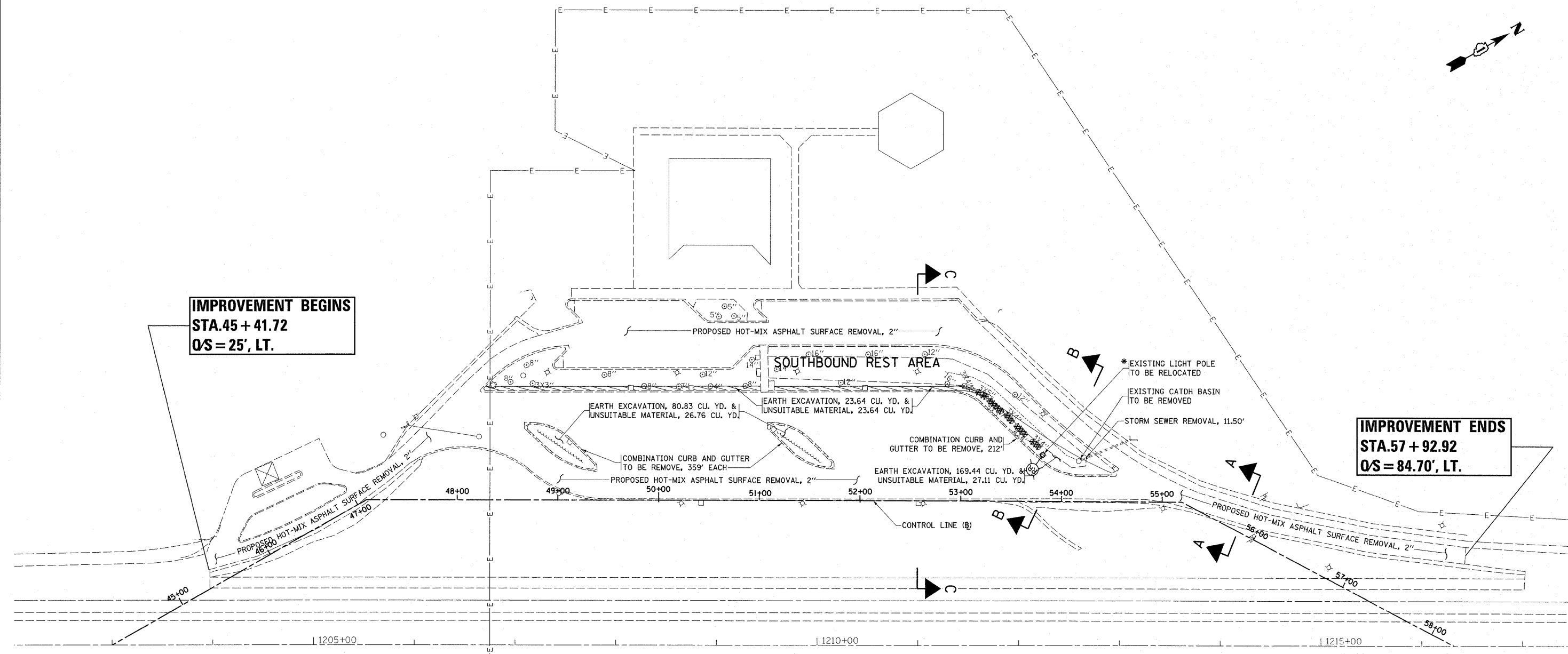

NORTHBOUND F.A.I. 57

* THE REMOVAL OF EXISTING LIGHT POLE FOUNDATION IS INCLUDED IN THE COST OF EARTH EXCAVATION.

FILE NAME =	USER NAME = Hamdanah	DESIGNED -	REVISED -
ca:\pwwork\pwwork\hamdanah\d0264490\shd\plan.dgn		DRAWN -	REVISED -
PLOT SCALE = 50.0000' / IN.		CHECKED -	REVISED -
PLOT DATE = 5/11/2011		DATE -	REVISED -

STATE OF ILLINOIS
DEPARTMENT OF TRANSPORTATION

I-57 AT PRARIE VIEW REST AREA IN PEOTONE
EXISTING PLAN (SOUTHBOUND REST AREA)

SCALE: SHEET NO. 2 OF 2 SHEETS STA. TO STA.

F.A.I. RTE. 57	SECTION 99-1-RA-WRS	COUNTY WILL	TOTAL SHEETS 14	SHEET NO. 7
			CONTRACT NO. 60P08	
ILLINOIS FED. AID PROJECT				