

AREA #1	
CLASS 2A SEEDING	CLASS 4 SEEDING
NITROGEN & POTASSIUM NUTRIENTS ONLY	NO NUTRIENTS
TOPSOIL	TOPSOIL
EROSION CONTROL BLANKET	EROSION CONTROL BLANKET



IL. RTE. 59
(SUTTON ROAD)

LIMIT OF IMPROVEMENT
STA. 90+25

LIMIT OF IMPROVEMENT
STA. 150+38.3

AREA #1

F&P OVERPASS
345 (US 20)

MATCHLINE STA. 101+00

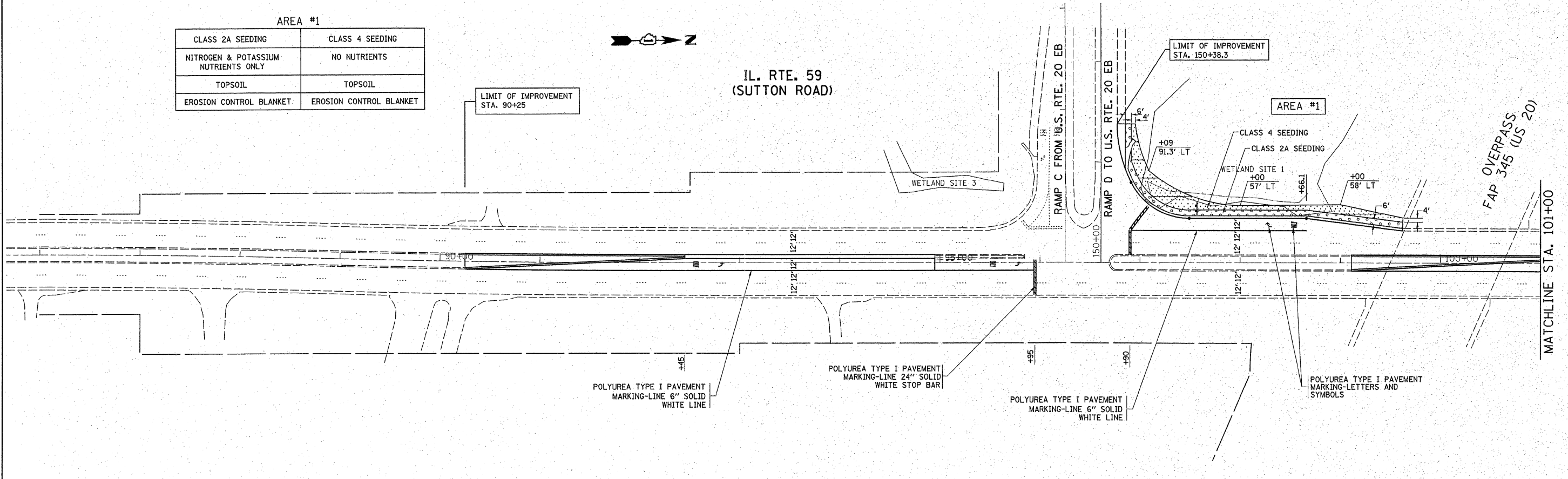

AREA #2	
CLASS 2A SEEDING	
NITROGEN, POTASSIUM AND PHOSPHORUS/NUTRIENTS	
TOPSOIL	
EROSION CONTROL BLANKET	

LIMIT OF IMPROVEMENT
STA. 1+38.3

IL. RTE. 59
(SUTTON ROAD)

LIMIT OF IMPROVEMENT
STA. 111+56.3



RED OAK DRIVE

RED OAK DRIVE

MATCHLINE STA. 101+00

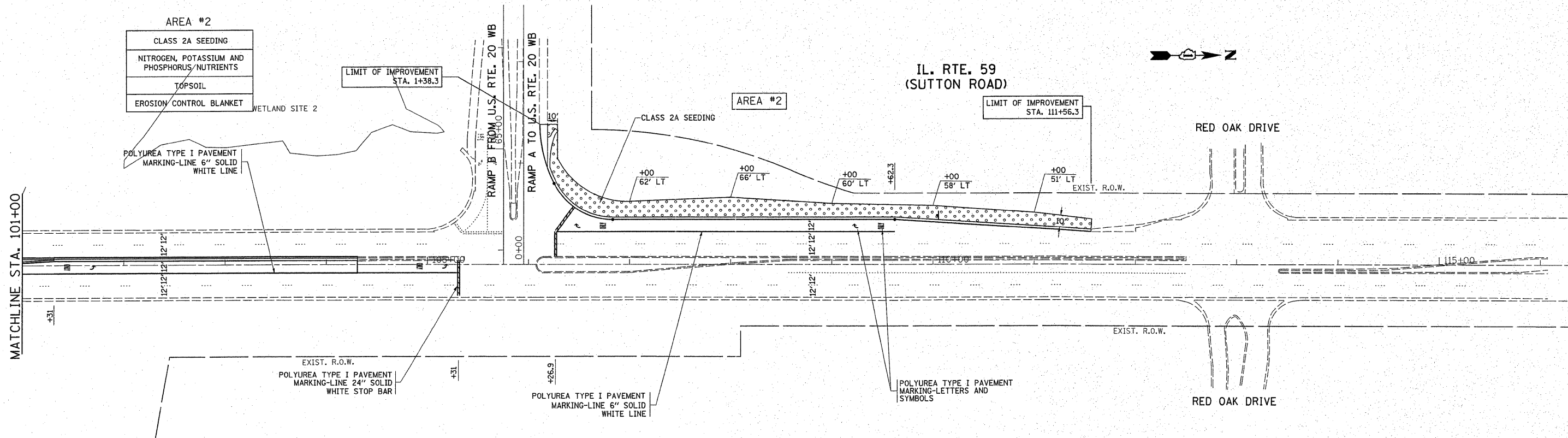

NOTE:

PROPOSED 15' EARTH SHELF AND DITCH/SWALE BETWEEN STA. 90+25 AND STA. 111+56 RT. SHALL FOLLOW SAME LANDSCAPING SCHEDULE AS AREA #2.

FILE NAME = c:\pwork\pwork\kellers\d0156271\p14239	USER NAME = kellers	DESIGNED -	REVISED - 3/16/11 SK	STATE OF ILLINOIS DEPARTMENT OF TRANSPORTATION	PAVEMENT MARKING AND LANDSCAPING PLAN IL. RTE. 59 AT U.S. RTE. 20			F.A.P. RTE. 338	SECTION 7 HB-K-N	COUNTY COOK	TOTAL SHEETS 82	SHEET NO. 34
	PLOT SCALE = 50.0000' / IN.	DRAWN -	REVISED -		SCALE: 1"=50'	SHEET NO. OF	SHEETS	STA. TO STA.	CONTRACT NO. 60K62			
	PLOT DATE = 3/16/2011	CHECKED -	REVISED -		ILLINOIS FED. AID PROJECT							
		DATE -	REVISED -									