

DATE	ISSUED	REVISION	BY	DATE	CHECKED
NOV 11 2011	NOV 11 2011	NOV 11 2011	COOK	177	100
WEST APPROACH PAVEMENT					

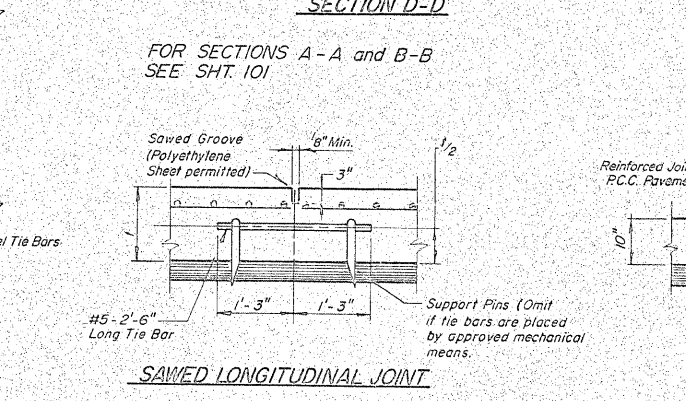

**WEST APPROACH
BILL OF MATERIAL**

BAR NUMBER	SIZE	LENGTH	SHAPE
A	3	27'-0"	
A1	24	119	27'-0"
A2	24	119	10'-0"
A3	24	119	31'-5"
A4	5	119	7'-0"
A5	72	119	32'-3"
B	20	119	23'-0"
B1	156	119	11'-0"
B2	33	119	19'-0"
B3	5	119	19'-0"
B4	14	119	10'-0"
B5	25	119	15'-0"
Bridge Approach Pavement			
Reinforcement Bars			
Sq. Yds. 1052.5			
Lbs. 27077			

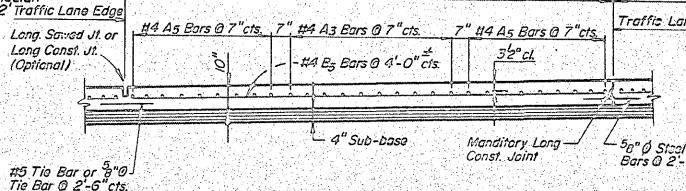
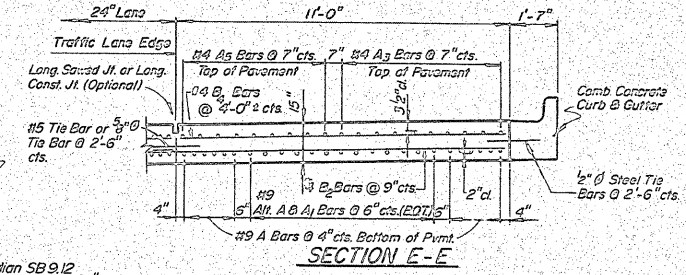
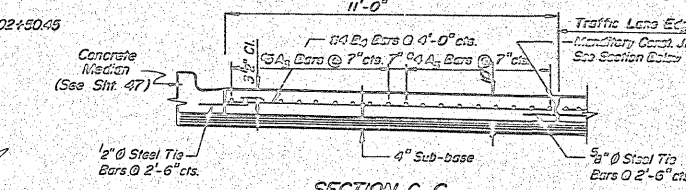
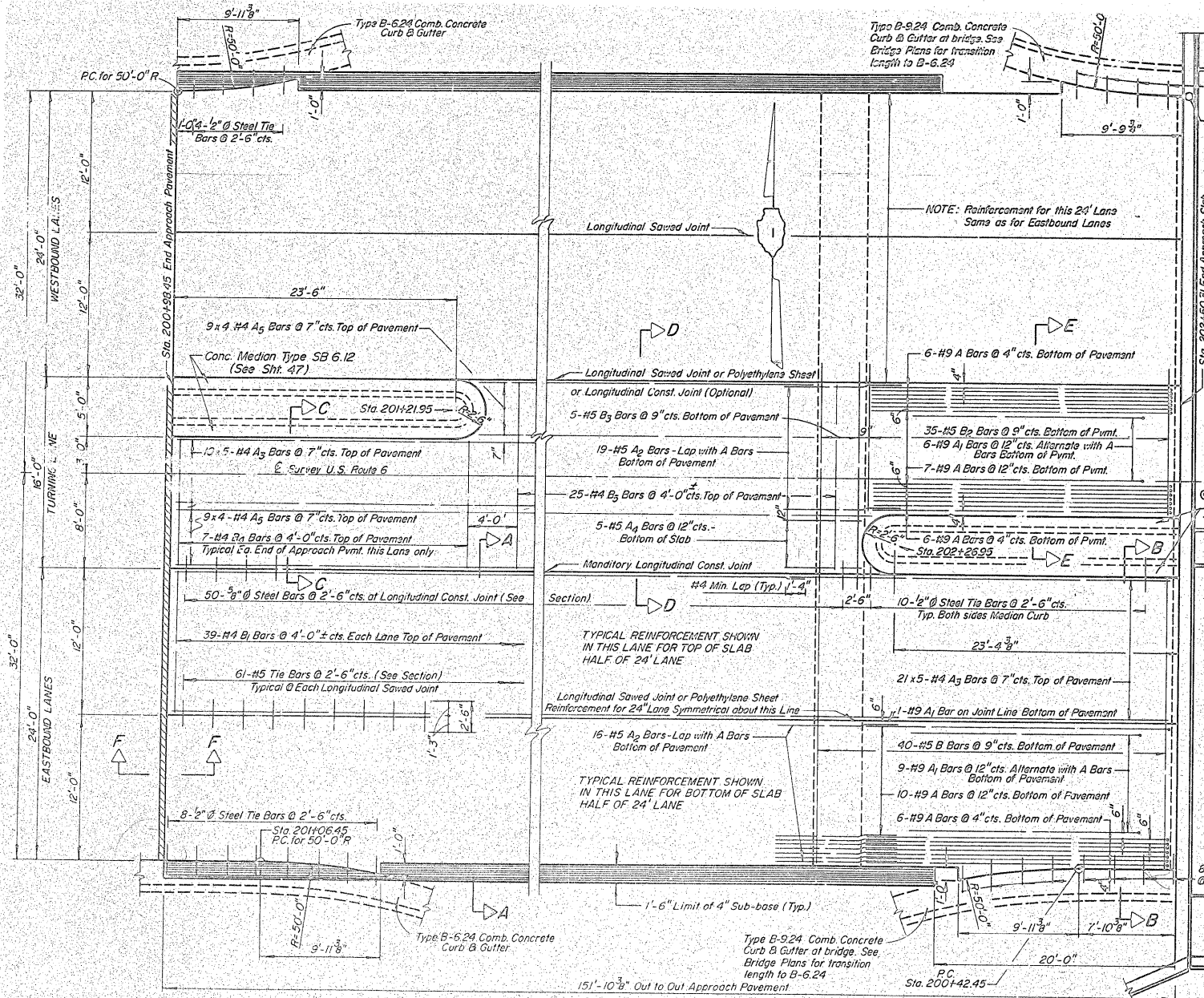
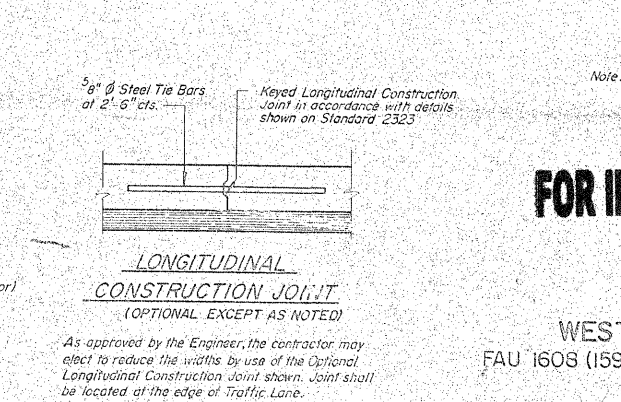
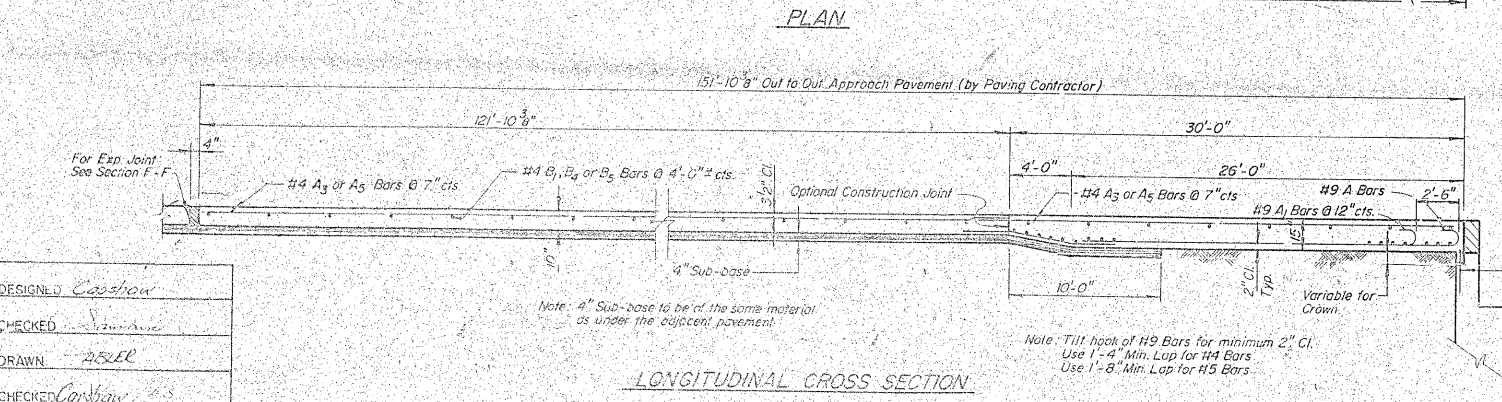
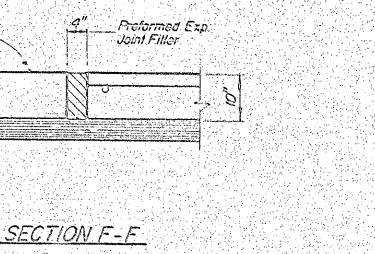
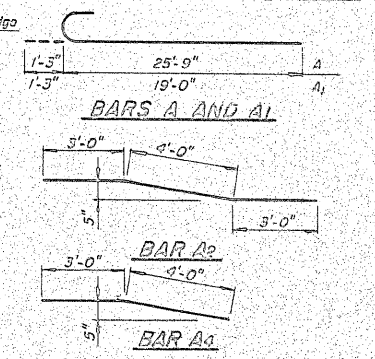

FOR INFORMATION ONLY

WEST APPROACH PAVEMENT
FAU 1608 (159th ST.) OVER LITTLE CALUMET RIVER
COOK COUNTY
SECTION 539-BY STATION 203+31.20

DESIGNED	COOK
CHECKED	COOK
DRAWN	COOK
CHECKED	COOK