

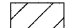

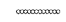

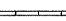

LEGEND

-  WORK AREA
-  IMPACT ATTENUATORS, TEMPORARY
-  TEMPORARY CONCRETE BARRIER
-  DRUM WITH STEADY BURN MONODIRECTIONAL LIGHT
-  DIRECTION INDICATOR BARRICADE WITH STEADY BURN MONODIRECTIONAL LIGHT
-  TYPE II BARRICADES
-  SIGN
-  ARROW BOARD
-  TYPE III BARRICADE

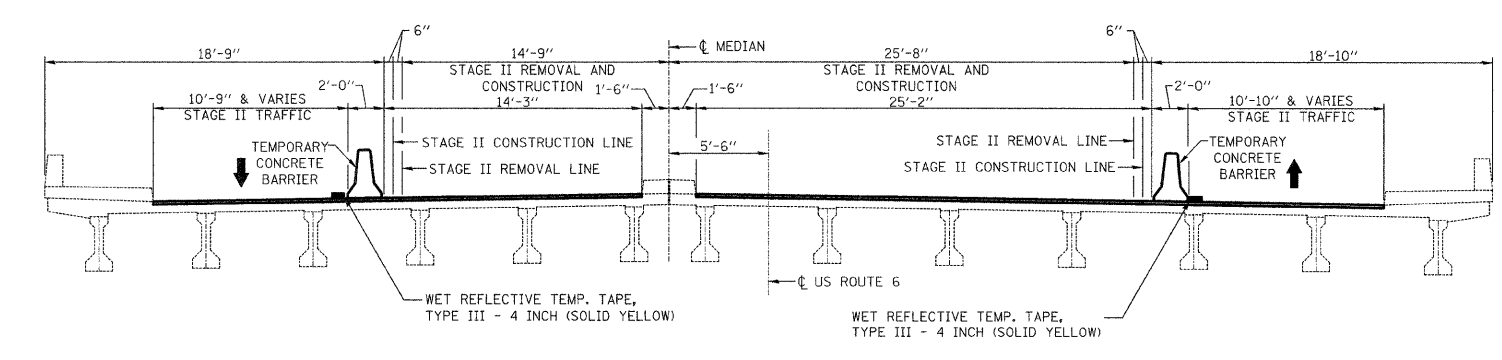
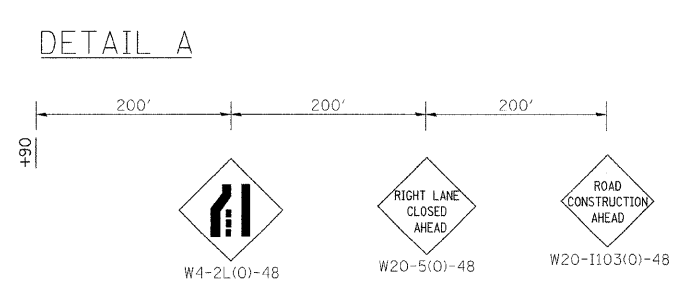
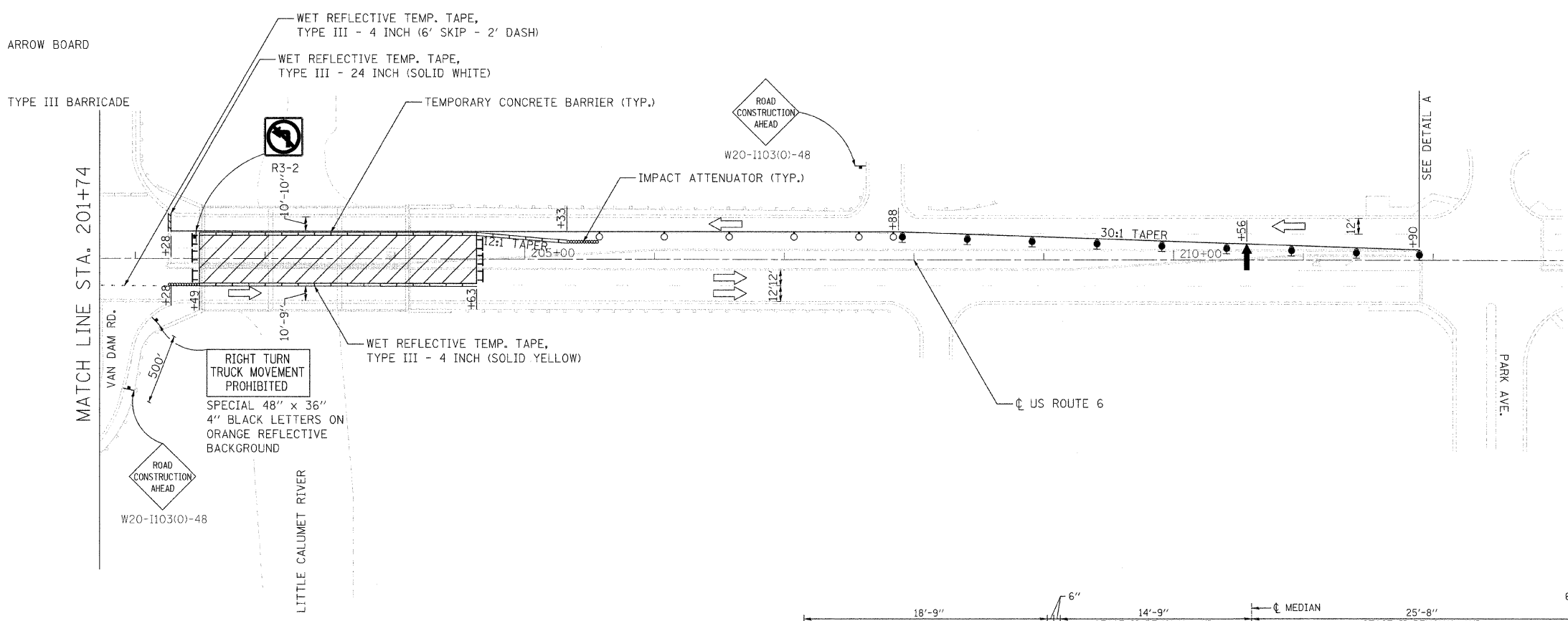
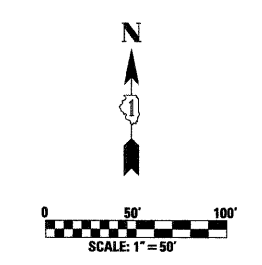

STAGE II MAINTENANCE OF TRAFFIC TYPICAL SECTION

(LOOKING WEST)
N.T.S.

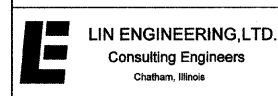

USER NAME = #USER#	DESIGNED - AS	REVISED -
PLOT SCALE = #SCALE#	DRAWN - AS	REVISED -
PLOT DATE = #DATE#	CHECKED - ST	REVISED -
	DATE - 04/2011	REVISED -

**STATE OF ILLINOIS
DEPARTMENT OF TRANSPORTATION**

**MAINTENANCE OF TRAFFIC - STAGE 2
US ROUTE 6 OVER LITTLE CALUMET RIVER**

SCALE: 1"=50' SHEET NO. 2 OF 2 SHEETS STA. 201+74 TO STA. 213+00

F.A.P. RTE.	SECTION	COUNTY	TOTAL SHEETS	SHEET NO.
351	539W-1-RS	COOK	56	20
CONTRACT NO. 60K57				
ILLINOIS FED. AID PROJECT				