

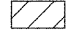

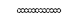

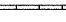

LEGEND

-  WORK AREA
-  IMPACT ATTENUATORS, TEMPORARY
-  TEMPORARY CONCRETE BARRIER
-  DRUM WITH STEADY BURN MONODIRECTIONAL LIGHT
-  DIRECTION INDICATOR BARRICADE WITH STEADY BURN MONODIRECTIONAL LIGHT
-  TYPE II BARRICADES
-  SIGN
-  ARROW BOARD
-  TYPE III BARRICADE



DETAIL A

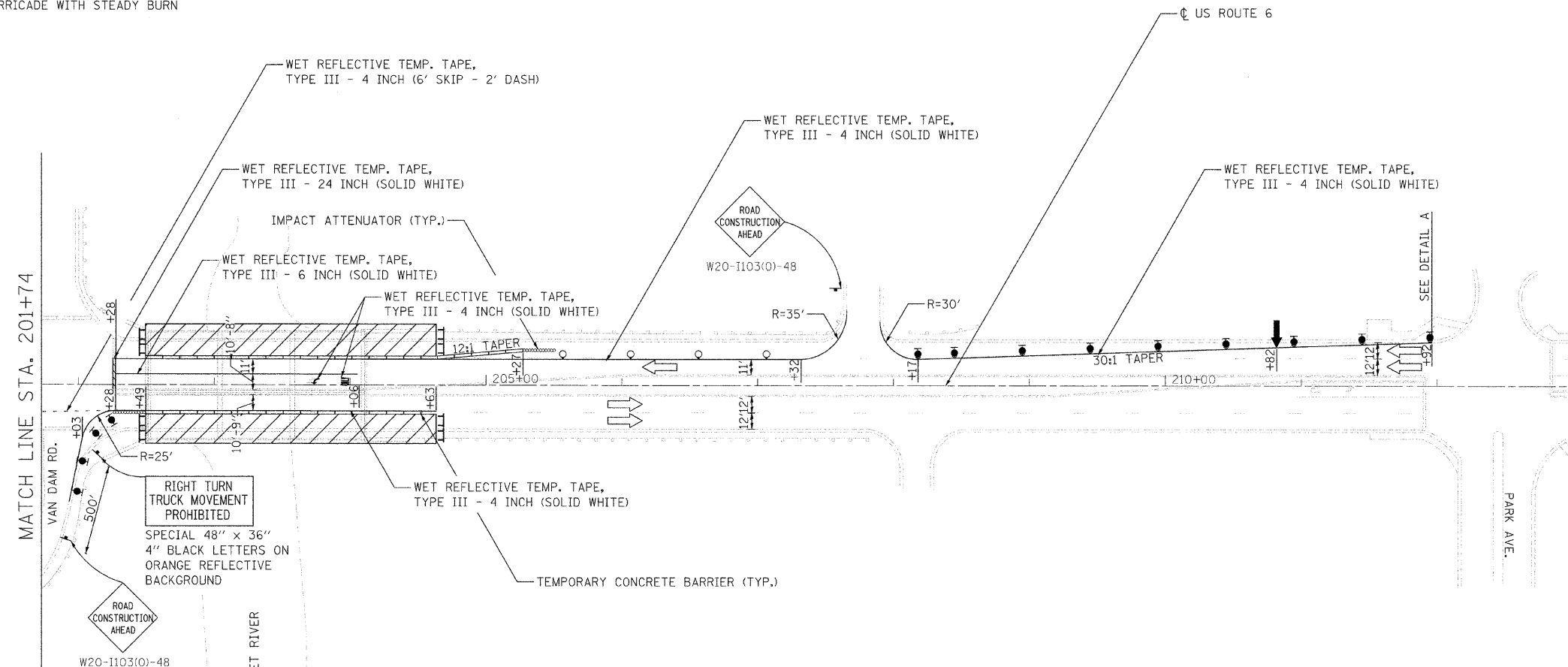
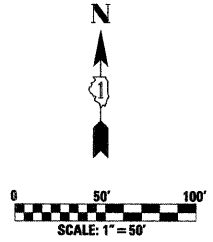
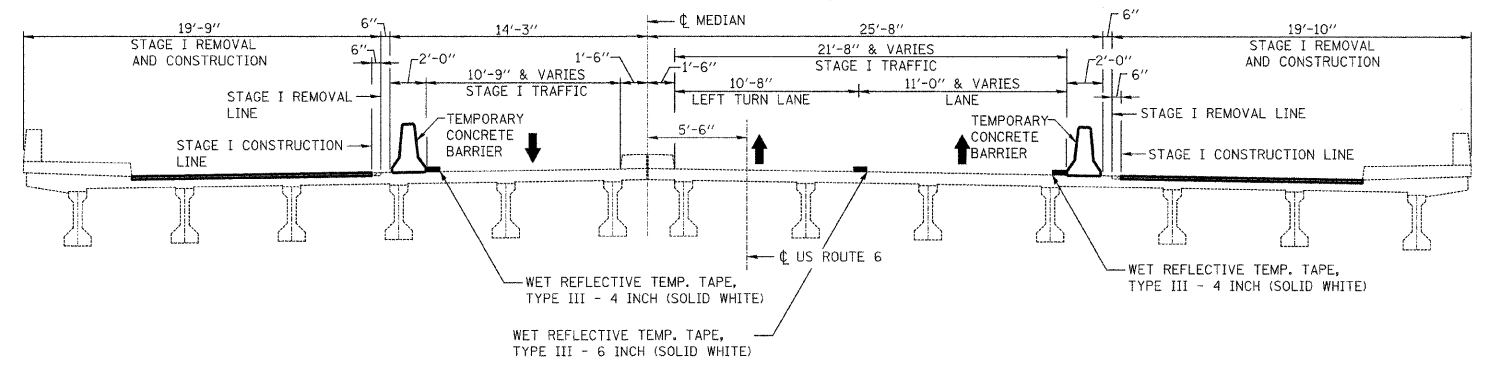
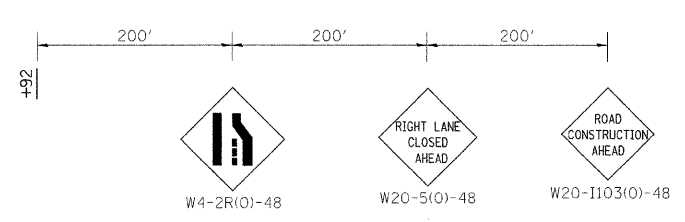

STAGE I MAINTENANCE OF TRAFFIC TYPICAL SECTION

(LOOKING WEST)
N.T.S.

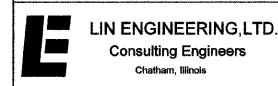

USER NAME = #USER#	DESIGNED - AS	REVISED -
PLOT SCALE = #SCALE#	DRAWN - AS	REVISED -
PLOT DATE = #DATE#	CHECKED - ST	REVISED -
	DATE - 04/2011	REVISED -

**STATE OF ILLINOIS
DEPARTMENT OF TRANSPORTATION**

MAINTENANCE OF TRAFFIC - STAGE 1 US ROUTE 6 OVER LITTLE CALUMET RIVER		
SCALE: 1"=50'	SHEET NO. 2 OF 2 SHEETS	STA. 201+74 TO STA. 213+00

F.A.P. RTE. 351	SECTION 539W-1-RS	COUNTY COOK	TOTAL SHEETS 56	SHEET NO. 18
				CONTRACT NO. 60K57
ILLINOIS FED. AID PROJECT				