

INDEX OF SHEETS

06-16-2023 LETTING ITEM 105

1. COVER SHEET
2. GENERAL NOTES, COMMITMENTS AND HIGHWAY STANDARDS
3. SUMMARY OF QUANTITIES
- 4-5. TYPICAL SECTIONS
6. SCHEDULE OF QUANTITIES
- 7-16. PLAN AND PROFILE
17. ENTRANCE SCHEDULE AND DETAILS
18. SIDEROAD SCHEDULE AND DETAILS

STATE OF ILLINOIS
DEPARTMENT OF TRANSPORTATION

PLANS FOR PROPOSED
FEDERAL AID HIGHWAY

STR/HSIP FUNDING

FAS 850 – FLORAVILLE ROAD – C.H. 2
FLORAVILLE ROAD RESURFACING
SECTION 20-00061-01-RS
PROJECT NO. NPGY(195)

COUNTY OF MONROE
JOB NO. C-98-022-24

F.A.S. RTE. 850 C.H. 2	SECTION 20-00061-01-RS	COUNTY MONROE	TOTAL SHEETS 18	SHEET NO. 1
ILLINOIS			CONTRACT NO. 97804	



LOCATION OF SECTION INDICATED THUS:

SCALES

PLAN 1" = 100'
PROFILE 1" = 10'

0 100 200 300



0 10 20 30



DESIGN CLASSIFICATION

ROAD CLASSIFICATION = MAJOR COLLECTOR
2019 ADT = 3100/1850 VPD
DESIGN SPEED: 50 MPH
POSTED SPEED: 55 MPH
LAFO DESIGN STANDARDS

UTILITIES

CALL J.U.L.I.E. BEFORE YOU DIG
800-892-0123

ELECTRIC:

AMEREN ILLINOIS
BELLEVILLE, IL 62221
(618) 236-4372

MONROE COUNTY ELECTRIC CO-OP
WATERLOO, IL 62298
(618) 939-7171

TELEPHONE:

HARRISONVILLE TELEPHONE COMPANY
WATERLOO, IL 62298
(618) 939-6112

FIBER OPTIC:

HARRISONVILLE TELEPHONE COMPANY
WATERLOO, IL 62298
(618) 939-6112

WATER:

FOUNTAIN WATER DISTRICT
VALMEYER, IL 62295
(618) 935-2121

GAS:

AMEREN ILLINOIS
BELLEVILLE, IL 62221
(618) 236-4372

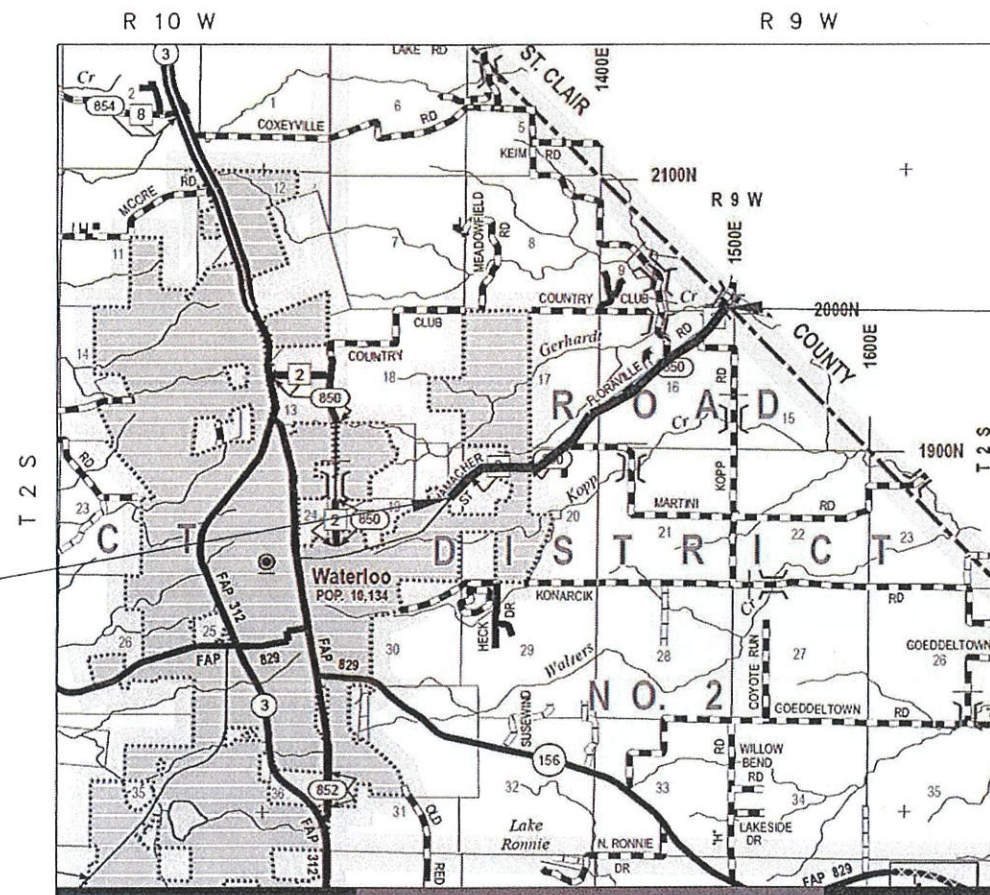

BEGIN PROJECT
STA. 0+00

END PROJECT
STA. 136+18

LOCATION MAP

GROSS LENGTH = 13618.00 FEET = 2.58 MILES
NET LENGTH = 13618.00 FEET = 2.58 MILES

DRAWN BY CASEY L CARNAHAN DATE 01/06/2023

CHECKED BY MARION W METZGER DATE 01/13/2023

062-055382
DESIGN CERTIFICATION
PROFESSIONAL
These plans were prepared by me or a full time member of my staff, under my personal supervision.
Date 3/17/23
County Engineer
Illinois Registered Professional Engineer No. 055382
Expiration Date: 11/30/23

STATE OF ILLINOIS
DEPARTMENT OF TRANSPORTATION

APPROVED March 17 20 23

Monroe County Engineer
Monroe County Highway Department

Passed April 5 20 23

District 8 Engineer
Local Roads and Streets

Released for Bid Based on Limited Review April 5 20 23

Region 5 Engineer

PRINTED BY THE AUTHORITY
OF THE STATE OF ILLINOIS

GENERAL NOTES

1. TRAFFIC CONTROL AND PROTECTION AND PROPER BARRICADES SHALL BE MAINTAINED BY THE CONTRACTOR.
2. THE CONTRACTOR WILL BE REQUIRED TO HAVE TWO FLAGGERS ON-SITE DURING ALL MAINLINE PAVING OPERATIONS.
3. THE CONTRACTOR IS RESPONSIBLE FOR CONTACTING THE MONROE COUNTY HIGHWAY DEPARTMENT AT LEAST 48 HOURS IN ADVANCE PRIOR TO COMMENCEMENT OF ANY CONSTRUCTION ACTIVITIES OR WORK REQUIRING INSPECTION OR APPROVAL.
4. USE ALL FLUORESCENT ORANGE 48" CONSTRUCTION SIGNS.
5. NO OVERNIGHT LANE CLOSURES WILL BE ALLOWED ON THIS PROJECT.
6. FACTORS USED FOR QUANTITY CALCULATIONS ARE AS FOLLOWS:
 ALL HOT-MIX ASPHALT - 112.0 LBS/SQ YD PER 1" THICKNESS
 ALL BITUMINOUS MATERIALS (TACK COAT) - 0.05 LB/SQ FT
7. THE THICKNESS OF THE BITUMINOUS MIXTURE SHOWN ON THE PLANS IS THE NOMINAL THICKNESS, DEVIATIONS FROM THE NOMINAL THICKNESS WILL BE PERMITTED, AS APPROVED BY THE ENGINEER, WHEN SUCH DEVIATIONS OCCUR DUE TO IRREGULARITIES IN THE EXISTING SURFACE OR BASE ON WHICH THE BITUMINOUS MIXTURE IS PLACED.
8. ACCESS SHALL BE PROVIDED TO/FROM PRIVATE ENTRANCES AT ALL LOCATIONS DURING ALL STAGES.
9. ALL EXCAVATION ADJACENT TO THE EDGE OF PAVEMENT SHALL BE PROTECTED BY TYPE 1 OR 2 BARRICADES
10. SEEDING IS NOT ANTICIPATED, ANY AREA DISTURBED OUTSIDE THE CONSTRUCTION LIMITS DURING CONSTRUCTION SHALL BE RESTORED TO ITS ORIGINAL CONDITION AT THE CONTRACTORS EXPENSE.
11. NO WORK WILL BE PERFORMED ON MAILBOX TURNOUTS BEYOND THE NEW 3 FOOT HMA SHOULDER.
12. HOT-MIX ASPHALT SHOULDERS SHALL BE 8" THICK ACROSS ENTRANCES AS DIRECTED BY THE ENGINEER.
13. ALL SHORT TERM PAVEMENT MARKINGS WILL BE PLACED IN SUCH A MANNER SO AS NOT TO INTERFERE WITH THE PLACEMENT OF PERMANENT PAVEMENT MARKINGS.
14. THERMOPLASTIC PAVEMENT MARKINGS SHALL MATCH EXISTING EXCEPT WHERE INDICATED ON THE PLANS AND AS DIRECTED BY THE ENGINEER.

HIGHWAY STANDARDS

STANDARD SYMBOLS	000001-08
HMA SHOULDER	482001-02
TRAFFIC CONTROL	701201-05 701301-04 701306-04 701311-03 701326-04 701901-08
RUMBLE STRIP	642006-01
PAVEMENT MARKING	780001-05 781001-04

SALVAGE: ASPHALT MILLINGS - SEE SPECIAL PROVISIONS

COMMITMENTS: NONE

HOT-MIX ASPHALT MIXTURE REQUIREMENTS				
LOCATIONS	ALL			
MIXTURE USE	SURFACE	SHOULDER BASE	SHOULDER SURFACE	INCIDENTAL
AC/PG	PG 64-22	PG 64-22	PG 64-22	PG 64-22
DESIGN AIR VOIDS	4.0% @ Ndes =70	4.0% @ Ndes= 30	4.0% @ Ndes=30	4.0% @ Ndes=70
MIXTURE COMPOSITION (GRADATION MIXTURE)	IL-9.5	IL 19.0 L	IL 9.5 L	IL-9.5
FRICTION AGGREGATE	MIXTURE D	MIXTURE C	MIXTURE C	MIXTURE D
MIXTURE WEIGHT	112.0 LB/SQ YD/IN	112.0 LB/SQ YD/IN	112.0 LB/SQ YD/IN	112.0 LB/SQ YD/IN
QUALITY MANAGEMENT PROGRAM	QC/QA	QC/QA	QC/QA	QC/QA
SUBLOT SIZE	N/A	N/A	N/A	N/A
MATERIAL TRANSFER DEVICE	NO	NO	NO	NO

DRAWING FILE: S:\Floresville Road\COVER

USER NAME =	DESIGNED -	REVISED -
	DRAWN -	REVISED -
PLOT SCALE = 100,000' / in.	CHECKED -	REVISED -
PLOT DATE =	DATE -	REVISED -

MONROE COUNTY
HIGHWAY DEPARTMENT

GENERAL NOTES, COMMITMENTS AND HIGHWAY STANDARDS

SCALE: NA SHEET 1 OF 1 SHEETS STA. TO STA.

F.A.S. RTE. 850 C.H.2	SECTION 20-00061-01-RS	COUNTY MONROE	TOTAL SHEETS 18	SHEET NO. 2
CONTRACT NO. 97804			ILLINOIS FED. AID PROJECT	

SUMMARY OF QUANTITIES				0005	0021
CODE	ITEM	UNIT	TOTAL QUANTITY	CONSTR. CODE	CONSTR. CODE
				80% FED 20% LOCAL	90% FED 10% LOCAL
				ROADWAY	ROADWAY
				STR	HSIP
				RURAL	RURAL
20200600	EXCAVATING AND GRADING EXISTING SHOULDER	UNIT	251	251	
40600290	BITUMINOUS MATERIALS (TACK COAT)	POUND	15690	15690	
40600370	LONGITUDINAL JOINT SEALANT	FOOT	13618	13618	
40600982	HOT-MIX ASPHALT SURFACE REMOVAL - BUTT JOINT	SQ YD	350	350	
40604062	HOT-MIX ASPHALT SURFACE COURSE, IL-9.5 MIX "D" N70	TON	3728	3728	
40800050	INCIDENTAL HOT-MIX ASPHALT SURFACING	TON	50	50	
44000155	HOT-MIX ASPHALT SURFACE REMOVAL, 1 1/2"	SQ YD	33288	33288	
48203100	HOT-MIX ASPHALT SHOULDERS	TON	3055		3055
64200108	SHOULDER RUMBLE STRIP, 8 INCH	FOOT	22870		22870
67100100	MOBILIZATION	L SUM	1	1	
70300100	SHORT TERM PAVEMENT MARKING	FOOT	2530	2530	
70300150	SHORT TERM PAVEMENT MARKING REMOVAL	SQ FT	843	843	
70300221	TEMPORARY PAVEMENT MARKING - LINE 4" - PAINT	FOOT	50035	50035	
* 78000200	THERMOPLASTIC PAVEMENT MARKING - LINE 4"	FOOT	50035	50035	
* 78100100	RAISED REFLECTIVE PAVEMENT MARKER	EACH	170		170
78300201	PAVEMENT MARKING REMOVAL - GRINDING	SQ FT	16678	16678	
X0326440	SURFACE REMOVAL VARIABLE DEPTH (SPECIAL)	SQ YD	1588	1588	
# Z0076600	TRAINEES	hour	500		
X7010216	TRAFFIC CONTROL AND PROTECTION (SPECIAL)	L SUM	1	1	
# Z0076604	TRAINEES TRAINING PROGRAM GRADUATE	hour	500		

* SPECIALTY ITEMS

0042

DRAWING FILE: S:\Florence Road\COVER

USER NAME -	DESIGNED -	REVISED -
	DRAWN -	REVISED -
PLOT SCALE = 100.000' / in.	CHECKED -	REVISED -
PLOT DATE -	DATE -	REVISED -

MONROE COUNTY
HIGHWAY DEPARTMENT

SUMMARY OF QUANTITIES

SCALE: NA SHEET 1 OF 1 SHEETS STA. TO STA.

F.A.S. RTE. 850 C.H.2	SECTION 20-00061-01-RS	COUNTY MONROE	TOTAL SHEETS 18	SHEET NO. 3
CONTRACT NO. 97804			ILLINOIS FED. AID PROJECT	

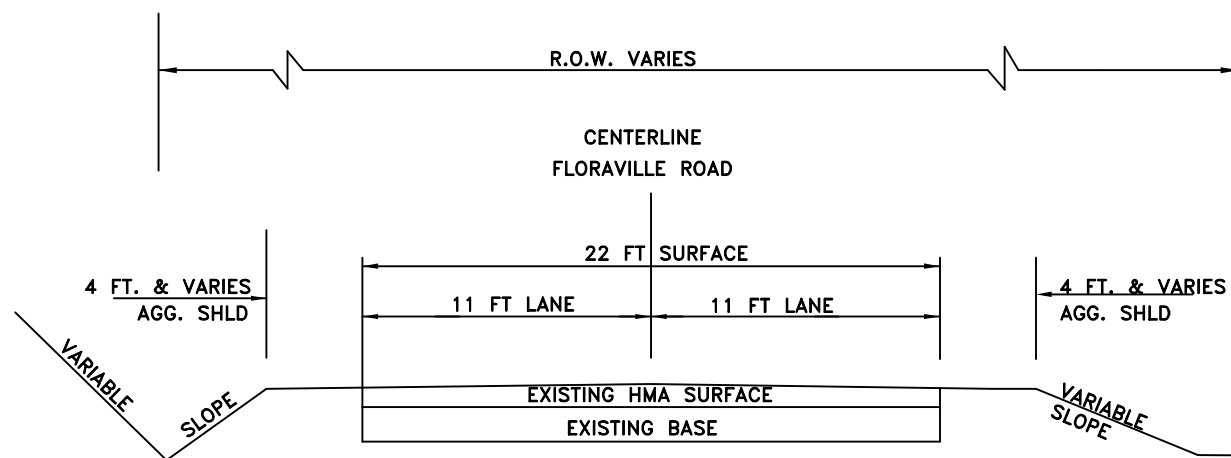

EXISTING TYPICAL SECTION
 STA. 0+00 TO STA. 26+39
 STA. 36+51 TO STA. 96+37
 STA. 108+23 TO STA. 136+18

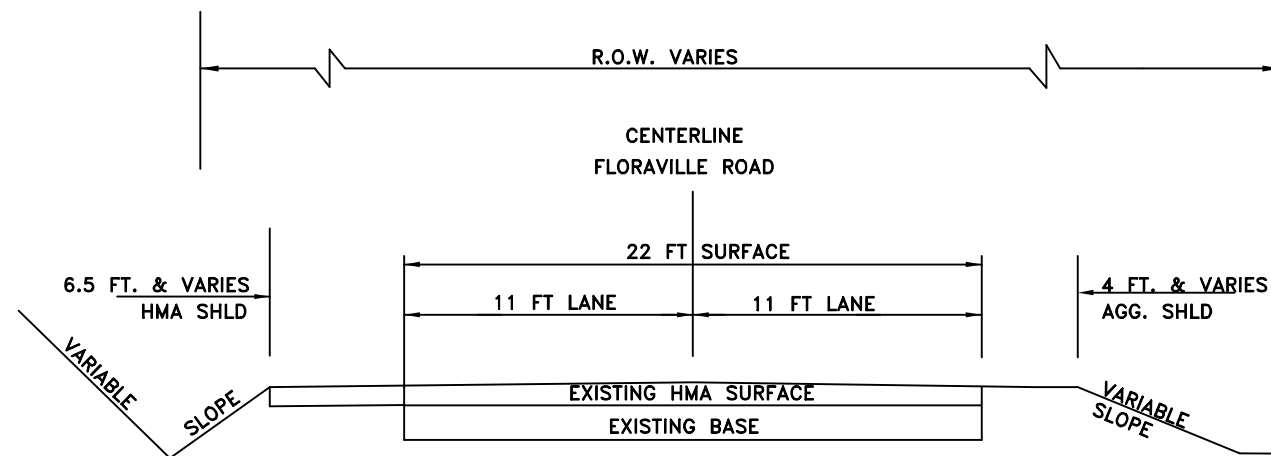

EXISTING TYPICAL SECTION
 STA. 26+39 TO STA. 36+51
 STA. 96+37 TO STA. 108+23

DRAWING FILE: S:\Floraville Road\COVER

USER NAME =	DESIGNED -	REVISED -
	DRAWN -	REVISED -
PLOT SCALE = 100.000' / in.	CHECKED -	REVISED -
PLOT DATE =	DATE -	REVISED -

MONROE COUNTY
HIGHWAY DEPARTMENT

TYPICAL SECTIONS

SCALE: NA SHEET 1 OF 2 SHEETS STA. TO STA.

F.A.S. RTE. 850 C.H.2	SECTION 20-00061-01-RS	COUNTY MONROE	TOTAL SHEETS 18	SHEET NO. 4
CONTRACT NO. 97804			ILLINOIS FED. AID PROJECT	

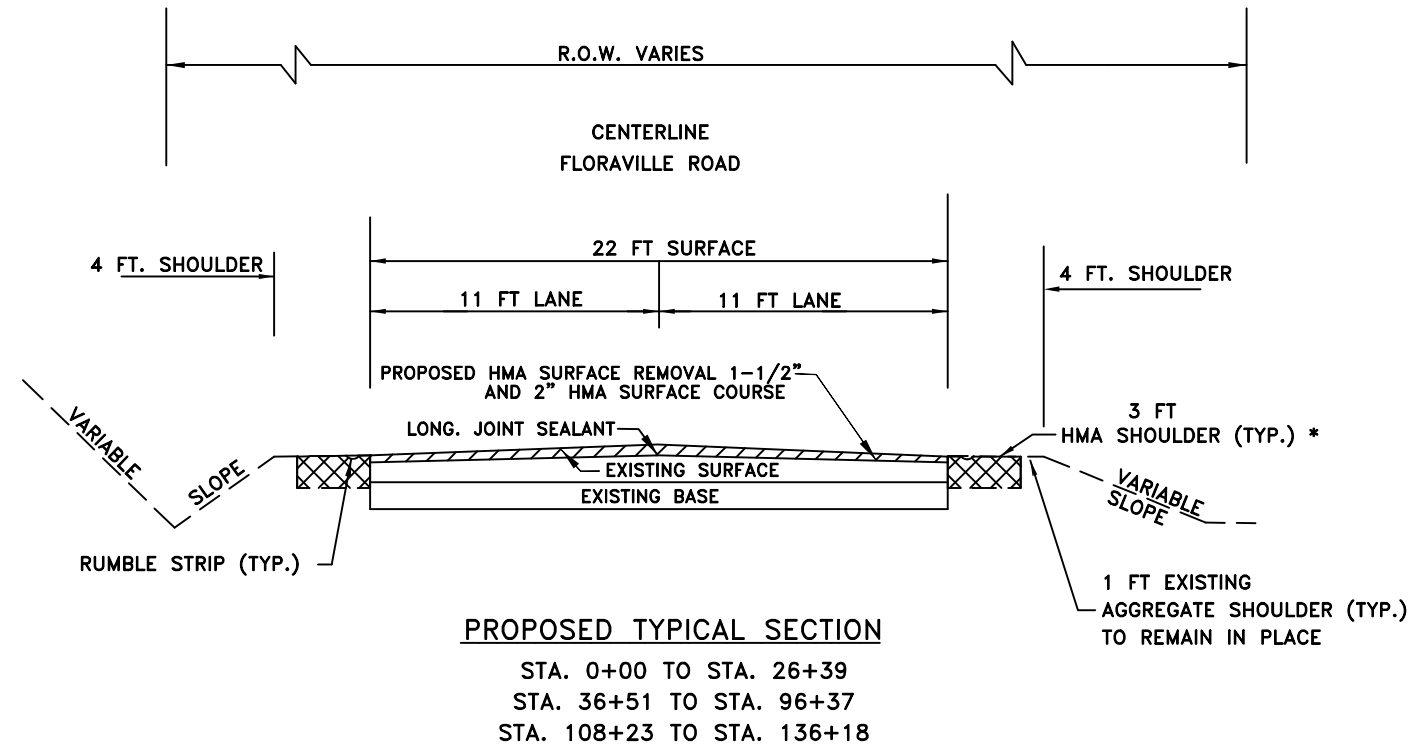

* HMA SHOULDER (TYP.)
 SHALL BE PLACED IN 2 LIFTS
 SURFACE LIFT SHALL BE 2" THICK
 BASE LIFT WILL BE 4-6" THICK BASED ON
 LOCATION AS DIRECTED BY THE ENGINEER

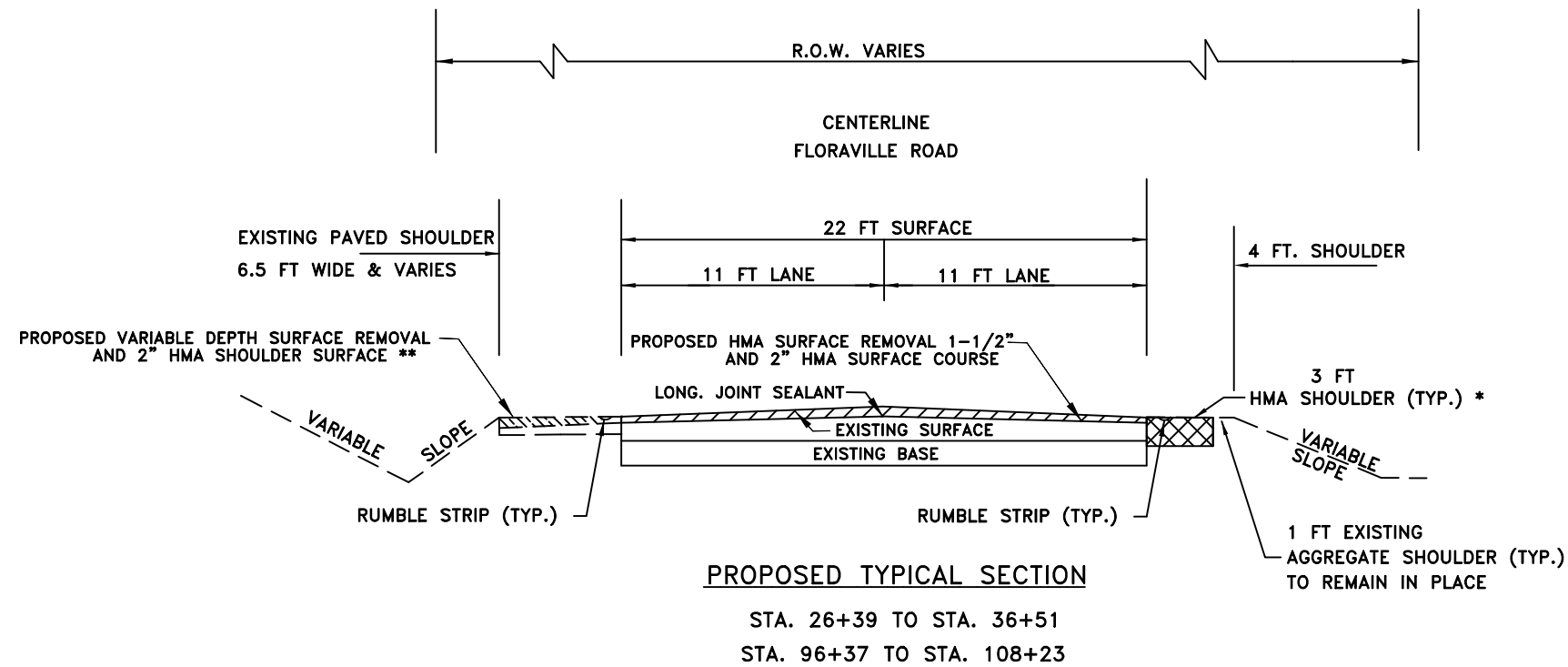

** VARIABLE DEPTH SURFACE REMOVAL WILL BE AT A DEPTH OF 1 1/2" AT THE EDGE OF PAVEMENT AND 2" AT THE EDGE OF SHOULDER AND CARRY THROUGH ENTRANCES AND SIDEROADS AS DIRECTED BY THE ENGINEER AND PAVED WITH 2" HMA SHOULDER SURFACE.

DRAWING FILE: S:\Floraville Road\COVER

USER NAME =	DESIGNED -	REVISED -
	DRAWN -	REVISED -
PLOT SCALE = 100,000' / in.	CHECKED -	REVISED -
PLOT DATE =	DATE -	REVISED -

MONROE COUNTY
 HIGHWAY DEPARTMENT

TYPICAL SECTIONS

SCALE: NA SHEET 2 OF 2 SHEETS STA. TO STA.

F.A.S. RTE.	SECTION	COUNTY	TOTAL SHEETS	SHEET NO.
850 C.H.2	20-00061-01-RS	MONROE	18	5
CONTRACT NO. 97804			ILLINOIS FED. AID PROJECT	

HOT-MIX ASPHALT QUANTITIES									
LOCATION	EXCAVATING AND GRADING EXISTING SHOULDER *	HMA SURFACE REMOVAL 1 1/2"	SURFACE REMOVAL VARIABLE DEPTH	HMA REMOVAL BUTT-JOINT	BITUMINOUS MATERIALS (TACK COAT)	LONGITUDINAL JOINT SEALANT	HMA SURFACE COURSE MIX "D" N70	HMA SHOULDER	INCIDENTAL HMA SURFACING
	UNIT	SQ YD	SQ YD	SQ YD	LB	FT	TON	TON	TON
STA. 0+00 - STA. 26+39	53	6451		49	2902	2639	722	599	
STA.26+39 - STA. 36+51	10	2474	731		1440	1012	277	197	
STA.36+51 - STA. 96+37	120	14632		157	6584	5986	1639	1385	30
STA. 96+37 - STA. 108+23	12	2899	857		1690	1186	325	237	
STA. 108+23 - STA. 136+18	56	6832		144	3074	2795	765	637	20
TOTAL	251	33288	1588	350	15690	13618	3728	3055	50

*ALL EXCESS MATERIAL EXCAVATED SHALL BECOME PROPERTY OF THE CONTRACTOR. THE COST FOR HAULING AND DISPOSAL OF EXCESS MATERIAL SHALL BE INCLUDED IN THE COST OF EXCAVATING AND GRADING EXISTING SHOULDER.

PAVEMENT MARKING QUANTITIES													
LOCATION	SHORT TERM PAVEMENT MARKING FOOT	SHORT TERM PAVEMENT MARKING REMOVAL SQUARE FOOT	TEMPORARY PAVEMENT MARKING - LINE 4" - PAINT				THERMOPLASTIC PAVEMENT MARKING - LINE 4"				RAISED REFLECTIVE PAVEMENT MARKERS 2-WAY AMBER EACH	SHOULDER RUMBLE STRIP 8 INCH FOOT	PAVEMENT MARKING REMOVAL - GRINDING SQUARE FOOT
			YELLOW SKIP-DASH FOOT	YELLOW SOLID FOOT	WHITE SOLID FOOT	WHITE SKIP-DASH FOOT	YELLOW SKIP-DASH FOOT	YELLOW SOLID FOOT	WHITE SOLID FOOT	WHITE SKIP-DASH FOOT			
STA. 0+00 TO STA. 3+01	54	18	70		602		70		602		4	532	224
STA. 3+01 TO STA. 77+12	1402	468		14822	14502	74		14822	14502	74	93	12512	9799
STA. 77+12 TO STA. 96+43	352	117	490	1931	3862		490	1931	3862		24	3592	2094
STA.96+43 TO STA. 99+99	64	21	90		626	20	90		626	20	4	586	245
STA. 99+99 TO STA.118+33	334	111	460	1834	3548	30	460	1834	3548	30	23	2328	1957
STA. 118+33 TO STA.136+18	324	108		3570	3484	20		3570	3484	20	22	3320	2358
SUBTOTAL			1110	22157	26624	144	1110	22157	26624	144			
TOTAL	2530	843	50035				50035				170	22870	16678

DRAWING FILE: S:\Florenceville Road\COVER

USER NAME =	DESIGNED -	REVISED -	MONROE COUNTY HIGHWAY DEPARTMENT	SCHEDULE OF QUANTITIES				F.A.S. RTE. 850 C.H.2	SECTION 20-00061-01-RS	COUNTY MONROE	TOTAL SHEETS 18	SHEET NO. 6
PLOT SCALE = 100,000' / in.	DRAWN -	REVISED -						SCALE: NA				CONTRACT NO. 97804
PLOT DATE =	CHECKED -	REVISED -		SHEET 1 OF 1 SHEETS				ILLINOIS FED. AID PROJECT				
	DATE -	REVISED -		STA. TO STA.								

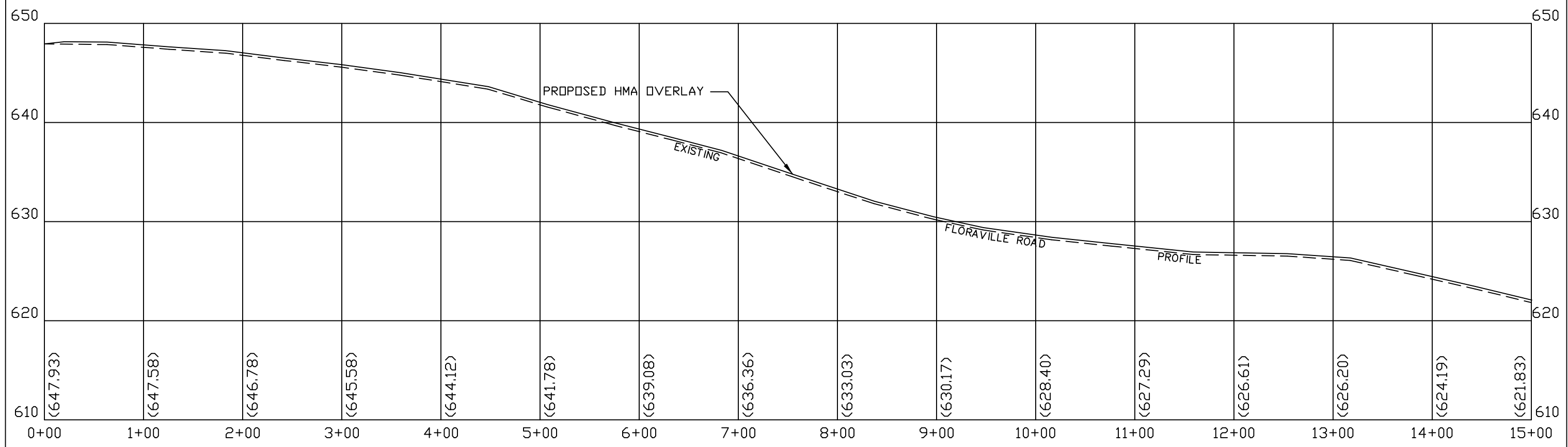
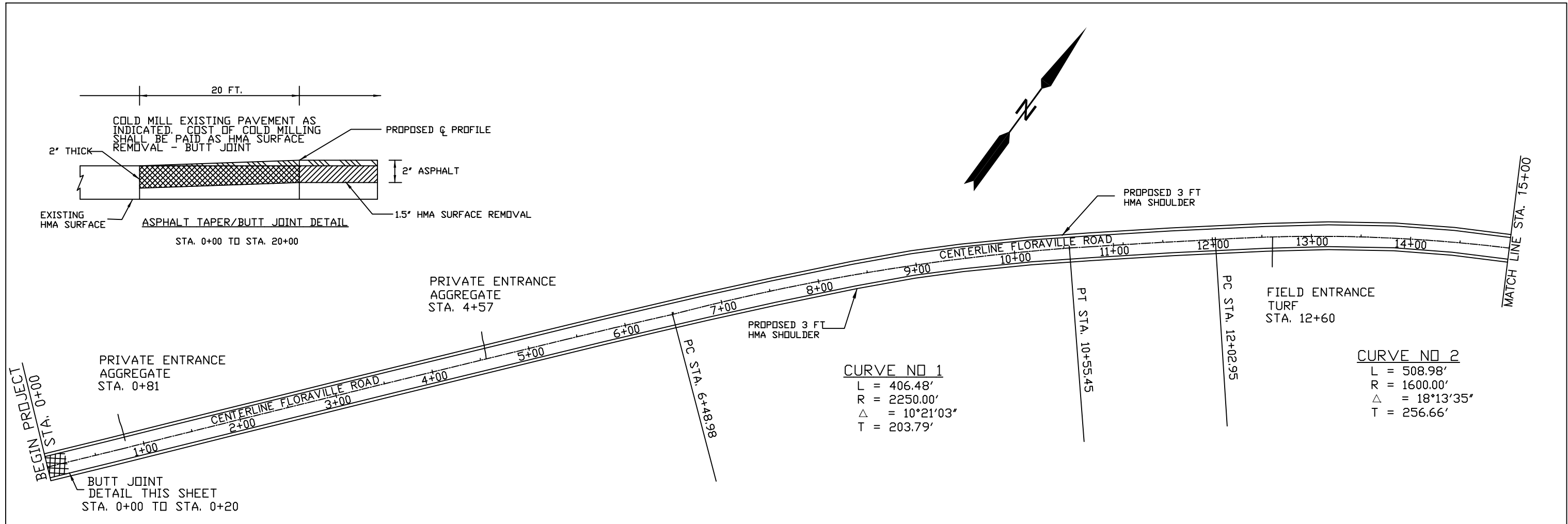

USER NAME =	DESIGNED -	REVISED -	MONROE COUNTY HIGHWAY DEPARTMENT	PLAN AND PROFILE		F.A. RTE. 850	SECTION 20-00061-01-RS	COUNTY MONROE	TOTAL SHEETS 18	SHEET NO. 7
PLLOT SCALE =	DRAWN -	REVISED -		SCALE: 1" = 100'	SHEET 1 OF 10 SHEETS	STA. 0+00 TO STA. 15+00	CONTRACT NO. 97804		ILLINOIS FED. AID PROJECT	
PLLOT DATE =	CHECKED -	REVISED -								
	DATE -	REVISED -								



CURVE NO 4
 L = 350.06'
 R = 2100.00'
 Δ = 9°33'03"
 T = 175.43'

PRIVATE ENTRANCE
 OIL & CHIP
 STA. 23+57

PRIVATE ENTRANCE
 AGGREGATE/ASPHALT
 STA. 26+65

PRIVATE ENTRANCE
 AGGREGATE
 STA. 23+75

CURVE NO 3
 L = 502.38'
 R = 1100.00'
 Δ = 26°10'03"
 T = 255.65'

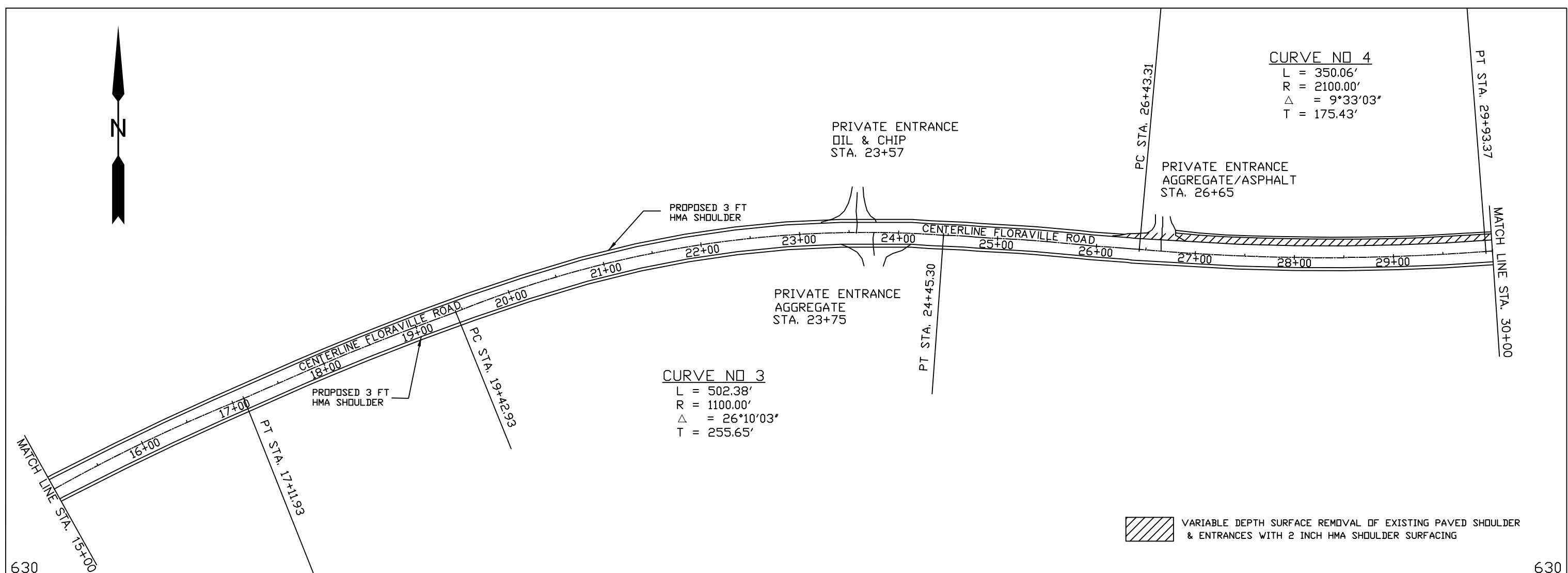

VARIABLE DEPTH SURFACE REMOVAL OF EXISTING PAVED SHOULDER & ENTRANCES WITH 2 INCH HMA SHOULDER SURFACING

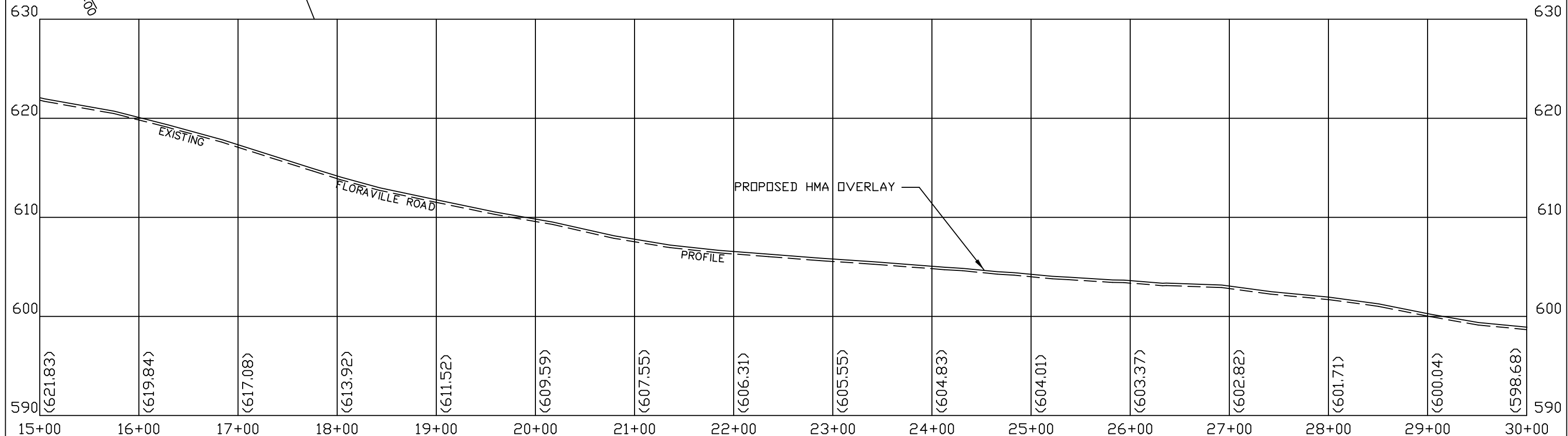

USER NAME = DRAWN - CHECKED - DATE -	DESIGNED - REVISIONS - REVISIONS - REVISIONS - REVISIONS -	MONROE COUNTY HIGHWAY DEPARTMENT	PLAN AND PROFILE SCALE: 1" = 100' SHEET 2 OF 10 SHEETS STA. 15+00 TO STA. 30+00	F.A. RTE. 850 C.H. 2	SECTION 20-00061-01-RS COUNTY MONROE CONTRACT NO. 97804	TOTAL SHEETS 18 SHEET NO. 8 ILLINOIS FED. AID PROJECT
---	--	--	---	-------------------------	---	---

CURVE NO 5
 L = 665.21'
 R = 1500.00'
 Δ = 25°24'33"
 T = 338.17'

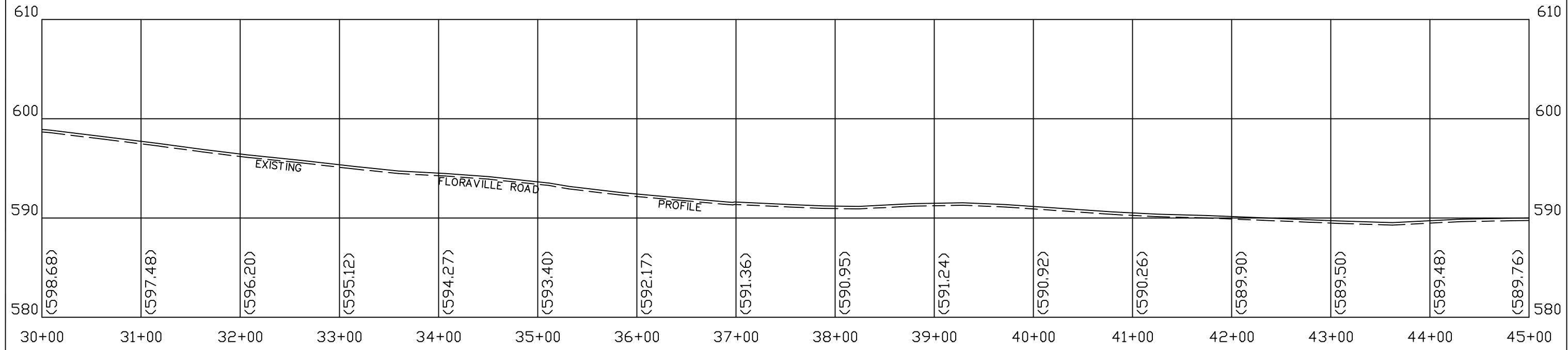
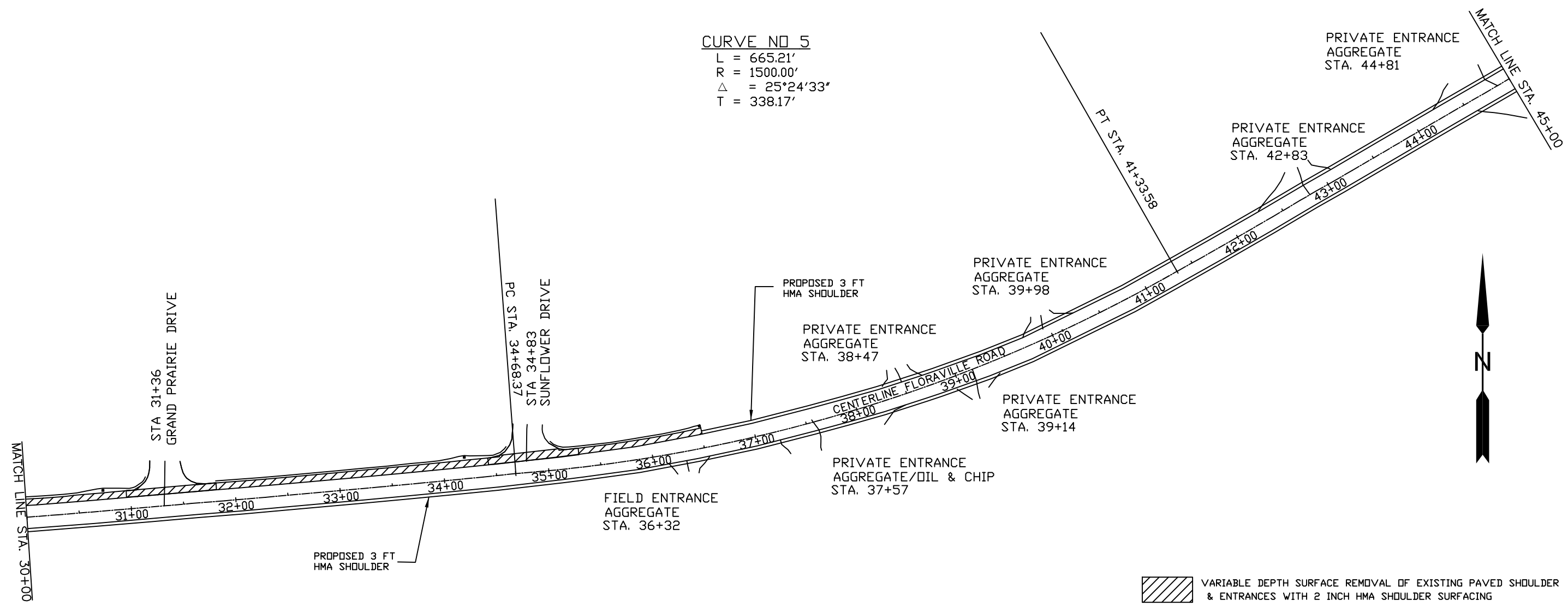

USER NAME =	DESIGNED -	REVISED -	MONROE COUNTY HIGHWAY DEPARTMENT	PLAN AND PROFILE			F.A. RTE. 850	SECTION 20-00061-01-RS	COUNTY MONROE	TOTAL SHEETS 18	SHEET NO. 9
PLLOT SCALE =	CHECKED -	REVISED -					SCALE: 1" = 100'	SHEET 3	OF 10 SHEETS	STA. 30+00	TO STA. 45+00
PLLOT DATE =	DATE -	REVISED -		ILLINOIS FED. AID PROJECT							

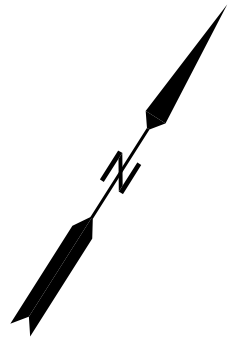

CURVE NO 6
 L = 806.03'
 R = 3450.00'
 Δ = 13°23'10"
 T = 404.86'

CURVE NO 7
 L = 387.03'
 R = 3300.00'
 Δ = 6°43'11"
 T = 193.74'

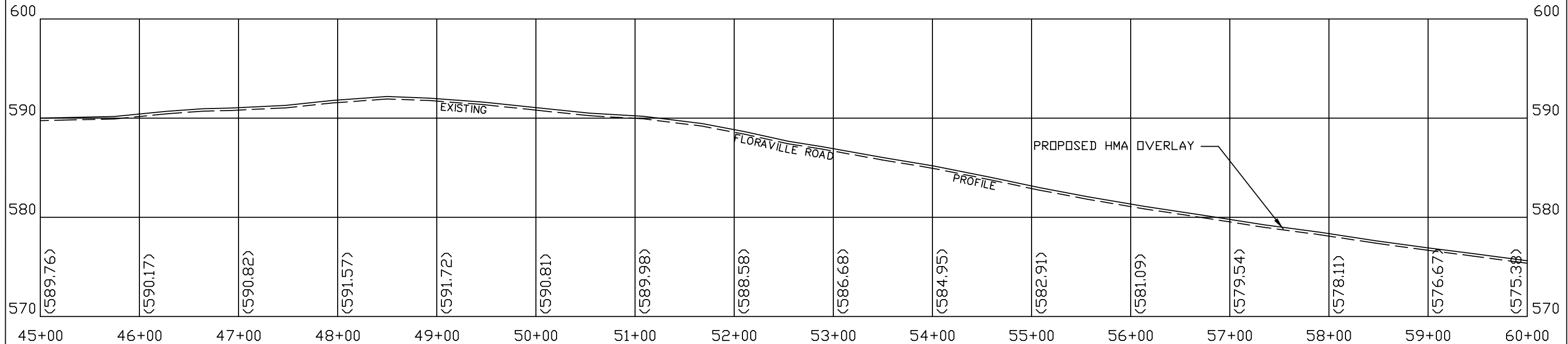
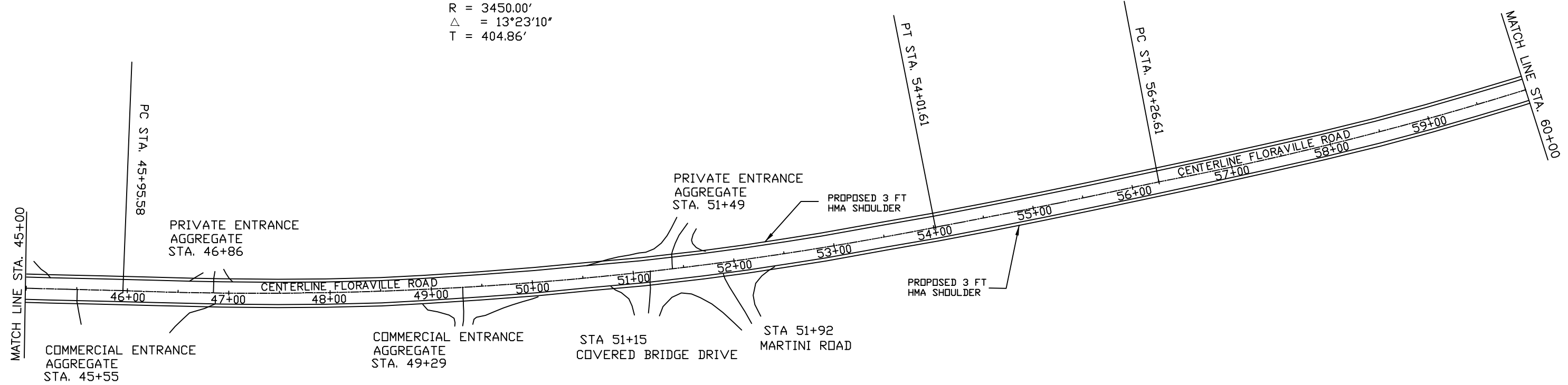

USER NAME = DESIGNED - DRAWN - PLOT SCALE = CHECKED - DATE - REVISOR - REVISED - REVISOR - REVISED - REVISOR - REVISED -	MONROE COUNTY HIGHWAY DEPARTMENT	PLAN AND PROFILE SCALE: 1" = 100' SHEET 4 OF 10 SHEETS STA. 45+00 TO STA. 60+00	<table border="1"> <tr> <td>F.A. RTE. 850</td> <td>SECTION 20-00061-01-RS</td> <td>COUNTY MONROE</td> <td>TOTAL SHEETS 18</td> <td>SHEET NO. 10</td> </tr> <tr> <td colspan="3">CONTRACT NO. 97804</td> <td colspan="2">ILLINOIS FED. AID PROJECT</td> </tr> </table>	F.A. RTE. 850	SECTION 20-00061-01-RS	COUNTY MONROE	TOTAL SHEETS 18	SHEET NO. 10	CONTRACT NO. 97804			ILLINOIS FED. AID PROJECT	
F.A. RTE. 850	SECTION 20-00061-01-RS	COUNTY MONROE	TOTAL SHEETS 18	SHEET NO. 10									
CONTRACT NO. 97804			ILLINOIS FED. AID PROJECT										

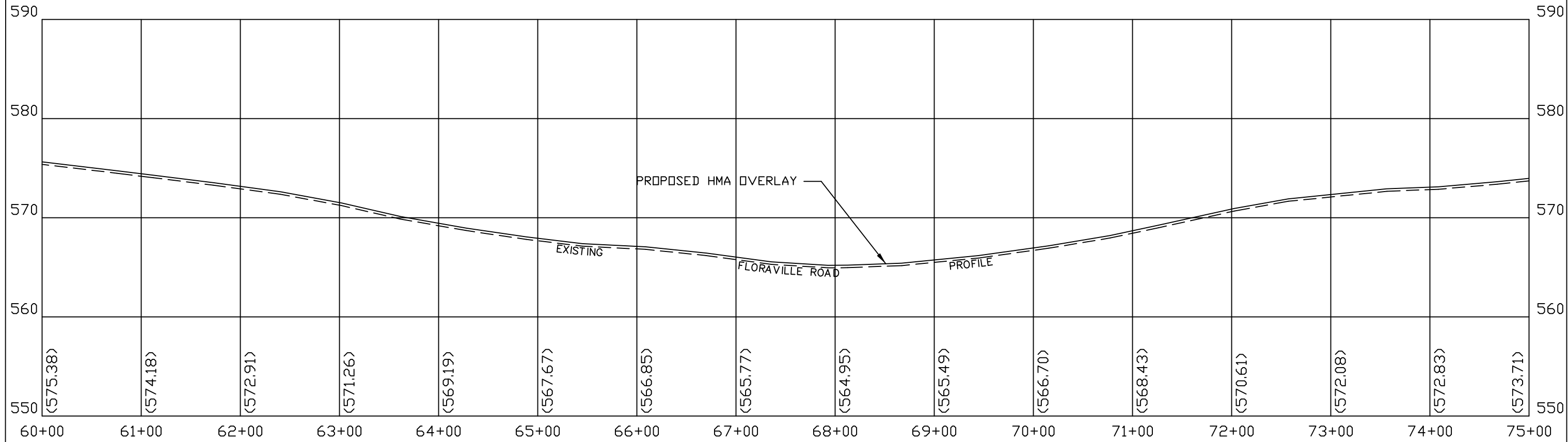
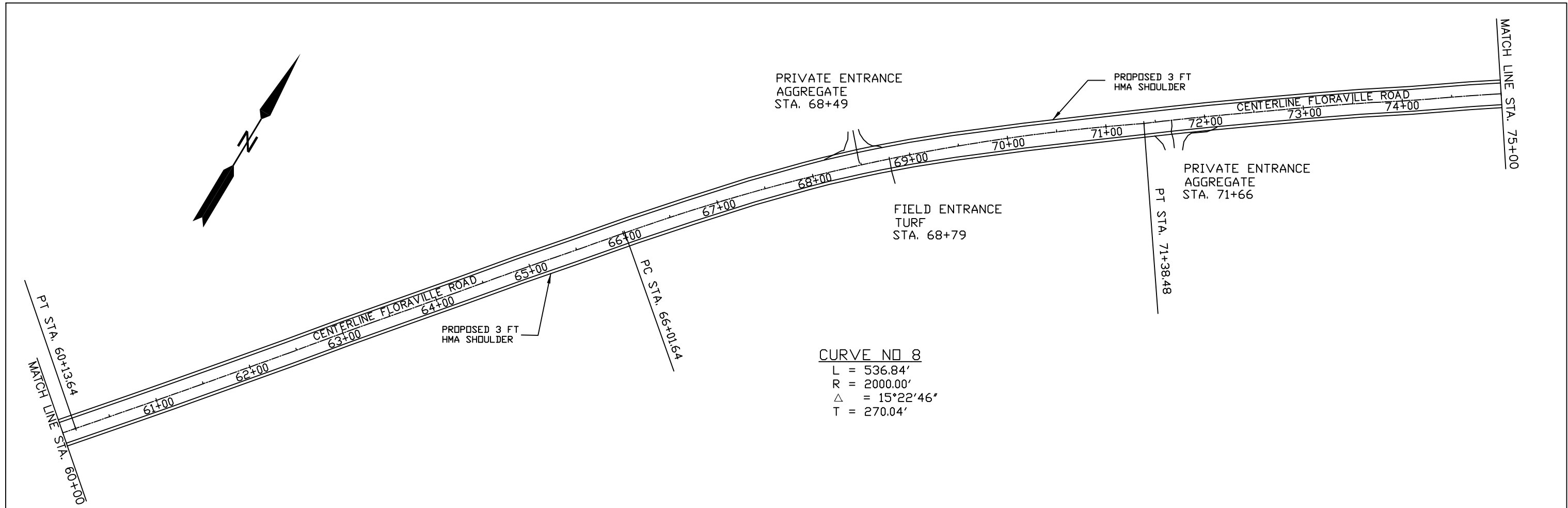

USER NAME =	DESIGNED -	REVISED -	MONROE COUNTY HIGHWAY DEPARTMENT	PLAN AND PROFILE		F.A. RTE. 850	SECTION 20-00061-01-RS	COUNTY MONROE	TOTAL SHEETS 18	SHEET NO. 11
PLOT SCALE =	DRAWN -	REVISED -		SCALE: 1" = 100'	SHEET 5 OF 10 SHEETS	STA. 60+00 TO STA. 75+00	ILLINOIS FED. AID PROJECT		CONTRACT NO. 97804	
PLLOT DATE =	CHECKED -	REVISED -								
	DATE -	REVISED -								

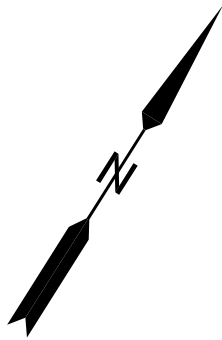

CURVE NO 9
 L = 499.96'
 R = 11127.00'
 Δ = 2°34'28"
 T = 250.02'

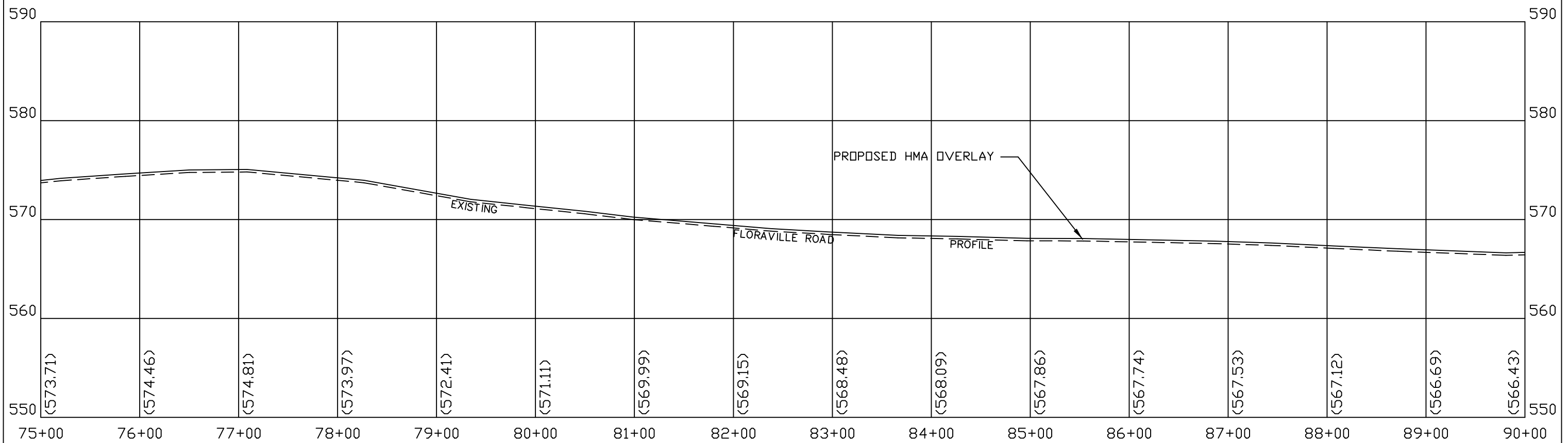
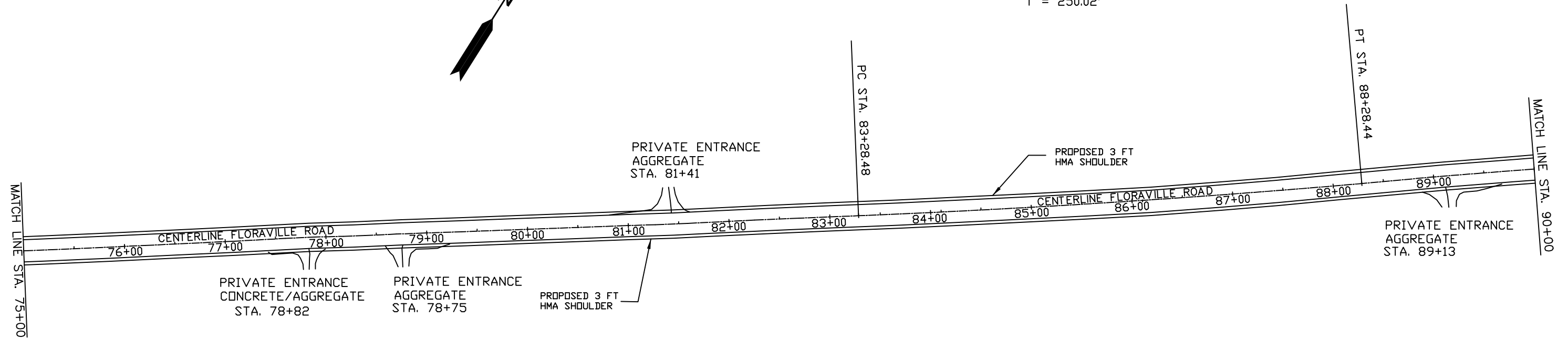

USER NAME =	DESIGNED -	REVISED -	MONROE COUNTY HIGHWAY DEPARTMENT	PLAN AND PROFILE			F.A. RTE. 850	SECTION 20-00061-01-RS	COUNTY MONROE	TOTAL SHEETS 18	SHEET NO. 12	
PLOT SCALE =	DRAWN -	REVISED -					SCALE: 1" = 100'	SHEET 6	OF 10 SHEETS	STA. 75+00	TO STA. 90+00	CONTRACT NO. 97804
PLOT DATE =	CHECKED -	REVISED -		ILLINOIS FED. AID PROJECT								
	DATE -	REVISED -										

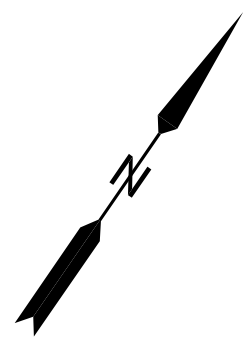
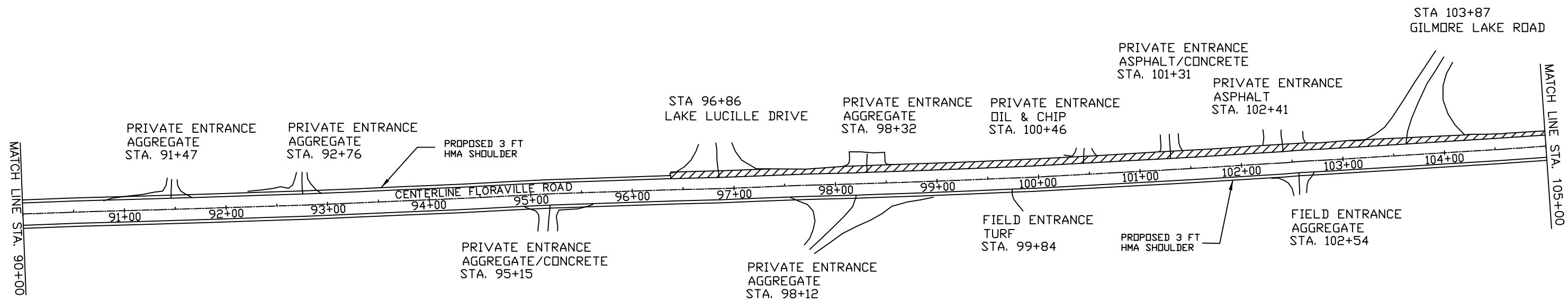

 VARIABLE DEPTH SURFACE REMOVAL OF EXISTING PAVED SHOULDER & ENTRANCES WITH 2 INCH HMA SHOULDER SURFACING

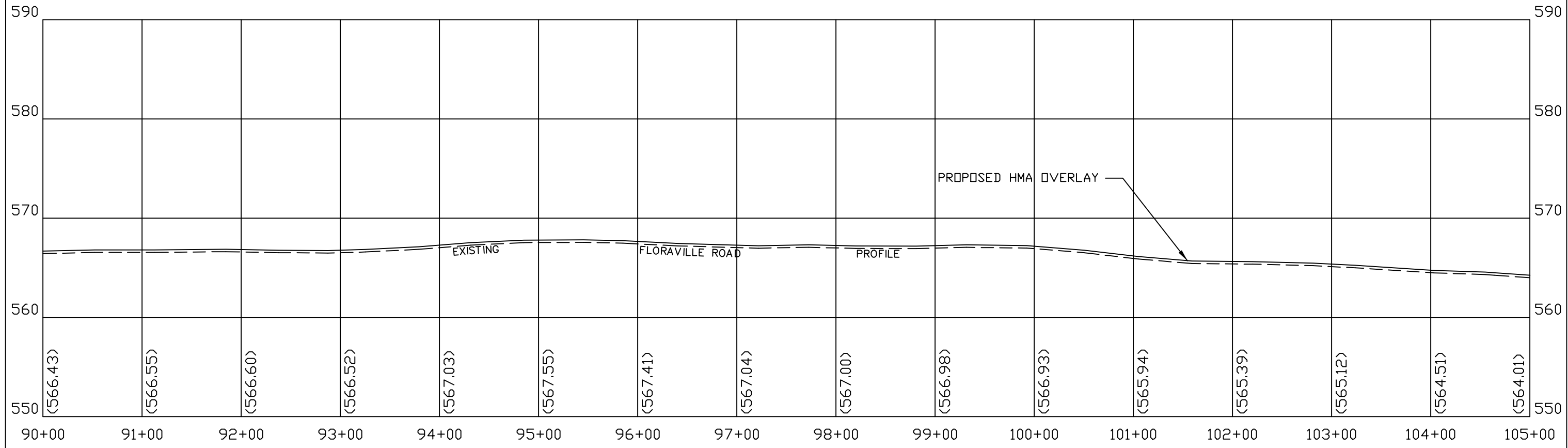

USER NAME =	DESIGNED -	REVISED -	MONROE COUNTY HIGHWAY DEPARTMENT	PLAN AND PROFILE			F.A. RTE. 850	SECTION 20-00061-01-RS	COUNTY MONROE	TOTAL SHEETS 18	SHEET NO. 13
PLOT SCALE =	DRAWN -	REVISED -					SCALE: 1" = 100'	SHEET 7 OF 10 SHEETS	STA. 90+00 TO STA. 105+00	CONTRACT NO. 97804	
PLOT DATE =	CHECKED -	REVISED -									
	DATE -	REVISED -									

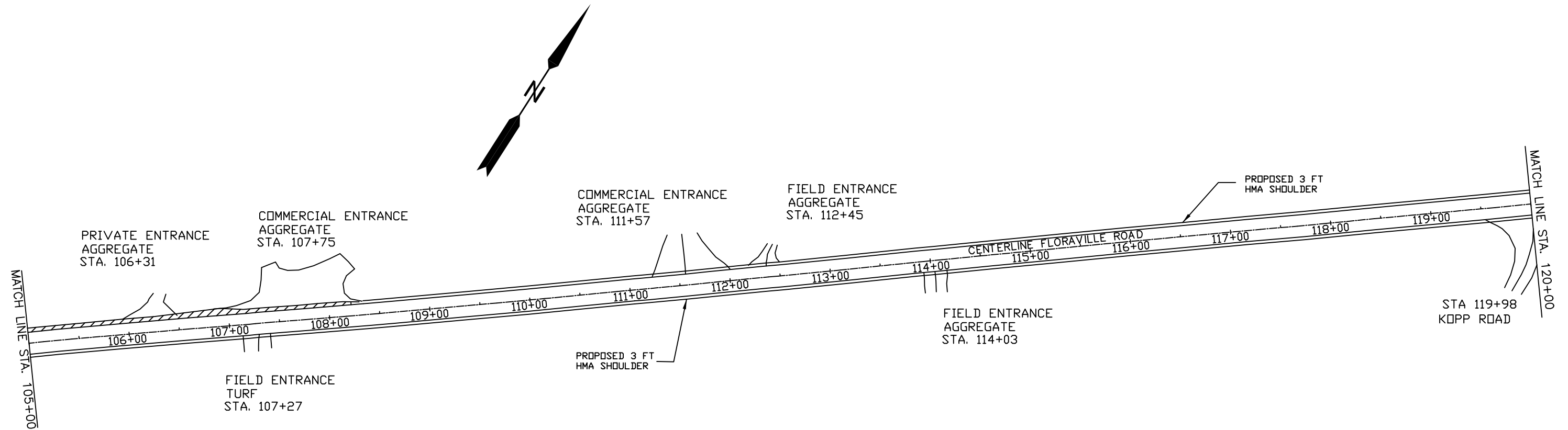

 VARIABLE DEPTH SURFACE REMOVAL OF EXISTING PAVED SHOULDER & ENTRANCES WITH 2 INCH HMA SHOULDER SURFACING

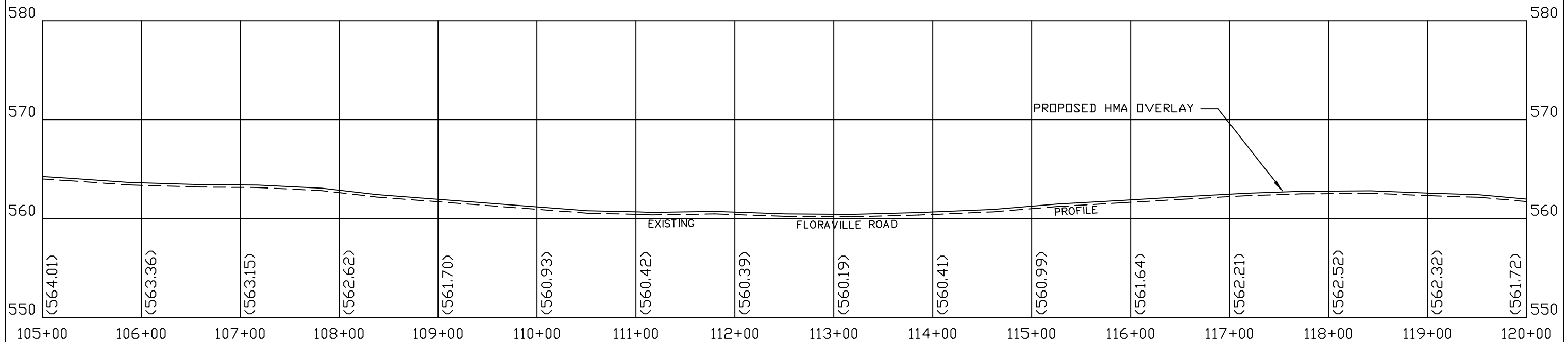

USER NAME =	DESIGNED -	REVISED -	MONROE COUNTY HIGHWAY DEPARTMENT	PLAN AND PROFILE		F.A. RTE. 850	SECTION 20-00061-01-RS	COUNTY MONROE	TOTAL SHEETS 18	SHEET NO. 14	
PLOT SCALE =	DRAWN -	REVISED -				SCALE: 1" = 100'	SHEET 8 OF 10 SHEETS	STA. 105+00 TO STA. 120+00	CONTRACT NO. 97804		
PLOT DATE =	CHECKED -	REVISED -		ILLINOIS FED. AID PROJECT							
	DATE -	REVISED -									

CURVE NO 10

L = 740.27'
 R = 2000.00'
 Δ = 21°12'26"
 T = 374.42'

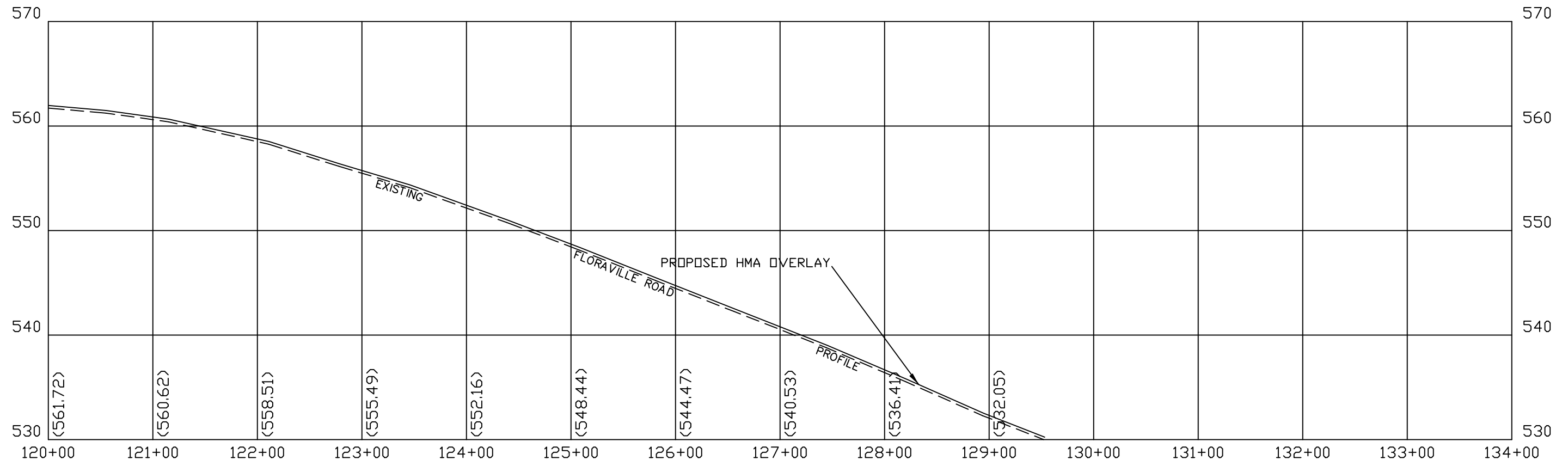
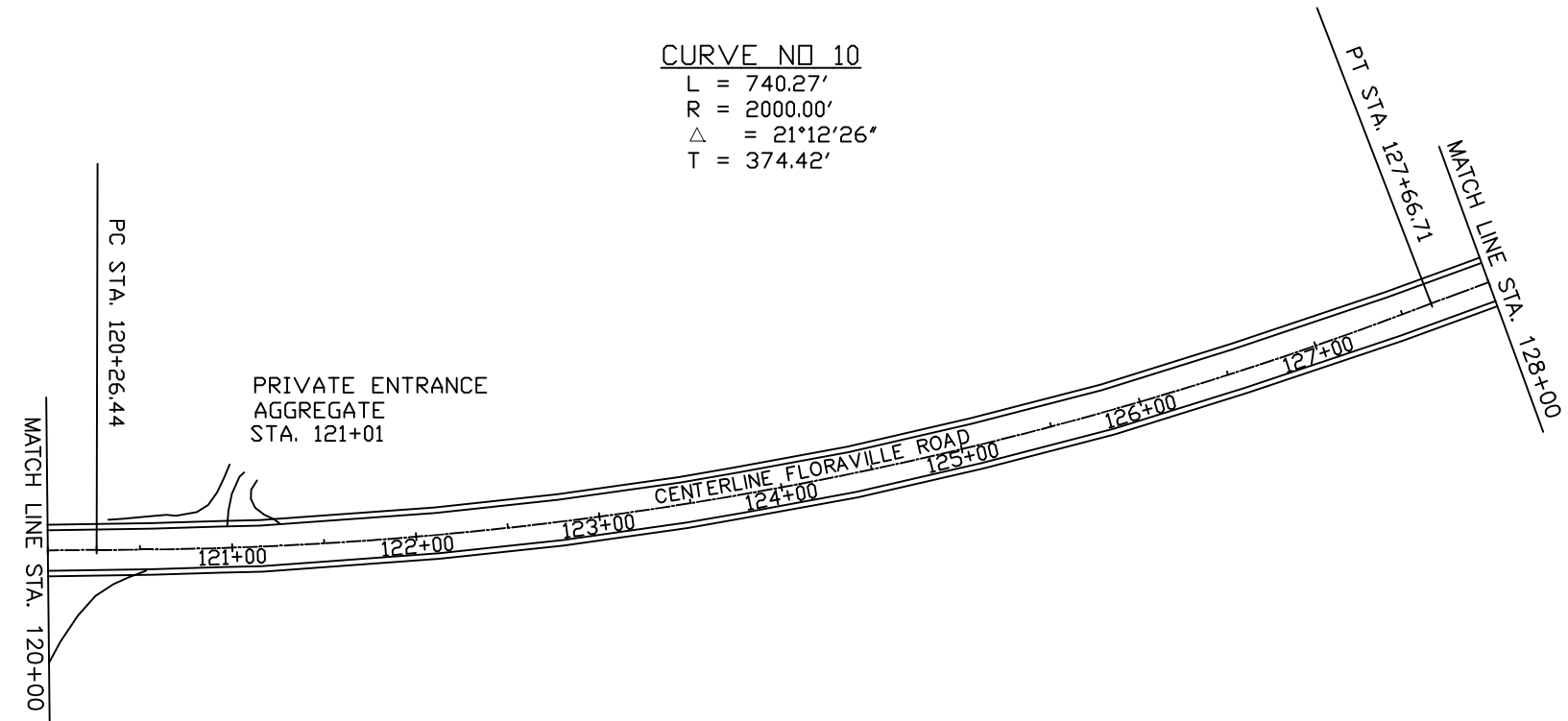
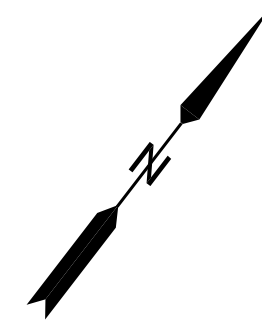

USER NAME =	DESIGNED -	REVISED -	MONROE COUNTY HIGHWAY DEPARTMENT	PLAN AND PROFILE		F.A. RTE. 850	SECTION 20-00061-01-RS	COUNTY MONROE	TOTAL SHEETS 18	SHEET NO. 15
PLLOT SCALE =	DRAWN -	REVISED -		SCALE: 1" = 100'	SHEET 9 OF 10 SHEETS	STA. 120+00	TD STA. 128+00	CONTRACT NO. 97804		
PLLOT DATE =	CHECKED -	REVISED -		ILLINOIS FED. AID PROJECT						
	DATE -	REVISED -								

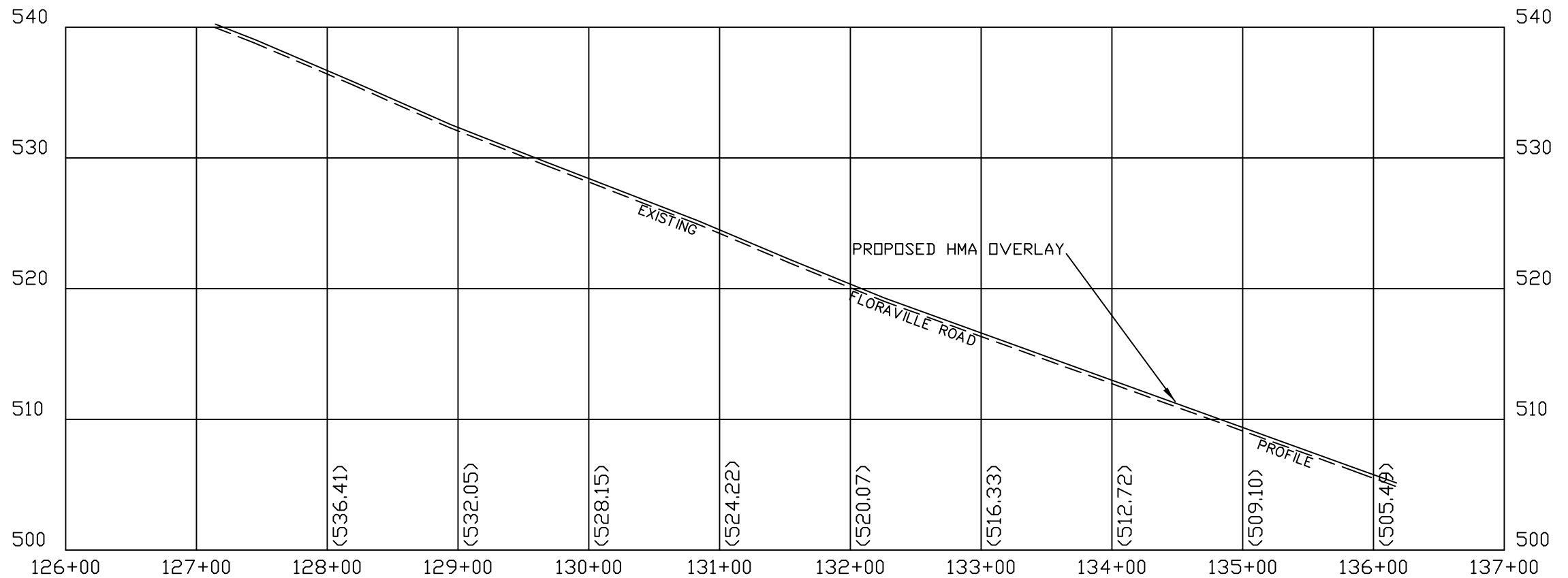
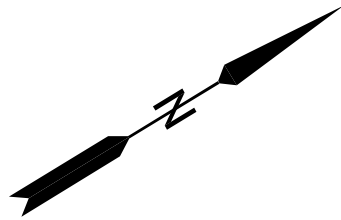
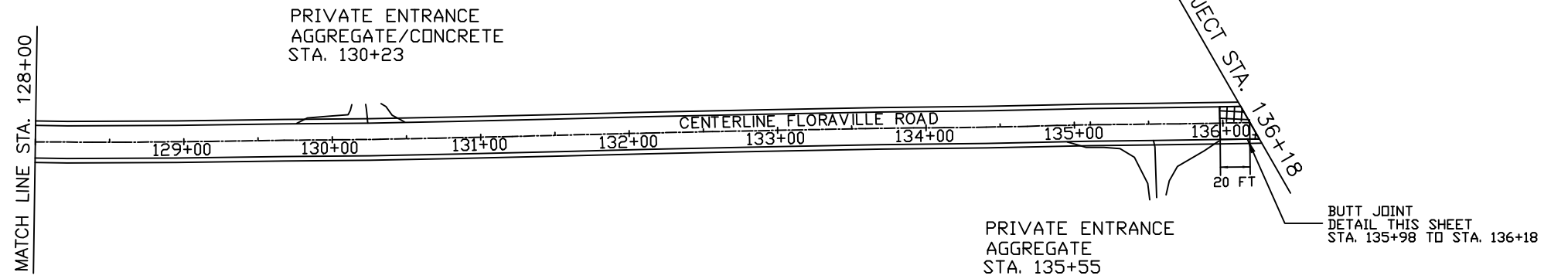
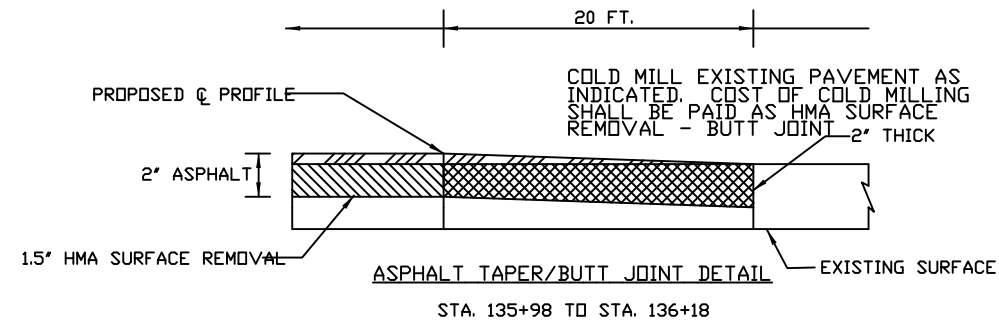

USER NAME =	DESIGNED -	REVISED -
	DRAWN -	REVISED -
PLLOT SCALE =	CHECKED -	REVISED -
PLLOT DATE =	DATE -	REVISED -

MONROE COUNTY
HIGHWAY DEPARTMENT

PLAN AND PROFILE

SCALE: 1" = 100' SHEET 10 OF 10 SHEETS STA. 128+00 TO STA. 136+17

F.A. RTE. 850 C.H. 2	SECTION 20-00061-01-RS	COUNTY MONROE	TOTAL SHEETS 18	SHEET NO. 16
CONTRACT NO. 97804			ILLINOIS FED. AID PROJECT	

ENTRANCE SCHEDULE					
LOCATION	SIDE	EXISTING SURFACE	TYPE OF ENTRANCE	WIDTH	LENGTH
STATION	LT/RT			FOOT	FOOT
0+81	LT	AGGREGATE	PRIVATE	60	0
4+57	LT	AGGREGATE	PRIVATE	15	0
12+60	RT	TURF	FIELD	20	0
23+57	LT	OIL & CHIP	PRIVATE	45	0
23+75	RT	AGGREGATE	PRIVATE	55	0
26+65	LT	ASPHALT/AGGREGATE	PRIVATE		0
36+32	RT	AGGREGATE	FIELD	36	0
37+57	RT	AGGREGATE	PRIVATE	108	0
38+47	LT	AGGREGATE	PRIVATE	34	0
39+14	RT	AGGREGATE	PRIVATE	40	0
39+98	LT	AGGREGATE	PRIVATE	42	0
42+83	LT	AGGREGATE	PRIVATE	70	0
44+81	LT	AGGREGATE	PRIVATE	88	0
45+55	RT	AGGREGATE	COMMERCIAL	215	0
46+86	LT	AGGREGATE	PRIVATE	35	0
49+29	RT	AGGREGATE	COMMERCIAL	115	0
51+49	RT	AGGREGATE	PRIVATE	65	0
68+49	LT	AGGREGATE	PRIVATE	45	0
68+79	RT	TURF	FIELD	20	0
71+66	RT	AGGREGATE	PRIVATE	37	0
77+82	RT	CONCRETE	PRIVATE	30	0
78+75	RT	AGGREGATE	PRIVATE	30	0
81+41	LT	AGGREGATE	PRIVATE	35	0
89+13	RT	AGGREGATE	PRIVATE	35	0
91+47	LT	AGGREGATE	PRIVATE	35	0
92+76	LT	AGGREGATE	PRIVATE	30	0
95+15	RT	AGGREGATE	PRIVATE	35	0
98+12	RT	AGGREGATE	PRIVATE	120	0
98+32	LT	ASPHALT	PRIVATE	38	0
99+84	RT	TURF	FIELD	20	0
100+46	LT	OIL & CHIP	PRIVATE	32	0
101+31	LT	ASPHALT/CONCRETE	PRIVATE	20	0
102+41	LT	ASPHALT	PRIVATE	42	0
102+54	RT	AGGREGATE	FIELD	30	0
106+31	LT	AGGREGATE	PRIVATE	60	0
107+27	RT	TURF	FIELD	26	0
107+75	LT	AGGREGATE	COMMERCIAL	100	0
111+57	LT	AGGREGATE	COMMERCIAL	75	0
112+45	LT	AGGREGATE	FIELD	30	0
114+03	RT	TURF	FIELD	25	0
121+01	LT	AGGREGATE	PRIVATE	45	0
130+23	LT	AGGREGATE	PRIVATE	30	0
135+55	RT	AGGREGATE	PRIVATE	65	0

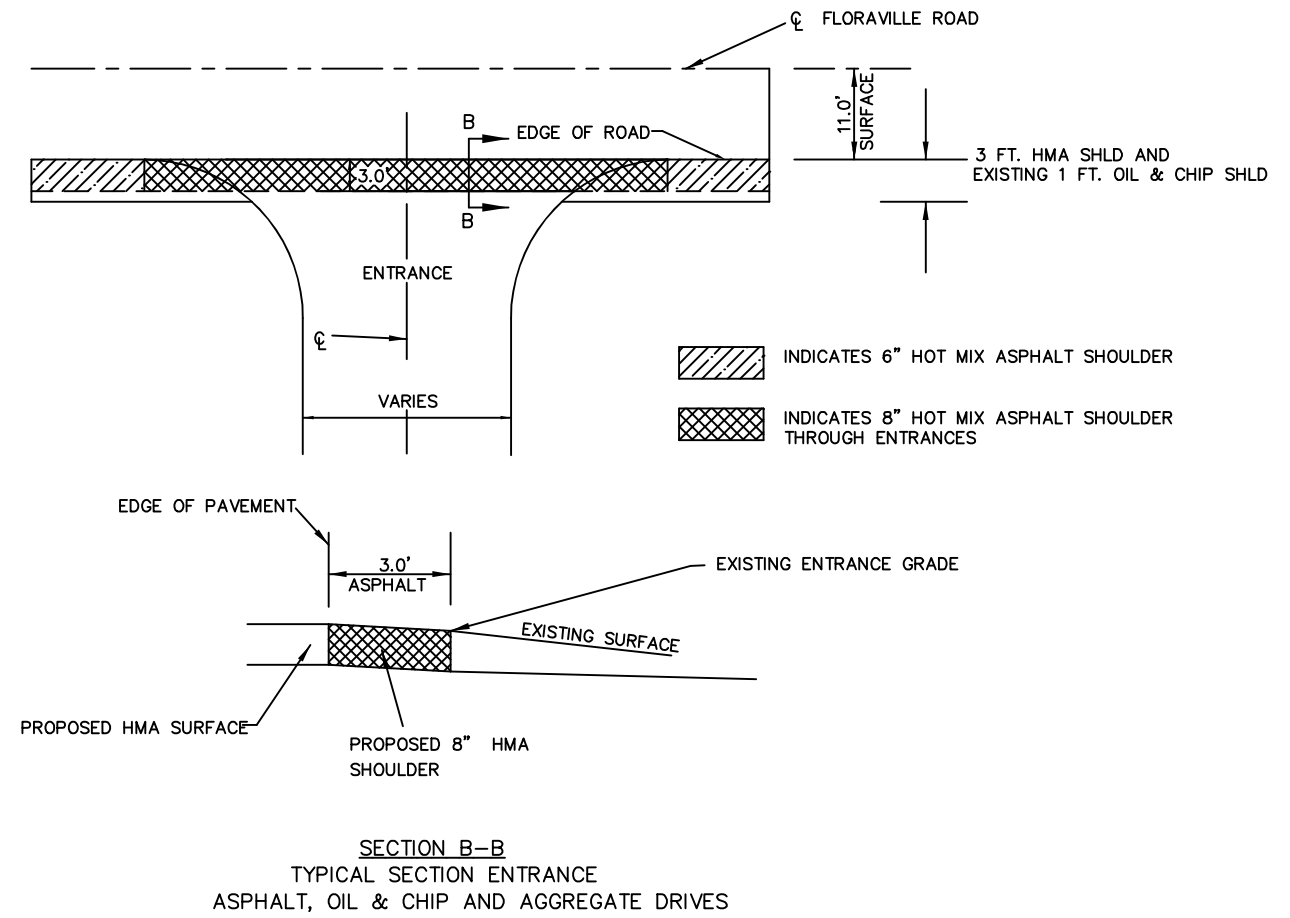

DRAWING FILE: S:\Floraville Road\COVER

USER NAME =	DESIGNED -	REVISED -
	DRAWN -	REVISED -
PLOT SCALE = 1/100,000' / in.	CHECKED -	REVISED -
PLOT DATE =	DATE -	REVISED -

MONROE COUNTY
HIGHWAY DEPARTMENT

ENTRANCE SCHEDULE AND DETAILS

SCALE: NTS SHEET 1 OF 1 SHEETS STA. TO STA.

F.A.S. RTE. 850 C.H. 2	SECTION 20-00061-01-RS	COUNTY MONROE	TOTAL SHEETS 18	SHEET NO. 17
				CONTRACT NO. 97804
ILLINOIS FED. AID PROJECT				

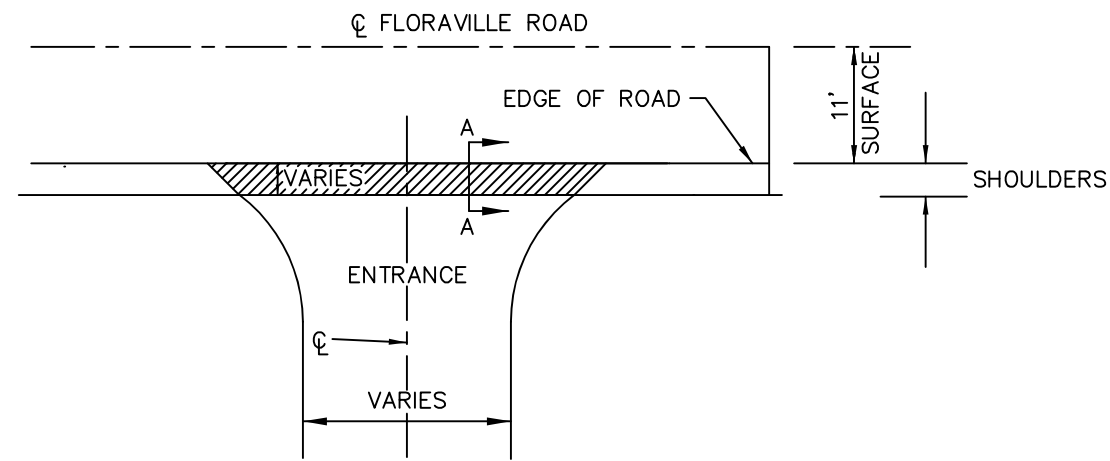

SIDEROAD SCHEDULE						
ROAD NAME	LOCATION	SIDE	WIDTH	LENGTH	INCIDENTAL HOT-MIX ASPHALT SURFACING	HMA SURFACE REMOVAL BUTT JOINT
	STATION	LT/RT	FOOT	FOOT	TON	SQUARE YARD
GRAND PRAIRIE DRIVE	31+36	LT	86	0		
SUNFLOWER DRIVE	34+83	LT	86	0		
COVERED BRIDGE DRIVE	51+15	RT	70	10	13	72
MARTINI ROAD	51+92	RT	80	10	17	85
LAKE LUCILLE DRIVE	96+86	LT	84	0		
GILMORE LAKE ROAD	103+87	LT	120	0		
KOPP ROAD	119+98	RT	86	10	20	95
TOTAL					50	252

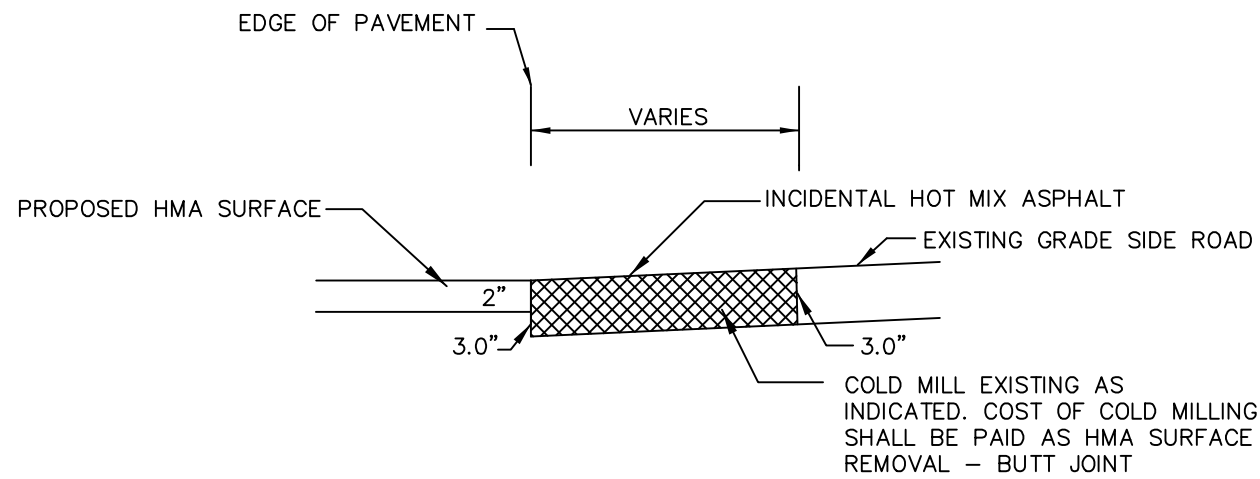

SECTION A-A
TYPICAL SECTION OIL & CHIP OR HOT-MIX ASPHALT SIDEROADS

DRAWING FILE: S:\Floraville Road\COVER

USER NAME =	DESIGNED -	REVISED -
	DRAWN -	REVISED -
PLOT SCALE =	CHECKED -	REVISED -
PLOT DATE =	DATE -	REVISED -

MONROE COUNTY
HIGHWAY DEPARTMENT

SIDEROAD SCHEDULE AND DETAILS
SCALE: NTS SHEET 1 OF 1 SHEETS STA. TO STA.

FAS RTE. 850 C.H. 2	SECTION 20-00061-01-RS	COUNTY MONROE	TOTAL SHEETS 18	SHEET NO. 18
CONTRACT NO. 97804			ILLINOIS FED. AID PROJECT	