

STATE OF ILLINOIS
DEPARTMENT OF TRANSPORTATION

F.A.I. RTE	SECTION	COUNTY	TOTAL SHEETS	SHEET NO.
270	60-1PP	MADISON	6	1
		ILLINOIS	CONTRACT NO. 76R69	

INDEX OF SHEETS

1. COVER
2. HIGHWAY STANDARDS, GENERAL NOTES & COMMITMENTS
3. SUMMARY OF QUANTITIES
4. TYPICAL SECTIONS
5. SCHEDULES
6. LOCATION MAP PLAN SHEET

TRAFFIC DATA

ADT: 9,100 (2023)
10,400 (2043)
SU: 7.8%
MU: 13.3%

**PROPOSED
HIGHWAY PLANS**

FAI ROUTE 270 (I-270)
SECTION 60-1PP
I-270 EB CD PAVEMENT PATCHING
MADISON COUNTY

D-98-112-22

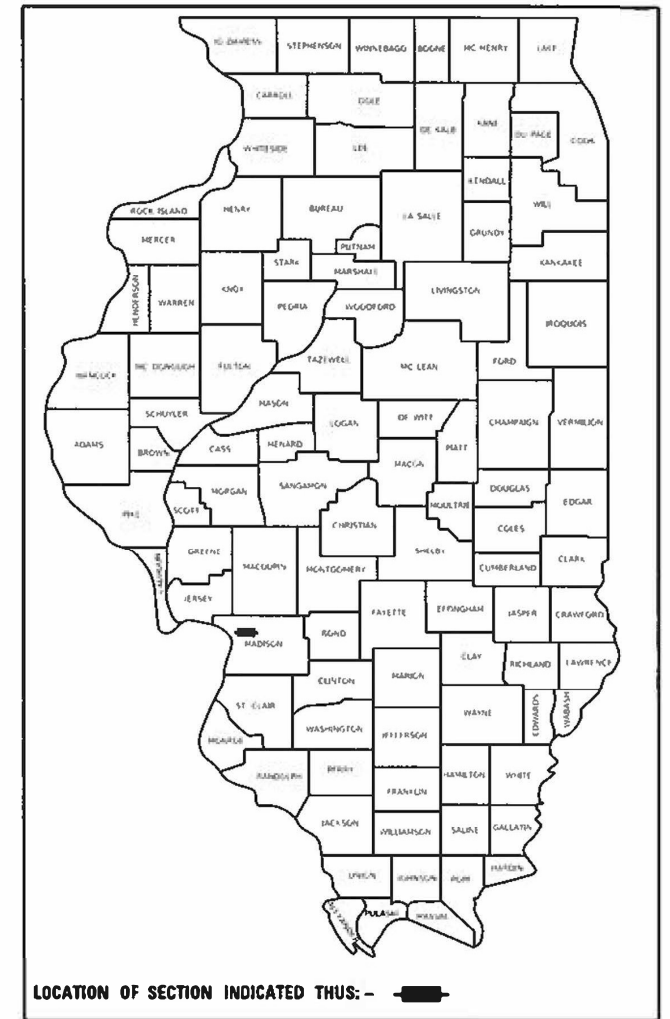

C-98-144-22

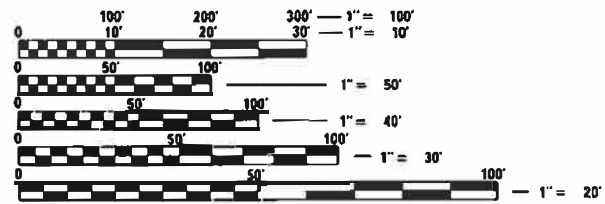
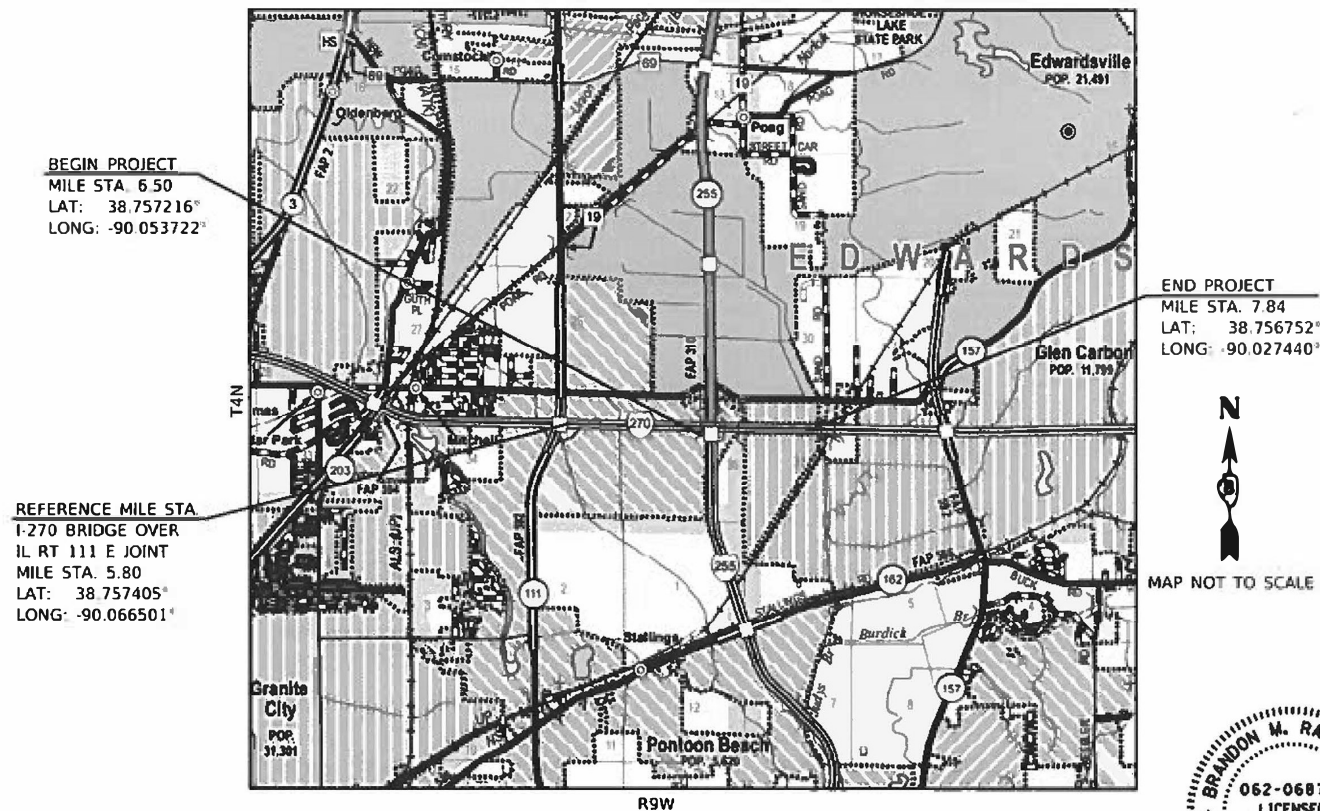

FULL SIZE PLANS HAVE BEEN PREPARED USING STANDARD ENGINEERING SCALES. REDUCED SIZED PLANS WILL NOT CONFORM TO STANDARD SCALES. IN MAKING MEASUREMENTS ON REDUCED PLANS, THE ABOVE SCALES MAY BE USED.

J.U.L.I.E.
JOINT UTILITY LOCATION INFORMATION FOR EXCAVATORS
1-800-892-0123
OR 811

GROSS LENGTH = 7,075 FT. = 1.34 MILES
NET LENGTH = 7,075 FT. = 1.34 MILES



PROJECT ENGINEER: CHERYL KEPLAR
PROJECT MANAGER: TONI MANN

CONTRACT NO. 76R69

Brandon M. Ratermann 3-2-23
BRANDON M. RATERMANN, P.E.
ILLINOIS REGISTERED ENGINEER NO. 062-068775
REGISTRATION EXPIRES NOV. 30, 2023

STATE OF ILLINOIS
DEPARTMENT OF TRANSPORTATION

SUBMITTED March 22 20 23
Kevin Brown
REGIONAL ENGINEER

May 12, 2023 *John A. Etk*
ENGINEER OF DESIGN AND ENVIRONMENT

May 12, 2023 *Steph M. Spauld*
DIRECTOR OF HIGHWAYS PROJECT IMPLEMENTATION

HMG ENGINEERS
HMG ENGINEERS, INC.
9360 HOLY CROSS LANE
BREESE, ILLINOIS 62230
888.HMG.ENGR

IL PROF. DESIGN FIRM NO. 184.000899

PRINTED BY THE AUTHORITY
OF THE STATE OF ILLINOIS

GENERAL NOTES

- UTILITIES KNOWN TO HAVE FACILITIES WITHIN THE PROJECT AREA AS FOLLOWS:
 AMEREN ILLINOIS - ELECTRIC
 AT&T ILLINOIS
 CHARTER COMMUNICATIONS
 DEPARTMENT OF CENTRAL MANAGEMENT SERVICES - COMMUNICATIONS
 VILLAGE OF GLEN CARBON - WATER & SANITARY SEWER
 LEVEL 3 COMMUNICATIONS, LLC
 MITCHELL PUBLIC WATER DISTRICT - WATER
- THE CONTRACTOR AND THE ENGINEER SHALL BE AWARE THAT NO SURVEY WAS PERFORMED FOR THIS PROJECT. THE PLANS WERE CREATED USING MICROFILM AND FIELD MEASUREMENTS. BOTH SHALL BE ASSUMED TO BE APPROXIMATE. THE CONTRACTOR SHALL VERIFY DIMENSIONS AND CONDITIONS IN THE FIELD PRIOR TO CONSTRUCTION AND ORDERING MATERIALS.
- "ROAD CONSTRUCTION AHEAD" SIGNS SHALL BE PLACED AT EACH END OF THE PROJECT, AND WILL BE CONSIDERED INCLUDED IN THE TRAFFIC CONTROL PAY ITEMS. ALL CONSTRUCTION SIGNS SHALL BE 48" X 48" FLUORESCENT ORANGE.
- A FLAGGER SHALL BE REQUIRED AT ALL TIMES WHEN WORKERS OR EQUIPMENT ARE ENCROACHING THE LANE OF TRAFFIC.
- ALL TURF AREAS DISTURBED BY THE CONTRACTOR SHALL BE SEEDED USING THE APPROPRIATE EROSION CONTROL, WITH APPROVAL FROM THE ENGINEER, AND AT THE CONTRACTOR'S EXPENSE.
- NO OVERNIGHT CLOSURES SHALL BE ALLOWED.
- THE DEPARTMENT STRONGLY ENCOURAGES THE PRIME CONTRACTOR AND THEIR APPROVED SUB-CONTRACTORS TO HIRE MINORITY, WOMEN, AND DISADVANTAGED INDIVIDUALS FROM ITS FEDERALLY FUNDED HIGHWAY CONSTRUCTION CAREERS TRAINING PROGRAM (HCCTP) TO HELP MEET WORKFORCE AND TRAINEE GOALS. THIS PROGRAM IS TRAINING MINORITIES, WOMEN, AND DISADVANTAGED INDIVIDUALS IN HIGHWAY CONSTRUCTION-RELATED SKILLS, E.G. MATH FOR THE TRADES, JOB READINESS, TECHNICAL SKILLS COURSEWORK (CARPENTRY, CONCRETE FLATWORK, BLUEPRINT READING, SITE PLANS, SITE WORK, TOOLS USE, ETC.) AND OSHA 10 HOUR CERTIFICATION, TO PREPARE THEM FOR A CAREER IN THE HIGHWAY CONSTRUCTION TRADES. GRADUATES ARE WELL-TRAINED AND READY TO BECOME PRODUCTIVE ENTRY-LEVEL CONSTRUCTION WORKERS. CONTACT THE DISTRICT 8 EEO OFFICE AT 618-346-3360 AND/OR THE HCCTP COORDINATOR AT 618-874-6528 TO LEARN MORE ABOUT THE PROGRAM AND FOR ASSISTANCE IN MEETING WORKFORCE AND TRAINEE GOALS.
- PCC PAVEMENT MAY BE ENCOUNTERED DURING PARTIAL DEPTH REMOVAL, 1.5". NO ADDITIONAL COMPENSATION WILL BE PERMITTED FOR ANY EXTRA WORK FROM THE CONCRETE PAVEMENT REMOVAL.
- ASSUMED QUANTITIES TO BE USED AT THE ENGINEER'S DISCRETION.
 THERMOPLASTIC PAVEMENT MARKING 6" 500 FT (250' WHITE & 250' YELLOW)
 RAISED REFLECTIVE PAVEMENT MARKING (RRPM) 10 EA (ALL CRYSTAL)
 RRPM REMOVAL 10 EA

MIXTURE COMPOSITION

	PATCHING
MIXTURE USE	PARTIAL DEPTH PATCH
AC/PG	PG 64-22
DESIGN AIR VOIDS	4.0% @ Ndes=90
MIX COMPOSITION (GRADATION)	IL 9.5
FRICTION AGG	MIXTURE "D"
QUALITY MGMT PROGRAM	QC/QA
MatTranDev REQUIRED?	NO

HIGHWAY STANDARDS

- 000001-08 STANDARD SYMBOLS, ABBREVIATIONS AND PATTERNS
- 001001-02 AREAS OF REINFORCEMENT BARS
- 001006 DECIMAL OF AN INCH AND OF A FOOT
- 442101-09 CLASS B PATCHES
- 701400-11 APPROACH TO LANE CLOSURE, FREEWAY/EXPRESSWAY
- 701401-13 LANE CLOSURE, FREEWAY/EXPRESSWAY
- 701456-05 PARTIAL EXIT RAMP CLOSURE FREEWAY/EXPRESSWAY
- 701901-08 TRAFFIC CONTROL DEVICES
- 780001-05 TYPICAL PAVEMENT MARKINGS
- 781001-04 TYPICAL APPLICATIONS RAISED REFLECTIVE PAVEMENT MARKERS
- 420001-10 PAVEMENT JOINTS

COMMITMENTS

NONE

REV. - MS

MODEL: 046431R
 FILE NAME: V102319.PLT
 PLOT DATE: 3/1/2023
 PLOT SCALE: 20.0000' / in.
 USER NAME: amontero
 DESIGNED: -
 DRAWN: -
 CHECKED: -
 DATE: -
 REVISED: -
 REVISED: -
 REVISED: -
 REVISED: -
 HMG ENGINEERS
 IL PROF DESIGN FIRM 184.000899



USER NAME = amontero	DESIGNED -	REVISED -
	DRAWN -	REVISED -
PLOT SCALE = 20.0000' / in.	CHECKED -	REVISED -
PLOT DATE = 3/1/2023	DATE -	REVISED -

STATE OF ILLINOIS
DEPARTMENT OF TRANSPORTATION

HIGHWAY STANDARDS, GENERAL NOTES,
& COMMITMENTS

SCALE: SHEET 1 OF 1 SHEETS STA. TO STA.

F.A.I. RTE.	SECTION	COUNTY	TOTAL SHEETS	SHEET NO.
270	60-1PP	MADISON	6	2
CONTRACT NO. 76R69			ILLINOIS FED. AID PROJECT	

100% STATE

CONSTR. CODE

CODE NO.	ITEM	UNIT	TOTAL QUANTITY	ROADWAY	
				0006	URBAN
44200994	CLASS B PATCHES, TYPE II, 12 INCH	SQ YD	11	11	
44201102	CLASS B PATCHES, TYPE II, 20 INCH	SQ YD	19	19	
44201299	DOWEL BARS 1 1/2"	EACH	60	60	
44213200	SAW CUTS	FOOT	152	152	
67100100	MOBILIZATION	L SUM	1	1	
70100800	TRAFFIC CONTROL AND PROTECTION, STANDARD 701401	L SUM	1	1	
70100825	TRAFFIC CONTROL AND PROTECTION, STANDARD 701456	L SUM	1	1	
70200100	NIGHTTIME WORK ZONE LIGHTING	L SUM	1	1	
* 78000400	THERMOPLASTIC PAVEMENT MARKING - LINE 6"	FOOT	500	500	
* 78100100	RAISED REFLECTIVE PAVEMENT MARKER	EACH	10	10	
78300200	RAISED REFLECTIVE PAVEMENT MARKER REMOVAL	EACH	10	10	
X4406040	PARTIAL DEPTH REMOVAL, TYPE I, 4"	SQ YD	6	6	
X4406440	PARTIAL DEPTH REMOVAL, TYPE III, 4"	SQ YD	54	54	
X4421000	PARTIAL DEPTH PATCHING	TON	47	47	

* SPECIALTY ITEM

100% STATE

CONSTR. CODE

CODE NO.	ITEM	UNIT	TOTAL QUANTITY	ROADWAY	
				0006	URBAN
X4406015	PARTIAL DEPTH REMOVAL, TYPE I, 1.5"	SQ YD	349	349	
X4406215	PARTIAL DEPTH REMOVAL, TYPE II, 1.5"	SQ YD	32	32	
X4406415	PARTIAL DEPTH REMOVAL, TYPE III, 1.5"	SQ YD	50	50	

MODEL: D:\dgn\hmg\11032103\11032103.dwg USER: bratermann DESIGNED: bratermann REVISED: bratermann
FILE NAME: 11032103.dwg PLOT DATE: 3/2/2023



USER NAME = bratermann	DESIGNED -	REVISED -
PLOT SCALE = 100.0000" / in.	DRAWN -	REVISED -
PLOT DATE = 3/2/2023	CHECKED -	REVISED -
	DATE -	REVISED -

STATE OF ILLINOIS
DEPARTMENT OF TRANSPORTATION

SUMMARY OF QUANTITIES

SCALE: NTS SHEET 1 OF 1 SHEETS STA. TO STA.

F.A.I. RTE.	SECTION	COUNTY	TOTAL SHEETS	SHEET NO.
270	60-1PP	MADISON	6	3
ILLINOIS FED. AID PROJECT			CONTRACT NO. 76R69	

REV. - MS

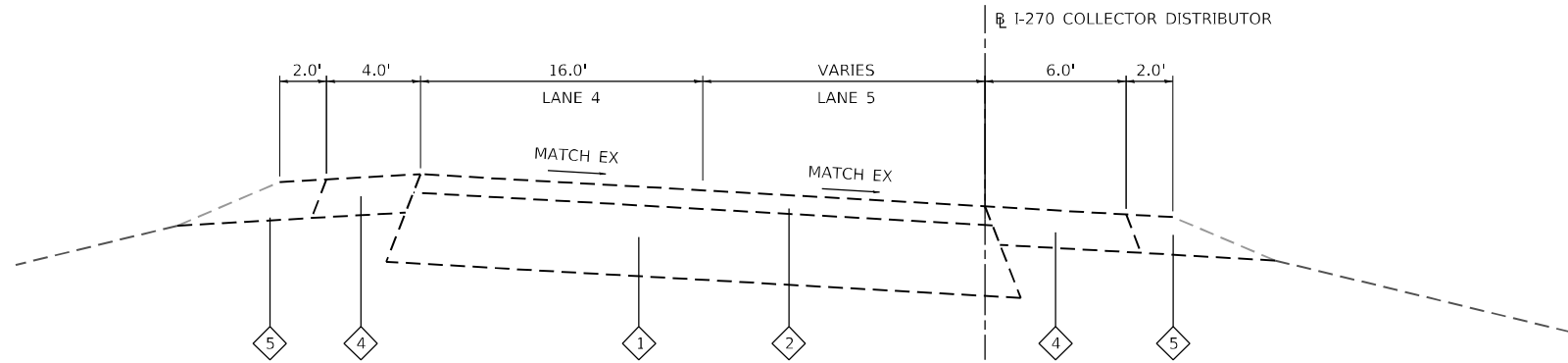

EXISTING EASTBOUND I-270 COLLECTOR DISTRIBUTOR

MILE STA. 6.50 TO MILE STA. 6.70
 MILE STA. 6.94 TO MILE STA. 7.09
 MILE STA. 7.28 TO MILE STA. 7.45

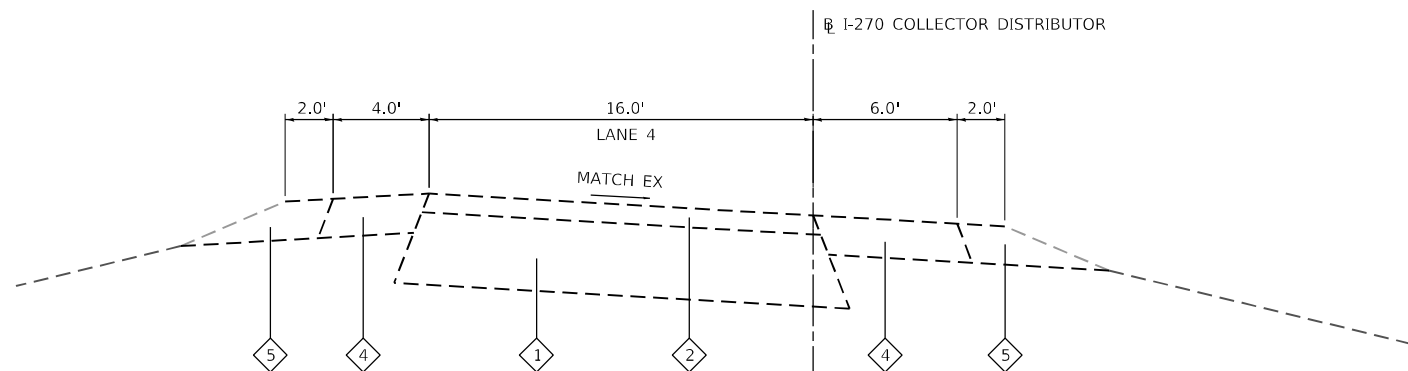

EXISTING EASTBOUND I-270 COLLECTOR DISTRIBUTOR

MILE STA. 6.70 TO MILE STA. 6.94
 MILE STA. 7.09 TO MILE STA. 7.28

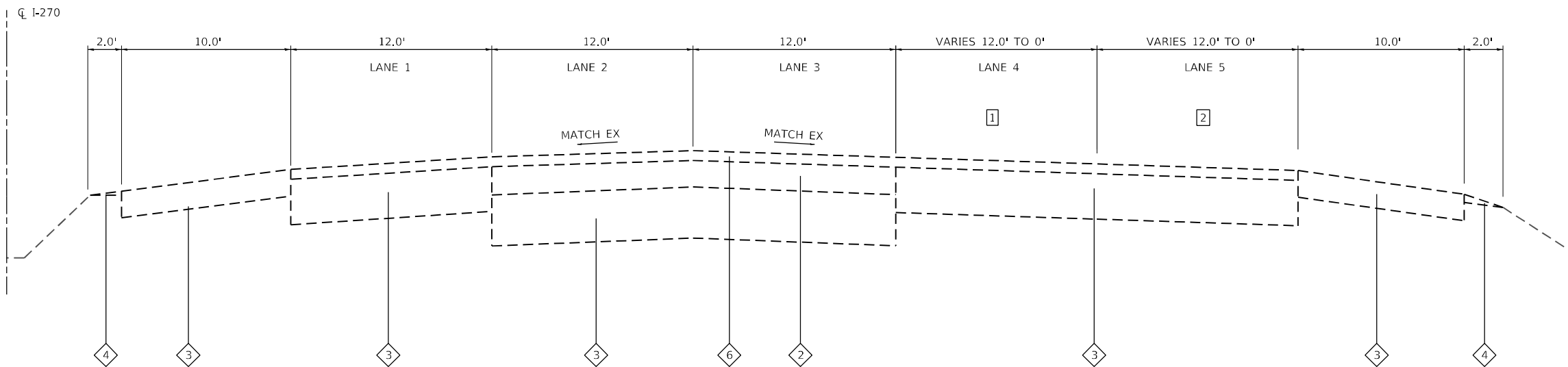

EXISTING EASTBOUND I-270

MILE STA. 7.05 TO MILE STA. 7.84

TYPICAL SECTION LEGEND

- 1 EXISTING HMA PAVEMENT, 15.5"
- 2 EXISTING HMA OVERLAY
- 3 EXISTING PCC PAVEMENT, 10"
- 4 EXISTING HMA SHOULDER
- 5 EXISTING AGGREGATE SHOULDER
- 6 EXISTING ULTRA-THIN BONDED WEARING COURSE, 1.5"

TYPICAL SECTION NOTES

- 1 LANE 4 BEGINS AT 12' AT MILE STA. 7.45 AND TRANSITIONS TO 0' AT MILE STA. 7.84
- 2 LANE 5 BEGINS AT 12' AT MILE STA. 7.45 AND TRANSITIONS TO 0' AT MILE STA. 7.63

MODEL Path: \\hmg\hmg\work\2023\270\270-199\0218219_028_W03_Veribus_Pitching\76669 - I-270-CDD_Sheets\0276669-Typical.dgn
 FILE NAME: \\hmg\hmg\work\2023\270\270-199\0218219_028_W03_Veribus_Pitching\76669 - I-270-CDD_Sheets\0276669-Typical.dgn



USER NAME = bratermann	DESIGNED -	REVISED -
	DRAWN -	REVISED -
PLOT SCALE = 40,000' / in.	CHECKED -	REVISED -
PLOT DATE = 3/2/2023	DATE -	REVISED -

**STATE OF ILLINOIS
 DEPARTMENT OF TRANSPORTATION**

TYPICAL SECTIONS

SCALE: NTS SHEET 1 OF 1 SHEETS STA. TO STA.

F.A.I. RTE.	SECTION	COUNTY	TOTAL SHEETS	SHEET NO.
270	60-1PP	MADISON	6	4
CONTRACT NO. 76R69				
ILLINOIS FED. AID PROJECT				

PARTIAL DEPTH PATCHING

LOCATION MILE STATION	LANE	LENGTH (FEET)	WIDTH (FEET)	PART DEP REM T1 1.5 (SQ YD)	PART DEP REM T2 1.5 (SQ YD)	PART DEP REM T3 1.5 (SQ YD)	PART DEP REM T1 4 (SQ YD)	PART DEP REM T3 4 (SQ YD)	PARTIAL DEPTH PATCH (NOTE 1) (TON)
6.50	4	4	12				5.3		1.2
6.50	5	40	12					53.3	11.9
7.40	4	4	6	2.7					0.2
7.40	4	4	12	5.3					0.4
7.40	5	4	12	5.3					0.4
7.40	4	4	6	2.7					0.2
7.50	4	4	12	5.3					0.4
7.50	5	4	12	5.3					0.4
7.51	4	4	12	5.3					0.4
7.52	4	4	12	5.3					0.4
7.52	4	4	12	5.3					0.4
7.52	4	4	12	5.3					0.4
7.53	5	4	12	5.3					0.4
7.53	5	4	12	5.3					0.4
7.54	5	4	12	5.3					0.4
7.54	4	4	12	5.3					0.4
7.56	4	4	12	5.3					0.4
7.56	5	4	12	5.3					0.4
7.57	4	4	6	2.7					0.2
7.58	4	6	12		8.0				0.7
7.58	5	6	12		8.0				0.7
7.58	4	4	12	5.3					0.4
7.58	5	4	12	5.3					0.4
7.59	4	4	10	4.4					0.4
7.59	5	4	12	5.3					0.4
7.60	4	4	10	4.4					0.4
7.60	5	4	12	5.3					0.4
7.60	4	4	8	3.6					0.3
7.60	5	4	12	5.3					0.4
7.61	4	4	6	2.7					0.2
7.61	5	4	6	2.7					0.2
7.62	5	6	12		8.0				0.7
7.63	5	6	12		8.0				0.7
7.63	4	4	4	1.8					0.2
7.63	5	4	12	5.3					0.4
7.64	4	4	4	1.8					0.2
7.64	5	4	6	2.7					0.2
7.65	4	4	4	1.8					0.2
7.65	4	4	4	1.8					0.2
7.66	4	4	16	7.1					0.6
7.66	4	4	16	7.1					0.6
7.67	4	4	14	6.2					0.5
7.67	4	75	6			50.0			4.2
7.68	4	4	13	5.8					0.5
7.68	4	4	12	5.3					0.4
7.69	4	4	12	5.3					0.4
7.70	4	4	12	5.3					0.4
7.70	4	4	12	5.3					0.4
7.71	4	4	12	5.3					0.4
7.71	4	4	12	5.3					0.4
7.72	4	4	12	5.3					0.4
7.72	4	4	12	5.3					0.4
7.72	4	4	12	5.3					0.4
7.73	4	4	12	5.3					0.4
7.74	4	4	12	5.3					0.4
7.74	4	4	12	5.3					0.4
7.75	4	4	12	5.3					0.4
7.75	4	4	12	5.3					0.4
7.76	4	4	12	5.3					0.4
7.76	4	4	12	5.3					0.4

CONTINUED

PARTIAL DEPTH PATCHING CONTINUED

LOCATION	LANE	LENGTH (FEET)	WIDTH (FEET)	PART DEP REM T1 1.5 (SQ YD)	PART DEP REM T2 1.5 (SQ YD)	PART DEP REM T3 1.5 (SQ YD)	PART DEP REM T1 4 (SQ YD)	PART DEP REM T3 4 (SQ YD)	PARTIAL DEPTH PATCH (NOTE 1) (TON)
7.77	4	4	12	5.3					0.4
7.77	4	4	12	5.3					0.4
7.78	4	4	12	5.3					0.4
7.78	4	4	12	5.3					0.4
7.79	4	4	12	5.3					0.4
7.79	4	4	12	5.3					0.4
7.79	4	4	12	5.3					0.4
7.79	4	4	12	5.3					0.4
7.79	4	4	12	5.3					0.4
7.80	4	4	12	5.3					0.4
7.80	4	4	12	5.3					0.4
7.80	4	4	12	5.3					0.4
7.81	4	4	12	5.3					0.4
7.81	4	4	12	5.3					0.4
7.82	4	4	12	5.3					0.4
7.82	4	4	12	5.3					0.4
7.83	4	4	12	5.3					0.4
7.84	4	4	12	5.3					0.4
7.84	4	4	12	5.3					0.4
SUBTOTAL				348.2	32.0	50.0	5.3	53.3	47.0
TOTAL				349	32	50	6	54	47

PARTIAL DEPTH PATCHING NOTES:

- APPLICATION RATES USED FOR QUANTITY ESTIMATES ARE AS FOLLOWS:
HOT-MIX ASPHALT: (PATCHING)

112 LBS/SY/INCH THICKNESS

FULL DEPTH PATCHING

LOCATION	LANE	LENGTH (FEET)	WIDTH (FEET)	CL B PATCH T2 12 (SQ YD)	CL B PATCH T2 20 (SQ YD)	DOWEL BARS 1 1/2 INCH (EACH)	SAWCUT (FT)
6.70	4	6	12		8.0	20	48.0
6.70	5	8	12		10.7	20	52.0
7.05	1	8	12	10.7		20	52.0
TOTAL				10.7	18.7	60.0	152.0
TOTAL				11	19	60	152

MODEL: Default; FILE: M:\11270CADDD_Schedule076R69 - 1270CADDD_Schedule076R69_Schedules.dgn



USER NAME = amontero	DESIGNED -	REVISED -
PLOT SCALE = 100.0000' / in.	DRAWN -	REVISED -
PLOT DATE = 3/1/2023	CHECKED -	REVISED -
	DATE -	REVISED -

**STATE OF ILLINOIS
DEPARTMENT OF TRANSPORTATION**

SCHEDULES	
SCALE: NTS	SHEET 1 OF 1 SHEETS STA. TO STA.

F.A.I. RTE.	SECTION	COUNTY	TOTAL SHEETS	SHEET NO.
270	60-1PP	MADISON	6	5
CONTRACT NO. 76R69				
ILLINOIS FED. AID PROJECT				

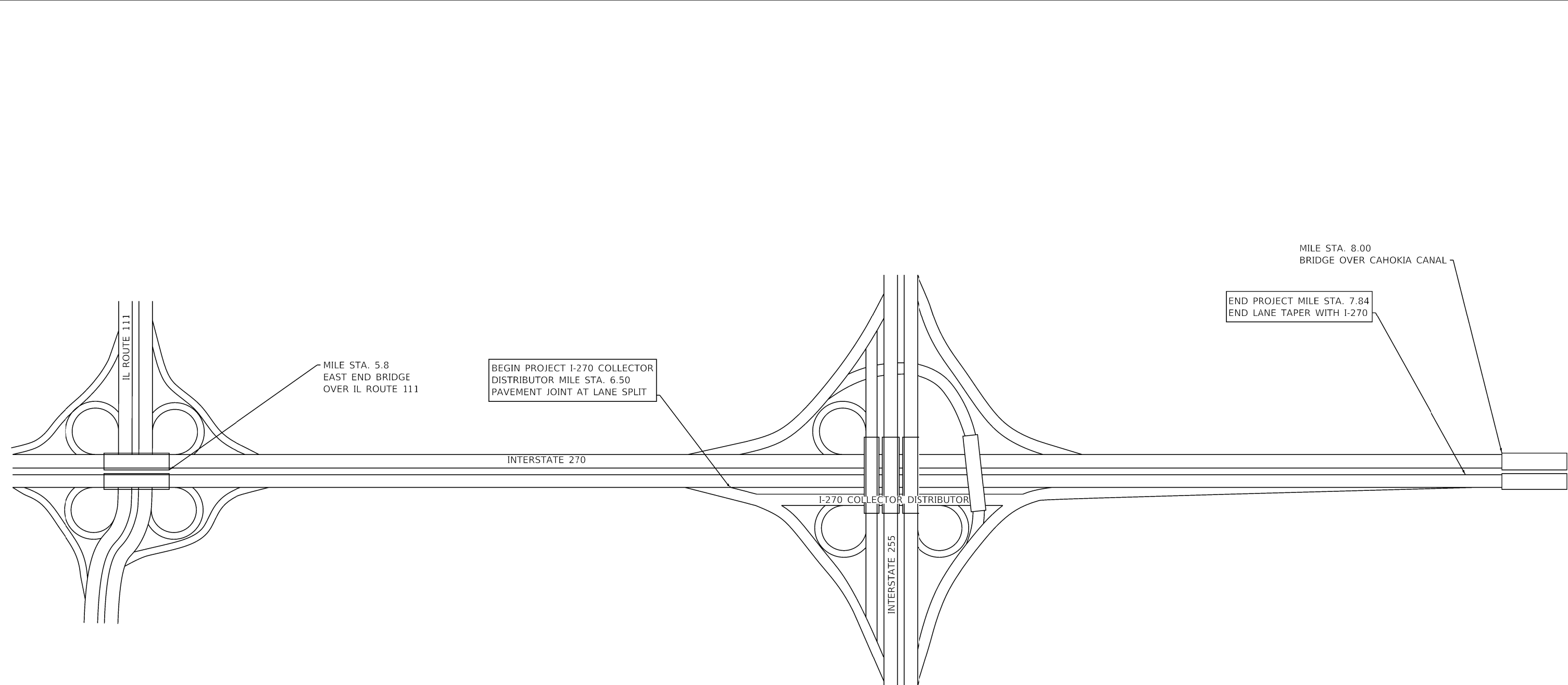

MODEL: Default
 FILE NAME: V:\32349_PTB_199_0228249_020_W03_Various_Pkchng\76R69 - I-270\CADD_Sheets\07_76R69_Plan.dgn



USER NAME = amontero	DESIGNED -	REVISED -
	DRAWN -	REVISED -
PLOT SCALE = 40,0000' / in.	CHECKED -	REVISED -
PLOT DATE = 3/1/2023	DATE -	REVISED -

STATE OF ILLINOIS
DEPARTMENT OF TRANSPORTATION

LOCATION MAP
PLAN SHEET

SCALE: NTS SHEET 1 OF 1 SHEETS STA. TO STA.

F.A.I. RTE.	SECTION	COUNTY	TOTAL SHEETS	SHEET NO.
270	60-1PP	MADISON	6	6
CONTRACT NO. 76R69			ILLINOIS FED. AID PROJECT	