

## INDEX OF SHEETS

1	COVER SHEET
2	INDEX OF SHEETS, HIGHWAY STANDARDS, GENERAL NOTES, MIX CHART & COMMITMENTS
3-4	SUMMARY OF QUANTITIES
5-6	TYPICAL SECTIONS
7-10	SCHEDULE OF QUANTITIES
11	LOCATION MAP
12	CHANGEABLE MESSAGE SIGN LOCATIONS
13	APPROACH DETAILS
14-18	DETECTOR LOOP DETAILS

## HIGHWAY STANDARDS

000001-08	STANDARD SYMBOLS, ABBREVIATIONS AND PATTERNS
001006	DECIMAL OF AN INCH AND OF A FOOT
701400-11	APPROACH TO LANE CLOSURE, FREEWAY / EXPRESSWAY
701401-13	LANE CLOSURE, FREEWAY / EXPRESSWAY
701411-09	LANE CLOSURE, MULTILANE, AT ENTRANCE OR EXIT RAMP FOR SPEEDS ≥ 45 MPH
701426-09	LANE CLOSURE, MULTILANE, INTERMITTENT OR MOVING OPER., FOR SPEEDS ≥ 45 MPH
701428-01	TRAFFIC CONTROL SETUP AND REMOVAL FREEWAY / EXPRESSWAY
701456-05	PARTIAL EXIT RAMP CLOSURE FREEWAY / EXPRESSWAY
701901-08	TRAFFIC CONTROL DEVICES
780001-05	TYPICAL PAVEMENT MARKINGS
781001-04	TYPICAL APPLICATIONS RAISED REFLECTIVE PAVEMENT MARKERS
886001-01	DETECTOR LOOP INSTALLATIONS

## GENERAL NOTES

1. UTILITIES KNOWN TO HAVE FACILITIES WITHIN THE PROJECT AREA:

- AMEREN ILLINOIS
- AT&T ILLINOIS
- VILLAGE OF BETHALTO
- BUCKEYE PARTNERS L.P. - WOOD RIVER PIPE LINE
- CHARTER COMMUNICATIONS, INC.
- EVERSTREAM GLC HOLDING COMPANY LLC
- FOSTERBURG WATER DISTRICT
- ILLINOIS AMERICAN WATER COMPANY
- MARATHON PIPE LINE LLC
- PLAINES MARKETING, LP
- ROSEWOOD HEIGHTS SANITARY DISTRICT
- VILLAGE OF ROXANA
- CITY OF WOOD RIVER

2. NO SURVEY WAS PERFORMED FOR THIS PROJECT AND THE PLANS WERE CREATED USING MICROFILM AND FIELD MEASUREMENTS.

3. THE DEPARTMENT STRONGLY ENCOURAGES THE PRIME CONTRACTOR AND THEIR APPROVED SUB-CONTRACTORS TO HIRE MINORITY, WOMEN AND DISADVANTAGED INDIVIDUALS FROM ITS FEDERALLY FUNDED HIGHWAY CONSTRUCTION CAREERS TRAINING PROGRAM (HCCTP) TO HELP MEET WORKFORCE AND TRAINEE GOALS. THIS PROGRAM IS TRAINING MINORITIES, WOMEN AND DISADVANTAGED INDIVIDUALS IN HIGHWAY CONSTRUCTION-RELATED SKILLS, E.G., MATH FOR THE TRADES, JOB READINESS, TECHNICAL SKILLS COURSEWORK (CARPENTRY, CONCRETE FLATWORK, BLUEPRINT READING, SITE PLANS, SITE WORK, TOOLS USE, ETC.) AND OSHA 10 HOUR CERTIFICATION, TO PREPARE THEM FOR A CAREER IN THE HIGHWAY CONSTRUCTION TRADES. GRADUATES ARE WELL-TRAINED AND READY TO BECOME PRODUCTIVE ENTRY-LEVEL CONSTRUCTION WORKERS. CONTACT THE DISTRICT 8 EEO OFFICE AT 618-346-3360 AND/OR THE HCCTP COORDINATOR AT 618-874-6528 TO LEARN MORE ABOUT THE PROGRAM AND FOR ASSISTANCE IN MEETING WORKFORCE AND TRAINEE GOALS.

4. THE MATERIAL TRANSFER DEVICE CAN CROSS IN AN UNLOADED CONDITION ON ALL STRUCTURES WITHIN THE PROJECT LIMITS.

5. TWELVE (12) CHANGEABLE MESSAGE SIGNS SHALL BE PLACED 14 DAYS IN ADVANCE OF CONSTRUCTION. SEE MESSAGE BOARD LOCATION SHEET FOR LOCATION AND DURATION OF EACH MESSAGE SIGN.

6. LOCATING UNDERGROUND CABLE FOR DETECTOR LOOP INSTALLATION SHALL BE PAID FOR UNDER ARTICLE 109.04 OF THE STANDARD SPECIFICATIONS.

7. OMITTED



8. NO TRAFFIC SHALL BE ALLOWED TO DRIVE ON MILLED SURFACES EXCEPT FOR TO CROSS OVER AT RAMP ENTRANCE/EXIT LOCATIONS.

9. 20 TONS OF HOT-MIX ASPHALT BINDER COURSE HAS BEEN ADDED TO THE SUMMARY OF QUANTITIES TO REPAIR TWO DIP LOCATIONS WITHIN THE PROJECT. THE FIRST LOCATION IS IN THE NB LANE AT MILE MARKER 9.5 AND THE SECOND LOCATION IS IN THE NB AND SB LANES AT MILE MARKER 8.1. THE REPAIR WILL BE COMPLETED AT THE DIRECTION OF THE ENGINEER.

10. PAINT PAVEMENT MARKING LETTERS AND SYMBOLS PAY ITEM HAS BEEN INCLUDED TO PUT BACK THE TRIANGLES ON THE SHOULDERS MARKING UNDERDRAIN OUTLETS.

## MIX CHART

MIXTURE USE	SURFACE	SHOULDER ≤ 8 FEET WIDE		SHOULDER > 8 FEET WIDE	
			SHOULDER (surface)		SHOULDER (surface)
AC/PG	PG 64-22		PG 64-22		PG 64-22
DESIGN AIR VOIDS	4.0% @ Ndes=90		4.0% @ Ndes=30		4.0% @ Ndes=30
MIX COMPOSITION (Gradation)	IL 9.5		IL 9.5L		IL 9.5L
FRICTION AGG	MIXTURE "E"				
QUALITY MGMT PROGRAM	PFP		QC/QA		QCP
MatTranDev Required?	yes		no		yes

MIXTURE USE	PATCHING	BINDER	
AC/PG	PG 64-22		PG 64-22
DESIGN AIR VOIDS	4.0% @ Ndes=90		4.0% @ Ndes=90
MIX COMPOSITION (Gradation)	IL 19.0		IL 9.5 FG
FRICTION AGG	MIXTURE "B"		MIXTURE "C"
QUALITY MGMT PROGRAM	QC/QA		QC/QA
MatTranDev Required?	no		no

MIXTURE USE				
AC/PG				
DESIGN AIR VOIDS				
MIX COMPOSITION (Gradation)				
FRICTION AGG				
QUALITY MGMT PROGRAM				
MatTranDev Required?				

Plan quantities for Hot-Mix Asphalt items are calculated using a unit weight of 112 lb/sq yd/in (59.8 kg/sq m/25 mm thickness). Any QCP Pay Item that has a quantity of 1600 tons or less will have two sublots each of which will be half of the Plan Quantity or half of the Adjusted Quantity by the Resident Engineer/Technician.

## COMMITMENTS

NONE

STATE OF ILLINOIS  
DEPARTMENT OF TRANSPORTATION

INDEX OF SHEETS, HIGHWAY STANDARDS,  
GENERAL NOTES, MIX CHART & COMMITMENTS

REVISOR SHEET 6/5/2023

MODEL: Default  
FILE: \\nas01-pw-bechtel.com\pww\DOT\Documents\DOT\_Offices\Dir\dr. B\Projects\0876840\CADD\Drawings\0876840-Sub-Generators.dgn

USER NAME = Karen.Challandes	DESIGNED -	REVISED -
	DRAWN -	REVISED -
PLOT SCALE = 100.0000' / in.	CHECKED -	REVISED -
PLOT DATE = 3/20/2023	DATE -	REVISED -

SCALE: SHEET 1 OF 1 SHEETS STA. TO STA.

F.A.P. RTE.	SECTION	COUNTY	TOTAL SHEETS	SHEET NO.
310	60-(12,13,14)RS-3 (60-9)RS-3	MADISON	18	2
CONTRACT NO. 76R40				
ILLINOIS		FED. AID PROJECT		

CODE NO.	ITEM	UNIT	TOTAL QUANTITY	CONSTR. CODE
				80% FED/ 20% STATE
				ROADWAY
				0005 URBAN
40600290	BITUMINOUS MATERIALS (TACK COAT)	POUND	253940	253940
<del>40600370</del>	<del>LONGITUDINAL JOINT SEALANT</del>	<del>FOOT</del>	<del>116836</del>	<del>116836</del>
40600372	LONGITUDINAL JOINT SEALANT, HALF - WIDTH	FOOT	233672	233672
40600990	TEMPORARY RAMP	SQ YD	1692	1692
40602975	HOT-MIX ASPHALT BINDER COURSE, IL-9.5FG, N90	TON	37	37
40604074	HOT-MIX ASPHALT SURFACE COURSE, IL-9.5, MIX "E", N90	TON	38546	38546
44000157	HOT-MIX ASPHALT SURFACE REMOVAL, 2"	SQ YD	563769	563769
44200196	PAVEMENT PATCHING, TYPE III, 16 INCH	SQ YD	20	20
44200198	PAVEMENT PATCHING, TYPE IV, 16 INCH	SQ YD	31	31
48203100	HOT-MIX ASPHALT SHOULDERS	TON	24653	24653
64200116	SHOULDER RUMBLE STRIPS, 16 INCH	FOOT	188007	188007
67000400	ENGINEER'S FIELD OFFICE, TYPE A	CAL MO	8	8
67100100	MOBILIZATION	L SUM	1	1
70100420	TRAFFIC CONTROL AND PROTECTION, STANDARD 701411	EACH	18	18
70100800	TRAFFIC CONTROL AND PROTECTION, STANDARD 701401	L SUM	1	1

CODE NO.	ITEM	UNIT	TOTAL QUANTITY	CONSTR. CODE
				80% FED/ 20% STATE
				ROADWAY
				0005 URBAN
70100825	TRAFFIC CONTROL AND PROTECTION, STANDARD 701456	L SUM	1	1
70107025	CHANGEABLE MESSAGE SIGN	CAL DA	580	580
70300100	SHORT TERM PAVEMENT MARKING	FOOT	56858	56858
70300150	SHORT TERM PAVEMENT MARKING REMOVAL	SQ FT	9476	9476
70300211	TEMPORARY PAVEMENT MARKING LETTERS AND SYMBOLS - PAINT	SQ FT	387	387
70300241	TEMPORARY PAVEMENT MARKING - LINE 6" - PAINT	FOOT	274382	274382
70300251	TEMPORARY PAVEMENT MARKING - LINE 8" - PAINT	FOOT	19385	19385
70300261	TEMPORARY PAVEMENT MARKING - LINE 12" - PAINT	FOOT	254	254
70300281	TEMPORARY PAVEMENT MARKING - LINE 24" - PAINT	FOOT	81	81
* 78001100	PAINT PAVEMENT MARKING - LETTERS AND SYMBOLS	SQ FT	350	350
* 78003101	PREFORMED PLASTIC PAVEMENT MARKING, TYPE B - STANDARD - LETTERS AND SYMBOLS	SQ FT	387	387
* 78003131	PREFORMED PLASTIC PAVEMENT MARKING, TYPE B - STANDARD - LINE 6"	FOOT	274382	274382
* 78003141	PREFORMED PLASTIC PAVEMENT MARKING, TYPE B - STANDARD - LINE 8"	FOOT	19385	19385
* 78003151	PREFORMED PLASTIC PAVEMENT MARKING, TYPE B - STANDARD - LINE 12"	FOOT	254	254

\* SPECIALTY ITEM

MODEL: Default  
 FILE: M:\GIS\p101112424\Bentley.com\PROJECTS\DOT\_01\1112424\DOT\_01\1112424\1112424.dwg  
 PLOT DATE = 3/20/2023

REV. - MS  
 REVISION SHEET 6/5/2023

USER NAME = Karen.Challandes DESIGNED - DRAWN - PLOT SCALE = 100.0000' / in. CHECKED - PLOT DATE = 3/20/2023 DATE -	REVISED - REVISED - REVISED - REVISED -	STATE OF ILLINOIS DEPARTMENT OF TRANSPORTATION	SUMMARY OF QUANTITIES SCALE: SHEET 1 OF 2 SHEETS STA. TO STA.	F.A.P. RTE. SECTION COUNTY TOTAL SHEETS SHEET NO. 310 60-(12,13,14)RS-3 (60-9)RS-3 MADISON 18 3 CONTRACT NO. 76R40 ILLINOIS FED. AID PROJECT
---	--	---	--	---

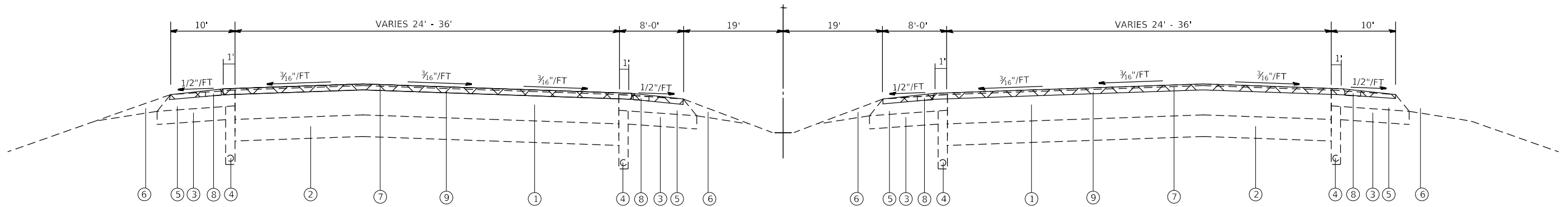

IL 255 - EXISTING TYPICAL SECTION  
 MILE 0.24 - MILE 0.67  
 MILE 0.95 - MILE 1.20  
 MILE 1.88 - MILE 2.27  
 MILE 3.03 - MILE 3.48  
 MILE 4.08 - MILE 4.17  
 MILE 6.55 - MILE 6.72  
 MILE 7.27 - MILE 7.39  
 MILE 9.1 - MILE 9.39

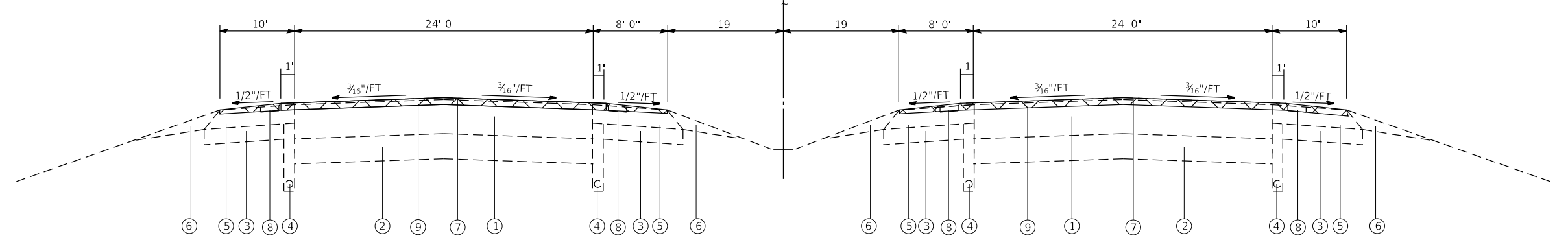

IL 255 - EXISTING TYPICAL SECTION  
 MILE 0.00 - MILE 0.24  
 MILE 0.67 - MILE 0.95  
 MILE 1.20 - MILE 1.88  
 MILE 2.27 - MILE 3.03  
 MILE 3.48 - MILE 4.08  
 MILE 4.17 - MILE 6.55  
 MILE 6.72 - MILE 7.27  
 MILE 7.39 - MILE 9.1  
 MILE 9.39 - MILE 10.07

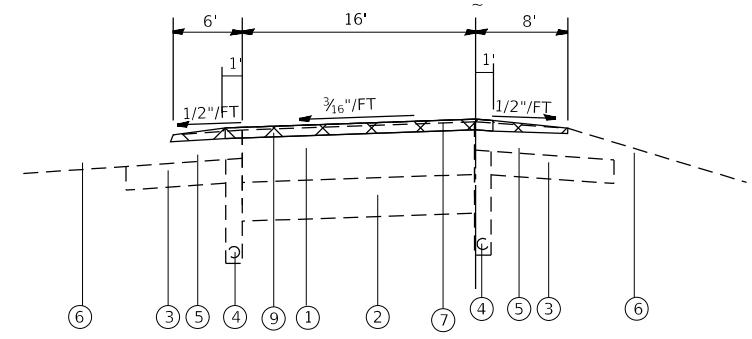

RAMP - EXISTING TYPICAL SECTION  
 IL 143 (RAMPS 1,2)  
 IL 111 (RAMPS 1,2,3,4)  
 IL 140 (RAMPS 1,2,3,4)  
 FOSTERBURG RD (RAMPS 1,2,3,4)  
 SEMINARY RD (RAMPS 1,2,3,4)

**LEGEND**

- ① EXISTING HMA FULL-DEPTH PAVEMENT, 16 1/2"
- ② EXISTING LIME MODIFIED SOIL, 12"
- ③ EXISTING STABILIZED SUB-BASE, 4"
- ④ EXISTING PIPE UNDERDRAIN, 4"
- ⑤ EXISTING HMA SHOULDERS
- ⑥ EXISTING AGG. SHOULDERS
- ⑦ EXISTING MICRO-SURFACING
- ⑧ EXISTING SHOULDER RUMBLE STRIP
- ⑨ PROPOSED HOT-MIX ASPHALT SURFACE  
REMOVAL 2"
- ⑩ PROPOSED LONGITUDINAL JOINT SEALANT (HALF-WIDTH)
- ⑪ PROPOSED BITUMINOUS MATERIALS (TACK COAT)
- ⑫ PROPOSED HOT-MIX ASPHALT SURFACE COURSE,  
IL-9.5, MIX "E", N90
- ⑬ PROPOSED PREFORMED PLASTIC PAVEMENT  
MARKING, TYPE B
- ⑭ PROPOSED HMA SHOULDERS
- ⑮ PROPOSED SHOULDER RUMBLE STRIPS 16"

**1** REVISED SHEET 6/5/2023

MODEL: Default  
 FILE: \\bls01\caw\_bentley.com\PIV\DOT\Documents\DOT\_Offices\Bhndr\B\Projects\0876840\CADD\Drawings\0876840-Sub\Typical.dgn

USER NAME = Karen.Challandes	DESIGNED -	REVISED -
	DRAWN -	REVISED -
PLOT SCALE = 100,0000' / in.	CHECKED -	REVISED -
PLOT DATE = 6/5/2023	DATE -	REVISED -

**STATE OF ILLINOIS  
 DEPARTMENT OF TRANSPORTATION**

**EXISTING TYPICAL SECTIONS**

SCALE: SHEET 1 OF 2 SHEETS STA. TO STA.

F.A.P. RTE.	SECTION	COUNTY	TOTAL SHEETS	SHEET NO.
310	60-(12,13,14)RS-3 (60-9)RS-3	MADISON	18	5
CONTRACT NO. 76R40			ILLINOIS FED. AID PROJECT	

IL 255 - NORTHBOUND MAINLINE PAVING SCHEDULE									
LOCATION	HMA SURFACE REMOVAL, 2"	HOT-MIX ASPHALT SURFACE COURSE, IL 9.5, MIX "E", N90	BITUMINOUS MATERIALS (TACK COAT)	LONGINTUDINAL JOINT SEALANT HALF WIDTH	PCC SURFACE REMOVAL (VARIABLE DEPTH)	HMA SURFACE REMOVAL (VARIABLE DEPTH)	HOT-MIX ASPHALT BINDER COURSE, IL 9.5FG, N90	TEMPORARY RAMP	RUMBLE STRIPS
MILE MARKER - MILE MARKER	SQ YD	TON	POUND	FOOT	SQ YD	SQ YD	TON	SQ YD	FOOT
0.00 - 1.49	21151	2369	9518	20716				30	13275
IL 111 BRIDGE OMISSION								59	
1.56 - 3.75	30818	3452	13868	31032					19135
IL 140 BRIDGE OMISSION								59	
3.86 - 4.97	15476	1748	7024	12518	133		7		11025
EAST FORK BRIDGE OMISSION								59	
5.04 - 7.05	27413	3085	12396	21136	58	187	16		20260
FOSTERBURG RD. BRIDGE OMISSION								59	
7.10 - 8.38	17604	1972	7922	14366					12490
WEST FORK BRIDGE OMISSION								59	
8.53 - 9.82	17888	2003	8050	13984					13120
SEMINARY RD. BRIDGE OMISSION								59	
9.86 - 10.0	5547	621	2496	5694				30	2881
SUB TOTAL	135897	15250	61274	119446	191	187	23	414	92186

RAMP MAINLINE PAVING SCHEDULE				
LOCATION	HMA SURFACE REMOVAL, 2"	HOT-MIX ASPHALT SURFACE COURSE, IL 9.5, MIX "E", N90	BITUMINOUS MATERIALS (TACK COAT)	TEMPORARY RAMP
MILE MARKER - MILE MARKER	SQ YD	TON	POUND	SQ YD
IL 143 RAMP 1 (0.00 - 0.34)	6636	743	2986	48
IL 143 RAMP 2 (0.00 - 0.43)	4277	479	1925	48
IL 111 RAMP 1 (0.00 - 0.40)	3777	423	1700	48
IL 111 RAMP 2 (0.00 - 0.39)	4338	486	1952	48
IL 111 RAMP 3 (0.00 - 0.25)	5171	579	2327	48
IL 111 RAMP 4 (0.00 - 0.52)	5271	590	2372	48
IL 140 RAMP 1 (0.00 - 0.28)	5326	597	2397	48
IL 140 RAMP 2 (0.00 - 0.29)	5584	625	2513	48
IL 140 RAMP 3 (0.00 - 0.37)	2843	318	1279	48
IL 140 RAMP 4 (0.00 - 0.30)	2856	320	1285	48
FOSTERBURG RD. RAMP 1 (0.00 - 0.32)	3490	391	1571	48
FOSTERBURG RD. RAMP 2 (0.00 - 0.47)	4047	453	1821	48
FOSTERBURG RD. RAMP 3 (0.00 - 0.44)	3929	440	1768	48
FOSTERBURG RD. RAMP 4 (0.00 - 0.34)	3571	400	1607	48
SEMINARY RD. RAMP 1 (0.00 - 0.38)	3008	337	1354	48
SEMINARY RD. RAMP 2 (0.00 - 0.45)	3165	354	1424	48
SEMINARY RD. RAMP 3 (0.00 - 0.16)	2630	295	1184	48
SEMINARY RD. RAMP 4 (0.00 - 0.15)	2457	275	1106	48
SUB TOTAL	72376	8105	32571	864

IL 255 - SOUTHBOUND MAINLINE PAVING SCHEDULE								
LOCATION	HMA SURFACE REMOVAL, 2"	HOT-MIX ASPHALT SURFACE COURSE, IL 9.5, MIX "E", N90	BITUMINOUS MATERIALS (TACK COAT)	LONGINTUDINAL JOINT SEALANT HALF WIDTH	PCC SURFACE REMOVAL (VARIABLE DEPTH)	HOT-MIX ASPHALT BINDER COURSE, IL 9.5FG, N90	TEMPORARY RAMP	RUMBLE STRIPS
MILE MARKER - MILE MARKER	SQ YD	TON	POUND	FOOT	SQ YD	TON	SQ YD	FOOT
0.00 - 1.49	20770	2326	9347	17256			30	14750
IL 111 BRIDGE OMISSION							59	
1.56 - 3.75	31031	3475	13964	27788				21326
IL 140 BRIDGE OMISSION							59	
3.86 - 4.97	15250	1723	6922	13812	133	7		11095
EAST FORK BRIDGE OMISSION							59	
5.04 - 7.05	27469	3091	12421	22472	133	7		19836
FOSTERBURG RD. BRIDGE OMISSION							59	
7.10 - 8.38	17603	1972	7921	13720				12900
WEST FORK BRIDGE OMISSION							59	
8.53 - 9.82	17704	1983	7967	14560				12560
SEMINARY RD. BRIDGE OMISSION							59	
9.86 - 10.0	5547	621	2496	4618			30	3354
SUB TOTAL	135374	15191	61038	114226	266	14	414	95821

RAMPS SHOULDER PAVING SCHEDULE			
LOCATION	HMA SURFACE REMOVAL, 2"	HMA SHOULDERS	BITUMINOUS MATERIALS (TACK COAT)
MILE MARKER - MILE MARKER	SQ YD	TON	POUND
IL 143 RAMP 1 (0.00 - 0.34)	2953	331	1329
IL 143 RAMP 2 (0.00 - 0.43)	3295	369	1483
IL 111 RAMP 1 (0.00 - 0.40)	3119	349	1404
IL 111 RAMP 2 (0.00 - 0.39)	3972	445	1787
IL 111 RAMP 3 (0.00 - 0.25)	2204	247	992
IL 111 RAMP 4 (0.00 - 0.52)	4560	511	2052
IL 140 RAMP 1 (0.00 - 0.28)	2037	228	917
IL 140 RAMP 2 (0.00 - 0.29)	2473	277	1113
IL 140 RAMP 3 (0.00 - 0.37)	2681	300	1206
IL 140 RAMP 4 (0.00 - 0.30)	2329	261	1048
FOSTERBURG RD. RAMP 1 (0.00 - 0.32)	2624	294	1181
FOSTERBURG RD. RAMP 2 (0.00 - 0.47)	3498	392	1574
FOSTERBURG RD. RAMP 3 (0.00 - 0.44)	3234	362	1455
FOSTERBURG RD. RAMP 4 (0.00 - 0.34)	3098	347	1394
SEMINARY RD. RAMP 1 (0.00 - 0.38)	2082	233	937
SEMINARY RD. RAMP 2 (0.00 - 0.45)	2147	240	966
SEMINARY RD. RAMP 3 (0.00 - 0.16)	3362	377	1513
SEMINARY RD. RAMP 4 (0.00 - 0.15)	3531	395	1589
SUB TOTAL	53199	5958	23940

MAINLINE SHOULDER PAVING SCHEDULE			
LOCATION	HMA SURFACE REMOVAL, 2"	HMA SHOULDERS	BITUMINOUS MATERIALS (TACK COAT)
MILE MARKER - MILE MARKER	SQ YD	TON	POUND
0.00 - 1.49	25439	2849	11448
IL 111 BRIDGE OMISSION			
1.56 - 3.75	39075	4376	17584
IL 140 BRIDGE OMISSION			
3.86 - 4.97	19660	2202	8847
EAST FORK BRIDGE OMISSION			
5.04 - 7.05	36399	4077	16380
FOSTERBURG RD. BRIDGE OMISSION			
7.10 - 8.38	17305	1938	7787
WEST FORK BRIDGE OMISSION			
8.53 - 9.82	21495	2407	9673
SEMINARY RD. BRIDGE OMISSION			
9.86 - 10.0	7550	846	3398
SUB TOTAL	166923	18695	75117

PAVEMENT PATCHING, 16" SCHEDULE						
PATCH	MILE	LOCATION	LENGTH	WIDTH	AREA	TYPE III / TYPE IV
1	0.65	NB DRIVING LANE	20	12	26.7	26.7
2	0.30	FOSTERBURG RD RAMP 4	10	16	17.8	17.8
SUBTOTAL					44.4	26.7
TOTALS WITH 15% ADD ON					51	31

MODEL: Default  
 FILE: \\nas01-paw.bentley.com\FWIDOT\Documents\DOT\_Offices\Bharte, B\Projects\0876840\CAD\Sheet\0876840-sh-schedule.dgn

USER NAME = Karen.Challandes	DESIGNED -	REVISED -
PLOT SCALE = 100,0000' / in.	DRAWN -	REVISED -
PLOT DATE = 6/5/2023	CHECKED -	REVISED -
	DATE -	REVISED -

**STATE OF ILLINOIS**  
**DEPARTMENT OF TRANSPORTATION**

SCHEDULES			
SCALE:	SHEET 1	OF 4 SHEETS	STA. TO STA.

F.A.P. RTE.	SECTION	COUNTY	TOTAL SHEETS	SHEET NO.
310	60-(12,13,14)RS-3 (60-9)RS-3	MADISON	18	7
CONTRACT NO. 76R40			ILLINOIS / FED. AID PROJECT	

REVISED SHEET 6/5/2023