

F.A. RTE.	SECTION	COUNTY	TOTAL SHEETS	SHEET NO.
VAR.	D5 INLAY 2017-1	*	23	1
* CHAMPAIGN & DOUGLAS ILLINOIS			CONTRACT NO. 70C68	

06-16-2017 LETTING ITEM 022

STATE OF ILLINOIS  
DEPARTMENT OF TRANSPORTATION

# PROPOSED HIGHWAY PLANS

VARIOUS ROUTES  
SECTION D5 INLAY 2017-1

RESURFACING INTERMITTENT  
CHAMPAIGN & DOUGLAS COUNTIES

C-95-025-17

AT WASHINGTON ST IN TUSCOLA & AT I-72 RAMPS S OF MAHOMET

FOR INDEX OF SHEETS, SEE SHEET NO. 2  
FOR SUMMARY OF QUANTITIES, SEE SHEET NO. 4-6

CURRENT ADT			
	LOC. #1	LOC. #2	LOC. #3
ADT (2017)	5,850	4,500	1,000

**TRAFFIC DATA LOCATIONS**

LOC. #1 = US 36 FROM US 45 TO WASHINGTON ST IN TUSCOLA.  
LOC. #2 = IL 47 OVER I-72 IN CHAMPAIGN COUNTY.  
LOC. #3 = I-72 RAMPS AT IL 47 (ADT IS PER RAMP).

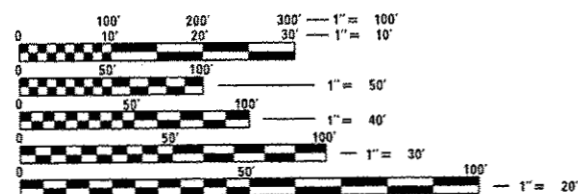
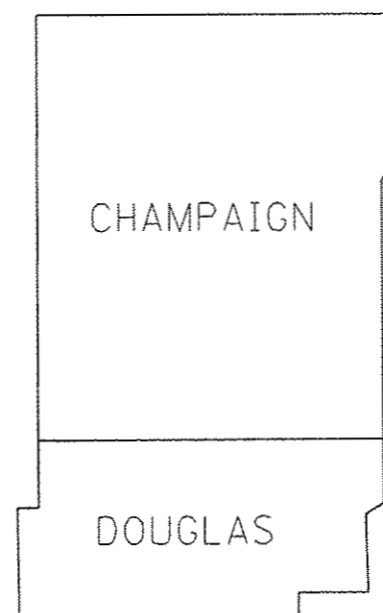
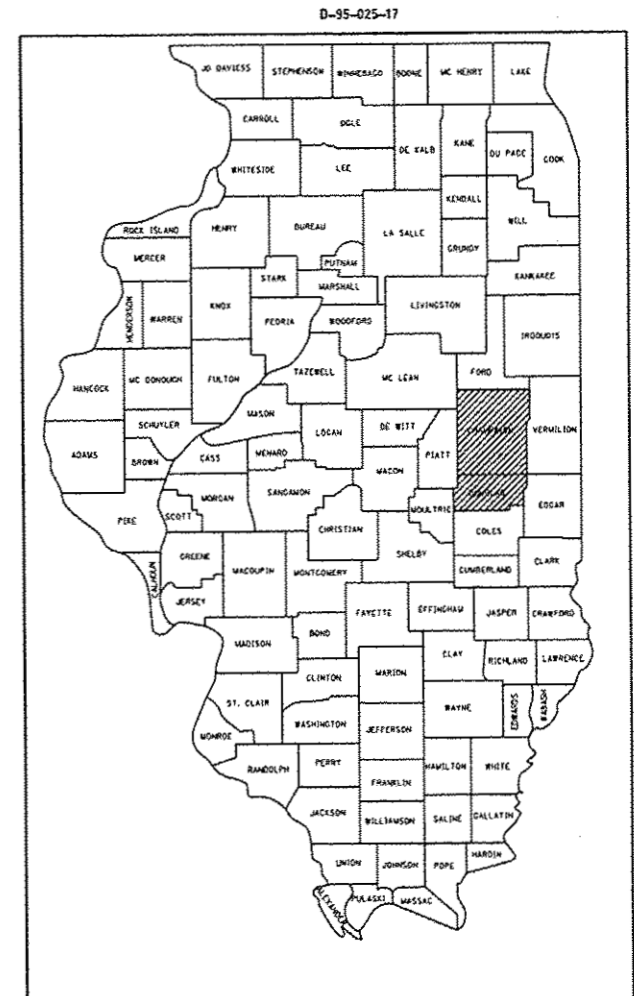

FULL SIZE PLANS HAVE BEEN PREPARED USING STANDARD ENGINEERING SCALES. REDUCED SIZED PLANS WILL NOT CONFORM TO STANDARD SCALES. IN MAKING MEASUREMENTS ON REDUCED PLANS, THE ABOVE SCALES MAY BE USED.

J.U.L.I.E.  
JOINT UTILITY LOCATION INFORMATION FOR EXCAVATION  
1-800-892-0123  
OR 811

PROJECT ENGINEER: NANCY FASIG  
SQUAD LEADER: STEVE COOMBES  
DESIGNER: CHRISTINA GOSNELL  
CONTRACT NO. 70C68

FOR LOCATION MAPS, SEE SHEET NO. 3

STATE OF ILLINOIS  
DEPARTMENT OF TRANSPORTATION

SUBMITTED March 24 2017  
[Signature] REGIONAL ENGINEER

May 10 2017  
Margaret M. Addis, P.E. ENGINEER OF DESIGN AND ENVIRONMENT

[Signature] 2  
DIRECTOR OF PROGRAM DEVELOPMENT

PRINTED BY THE AUTHORITY  
OF THE STATE OF ILLINOIS

# INDEX OF SHEETS

SHEET NO.	DESCRIPTION
1	COVER SHEET
2	INDEX OF SHEETS & LIST OF HIGHWAY STANDARDS
2	GENERAL NOTES
3	LOCATION MAPS
4-6	SUMMARY OF QUANTITIES
7-9	TYPICAL CROSS SECTIONS
10-13	SCHEDULE OF QUANTITIES
14	PLAN SHEET - U.S. 36
15	PLAN SHEET - I 72 & IL 47 INTERCHANGE
16	PAVEMENT MARKING DETAIL - U.S. 36
17	PAVEMENT MARKING DETAIL - I 72 & IL 47 INTERCHANGE
18	CONCRETE MEDIAN, TYPE SM (DOWELLED) DETAIL
19	SIGN POST BLOCKOUTS DETAIL
20-23	PAVEMENT MARKING AND MARKERS (RURAL & URBAN APPLICATIONS) DETAIL

# LIST OF STANDARDS

STANDARD	DESCRIPTION
000001-06	STANDARD SYMBOLS ABBREVIATIONS AND PATTERNS
001006	DECIMAL OF AN INCH AND OF A FOOT
420001-08	PAVEMENT JOINTS
606301-04	PC CONCRETE ISLANDS AND MEDIANS
701201-04	LANE CLOSURE, 2L, 2W, DAY ONLY, FOR SPEEDS $\geq$ 45 MPH
701311-03	LANE CLOSURE 2L, 2W MOVING OPERATIONS - DAY ONLY
701456-04	PARTIAL EXIT RAMP CLOSURE FREEWAY/EXPRESSWAY
701501-06	URBAN LANE CLOSURE, 2L, 2W, UNDIVIDED
701901-06	TRAFFIC CONTROL DEVICES
780001-05	TYPICAL PAVEMENT MARKINGS
781001-04	TYPICAL APPLICATIONS RAISED REFLECTIVE PAVEMENT MARKERS

# GENERAL NOTES

G.N.-100  
ENGLISH UNITS OF MEASUREMENT SHALL GOVERN OVER AND SUPERSEDE ANY METRIC UNITS SHOWN IN THIS CONTRACT. WHERE INCLUDED, METRIC UNITS ARE FOR INFORMATION ONLY.

G.N.-100A  
ELECTRONIC FILES AND/OR ELECTRONIC SURVEY INFORMATION INCLUDING CADD FILES WILL NOT BE AVAILABLE TO THE CONTRACTOR.

G.N.-105.09A  
ALL ELEVATIONS SHOWN IN THE PLANS ARE BASED ON NORTH AMERICAN VERTICAL DATUM OF 1988. (NAVD 88)

G.N.-406  
THE QUANTITIES INCLUDED IN THE PLANS FOR HOT-MIX ASPHALT RESURFACING ARE INTENDED TO GIVE THE COVERAGE SHOWN ON THE TYPICAL CROSS SECTIONS. IT IS NOT INTENDED TO INCREASE THE THICKNESS OF THE HOT-MIX ASPHALT MIXTURE IN ORDER TO USE ALL OF THE QUANTITIES INCLUDED IN THE CONTRACT.

G.N.-406H  
Mixture Requirements Contract: 70C68

Location	I-72, IL-47, & U.S. 36
Mixture Use	Polymer Surface
AC/PG	SBS PG 70-22
Design Air Voids	4.0% @ Ndes=70
Mix Comp(Gradation)	IL 9.5
Friction Aggregate	Mix D
Mixture Weight	112
Quality Management Program	QC/QA
Sublot Size	N.A.

G.N.-440B  
THE EXISTING TIE BARS BETWEEN THE EXISTING PAVEMENT AND EXISTING MEDIANS, GUTTERS AND/OR COMBINATION CURB AND GUTTERS THAT ARE FOUND SUITABLE FOR REUSE SHALL BE CLEANED, STRAIGHTENED AND INCORPORATED INTO THE NEW CONSTRUCTION. ANY EXISTING TIE BARS THAT ARE FOUND UNSUITABLE TO BE INCORPORATED INTO THE PROPOSED CONSTRUCTION DUE TO EXCESSIVE RUSTING OR DISTRESS SHALL BE REMOVED FLUSH WITH THE FACE OF THE EXISTING CONCRETE AND DISPOSED OF OUTSIDE THE LIMITS OF THE RIGHT-OF-WAY IN ACCORDANCE WITH ARTICLE 202.03 OF THE STANDARD SPECIFICATIONS.

THIS WORK WILL NOT BE PAID FOR SEPARATELY BUT SHALL BE CONSIDERED INCLUDED IN THE VARIOUS REMOVAL PAY ITEMS AND NO ADDITIONAL COMPENSATION WILL BE ALLOWED.

G.N.- 703A  
SHORT TERM PAVEMENT MARKING SHALL BE APPLIED TO THE PAVEMENT AFTER ANY OF THE FOLLOWING: COLD MILLING AND/OR PLACING BITUMINOUS MATERIALS (TACK COAT), LEVELING BINDER (MACHINE METHOD), BINDER AND SURFACE COURSES. SHORT TERM PAVEMENT MARKING PLACED ON THE SURFACE SHALL COINCIDE WITH THE FINAL PAVEMENT STRIPING. SHORT TERM PAVEMENT MARKING PLACED PRIOR TO THE SURFACE SHALL COINCIDE WITH THE EXISTING PAVEMENT MARKINGS. USE 4 FEET PER 40 FEET (OR 10% PER STATION).

G.N.- 781  
RAISED REFLECTIVE PAVEMENT MARKERS SHALL BE PLACED IN ACCORDANCE WITH STANDARD 781001 AND THE DETAILS SHOWN IN THE PLANS. IF THERE IS ANY DISCREPANCY BETWEEN THE STANDARD AND THE DETAILS IN THE PLANS, THE DETAILS IN THE PLANS SHALL GOVERN. THE FINAL PAVEMENT MARKINGS SHALL BE IN PLACE PRIOR TO PLACING THE RAISED REFLECTIVE PAVEMENT MARKERS, AND THE RAISED REFLECTIVE PAVEMENT MARKER SHALL BE PLACED MIDWAY IN THE 30 FOOT (9m) SPACE BETWEEN THE DASHED CENTERLINE STRIPES (WHEN APPLICABLE).

COMMITMENTS:  
THERE ARE NO COMMITMENTS FOR THIS CONTRACT.

STATE OF ILLINOIS  
DEPARTMENT OF TRANSPORTATION

INDEX OF SHEETS  
LIST OF STANDARDS & GENERAL NOTES

F.A. RTE.	SECTION	COUNTY	TOTAL SHEETS	SHEET NO.
VAR.	05 INLAY 2017-1	*	23	2
* CHAMPAIGN & DOUGLAS			CONTRACT NO. 70C68	
ILLINOIS FED. AID PROJECT				

FILE NAME	USER NAME	DESIGNED	REVISED
\\IL084EBIOINTEG\illinois.gov\PI001\Documents\DOT Offices\District 5\Projects\0570C68\0570C68-SHT-Cover.dwg	dodgms	-	-
		CHECKED	REVISED
		DATE	REVISED

MODEL NAME	PLT SCALE	PLT DATE
	48.0000 / in.	3/24/2017

SCALE:	SHEET	OF	SHEETS	STA.	TO	STA.

**LOCATION #1 MAP  
U.S. 36 IN DOUGLAS COUNTY**

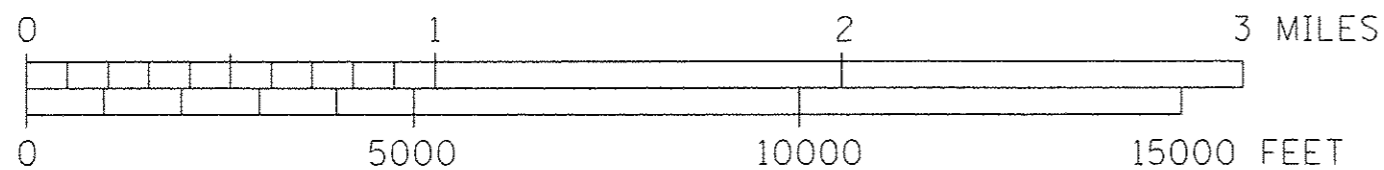
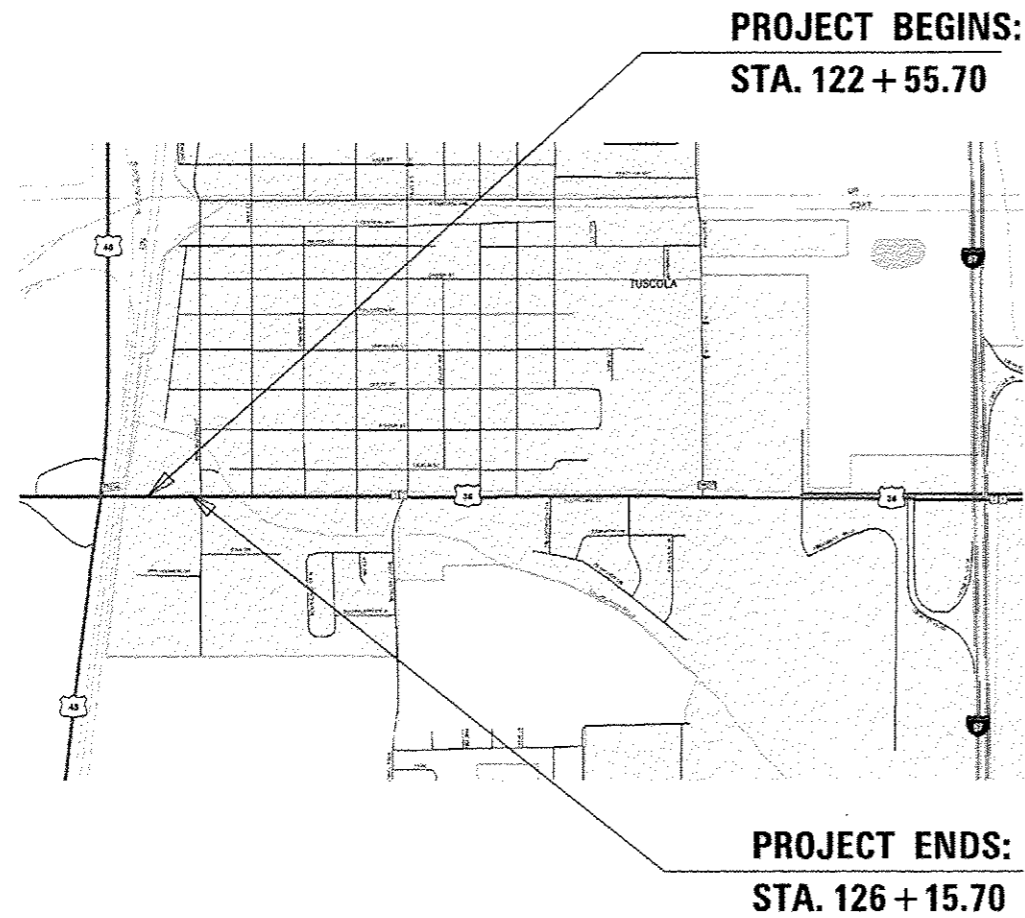

GROSS LENGTH = 360.00 FT. = 0.068 MILE  
NET LENGTH = 360.00 FT. = 0.068 MILE

**LOCATION #2 MAP  
IL 47 & I-72 IN CHAMPAIGN COUNTY**

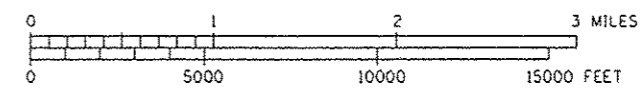
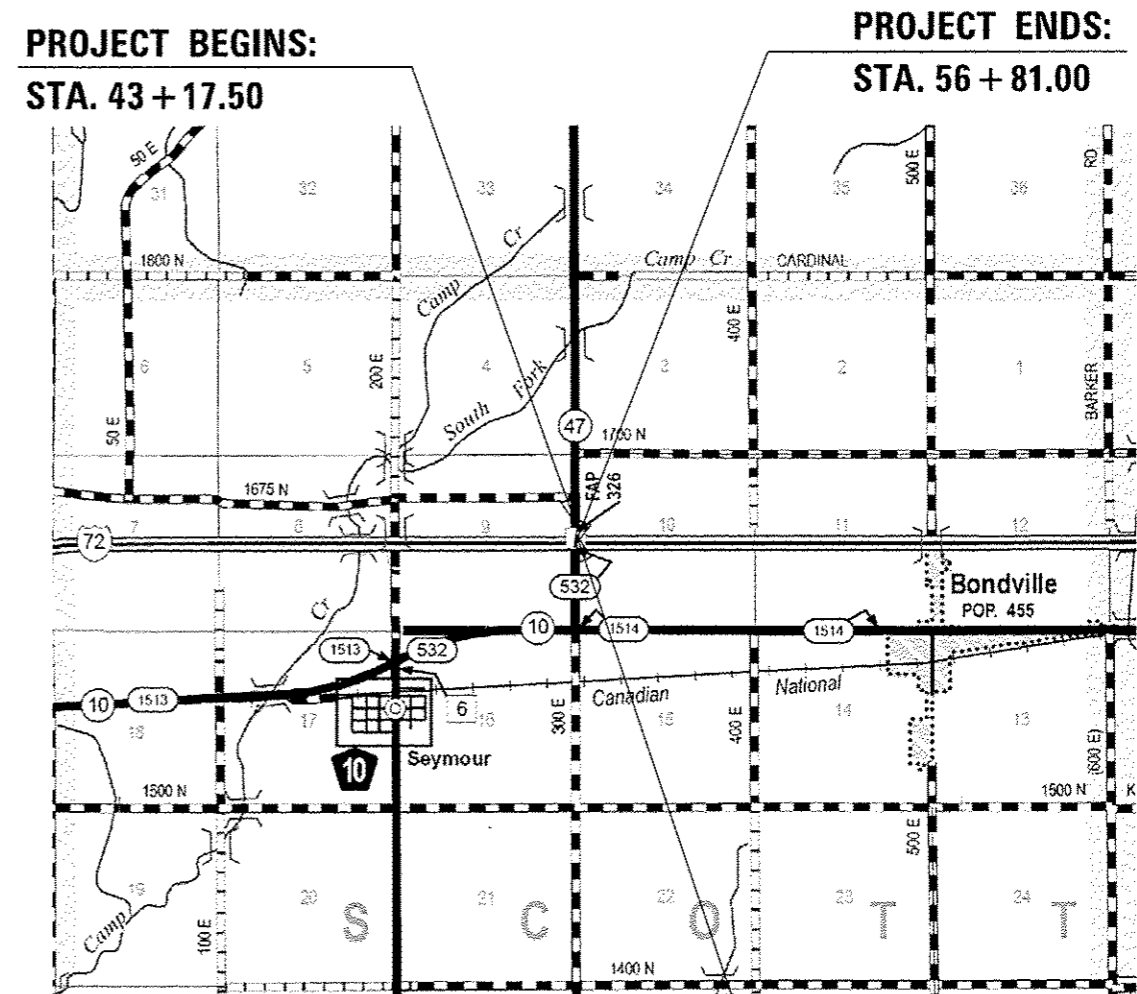

GROSS LENGTH = 1,363.50 FT. = 0.258 MILE  
NET LENGTH = 243.00 FT. = 0.046 MILE

FILE NAME :	USER NAME : dodgers	DESIGNED -	REVISED -	<b>STATE OF ILLINOIS DEPARTMENT OF TRANSPORTATION</b>	<b>LOCATION MAPS</b>			F.A. RTE.	SECTION	COUNTY	TOTAL SHEETS	SHEET NO.
	PLLOT SCALE = 40.0000' / in.	CHECKED -	REVISED -					VAR.	DS INLAY 2017-1	.	23	3
	*MODELNAME*	PLLOT DATE = 3/24/2017	DATE -					REVISED -	* CHAMPAIGN & DOUGLAS		CONTRACT NO. 70C68	
									[ILLINOIS] FED. AID PROJECT			
				SCALE:	SHEET	OF	SHEETS	STA.	TO STA.			

# SUMMARY OF QUANTITIES

2                      3                      1

LOCATION OF WORK:	FAP 323 (U.S. 36)	FAP 326 (IL 47)	FAS 533 (IL 47)	FAI 72 (I-72)
	RURAL TWO-LANE	RURAL TWO-LANE	RURAL TWO-LANE	RURAL
	O.P.A.	O.P.A.	MAJOR COLLECTOR	INTERSTATE
COUNTY:	DOUGLAS	CHAMPAIGN	CHAMPAIGN	CHAMPAIGN
FUNDING BREAKOUT:	100% STATE ✓	100% STATE ✓	100% STATE ✓	100% STATE ✓
CONSTRUCTION TYPE CODE:	0005 ✓	0005 ✓	0005 ✓	0005 ✓

CODE NO.	ITEM DESCRIPTION	UNIT	TOTAL QUANTITY	QUANTITY	QUANTITY	QUANTITY	QUANTITY
35300400	PORTLAND CEMENT CONCRETE BASE COURSE 9"	SQ YD	16.0	0.0	0.0	0.0	16.0
40600290	BITUMINOUS MATERIALS (TACK COAT)	POUND	1,544.0	746.0	155.0	137.0	506.0
40600990	TEMPORARY RAMP	SQ YD	266.0	78.0	49.5	49.5	89.0
40603540	POLYMERIZED HOT-MIX ASPHALT SURFACE COURSE, MIX "D", N70	TON	492.0	219.0	53.0	47.0	173.0
44000159	HOT-MIX ASPHALT SURFACE REMOVAL, 2 1/2"	SQ YD	1,497.0	1,497.0	0.0	0.0	0.0
44000160	HOT-MIX ASPHALT SURFACE REMOVAL, 2 3/4"	SQ YD	1,771.0	0.0	344.0	304.0	1,123.0
44000500	COMBINATION CURB AND GUTTER REMOVAL	FOOT	63.0	0.0	0.0	0.0	63.0
44213204	TIE BARS 3/4"	EACH	65.0	0.0	0.0	0.0	65.0
67100100	MOBILIZATION	L SUM	1.0	0.5	0.1	0.1	0.3
70100450	TRAFFIC CONTROL AND PROTECTION, STANDARD 701201	L SUM	1.0	0.0	0.5	0.5	0.0
70100825	TRAFFIC CONTROL AND PROTECTION, STANDARD 701456	L SUM	1.0	0.0	0.0	0.0	1.0
70102620	TRAFFIC CONTROL AND PROTECTION, STANDARD 701501	L SUM	1.0	1.0	0.0	0.0	0.0
70300100	SHORT TERM PAVEMENT MARKING	FOOT	193.0	144.0	26.0	23.0	0.0
70300150	SHORT TERM PAVEMENT MARKING REMOVAL	SQ FT	33.0	24.0	5.0	4.0	0.0
	* DENOTES SPECIALTY ITEM						

14

# SUMMARY OF QUANTITIES

LOCATION OF WORK:	FAP 323 (U.S. 36)	FAP 326 (IL 47)	FAS 533 (IL 47)	FAI 72 (I-72)
	RURAL TWO-LANE	RURAL TWO-LANE	RURAL TWO-LANE	RURAL
	O.P.A.	O.P.A.	MAJOR COLLECTOR	INTERSTATE
COUNTY:	DOUGLAS	CHAMPAIGN	CHAMPAIGN	CHAMPAIGN
FUNDING BREAKOUT:	100% STATE	100% STATE	100% STATE	100% STATE
CONSTRUCTION TYPE CODE:	0005	0005	0005	0005

CODE NO.	ITEM DESCRIPTION	UNIT	TOTAL QUANTITY	QUANTITY	QUANTITY	QUANTITY	QUANTITY
70300210	TEMPORARY PAVEMENT MARKING LETTERS AND SYMBOLS	SQ FT	63.0	0.0	0.0	0.0	63.0
70300220	TEMPORARY PAVEMENT MARKING - LINE 4"	FOOT	3,050.0	2134.0	161.0	143.0	612
70300240	TEMPORARY PAVEMENT MARKING - LINE 6"	FOOT	208.0	0.0	0.0	0.0	208.0
70300260	TEMPORARY PAVEMENT MARKING - LINE 12"	FOOT	202.0	114.0	0.0	0.0	88
70300280	TEMPORARY PAVEMENT MARKING - LINE 24"	FOOT	66.0	0.0	0.0	0.0	66.0
* 78000100	THERMOPLASTIC PAVEMENT MARKING - LETTERS AND SYMBOLS	SQ FT	63.0	0.0	0.0	0.0	63.0
* 78000200	THERMOPLASTIC PAVEMENT MARKING - LINE 4"	FOOT	3,050.0	2134.0	161.0	143.0	612
* 78000400	THERMOPLASTIC PAVEMENT MARKING - LINE 6"	FOOT	208.0	0.0	0.0	0.0	208.0
* 78000600	THERMOPLASTIC PAVEMENT MARKING - LINE 12"	FOOT	202.0	114.0	0.0	0.0	88
* 78000650	THERMOPLASTIC PAVEMENT MARKING - LINE 24"	FOOT	66.0	0.0	0.0	0.0	66.0
* 78100100	RAISED REFLECTIVE PAVEMENT MARKER	EACH	22.0	18.0	2.0	2.0	0.0
78300200	RAISED REFLECTIVE PAVEMENT MARKER REMOVAL	EACH	22.0	18.0	2.0	2.0	0.0
X4402020	CONCRETE MEDIAN SURFACE REMOVAL	SQ FT	108.0	0.0	0.0	0.0	108.0
X6061702	CONCRETE MEDIAN, TYPE SM (DOWELLED)	SQ FT	144.0	0.0	0.0	0.0	144.0
* DENOTES SPECIALTY ITEM							



# 1 EXISTING TYPICAL CROSS SECTION

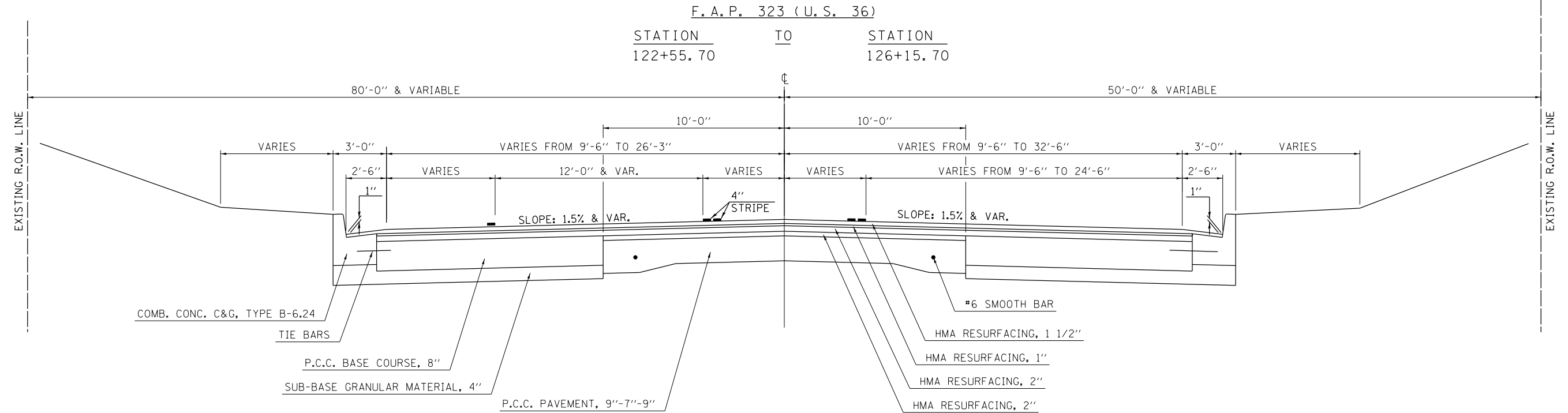

# 1 PROPOSED TYPICAL CROSS SECTION

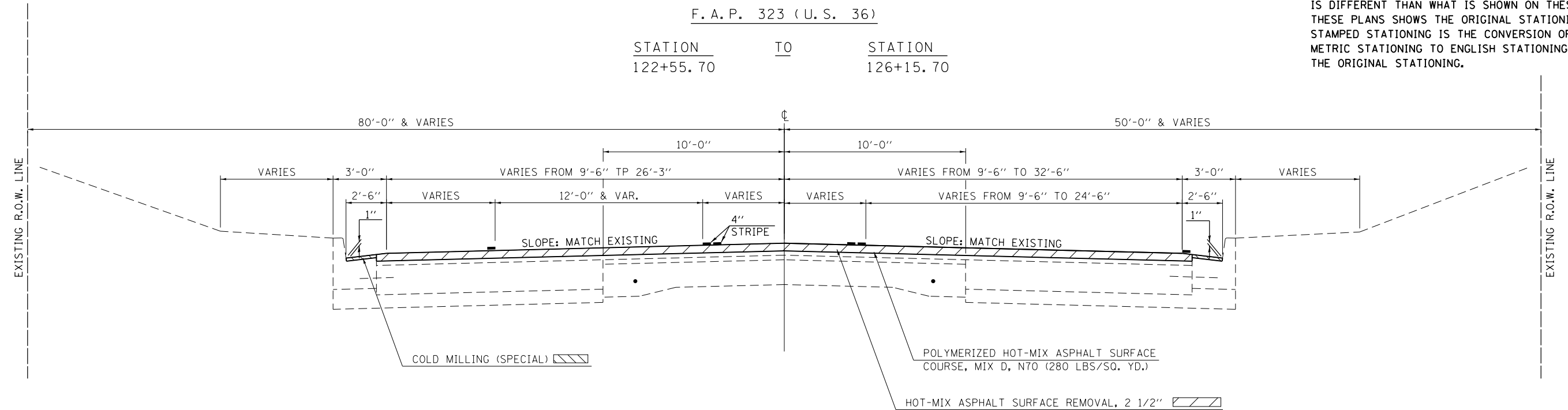

NOTE: THE STAMPED STATIONING IN THE WORK AREA IS DIFFERENT THAN WHAT IS SHOWN ON THESE PLANS. THESE PLANS SHOWS THE ORIGINAL STATIONING. THE STAMPED STATIONING IS THE CONVERSION OF THE METRIC STATIONING TO ENGLISH STATIONING AND NOT THE ORIGINAL STATIONING.

FILE NAME =	USER NAME = dodgms	DESIGNED -	REVISED -	<b>STATE OF ILLINOIS DEPARTMENT OF TRANSPORTATION</b>	<b>TYPICAL CROSS SECTION U.S. 36</b>	F.A. RTE.	SECTION	COUNTY	TOTAL SHEETS	SHEET NO.	
pw\11084EBIDINTEG.illinois.gov\PIWIDOT\Documents\DOT Offices\District 5\Projects\0579\CDRAWING\Design\05 70C68-SHT-Cover.dwg	DESIGNED BY	REVISED BY	VAR.			D5 INLAY 2017-1	•	23	7		
PLOT SCALE = 40.0000' / in.	CHECKED -	REVISED -	• CHAMPAIGN & DOUGLAS			CONTRACT NO. 70C68					
#MODELNAME#	DATE -	REVISED -	ILLINOIS FED. AID PROJECT								
					SCALE:	SHEET	OF	SHEETS	STA.	TO	STA.

# 1 EXISTING TYPICAL CROSS SECTION

F. A. P. 326/F. A. S. 532 (IL 47)

STATION	TO	STATION
43+17.50		44+31.50 *
* 55+52.00		56+81.00

\* OMISSION 44+31.50 TO 55+52.00

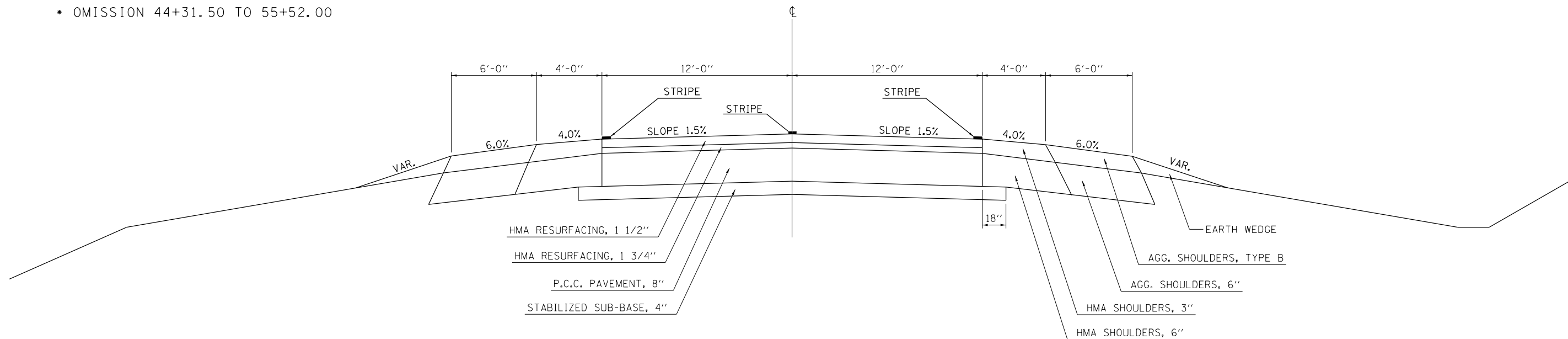

# 1 PROPOSED TYPICAL CROSS SECTION

F. A. P. 326/F. A. S. 532 (IL 47)

STATION	TO	STATION
43+20.00		44+20.00 *
* 55+80.00		56+80.00

\* OMISSION 44+22.00 TO 56+90.50

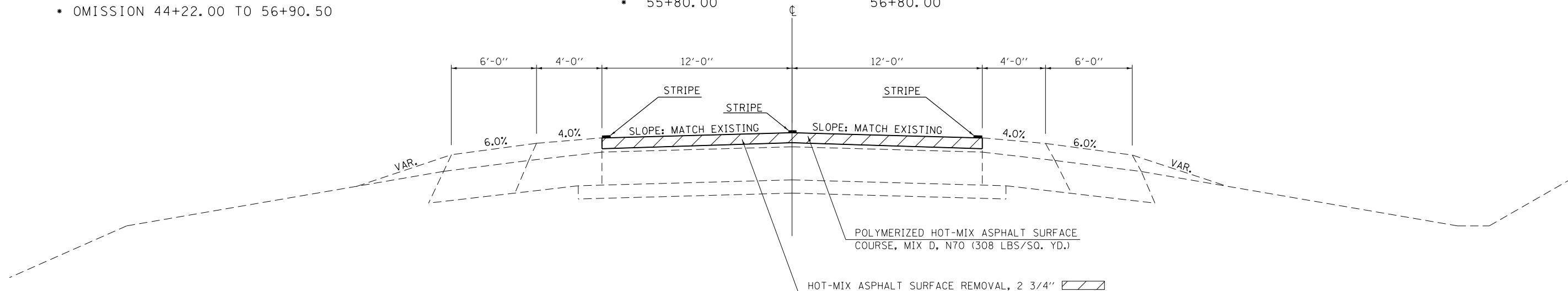

NOTE: THE STAMPED STATIONING IN THE WORK AREA IS DIFFERENT THAN WHAT IS SHOWN ON THESE PLANS. THESE PLANS SHOWS THE ORIGINAL STATIONING. THE STAMPED STATIONING IS THE CONVERSION OF THE METRIC STATIONING TO ENGLISH STATIONING AND NOT THE ORIGINAL STATIONING.

FILE NAME =	USER NAME = dodgms	DESIGNED -	REVISED -
pw\ill084EBIDINTEG.illinois.gov\PIWIDOT\Documents\DOT Offices\District 5\Projects\0570\Drawings\Design\05 70C68-SHT-Cover.dwg		CHECKED -	REVISED -
		DATE -	REVISED -

STATE OF ILLINOIS  
DEPARTMENT OF TRANSPORTATION

TYPICAL CROSS SECTION		IL 47	
SCALE:	SHEET	OF	SHEETS
	STA.	TO	STA.

F. A. RTE.	SECTION	COUNTY	TOTAL SHEETS	SHEET NO.
VAR.	D5 INLAY 2017-1	*	23	8
* CHAMPAIGN & DOUGLAS			CONTRACT NO. 70C68	
ILLINOIS FED. AID PROJECT				



## ② EXISTING TYPICAL CROSS SECTION

RAMPS AT F. A. I. 72 (I-72)

	STATION	TO	STATION
RAMP E	500+12.42		500+62.42
RAMP F	617+51.48		618+01.48
RAMP G	717+26.48		718+01.48
RAMP H	800+12.42		800+62.42

• SLOPE IS 4.2% MINIMUM OR SAME AS PAVEMENT ON LOW SIDE OF SUPERELEVATION. ON HIGH SIDE OF SUPERELEVATION, THE MAXIMUM CHANGE IN SLOPE BETWEEN SHOULDER AND PAVEMENT IS 0.08% FT/FT.

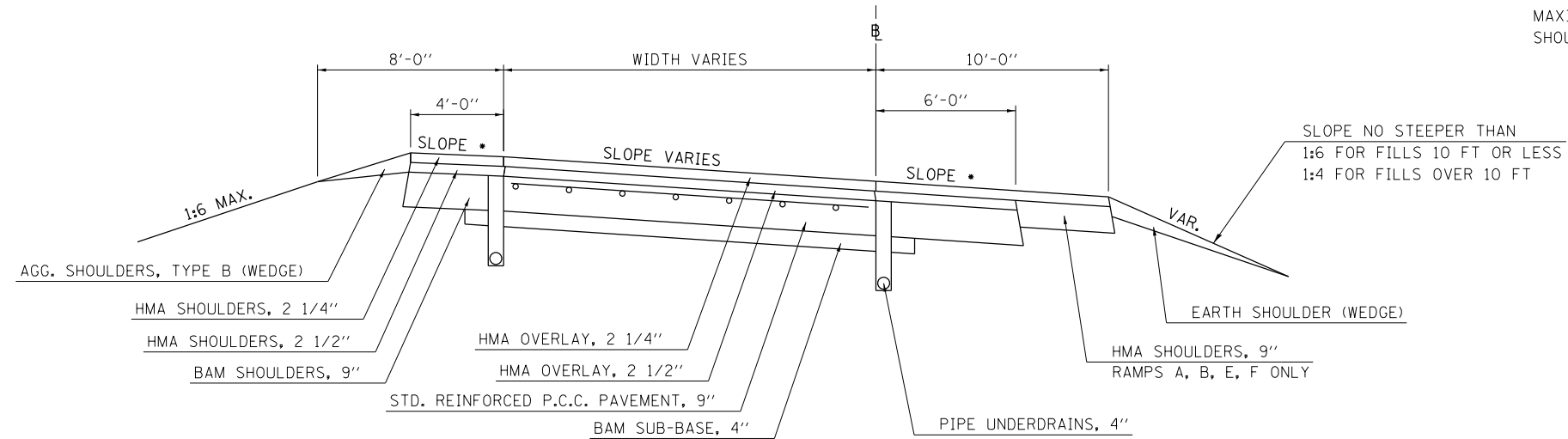

## ② PROPOSED TYPICAL CROSS SECTION

RAMPS AT F. A. I. 72 (I-72)

	STATION	TO	STATION
RAMP E	500+12.42		500+62.42
RAMP F	617+51.48		618+01.48
RAMP G	717+26.48		718+01.48
RAMP H	800+12.42		800+62.42

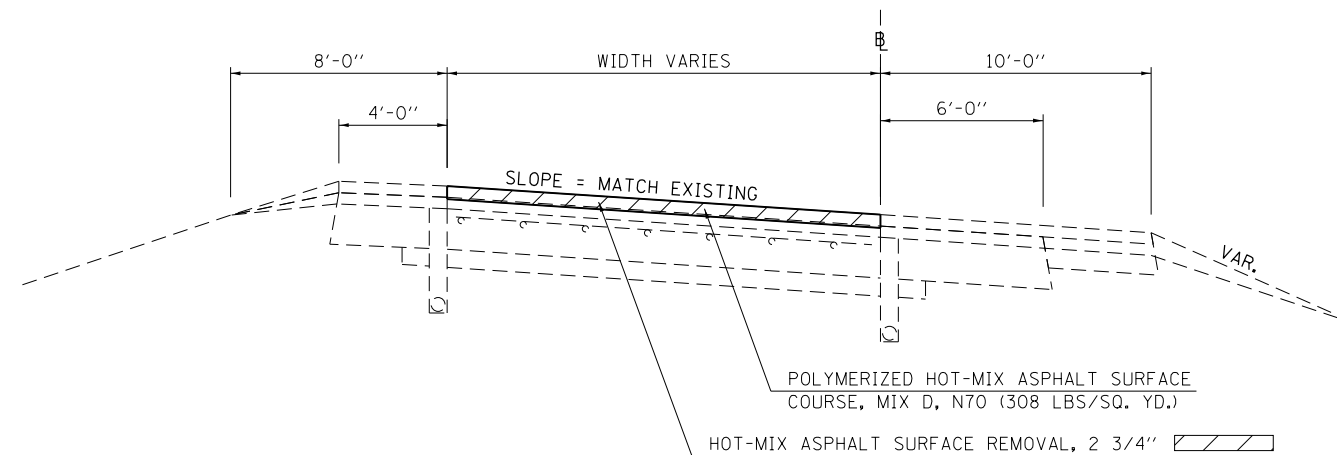

FILE NAME =	USER NAME = dodgms	DESIGNED -	REVISED -	<b>STATE OF ILLINOIS DEPARTMENT OF TRANSPORTATION</b>	<b>TYPICAL CROSS SECTION I-72 RAMPS</b>	F.A. RTE.	SECTION	COUNTY	TOTAL SHEETS	SHEET NO.		
p:\11\084EBIDINTEG.illinois.gov\PIWIDOT\Documents\IDOT Offices\District 5\Projects\0570\BROWNS\Design\05 70C68-SHT-Cover.dwg						DRAWN	CHECKED	VAR.	D5 INLAY 2017-1	•	23	9
PLOT SCALE = 40.0000' / in.						REVIS	REVIS	• CHAMPAIGN & DOUGLAS		CONTRACT NO. 70C68		
#MODELNAME#						DATE	REVIS	ILLINOIS FED. AID PROJECT				
					SCALE:	SHEET OF SHEETS		STA. TO STA.				

# SCHEDULE OF QUANTITIES

LOCATION #1  
F. A. P. 323 ( U. S. 36)

## US 36 RESURFACING SCHEDULES

STATION TO	STATION	AVERAGE PROPOSED ROADWAY WIDTH FT	LENGTH FT	AREA SQ YD	44000159	40600290	40603540	40603540	
					HMA SURFACE REMOVAL 2½ INCH	Z0010910 COLD MILLING (SPECIAL) SQ YD	BITUMINOUS MATERIALS (TACK COAT) POUND	HMA SURFACE COURSE 2½ INCH TON	HMA SURFACE COURSE 1 INCH TON
122+55.70	TO 126+15.70	VAR.	360.0	1,657.0	1,497.0	160.0	745.7	209.6	9.0
US 36 SUB-TOTAL =					1,497.0	160.0	745.7	209.6	9.0
USE =					1,497.0	160.0	746.0	210.0	9.0

NOTES:

\*AREAS WITH VARIABLE WIDTHS WERE OBTAINED USING CADD.

## TEMPORARY RAMPS - 40600990

LOCATION	STATION	HEIGHT INCHES	WIDTH FT	LENGTH FT	AREA SQ YD	QUANTITY SQ YD
US 36 MAINLINE	122+55.70	2.50	24.0	8.3	22.1	22.1
US 36 MAINLINE	126+15.70	2.50	60.0	8.3	55.3	55.3
US 36 SUB-TOTAL =					77.5	77.5
USE =					78.0	78.0

## US 36 PAVEMENT MARKING SCHEDULES

### 4" SOLID YELLOW

LOCATION	STATION TO	STATION	78000200 THERMOPLASTIC PVT MK-4" FOOT	X7830070 GRV RECESSED PVT MK - 5" FOOT	70300220 TEMP PVT MK - 4" FOOT	X7030005 TEMP PVT MK REM SQ FT	70300100 SHORT TERM PVT MK FOOT	70300150 SHORT TERM PVT MK REM SQ FT
E.B. CENTERLINE	122+55.70 TO	126+15.70	360.0	360.0	360.0	118.8	72.0	11.9
W.B. CENTERLINE	122+55.70 TO	126+15.70	360.0	360.0	360.0	118.8	72.0	11.9
E.B. DOUBLE YELLOW	122+68.90 TO	126+15.70	346.8	346.8	346.8	114.4	-	-
W.B. DOUBLE YELLOW	122+68.90 TO	126+15.70	346.8	346.8	346.8	114.4	-	-
US 36 SUB-TOTAL =			1,413.6	1,413.6	1,413.6	466.5	144.0	23.8
USE =			1,414.0	1,414.0	1,414.0	467.0	144.0	24.0

### 4" WHITE

LOCATION	STATION TO	STATION	78000200 THERMOPLASTIC PVT MK-4" FOOT	X7830070 GRV RECESSED PVT MK - 5" FOOT	70300220 TEMP PVT MK - 4" FOOT	X7030005 TEMP PVT MK REM SQ FT
E.B. EDGE	122+55.70 TO	126+15.70	360.0	360.0	360.0	118.8
W.B. EDGE	122+55.70 TO	126+15.70	360.0	360.0	360.0	118.8
US 36 SUB-TOTAL =			720.0	720.0	720.0	237.6
USE =			720.0	720.0	720.0	238.0

## RAISED REFLECTIVE PAVEMENT MARKERS

LOCATION	STATION TO	STATION	78100100 TWO WAY AMBER RRPM EACH	78300200 RRPM REMOVAL EACH
E.B. DOUBLE YELLOW	122+55.70 TO	126+15.70	9.0	9.0
W.B. DOUBLE YELLOW	122+55.70 TO	126+15.70	9.0	9.0
US 36 SUB-TOTAL =			18.0	18.0
USE =			18.0	18.0

### 12" DIAGONAL (YELLOW)

LOCATION / DESCRIPTION	78000600 THERMOPLASTIC PVT MK-12" FOOT	X7830078 GRV RECESSED PVT MK - 13" FOOT	70300260 TEMP PVT MK - 12" FOOT	X7030005 TEMP PVT MK REM SQ FT
MEDIAN STRIPING	113.8	113.8	113.8	113.8
US 36 SUB-TOTAL =				
USE =				

# SCHEDULE OF QUANTITIES

LOCATION #2  
F. A. P. 326/F. A. S. 532 ( IL 47)

## IL 47 RESURFACING SCHEDULES

STATION	TO	STATION	AVERAGE PROPOSED ROADWAY		AREA	44000160	40600290	40603540
			WIDTH	LENGTH		HMA SURFACE REMOVAL	BITUMINOUS MATERIALS (TACK COAT)	HMA SURFACE COURSE
			FT	FT	SQ YD	2 3/4 INCH	POUND	TON
43+17.50	TO	44+31.50	24.0	114.0	304.0	304.0	136.8	46.8
OMISSION FROM RESURFACING: STA. 44+20.00 TO STA. 55+80.00								
55+52.00	TO	56+81.00	24.0	129.0	344.0	344.0	154.8	53.0
TOTAL=						648.0	291.6	99.8
USE=						648.0	292.0	100.0

## TEMPORARY RAMPS - 40600990

LOCATION	STATION	HEIGHT	WIDTH	LENGTH	AREA	QUANTITY
		INCHES	FT	FT	SQ YD	SQ YD
IL 47 MAINLINE	43+17.50	2.75	24.0	9.2	24.5	24.5
IL 47 MAINLINE	44+31.50	2.75	24.0	9.2	24.5	24.5
IL 47 MAINLINE	55+52.00	2.75	24.0	9.2	24.5	24.5
IL 47 MAINLINE	56+81.00	2.75	24.0	9.2	24.5	24.5
IL-47 SUB-TOTAL=						98.1
USE=						99.0

## IL - 47 PAVEMENT MARKING SCHEDULES

## RAISED REFLECTIVE PAVEMENT MARKERS

4" CENTERLINE SKIP-DASH YELLOW				78000200	X7830070	70300220	X7030005	70300100	70300150
				THERMOPLASTIC PVT MK-4"	GRV RECESSED PVT MK - 5"	TEMP PVT MK - 4"	TEMP PVT MK REM	SHRT TRM PVT MK	SHRT TRM PVT MK REM
DIRECTION	STATION	TO	STATION	FOOT	FOOT	FOOT	SQ FT	FOOT	SQ FT
S.B.	43+17.50	TO	44+31.50	28.5	28.5	28.5	9.4	22.8	3.8
N.B.	55+52.00	TO	56+81.00	32.3	32.3	32.3	10.6	25.8	4.3
YELLOW SKIP-DASH SUB-TOTAL =				60.8	60.8	60.8	20.0	48.6	8.0

4" SOLID YELLOW				78000200	X7830070	70300220	X7030005		
				THERMOPLASTIC PVT MK-4"	GRV RECESSED PVT MK - 5"	TEMP PVT MK - 4"	TEMP PVT MK REM		
DIRECTION	STATION	TO	STATION	FOOT	FOOT	FOOT	SQ FT		
N.B.	43+17.50	TO	44+31.50	114.0	114.0	114.0	37.6		
S.B.	55+52.00	TO	56+81.00	129.0	129.0	129.0	42.6		
SOLID YELLO				243.0	243.0	243.0	80.2		
IL 47 YELLOW SUB-TOTAL =				303.8	303.8	303.8	100.2		
IL 47 - 4" SUB-TOTAL =				303.8	303.8	303.8	100.2	48.6	8.0
USE =				304.0	304.0	304.0	101.0	49.0	9.0

LOCATION	STATION	TO	STATION	78100100	78300200
				TWO WAY AMBER RRPM EACH	RRPM REMOVAL EACH
IL 47 CENTERLINE	43+17.50	TO	44+31.50	2.0	2.0
IL 47 CENTERLINE	55+52.00	TO	56+81.00	2.0	2.0
IL 47 SUB-TOTAL =				4.0	4.0
USE =				4.0	4.0

# SCHEDULE OF QUANTITIES

LOCATION #2  
RAMPS AT F. A. I. 72 (I-72)

## I-72 RAMPS RESURFACING SCHEDULES

LOCATION	STATION	TO	STATION	AVERAGE PROPOSED ROADWAY WIDTH FT	LENGTH FT	AREA SQ YD	44000160	40600290	40603540
							HMA SURFACE REMOVAL 2 3/4 INCH SQ YD	BITUMINOUS MATERIALS (TACK COAT) POUND	HMA SURFACE COURSE 2 3/4 INCH TON
WB I-72 ON RAMP	500+12.42	TO	500+62.42	VAR.	50.0	295.5	295.5	133.0	45.5
WB I-72 EXIT RAMP	617+51.48	TO	618+01.48	VAR.	50.0	265.0	265.0	119.3	40.8
EB I-72 EXIT RAMP	717+26.48	TO	718+01.48	VAR.	75.0	328.0	328.0	147.6	50.5
EB I-72 ON RAMP	800+12.42	TO	800+62.42	VAR.	50.0	234.1	234.1	105.3	36.1
I-72 SUB-TOTAL=							1,122.6	505.2	172.9
USE=							1,123.0	506.0	173.0

NOTES:  
\*AREAS WITH VARIABLE WIDTHS WERE OBTAINED USING CADD.

## I-72 RAMP ISLAND SCHEDULES

I-72 TEMPORARY RAMPS - 40600990												
LOCATION	STATION	HEIGHT INCHES	WIDTH FT	LENGTH FT	AREA SQ YD	QUANTITY SQ YD	X4402020 CONCRETE MEDIAN SURFACE REMOVAL SQ FT	44000500 CURB & GUTTER REMOVAL FOOT	35300400 PCC BASE COURSE 9 INCH SQ YD	44213204 TIE BARS 3/4 INCH EACH	X6061702 CONCRETE MEDIAN TYPE SM (DOWELLED) SQ FT	
WB I-72 ON RAMP	500+62.42	2.75	26.0	9.2	26.6	26.6						
WB I-72 EXIT RAMP	617+51.48	2.75	20.0	9.2	20.4	20.4						
EB I-72 EXIT RAMP	717+26.48	2.75	21.0	9.2	21.5	21.5						
EB I-72 ON RAMP	800+62.42	2.75	20.0	9.2	20.4	20.4						
I-72 SUB-TOTAL=						88.9						
USE=						89.0						
							WB I-72 EXIT RAMP	45.0	27.0	6.5	30.0	58.5
							EB I-72 EXIT RAMP	63.0	36.0	9.5	35.0	85.5
I-72 SUB-TOTAL=							108.0	63.0	16.0	65.0	144.0	
USE=							108.0	63.0	16.0	65.0	144.0	

# SCHEDULE OF QUANTITIES

LOCATION #2  
RAMPS AT F. A. I. 72 ( I-72)

## I-72 PAVEMENT MARKING SCHEDULES

4" SOLID YELLOW				78000200	X7830070	70300220	X7030005
				THERMOPLASTIC	GRV RECESSED	TEMP PVT	TEMP PVT
LOCATION	STATION	TO	STATION	PVT MK-4" FOOT	PVT MK - 5" FOOT	MK - 4" FOOT	MK REM SQ FT
WB I-72 ON RAMP	500+12.42	TO	500+62.42	66.0	66.0	66.0	21.8
WB I-72 EXIT RAMP	617+51.48	TO	618+01.48	57.0	57.0	57.0	18.8
EB I-72 EXIT RAMP	717+26.48	TO	718+01.48	75.0	75.0	75.0	24.8
EB I-72 ON RAMP	800+12.42	TO	800+62.42	54.0	54.0	54.0	17.8
<b>SOLID YELLOW SUB-TOTAL =</b>				<b>252.0</b>	<b>252.0</b>	<b>252.0</b>	<b>83.2</b>
<b>I-72 YELLOW SUB-TOTAL =</b>				<b>252.0</b>	<b>252.0</b>	<b>252.0</b>	<b>83.2</b>

12" WHITE		78000600	X7830078	70300260	X7030005
		THERMOPLASTIC	GRV RECESSED	TEMP PVT	TEMP PVT
LOCATION	DESCRIPTION	PVT MK-12" FOOT	PVT MK - 13" FOOT	MK - 12" FOOT	MK REM SQ FT
WB I-72 EXIT RAMP	ISLAND STRIPING	40.0	40.0	40.0	40.0
EB I-72 EXIT RAMP	ISLAND STRIPING	48.0	48.0	48.0	48.0
<b>I-72 12" SUB-TOTAL =</b>		<b>88.0</b>	<b>88.0</b>	<b>88.0</b>	<b>88.0</b>
<b>USE =</b>		<b>88.0</b>	<b>88.0</b>	<b>88.0</b>	<b>88.0</b>

4" WHITE				78000200	X7830070	70300220	X7030005
				THERMOPLASTIC	GRV RECESSED	TEMP PVT	TEMP PVT
LOCATION	STATION	TO	STATION	PVT MK-4" FOOT	PVT MK - 5" FOOT	MK - 4" FOOT	MK REM SQ FT
WB I-72 ON RAMP	500+12.42	TO	500+62.42	83.0	83.0	83.0	27.4
WB I-72 EXIT RAMP	617+51.48	TO	618+01.48	90.0	90.0	90.0	29.7
EB I-72 EXIT RAMP	717+26.48	TO	718+01.48	112.0	112.0	112.0	37.0
EB I-72 ON RAMP	800+12.42	TO	800+62.42	75.0	75.0	75.0	24.8
<b>SOLID WHITE SUB-TOTAL =</b>				<b>360.0</b>	<b>360.0</b>	<b>360.0</b>	<b>118.8</b>
<b>I-72 4" SUB-TOTAL =</b>				<b>612.0</b>	<b>612.0</b>	<b>612.0</b>	<b>202.0</b>
<b>USE =</b>				<b>612.0</b>	<b>612.0</b>	<b>612.0</b>	<b>202.0</b>

24" WHITE		78000650	X7830090	70300280	X7030005
		THERMOPLASTIC	GRV RECESSED	TEMP PVT	TEMP PVT
LOCATION	DESCRIPTION	PVT MK-24" FOOT	PVT MK - 25" FOOT	MRK - 24" FOOT	MK REM SQ FT
WB I-72 EXIT RAMP	STOP BAR - RT TURN	15.0	15.0	15.0	30
WB I-72 EXIT RAMP	STOP BAR - LT TURN	18.0	18.0	18.0	36
EB I-72 EXIT RAMP	STOP BAR - RT TURN	15.0	15.0	15.0	30
EB I-72 EXIT RAMP	STOP BAR - LT TURN	18.0	18.0	18.0	36
<b>I-72 24" SUB-TOTAL =</b>		<b>66.0</b>	<b>66.0</b>	<b>66.0</b>	<b>132.0</b>
<b>USE =</b>		<b>66.0</b>	<b>66.0</b>	<b>66.0</b>	<b>132.0</b>

6" WHITE		78000400	X7830074	70300240	X7030005
		THERMOPLASTIC	GRV RECESSED	TEMP PVT	TEMP PVT
LOCATION	DESCRIPTION	PVT MK-6" FOOT	PVT MK - 7" FOOT	MK - 6" FOOT	MK REM SQ FT
WB I-72 EXIT RAMP	ISLAND STRIPING	95.0	95.0	95.0	47.5
EB I-72 EXIT RAMP	ISLAND STRIPING	113.0	113.0	113.0	56.5
<b>I-72 6" SUB-TOTAL =</b>		<b>208.0</b>	<b>208.0</b>	<b>208.0</b>	<b>104.0</b>
<b>USE =</b>		<b>208.0</b>	<b>208.0</b>	<b>208.0</b>	<b>104.0</b>

LETTERS AND SYMBOLS		78000100	X7830060	70300210	X7030005
		THERMOPLASTIC	GRV RECESSED	TEMP PVT	TEMP PVT
LOCATION	DESCRIPTION	PVT MK-L&S SQ FT	PVT MK-L&S SQ FT	MRK - L&S SQ FT	MK REM SQ FT
WB I-72 EXIT RAMP	RT TURN ARROW	15.6	15.6	15.6	15.6
WB I-72 EXIT RAMP	LT TURN ARROW	15.6	15.6	15.6	15.6
EB I-72 EXIT RAMP	RT TURN ARROW	15.6	15.6	15.6	15.6
EB I-72 EXIT RAMP	LT TURN ARROW	15.6	15.6	15.6	15.6
<b>I-72 LETTERS AND SYMBOLS SUB-TOTAL =</b>		<b>62.4</b>	<b>62.4</b>	<b>62.4</b>	<b>62.4</b>
<b>USE =</b>		<b>63.0</b>	<b>63.0</b>	<b>63.0</b>	<b>63.0</b>

NOTE:  
TURN ARROWS AT RAMPS SHALL BE PLACED 18 FT PRIOR TO STOP BARS.

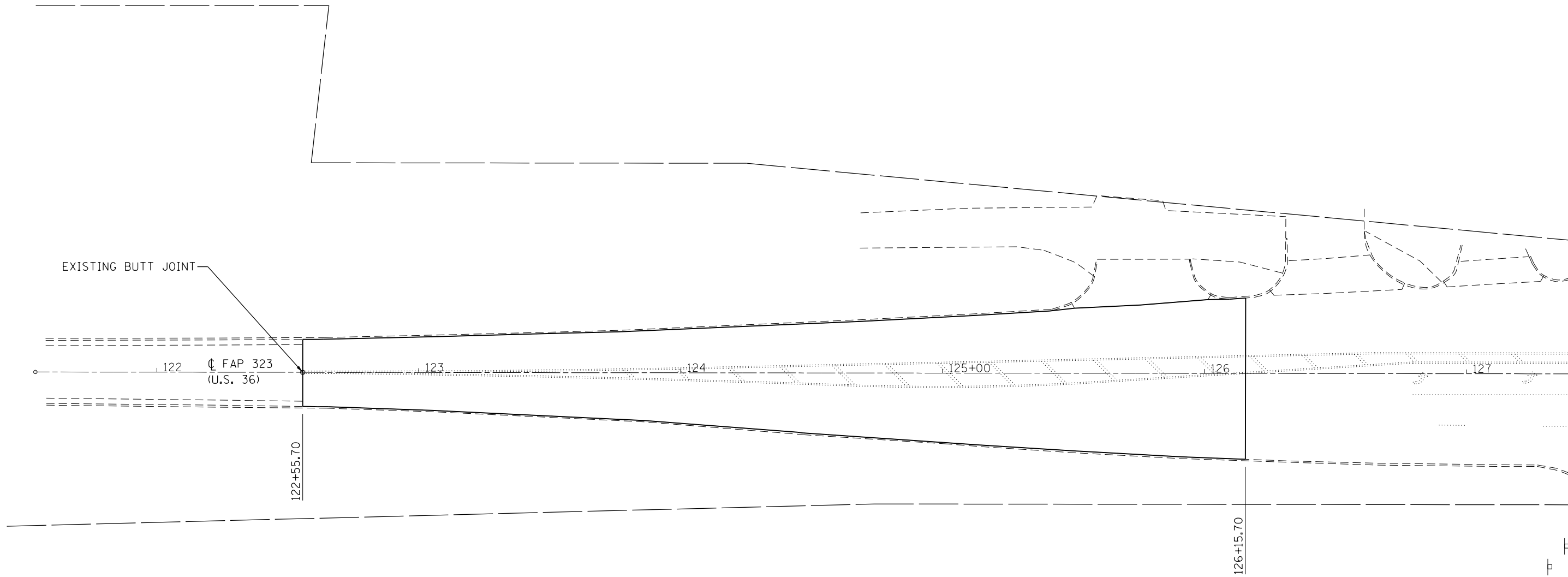

FILE NAME =	USER NAME = dodgens	DESIGNED -	REVISED -
p:\11\084EBIDINTEG.illinois.gov\PIWIDOT\Documents\IDOT Offices\District 5\Projects\0570C68\0570C68-shr-details.dwg		DRAWN -	REVISED -
\$MODELNAME\$	PLOT SCALE = 40.0000' / in.	CHECKED -	REVISED -
	PLOT DATE = 3/24/2017	DATE -	REVISED -

**STATE OF ILLINOIS  
DEPARTMENT OF TRANSPORTATION**

<b>PLAN SHEET U.S. 36</b>			
SCALE:	SHEET	OF	SHEETS
	STA.	TO	STA.

F.A. RTE.	SECTION	COUNTY	TOTAL SHEETS	SHEET NO.
VAR.	D5 INLAY 2017-1	•	23	14
• CHAMPAIGN & DOUGLAS		CONTRACT NO. 70C68		
ILLINOIS FED. AID PROJECT				

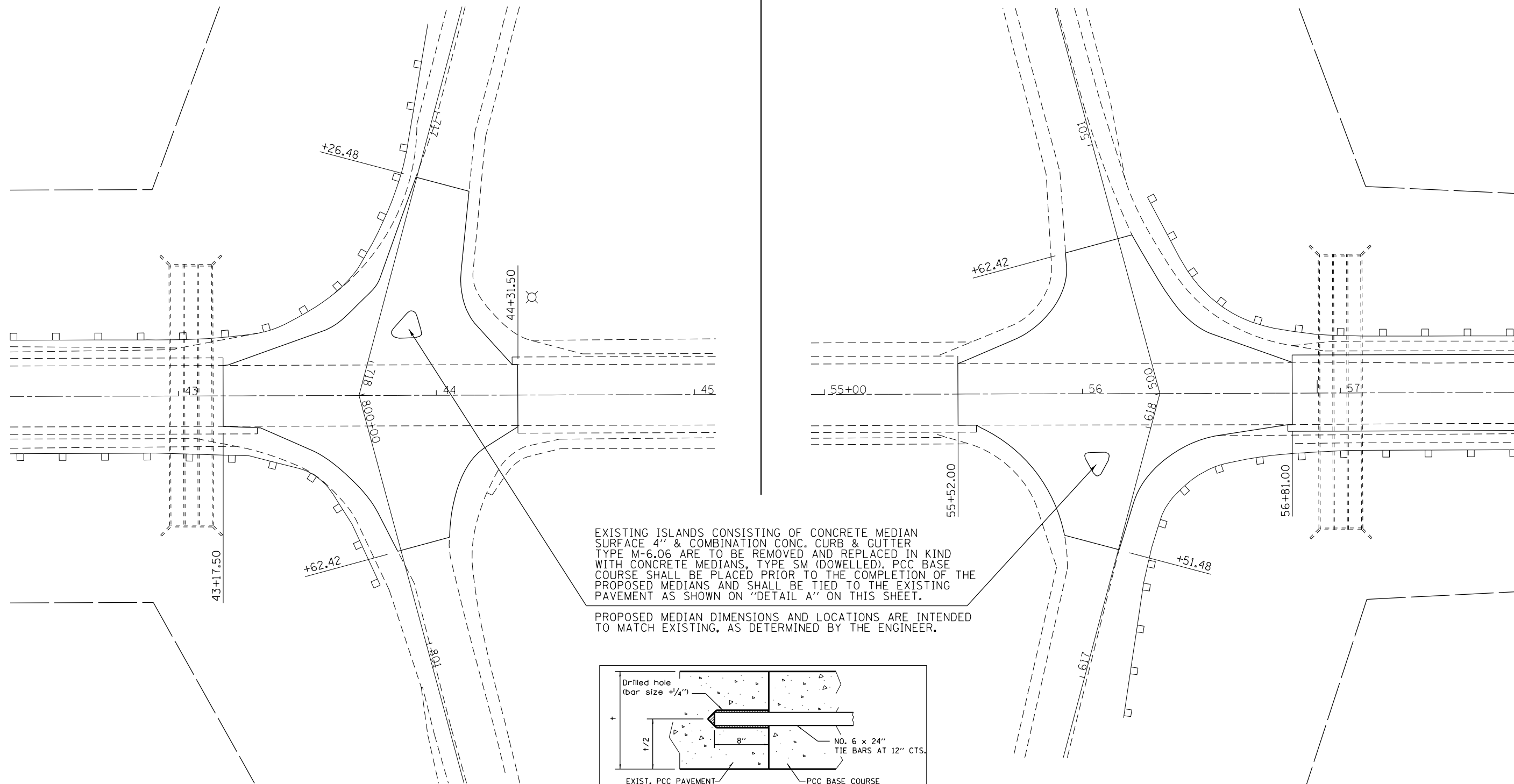

EXISTING ISLANDS CONSISTING OF CONCRETE MEDIAN SURFACE 4" & COMBINATION CONC. CURB & GUTTER TYPE M-6.06 ARE TO BE REMOVED AND REPLACED IN KIND WITH CONCRETE MEDIANS, TYPE SM (DOWELLED). PCC BASE COURSE SHALL BE PLACED PRIOR TO THE COMPLETION OF THE PROPOSED MEDIANS AND SHALL BE TIED TO THE EXISTING PAVEMENT AS SHOWN ON "DETAIL A" ON THIS SHEET.

PROPOSED MEDIAN DIMENSIONS AND LOCATIONS ARE INTENDED TO MATCH EXISTING, AS DETERMINED BY THE ENGINEER.

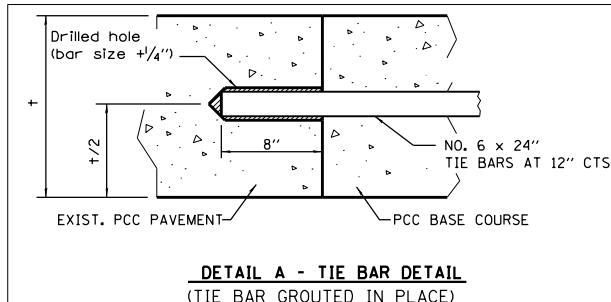

**DETAIL A - TIE BAR DETAIL**  
(TIE BAR GROUTED IN PLACE)

FILE NAME =	USER NAME = dodgens	DESIGNED -	REVISED -
p:\11\084EBIDINTEG.illinois.gov\PIWIDOT\Documents\DOT Offices\District 5\Projects\0570\BROWND\Design\0570C68-shr-details.dwg		CHECKED -	REVISED -
\$MODELNAME\$	PLOT SCALE = 40.0000' / in.	DATE -	REVISED -
	PLOT DATE = 3/24/2017		

**STATE OF ILLINOIS  
DEPARTMENT OF TRANSPORTATION**

<b>PLAN SHEET</b>			
<b>I-72 &amp; IL 47 INTERCHANGE</b>			
SCALE:	SHEET	OF SHEETS	STA. TO STA.

F.A. RTE.	SECTION	COUNTY	TOTAL SHEETS	SHEET NO.
VAR.	D5 INLAY 2017-1		23	15
• CHAMPAIGN & DOUGLAS			CONTRACT NO. 70C68	
ILLINOIS FED. AID PROJECT				

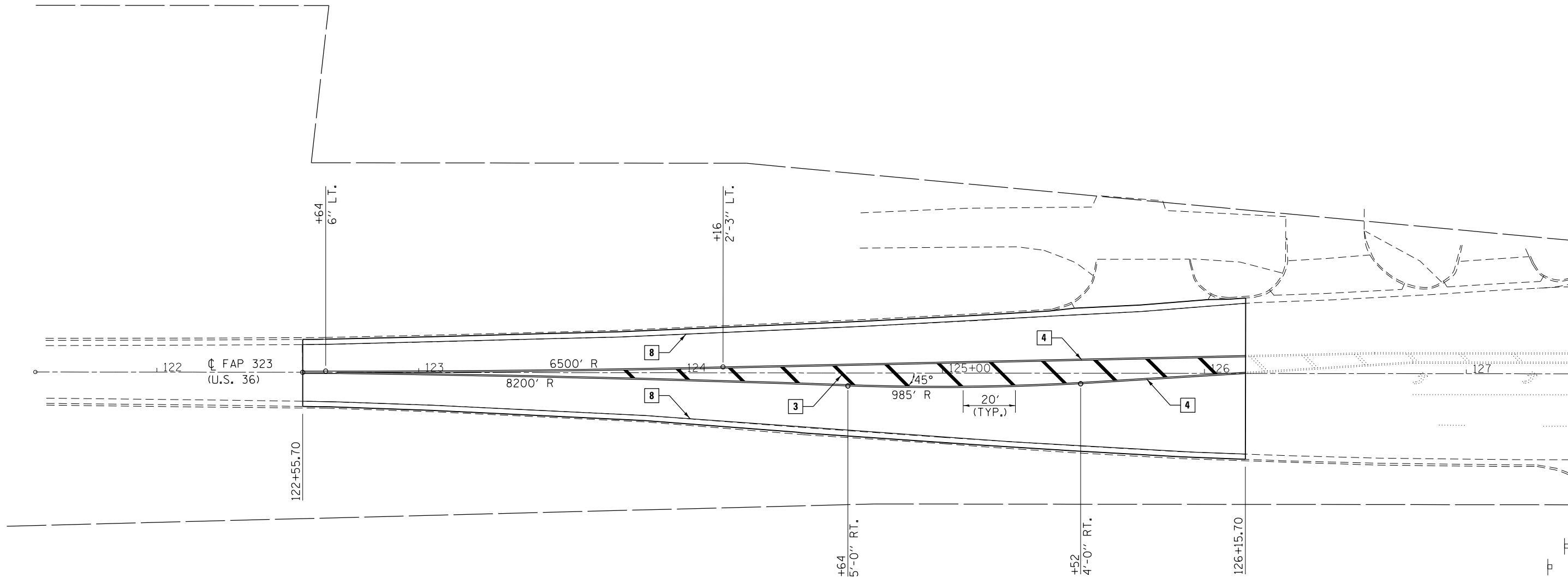

**TYPICAL PAVEMENT MARKING LEGEND**

- 3 12" (300) DIAGONAL (YELLOW)
- 4 4" (100) DOUBLE YELLOW (NARROW)
- 8 4" (100) SOLID (WHITE)

FILE NAME =	USER NAME = dodgms	DESIGNED -	REVISED -
p:\11\084EBIDINTEG.illinois.gov\PIWIDOT\Documents\IDOT Offices\District 5\Projects\0570C68\Drawings\Design\0570C68-shr-details.dwg		CHECKED -	REVISED -
\$MODELNAME\$	PLOT DATE = 3/24/2017	DATE -	REVISED -

**STATE OF ILLINOIS  
DEPARTMENT OF TRANSPORTATION**

**PAVEMENT MARKING DETAIL  
U.S. 36**

SCALE: SHEET OF SHEETS STA. TO STA.

F.A. RTÉ.	SECTION	COUNTY	TOTAL SHEETS	SHEET NO.
VAR.	D5 INLAY 2017-1	•	23	16
• CHAMPAIGN & DOUGLAS			CONTRACT NO. 70C68	
ILLINOIS FED. AID PROJECT				





**TYPICAL PAVEMENT MARKING LEGEND**

- 1 4" (100) SKIP-DASH (YELLOW)
- 2 4" (100) SOLID (YELLOW)
- 8 4" (100) SOLID (WHITE)
- 9 12" (300) DIAGONAL (WHITE)
- 10 6" (150) SOLID (WHITE)
- 11 24" (600) STOP BAR (WHITE)

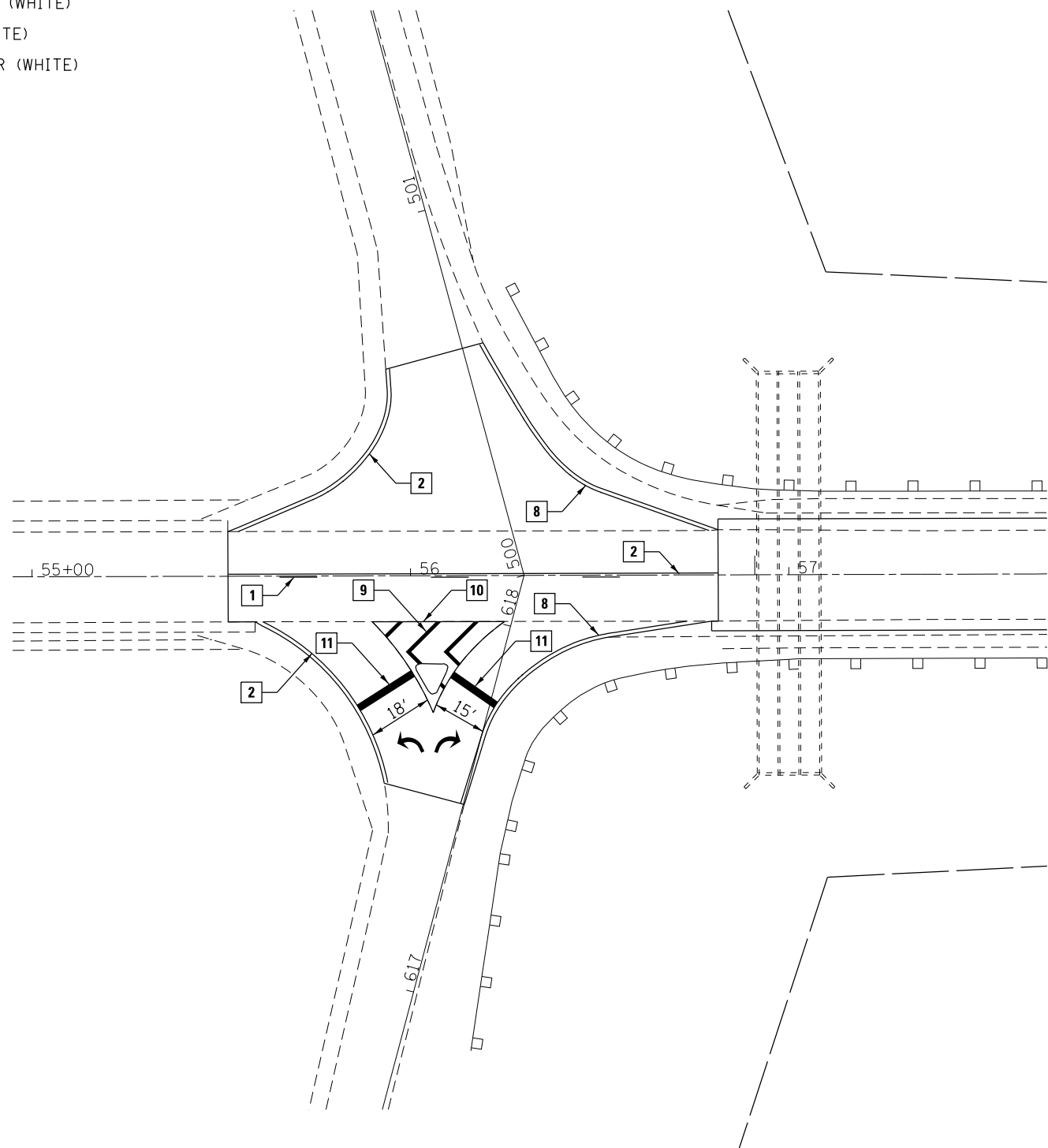
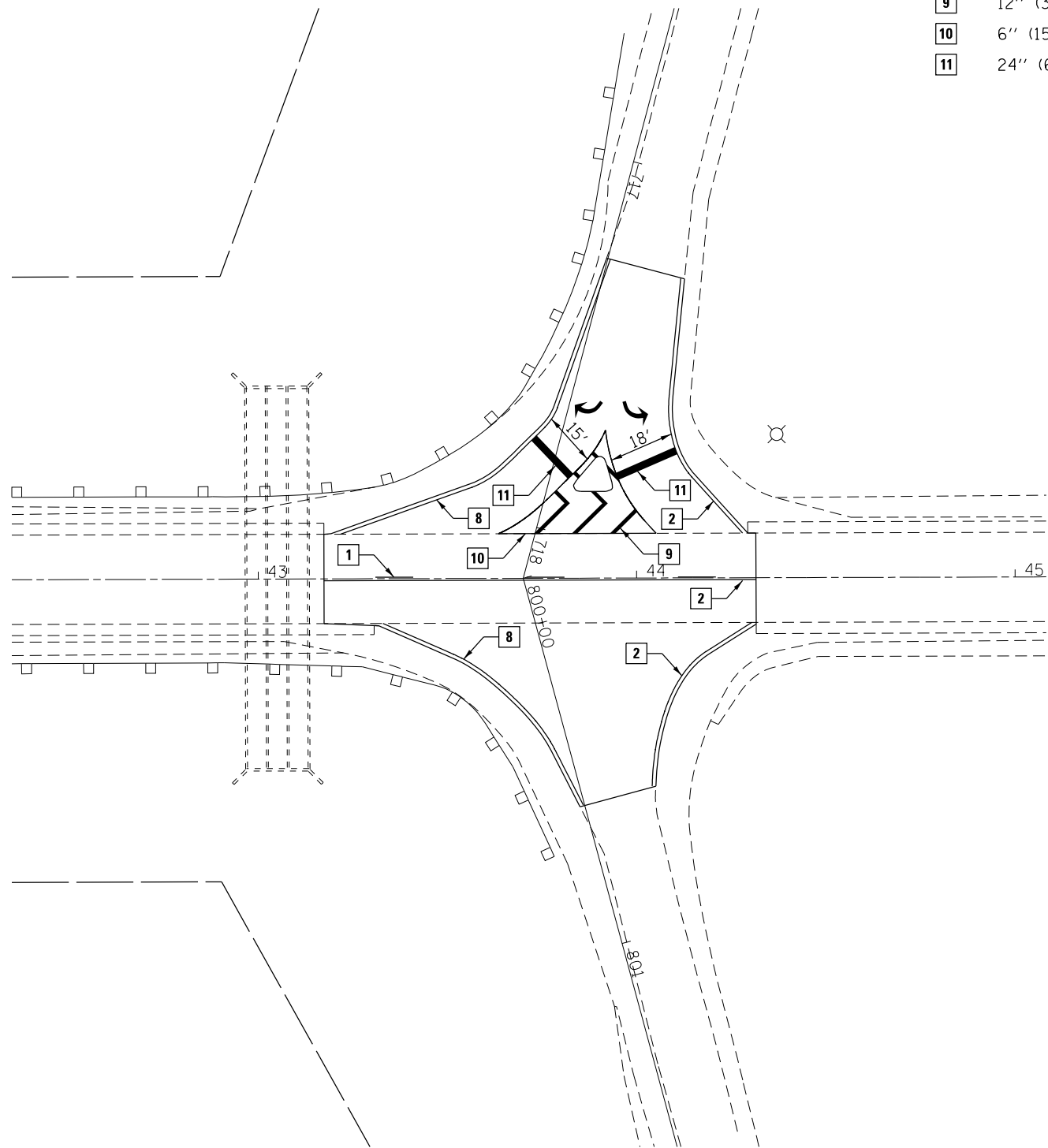

FILE NAME =	USER NAME = dodgers	DESIGNED -	REVISED -
p:\ll\084EBID\INTEG\illinois.gov\PWIDOT\Documents\DOT Offices\District 5\Projects\05790\05790\Drawings\05790C68-shr-details.dwg	PROJECT NUMBER = 05790C68	DRAWN BY -	REVISED -
\$MODELNAME\$	PLOT SCALE = 40.0000' / in.	CHECKED -	REVISED -
	PLOT DATE = 3/24/2017	DATE -	REVISED -

**STATE OF ILLINOIS  
DEPARTMENT OF TRANSPORTATION**

**PAVEMENT MARKING DETAIL  
I-72 & IL 47 INTERCHANGE**

SCALE: SHEET OF SHEETS STA. TO STA.

F.A. RTE.	SECTION	COUNTY	TOTAL SHEETS	SHEET NO.
VAR.	D5 INLAY 2017-1	*	23	17
CHAMPAIGN & DOUGLAS			CONTRACT NO. 70C68	
ILLINOIS FED. AID PROJECT				

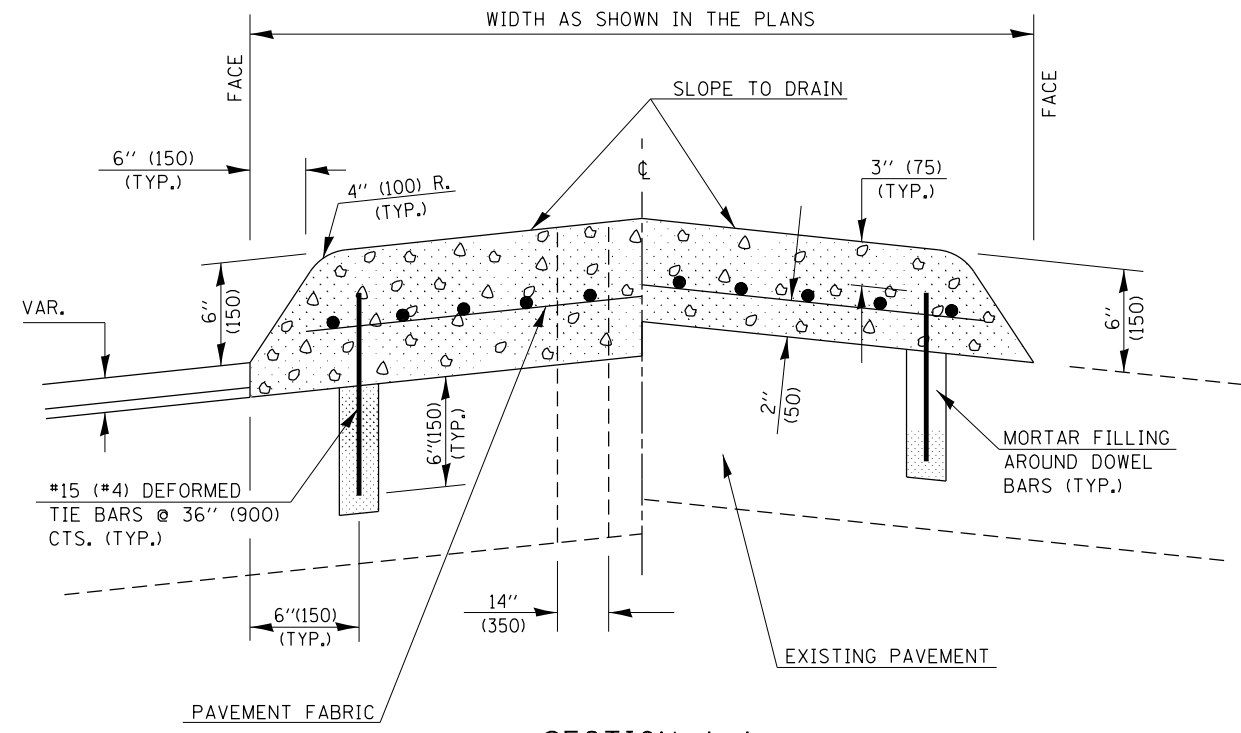

**GENERAL NOTES**

1. THE GENERAL NOTES FOR STANDARD 606301 SHALL APPLY.
2. DOWEL BARS @ 36" (900) CTS. OR AS DIRECTED BY THE ENGINEER.
3. THIS WORK WILL BE PAID FOR AT THE CONTRACT UNIT PRICE PER SO FOOT (m<sup>2</sup>) FOR CONCRETE MEDIAN, TYPE SM (DOWELLED), INCLUDING THE COST OF FURNISHING AND INSTALLING THE DOWEL BARS, MORTAR FILLING, PAVEMENT FABRIC AND THE REMOVAL AND DISPOSAL OF THE EXISTING PAVEMENT FOR THE 14" x 14" (350 x 350) OPENING, IF REQUIRED, AND NO ADDITIONAL COMPENSATION WILL BE ALLOWED.

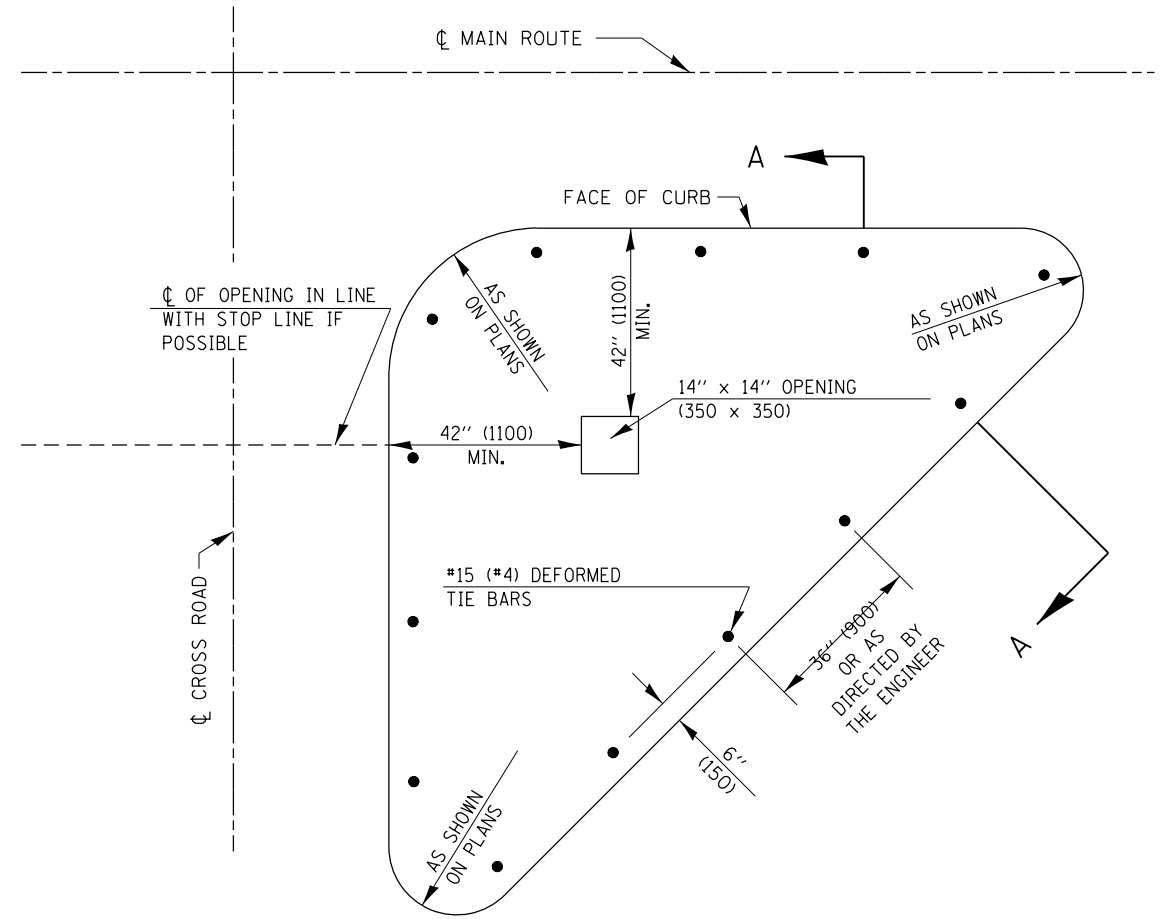
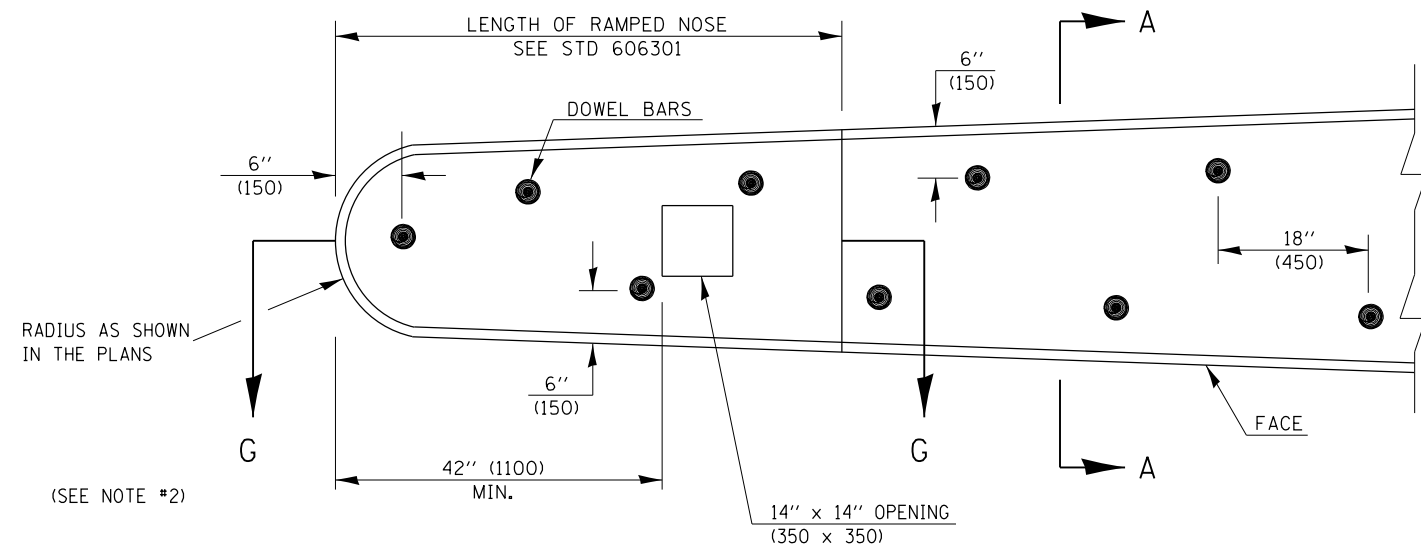

Note: All dimensions are in INCHES (millimeters) unless otherwise shown.

FILE NAME =	USER NAME = dodgms	DESIGNED -	REVISED - 11/06
pw\11084EBIDINTEG.illinois.gov\PIWIDOT\Documents\DOT Offices\District 5\Projects\0570\0570C68-shr-details.dwg		DRAWN -	REVISED - 08/09 - KJT
		CHECKED -	REVISED - 07/14 - JWS
		DATE -	REVISED -

**STATE OF ILLINOIS  
DEPARTMENT OF TRANSPORTATION**

**CONCRETE MEDIAN, TYPE SM (DOWELLED)**

SCALE:	SHEET NO.	OF SHEETS	STA.	TO STA.
--------	-----------	-----------	------	---------

<b>DISTRICT 5 DETAIL NO. 60622354</b>				
F.A. RTE.	SECTION	COUNTY	TOTAL SHEETS	SHEET NO.
VAR.	D5 INLAY 2017-1	*	23	18
* CHAMPAIGN & DOUGLAS			CONTRACT NO. 70C68	
FED. ROAD DIST. NO.	ILLINOIS	FED. AID PROJECT		

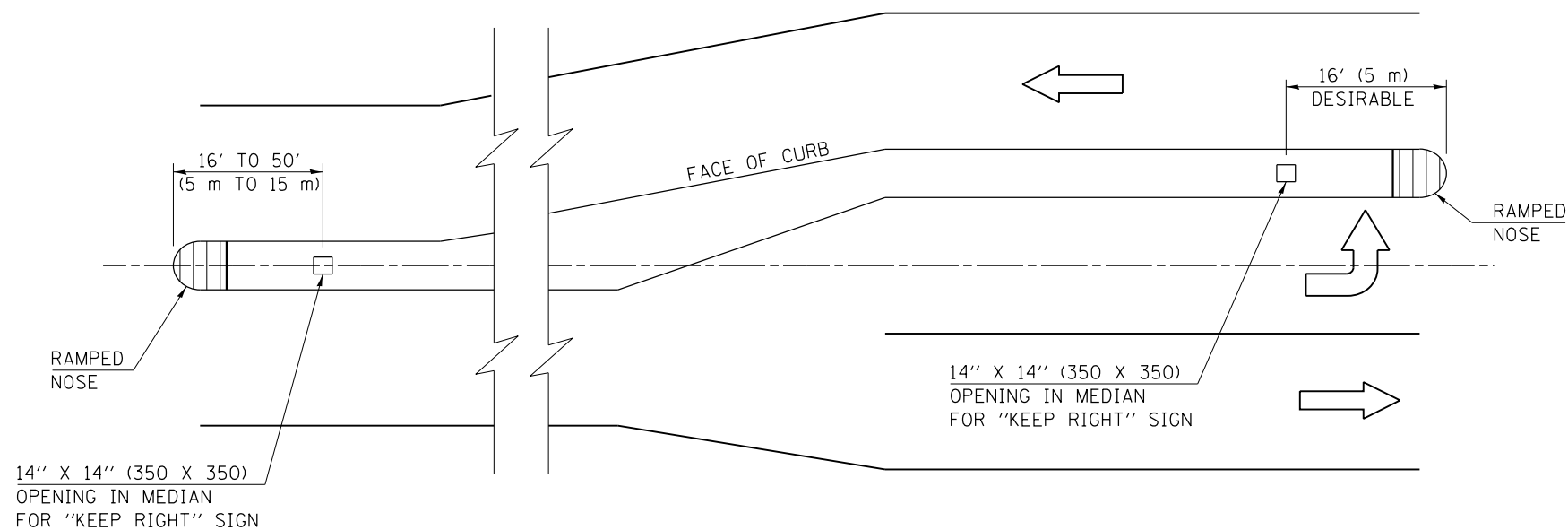

LOCATION OF OPENINGS FOR "KEEP RIGHT" SIGNS

GENERAL NOTES

1. ALL SMALL ISLANDS SHALL BE CONSTRUCTED WITH THE STOP SIGN ISLANDS AS SHOWN, UNLESS OTHERWISE SPECIFIED.
2. OPENINGS FOR SIGNS IN MEDIANS SHALL BE AS SHOWN OR AS DIRECTED BY THE ENGINEER.
3. THIS WORK WILL NOT BE PAID FOR SEPARATELY, BUT SHALL BE INCLUDED IN THE CONTRACT UNIT PRICE FOR THE TYPE OF MEDIAN SPECIFIED IN THE PLANS AND NO ADDITIONAL COMPENSATION WILL BE ALLOWED.

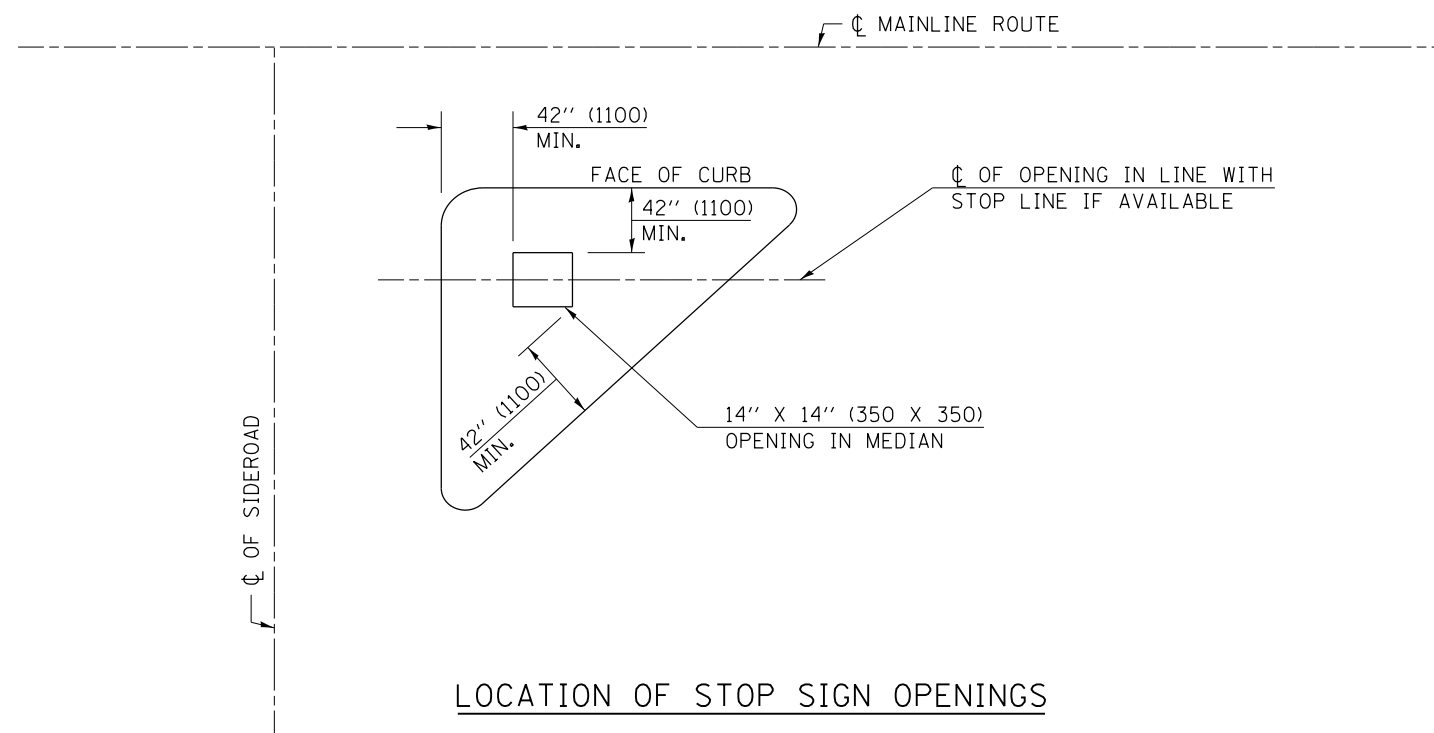

LOCATION OF STOP SIGN OPENINGS

Note: All dimensions are in INCHES (millimeters) unless otherwise shown.

**DISTRICT 5 DETAIL NO. 60623711**

FILE NAME =	USER NAME = dodgms	DESIGNED -	REVISED - 11/06
p:\11\084EBIDINTEG.illinois.gov\PI\DOT\Documents\DOT Offices\District 5\Projects\0570C68\0570C68-shr-details.dwg		CHECKED -	REVISED -
	PLOT SCALE = 40.0000' / in.	DATE -	REVISED -
	PLOT DATE = 3/24/2017		

**STATE OF ILLINOIS  
DEPARTMENT OF TRANSPORTATION**

**SIGN POST BLOCKOUTS**

SCALE: SHEET NO. OF SHEETS STA. TO STA.

F.A. RTE.	SECTION	COUNTY	TOTAL SHEETS	SHEET NO.
VAR.	D5 INLAY 2017-1	*	23	19
* CHAMPAIGN & DOUGLAS			CONTRACT NO. 70C68	
FED. ROAD DIST. NO.		ILLINOIS FED. AID PROJECT		

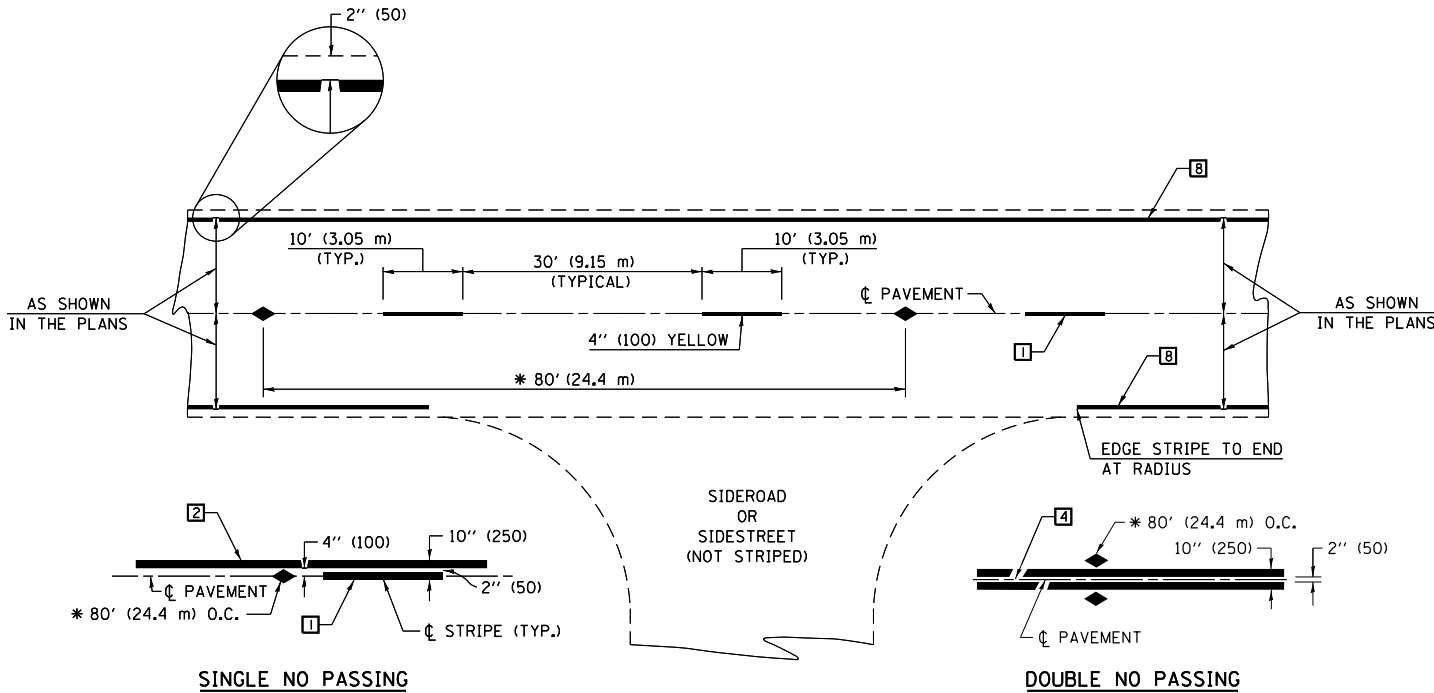

\* REDUCE TO 40' (12.2 m) O.C. ON CURVES WITH POSTED OR ADVISORY SPEEDS OF 45 mph (70 km/h) OR LESS.

**TWO LANE/TWO WAY**

**TYPICAL PAVEMENT MARKING LEGEND**

- 1 4" (100) SKIP-DASH (YELLOW)
- 2 4" (100) SOLID (YELLOW)
- 3 12" (300) DIAGONAL (YELLOW)
- 4 4" (100) DOUBLE YELLOW (NARROW)
- 5 RESERVED
- 6 RESERVED
- 7 4" (100) SKIP-DASH (WHITE)
- 8 4" (100) SOLID (WHITE)
- 9 12" (300) DIAGONAL (WHITE)
- 10 6" (150) SOLID (WHITE)
- 11 24" (600) STOP BAR (WHITE)
- 12 8" (200) SOLID (WHITE)
- 13 4" (100) LANE LINE EXTENSIONS (WHITE)
- 14 4" (100) PARKING WHITE

**TYPICAL PAVEMENT MARKERS LEGEND**

- ◆ TWO-WAY AMBER MARKER
- ▶ ONE-WAY AMBER MARKER
- ▷ ONE-WAY CRYSTAL MARKER

**RURAL LEFT TURN**

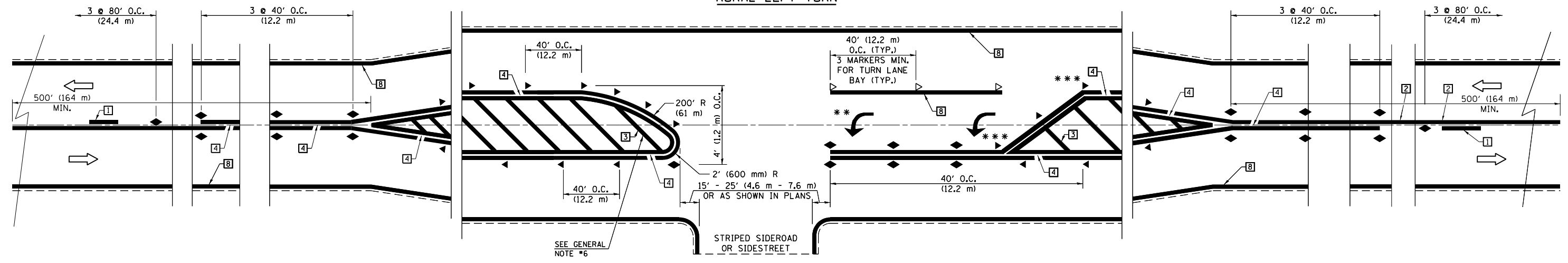

\*\*\* REDUCE SPACING IF NECESSARY TO ASSURE MARKERS AT CORNER POINTS.  
 \*\* TURN ARROWS SHALL BE PLACED AS SHOWN ON SHEET #2.

Note: All dimensions are in INCHES (millimeters) unless otherwise shown.

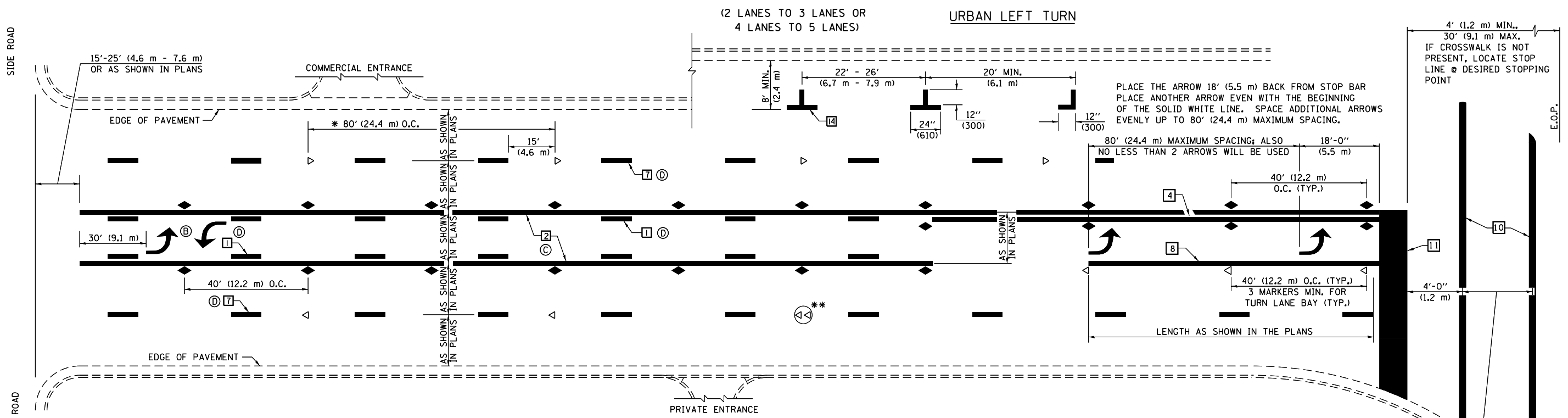

\* REDUCE TO 40 FEET (12.2 METERS) ON CENTER ON CURVES WHERE ADVISORY SPEEDS ARE 10 MPH (15 km/h) LOWER THAN POSTED SPEEDS.

\*\* DOUBLE LANE LINE MARKERS SHALL BE SPECIFIED AND SPACED AS SHOWN IN HIGHWAY STANDARD 781001 FOR MULTI-LANE DIVIDED AND UNDIVIDED HIGHWAYS.

- GENERAL NOTES:**
- ⓑ TURN ARROW PAIRS SHALL BE PLACED AT 250' (75 m) INTERVALS AND SHALL BE EVENLY SPACED BETWEEN BOTH ENDS OF THE BIDIRECTIONAL LEFT TURN LANE.
  - ⓒ THE SOLID YELLOW PAVEMENT MARKINGS [2] SHOULD GENERALLY START OR END NEAR THE RADIUS POINT OF EACH STREET RETURN EXCEPT WHERE ONE OR BOTH ENDS WOULD INCLUDE STOP BARS.
  - ⓓ THE SKIP-DASH PAVEMENT MARKINGS [1] OR [7] SHOULD BE CENTERED BETWEEN BOTH ENDS OF EACH CITY BLOCK AND SHALL BE PLACED SO THEY LINE UP ACROSS FROM EACH OTHER. SEE EXAMPLE ON SHEET 2 OF 3.
  - ⓔ USE LARGE ARROW SIZE FOR BOTH RURAL AND URBAN LOCATIONS. (SEE LAST PAGE OF SECTION 780x FOR SYMBOLS TABLE)

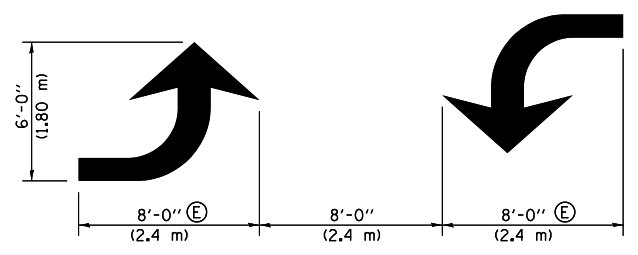
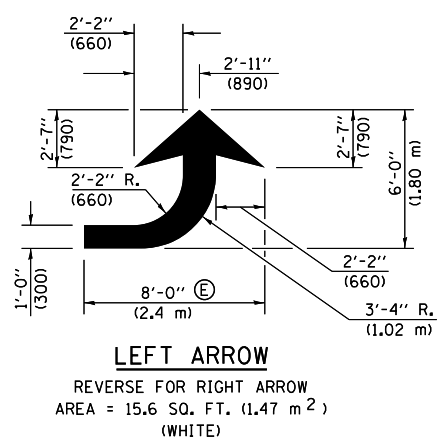

TYPICAL DOUBLE TURN ARROWS (WHITE)

**BLOOMINGTON-NORMAL CITY LIMITS ONLY**

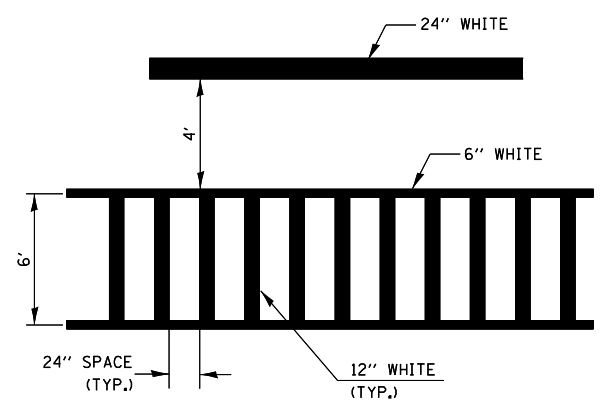

TYPICAL SPACING FOR CROSSWALKS & STOP BARS

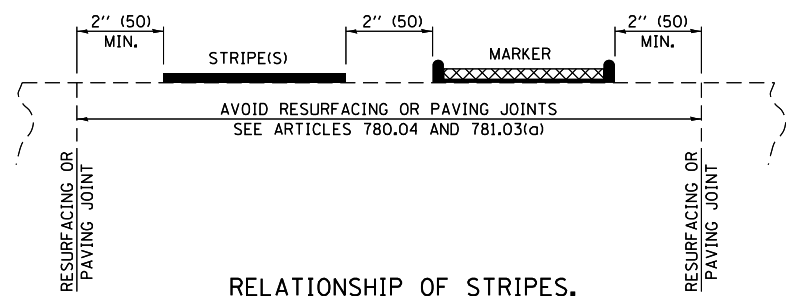

RELATIONSHIP OF STRIPES, MARKERS AND JOINTS

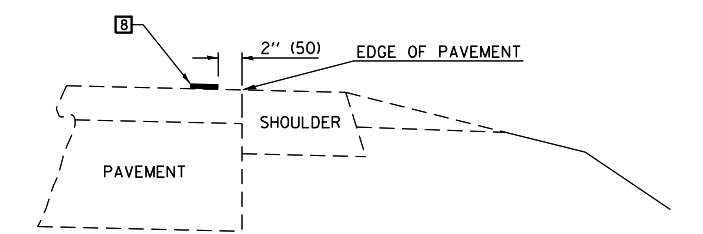

RELATIONSHIP OF EDGE LINE TO EDGE OF PAVEMENT (SAFETY SHOULDER OR PAVED SURFACE) SEE ARTICLE 780.04

CROSSWALK WIDTH 6'-0" (1.8 m) OR AS SHOWN IN THE PLANS

Note: All dimensions are in INCHES (millimeters) unless otherwise shown.

FILE NAME =	USER NAME = dodgms	DESIGNED -	REVISED - 11/06	<b>STATE OF ILLINOIS DEPARTMENT OF TRANSPORTATION</b>	<b>PAVEMENT MARKING AND MARKERS (RURAL &amp; URBAN APPLICATIONS)</b>				F.A. RTE.	SECTION	COUNTY	TOTAL SHEETS	SHEET NO.
pw\11\084EBIDINTEG.illinois.gov\PIWIDOT\Documents\DOT Offices\District 5\Projects\0570C68\Design\0570C68-shd-details.dwg	DRAWN	09/2009 - KJT	04/14 - JLA						VAR.	D5 INLAY 2017-1		23	21
PLOT SCALE = 40.0000' / in.	CHECKED -	REVISOR -	DATE -		• CHAMPAIGN & DOUGLAS CONTRACT NO. 70C68								
PLOT DATE = 3/24/2017	DATE -	REVISOR -	DATE -		FED. ROAD DIST. NO. ILLINOIS FED. AID PROJECT								

**DISTRICT 5 DETAIL NO. 7800AAA**

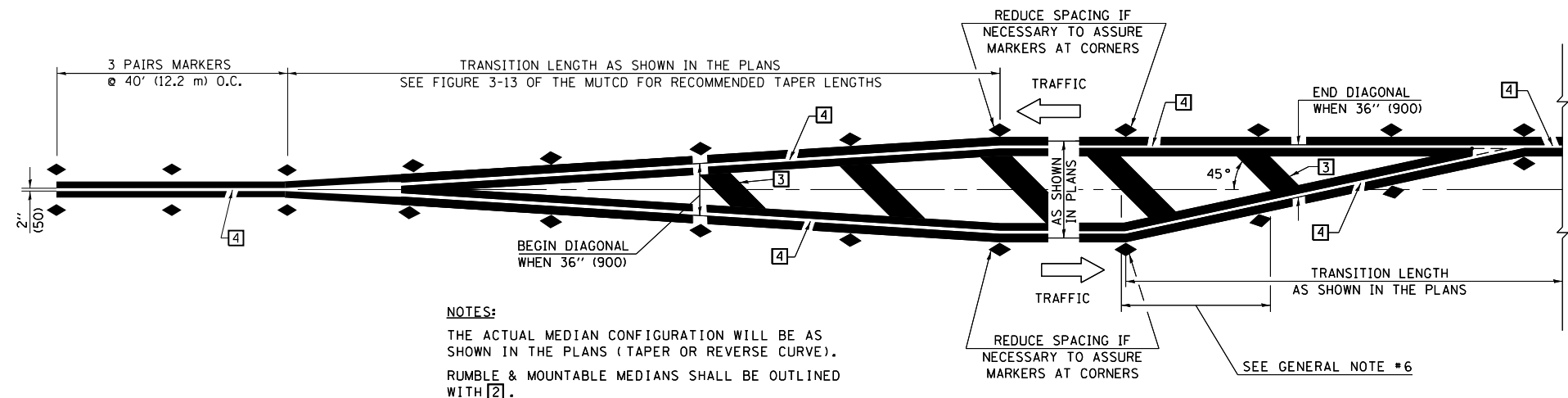

**NOTES:**  
 THE ACTUAL MEDIAN CONFIGURATION WILL BE AS SHOWN IN THE PLANS (TAPER OR REVERSE CURVE).  
 RUMBLE & MOUNTABLE MEDIANS SHALL BE OUTLINED WITH [2].

**TYPICAL MEDIAN TRANSITIONS**

**GENERAL NOTES**

1. WHEN MEDIANS ARE PRESENT, PAVEMENT MARKINGS ARE TO BE PLACED ADJACENT TO MEDIANS.
2. SOME OF THE INFORMATION INCLUDED WITH THIS DETAIL MAY NOT BE APPLICABLE TO THIS IMPROVEMENT.
3. PAVEMENT MARKINGS ARE TO BE EXTENDED THROUGH OMISSIONS WHEN APPLICABLE.
4. A STRIPING KEY IS AVAILABLE ELSEWHERE AND SHALL BE SHOWN WHERE THE QUANTITIES ARE LISTED.
5. FINAL PAVEMENT MARKINGS SHALL BE IN PLACE PRIOR TO PLACING ANY RAISED REFLECTIVE PAVEMENT MARKERS.
6. THE FOLLOWING CRITERIA SHALL BE USED FOR SELECTING THE DIAGONAL PAVEMENT MARKING SPACING,  
 < 30 MPH USE 15' (< 50 km/h USE 4.5 m)  
 30-45 MPH USE 20' (50-75 km/h USE 6.0 m)  
 > 45 MPH USE 30' (> 75 km/h USE 9.0 m)

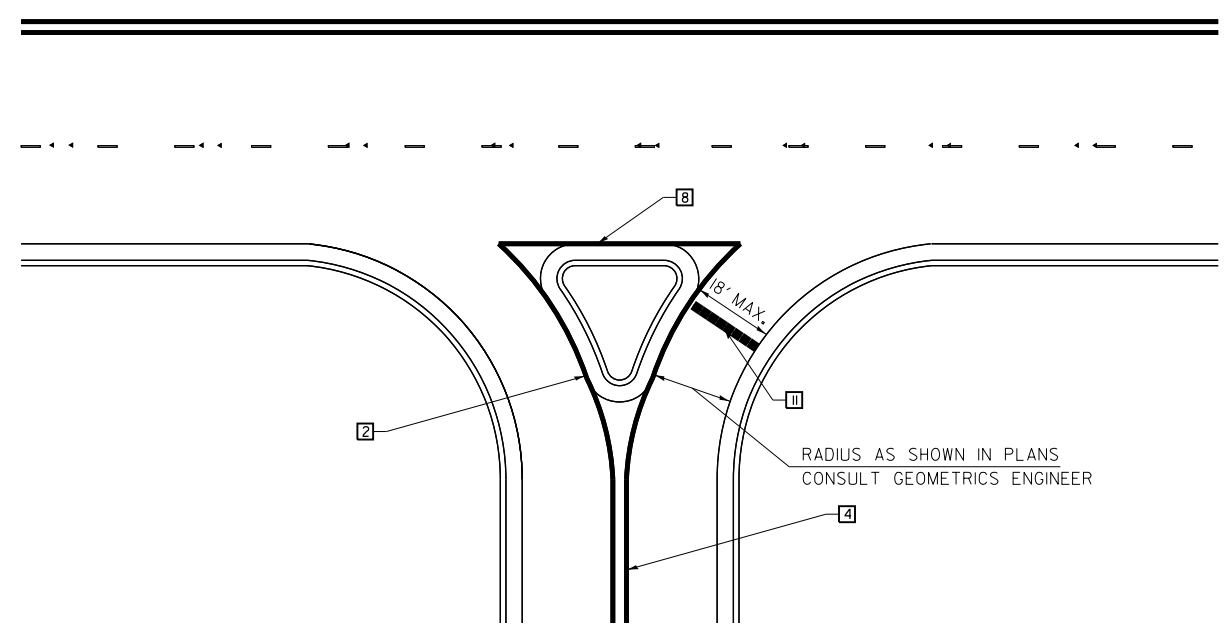

**RIGHT IN - RIGHT OUT ACCESS**

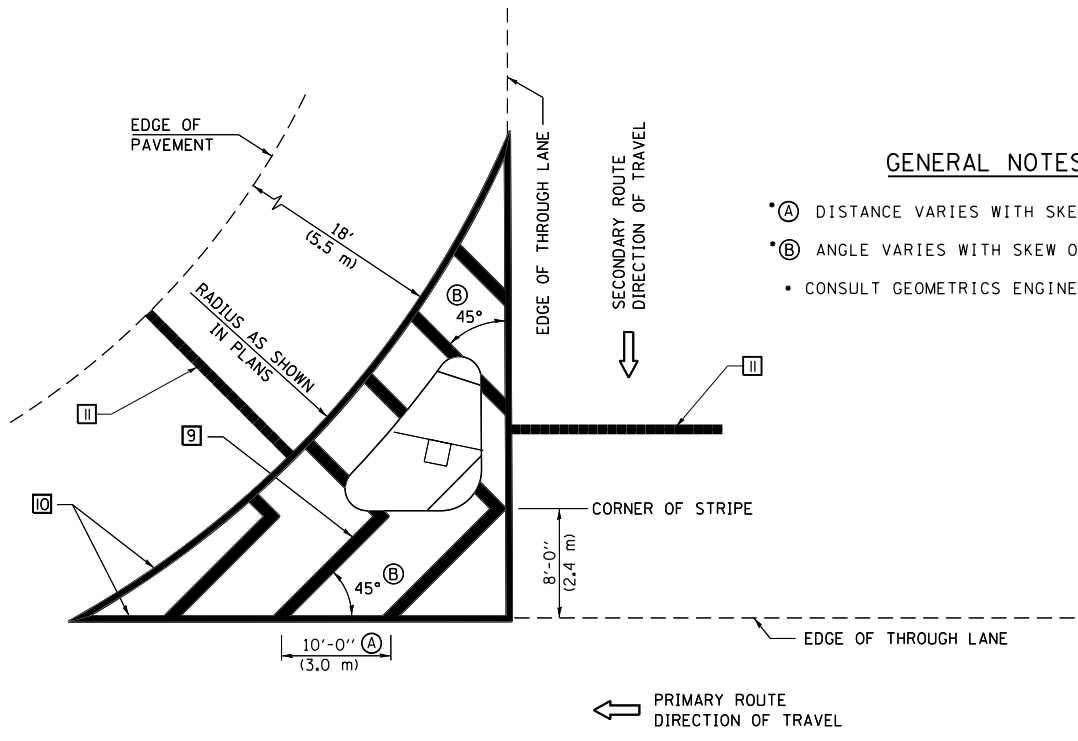

**ISLAND**

**GENERAL NOTES**

- (A) DISTANCE VARIES WITH SKEW OF INTERSECTION.
- (B) ANGLE VARIES WITH SKEW OF INTERSECTION.
- CONSULT GEOMETRICS ENGINEER

Note: All dimensions are in INCHES (millimeters) unless otherwise shown.

FILE NAME =	USER NAME = dodgms	DESIGNED -	REVISED - 11/06
pw:\IL\084EBIDINTEG\illinois.gov\PWIDOT\Documents\DOT Offices\District 5\Projects\0570\DRAWING\Design\0570C68-shr-details.dwg		DRAWN -	REVISED - 09/2009 - KJT
	PLOT SCALE = 40.0000' / in.	CHECKED -	REVISED - 04/14 - JLA
	PLOT DATE = 3/24/2017	DATE -	REVISED -

**STATE OF ILLINOIS  
 DEPARTMENT OF TRANSPORTATION**

**PAVEMENT MARKING AND MARKERS  
 (RURAL & URBAN APPLICATIONS)**

SCALE: SHEET NO. OF SHEETS STA. TO STA.

**DISTRICT 5 DETAIL NO. 7800AAA**

F.A. RTE.	SECTION	COUNTY	TOTAL SHEETS	SHEET NO.
VAR.	D5 INLAY 2017-1	*	23	22
* CHAMPAIGN & DOUGLAS			CONTRACT NO. 70C68	
FED. ROAD DIST. NO. ILLINOIS FED. AID PROJECT				

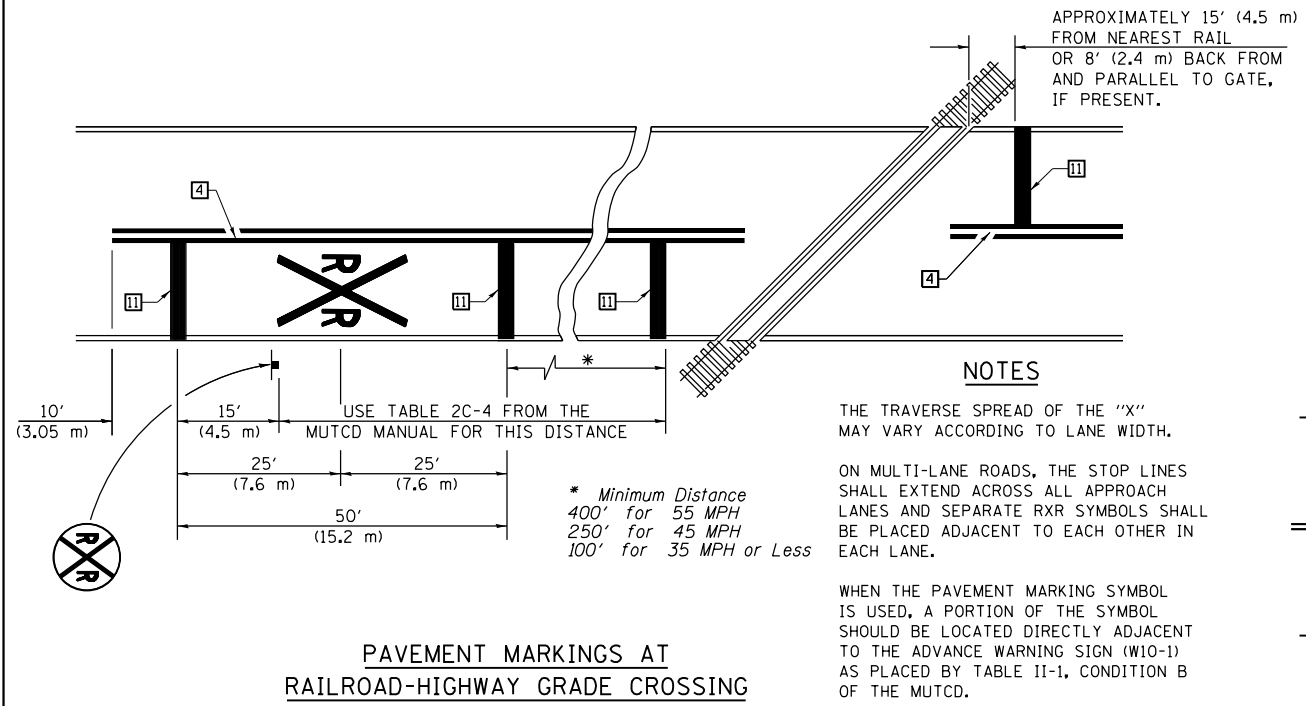

**PAVEMENT MARKINGS AT  
RAILROAD-HIGHWAY GRADE CROSSING**

**RAILROAD CROSSING WITH INTERCONNECT ONLY**

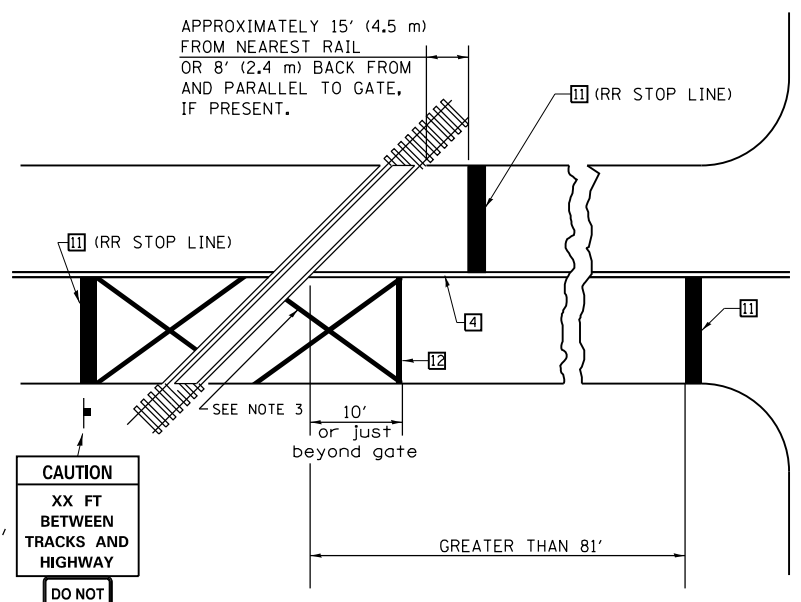

W10-1100  
30" X 36"

CAUTION  
XX FT  
BETWEEN  
TRACKS AND  
HIGHWAY

DO NOT  
STOP ON  
TRACKS

R8-8  
24" X 30"

**RAILROAD CROSSING WITH INTERCONNECT AND PRE-SIGNALS**

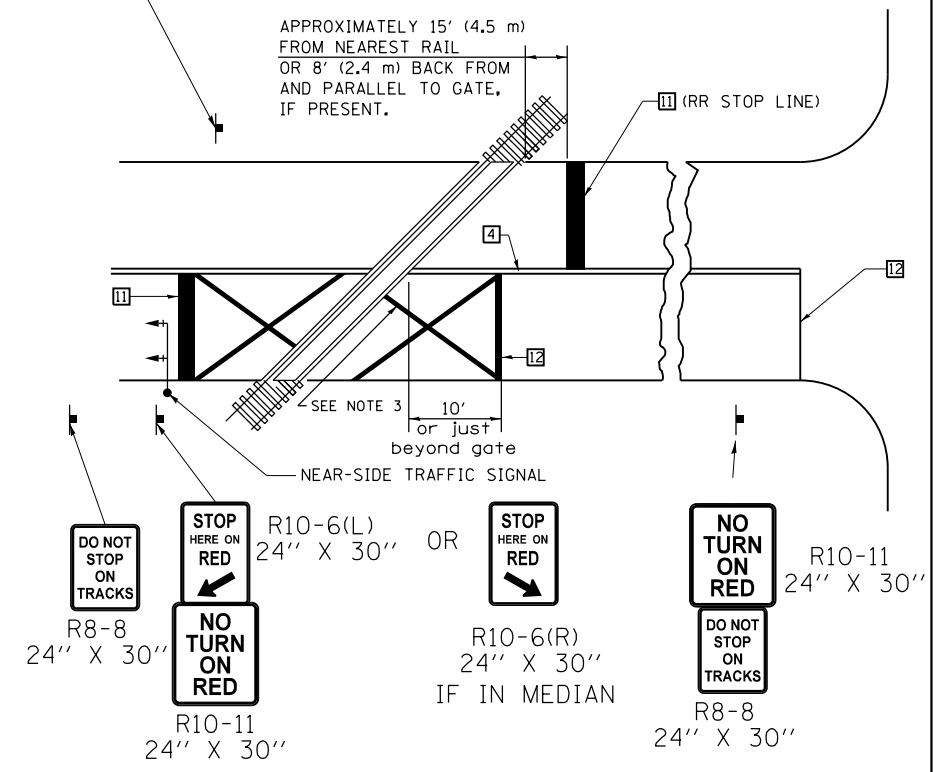

**SUPPLEMENTAL PAVEMENT MARKING TREATMENT FOR  
RAILROAD-HIGHWAY GRADE CROSSING**

**GENERAL NOTES**

- SUPPLEMENTAL PAVEMENT MARKINGS TO BE INSTALLED ONLY ON APPROACHES TO INTERSECTIONS CONTROLLED BY TRAFFIC SIGNALS WHICH ARE INTERCONNECTED WITH THE RAILROAD WARNING SIGNALS.
- EXTEND PAVEMENT MARKINGS TO THE INTERSECTION ONLY WHERE NEAR-SIDE TRAFFIC SIGNALS ARE USED.
- 6" WHITE PAVEMENT MARKINGS AT 45° TO PAVEMENT, 8' CENTER TO CENTER.
- XX DISTANCE TO BE SHOWN ON SIGN MEASURED FROM A POINT 6 FEET FROM THE RAIL CLOSEST TO THE INTERSECTION OR FROM THE CLOSEST POINT ALONG THE EXIT GATE IF PRESENT OVER THE ROADWAY WHEN IN THE LOWERED POSITION TO THE STOP BAR OR CROSSWALK, WHICH EVER IS CLOSEST, ROUNDED DOWN TO NEAREST 5 FEET. WHERE THERE IS NO STOP LINE, MEASURE TO POINT WHERE DRIVER HAS A VIEW OF APPROACHING TRAFFIC.
- THE CLEARANCE SIGN IS ALSO TO BE USED AS AN INTERIM MEASURE AT LOCATIONS WITH INTERCONNECTED INTERSECTION TRAFFIC SIGNALS WHERE IT IS PLANNED TO CHANGE THEM TO NEAR-SIDE SIGNALS AT A FUTURE TIME. IN THIS CASE, THE DISTANCE TO BE SHOWN ON THE SIGN IS MEASURED FROM THE EDGE OF THE STRIPED-OUT AREA INSTEAD OF 6 FEET FROM THE RAIL. THE SIGN IS TO BE REMOVED WHEN THE NEAR-SIDE SIGNALS ARE INSTALLED AND THE PAVEMENT MARKINGS EXTENDED TO THE INTERSECTION.

Note: All dimensions are in INCHES (millimeters) unless otherwise shown.

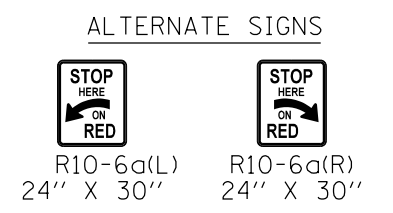
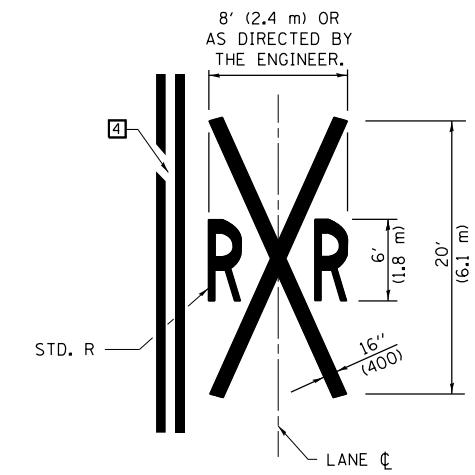

FILE NAME =	USER NAME = dodgms	DESIGNED -	REVISED - 11/06
pw:\IL084EBIDINTEG\illinois.gov\PWIDOT\Documents\DOT Offices\District 5\Projects\0570\BRAND\0570\0570-C68-sht-details.dwg		CHECKED -	REVISED - 09/2009 - KJT
		DATE -	REVISED - 04/14 - JLA
			REVISED -

**STATE OF ILLINOIS  
DEPARTMENT OF TRANSPORTATION**

<b>PAVEMENT MARKING AND MARKERS (RURAL &amp; URBAN APPLICATIONS)</b>			
SCALE:	SHEET NO. OF SHEETS	STA.	TO STA.

**DISTRICT 5 DETAIL NO. 7800AAAA**

F.A. RTE.	SECTION	COUNTY	TOTAL SHEETS	SHEET NO.
VAR.	D5 INLAY 2017-1	*	23	23
CHAMPAIGN & DOUGLAS		CONTRACT NO. 70C68		
FED. ROAD DIST. NO. ILLINOIS FED. AID PROJECT				