

05/01/2006, 08:29 AM  
1:104Jobs0083103104TXYP Taxilanes Re-design (June 2006)(CivilSheet)11 Removal Hangar Plan 02.dgn

LDH

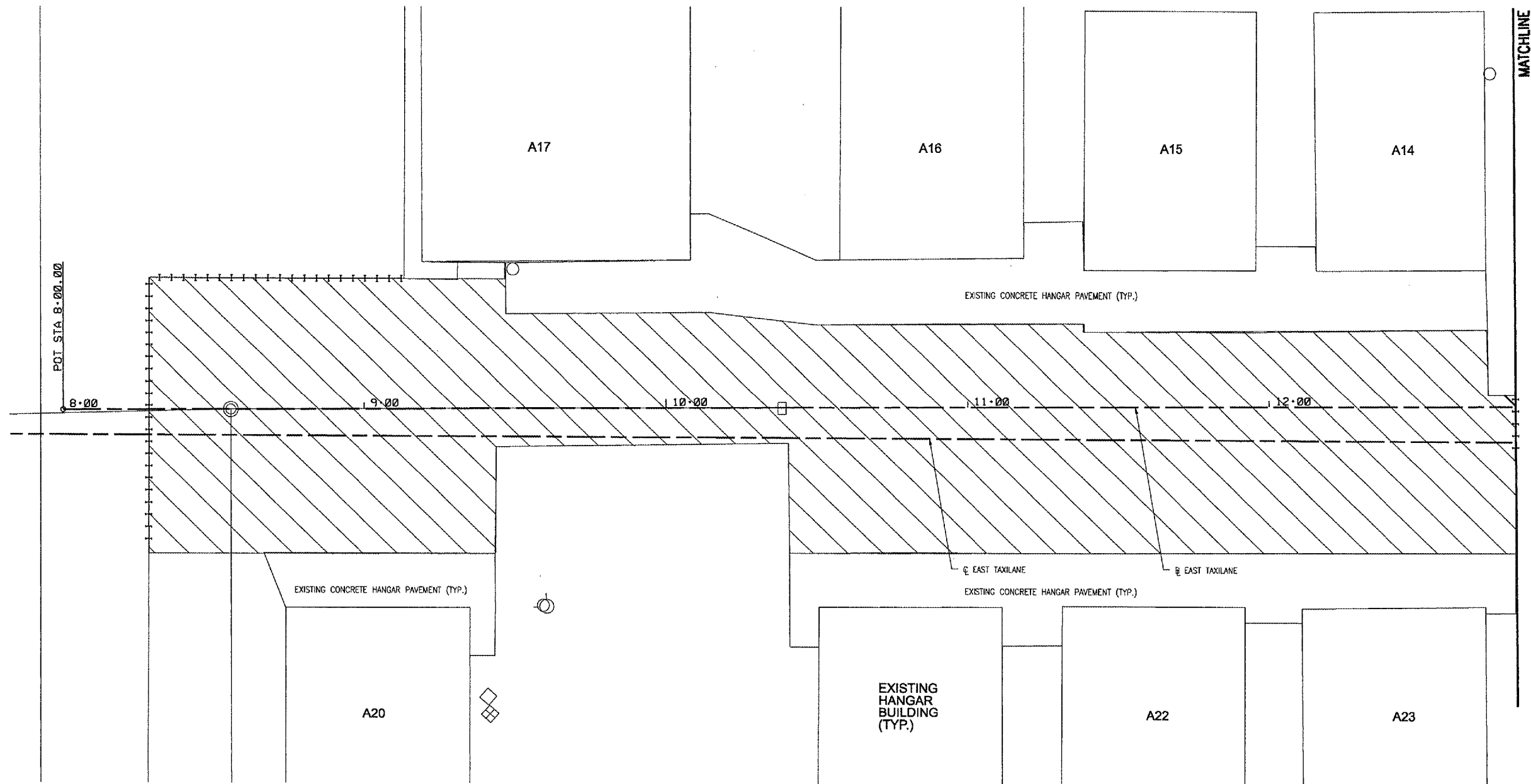

#### NOTES

1. EXISTING BITUMINOUS PAVEMENT, UNDERCUT, UNDERDRAINS, AND STORM SEWER RELATED ITEMS TO BE REMOVED ARE TO BE DISPOSED OF AT AN OFFSITE LOCATION. SEE SPECIAL PROVISIONS.
2. SEE PLAN SHEETS FOR COORDINATES OF PROPOSED SAWCUT LOCATIONS

#### LEGEND

	EXISTING STORM SEWER
	EXISTING STORM SEWER MANHOLE
	EXISTING STORM SEWER INLET
	EXISTING WATER VALVE
	EXISTING TELEPHONE BOX
	EXISTING ELECTRICAL BOX
	PROPOSED SAWCUT, ITEM 401665
	BITUMINOUS PAVEMENT REMOVAL, 4" (NOMINAL) ITEM AR401900
	BITUMINOUS PAVEMENT MILLING, 1" ITEM AR401650
	BITUMINOUS PAVEMENT REMOVAL, ITEM 401900 AGGREGATE BASE COURSE REMOVAL, QUANTITY INCLUDED IN ITEM AR152410

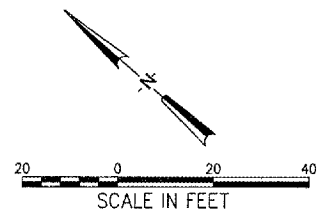

WA056



HANSON PROFESSIONAL SERVICES INC.

815 Commerce Drive, Suite 200  
Oak Brook, Illinois 60523  
Telephone: 630.990.3800  
Fax: 630.990.3801



Waukegan Regional Airport  
Waukegan Regional Port District

3580 North McAree Road  
Waukegan, Illinois 60087  
Phone: 847.244.0055  
Fax: 847.244.3813

WAUKEGAN REGIONAL AIRPORT

REHABILITATE HANGAR  
TAXILANES AND SERVICE  
ROAD

IDA PROJECT NO. UGN-3601

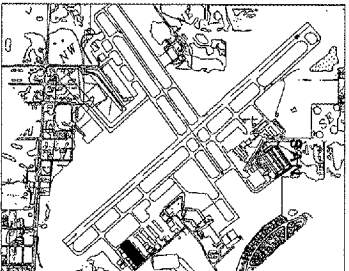

KEY MAP

No.	Drawing Issue Description	Date	By

Date

APRIL 21, 2006

Sheet Title

SAWCUTTING AND  
PAVEMENT REMOVAL  
EAST TAXILANE

831-04TXYP

Project Number

RPH 11/15/05

Layout By Date

RPH 11/15/05

Designed By Date

RPH 04/04/06

Reviewed By Date

SJM DSY --

Drawn By

11

Sheet No.