

05/01/2006, 08:27 AM
I:\04\Jobs\0083103104\TXYP Taxilanes Re-design (June 2006)\Civil\Sheet\08 Construction Staging 3.dgn
LDH

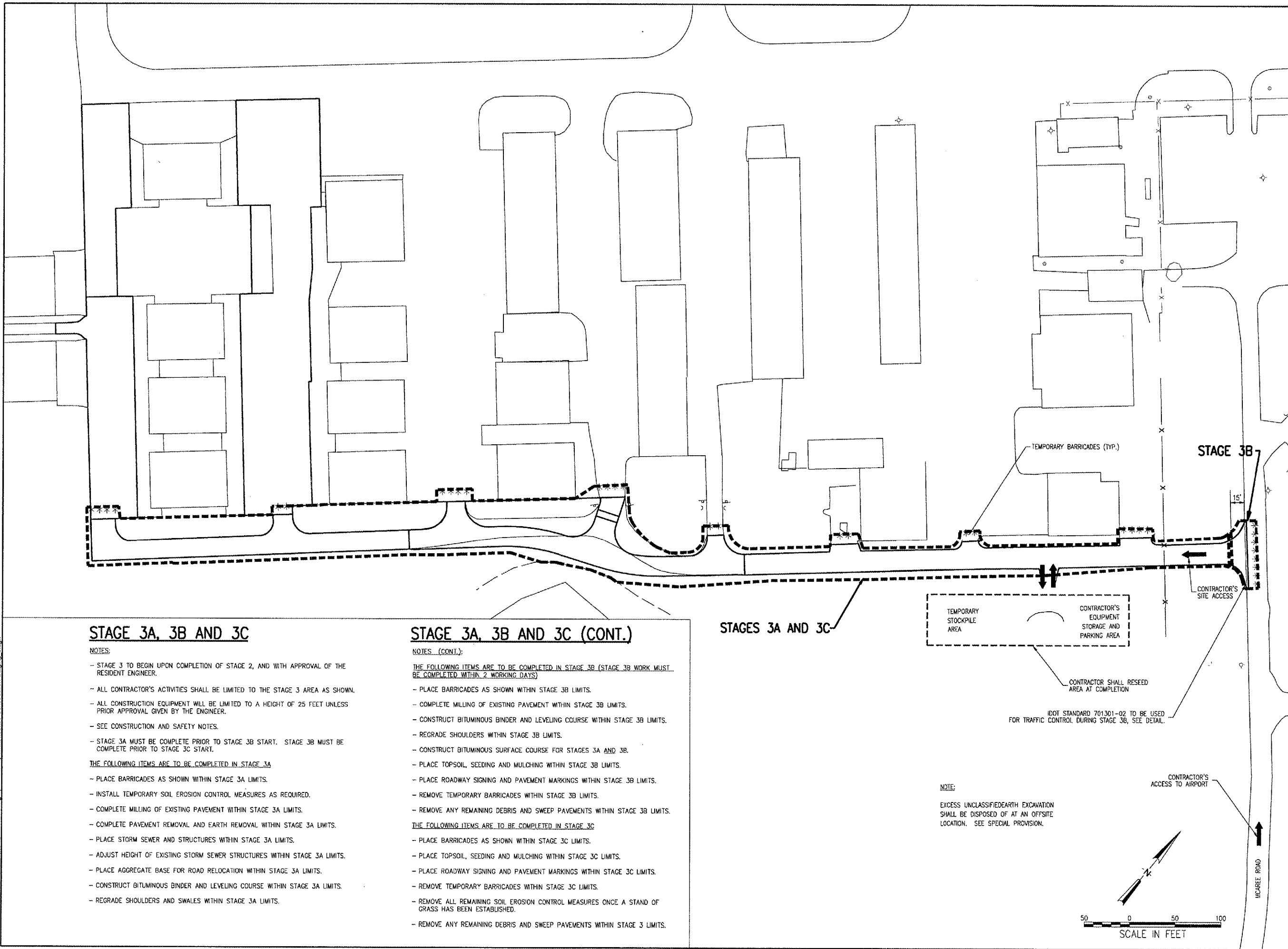

STAGE 3A, 3B AND 3C

NOTES:

- STAGE 3 TO BEGIN UPON COMPLETION OF STAGE 2, AND WITH APPROVAL OF THE RESIDENT ENGINEER.
- ALL CONTRACTOR'S ACTIVITIES SHALL BE LIMITED TO THE STAGE 3 AREA AS SHOWN.
- ALL CONSTRUCTION EQUIPMENT WILL BE LIMITED TO A HEIGHT OF 25 FEET UNLESS PRIOR APPROVAL GIVEN BY THE ENGINEER.
- SEE CONSTRUCTION AND SAFETY NOTES.
- STAGE 3A MUST BE COMPLETE PRIOR TO STAGE 3B START. STAGE 3B MUST BE COMPLETE PRIOR TO STAGE 3C START.

THE FOLLOWING ITEMS ARE TO BE COMPLETED IN STAGE 3A

- PLACE BARRICADES AS SHOWN WITHIN STAGE 3A LIMITS.
- INSTALL TEMPORARY SOIL EROSION CONTROL MEASURES AS REQUIRED.
- COMPLETE MILLING OF EXISTING PAVEMENT WITHIN STAGE 3A LIMITS.
- COMPLETE PAVEMENT REMOVAL AND EARTH REMOVAL WITHIN STAGE 3A LIMITS.
- PLACE STORM SEWER AND STRUCTURES WITHIN STAGE 3A LIMITS.
- ADJUST HEIGHT OF EXISTING STORM SEWER STRUCTURES WITHIN STAGE 3A LIMITS.
- PLACE AGGREGATE BASE FOR ROAD RELOCATION WITHIN STAGE 3A LIMITS.
- CONSTRUCT BITUMINOUS BINDER AND LEVELING COURSE WITHIN STAGE 3A LIMITS.
- REGRADE SHOULDERS AND SWALES WITHIN STAGE 3A LIMITS.

STAGE 3A, 3B AND 3C (CONT.)

NOTES (CONT.):

THE FOLLOWING ITEMS ARE TO BE COMPLETED IN STAGE 3B (STAGE 3B WORK MUST BE COMPLETED WITHIN 2 WORKING DAYS)

- PLACE BARRICADES AS SHOWN WITHIN STAGE 3B LIMITS.
- COMPLETE MILLING OF EXISTING PAVEMENT WITHIN STAGE 3B LIMITS.
- CONSTRUCT BITUMINOUS BINDER AND LEVELING COURSE WITHIN STAGE 3B LIMITS.
- REGRADE SHOULDERS WITHIN STAGE 3B LIMITS.
- CONSTRUCT BITUMINOUS SURFACE COURSE FOR STAGES 3A AND 3B.
- PLACE TOPSOIL, SEEDING AND MULCHING WITHIN STAGE 3B LIMITS.
- PLACE ROADWAY SIGNING AND PAVEMENT MARKINGS WITHIN STAGE 3B LIMITS.
- REMOVE TEMPORARY BARRICADES WITHIN STAGE 3B LIMITS.
- REMOVE ANY REMAINING DEBRIS AND SWEEP PAVEMENTS WITHIN STAGE 3B LIMITS.

THE FOLLOWING ITEMS ARE TO BE COMPLETED IN STAGE 3C

- PLACE BARRICADES AS SHOWN WITHIN STAGE 3C LIMITS.
- PLACE TOPSOIL, SEEDING AND MULCHING WITHIN STAGE 3C LIMITS.
- PLACE ROADWAY SIGNING AND PAVEMENT MARKINGS WITHIN STAGE 3C LIMITS.
- REMOVE TEMPORARY BARRICADES WITHIN STAGE 3C LIMITS.
- REMOVE ALL REMAINING SOIL EROSION CONTROL MEASURES ONCE A STAND OF GRASS HAS BEEN ESTABLISHED.
- REMOVE ANY REMAINING DEBRIS AND SWEEP PAVEMENTS WITHIN STAGE 3C LIMITS.

WA056



HANSON PROFESSIONAL SERVICES INC.

815 Commerce Drive, Suite 200
Oak Brook, Illinois 60523
Telephone: 630.990.3800
Fax: 630.990.3801



Waukegan Regional Airport
Waukegan Regional Port District

3580 North McAree Road
Waukegan, Illinois 60087
Phone: 847.244.0055
Fax: 847.244.3813

WAUKEGAN REGIONAL AIRPORT

REHABILITATE HANGAR
TAXILANES AND SERVICE
ROAD

IDA PROJECT NO. UGN-3601

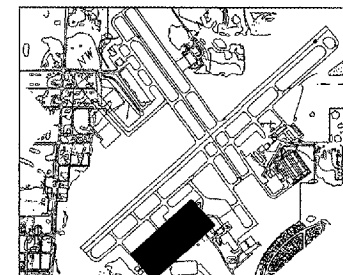

KEY MAP

No.	Drawing Issue Description	Date	By

Date
APRIL 21, 2006

Sheet Title

CONSTRUCTION STAGING
PLAN - SERVICE ROAD
STAGE 3

831-04TXD

Project Number

RPH 11/15/05

Layout By Date

RPH 11/15/05

Designed By Date

RPH/RPH 04/04/06

Reviewed By Date

RPH SJM

Drawn By

Sheet No.