

F.A.P. RTE.	SECTION	COUNTY	TOTAL SHEETS	SHEET NO.
314	(520,108,109,110)PP-1	MADISON	7	1
		ILLINOIS	CONTRACT NO. 76L59	

D-98-074-18



06-15-2018 LETTING ITEM 082

FOR INDEX OF SHEETS, SEE SHEET NO. 2

STATE OF ILLINOIS
DEPARTMENT OF TRANSPORTATION

**PROPOSED
HIGHWAY PLANS**

FAP ROUTE 314 (IL 4)
SECTION (520,108,109,110)PP-1
PATCHING
MADISON COUNTY

C-98-258-18

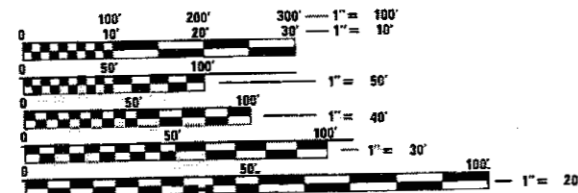

FULL SIZE PLANS HAVE BEEN PREPARED USING STANDARD ENGINEERING SCALES. REDUCED SIZED PLANS WILL NOT CONFORM TO STANDARD SCALES. IN MAKING MEASUREMENTS ON REDUCED PLANS, THE ABOVE SCALES MAY BE USED.

J.U.L.I.E.
JOINT UTILITY LOCATION INFORMATION FOR EXCAVATION
1-800-892-0123
OR 811

PROJECT ENGINEER: HERVE GELIN (618)346-3179
PROJECT MANAGER: BILLIE OWEN (618)346-3209

CONTRACT NO. 76L59

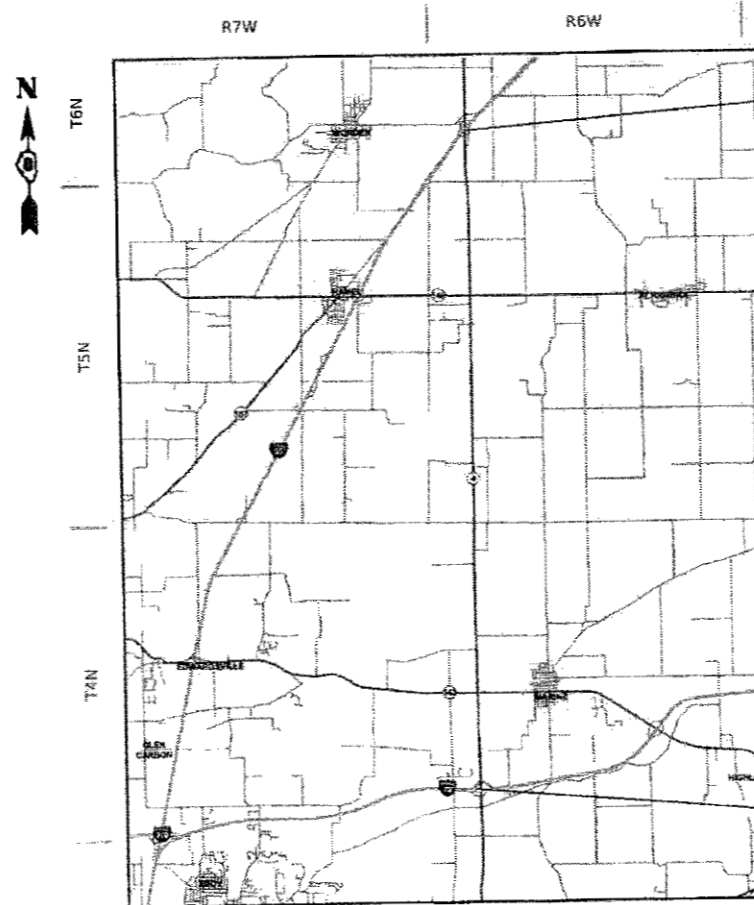

NOT TO SCALE

BEGIN PROJECT
M.P. 18.8
LAT: 38.9312
LONG: -89.8014

END PROJECT
M.P. 7.3
LAT: 38.7619
LONG: -89.8007

GROSSNET LENGTH = 61,828.8 FT. = 11.71 MILE

STATE OF ILLINOIS
DEPARTMENT OF TRANSPORTATION

SUBMITTED *March 20, 2018*
Jeffrey Z. Khan REGIONAL ENGINEER

May 11, 2018
ENGINEER OF DESIGN AND ENVIRONMENT

May 11, 2018
Daniel P. [Signature] DIRECTOR OF HIGHWAYS PROJECT IMPLEMENTATION

PRINTED BY THE AUTHORITY
OF THE STATE OF ILLINOIS

INDEX OF SHEETS

- 1 COVER SHEET
- 2 INDEX OF SHEETS, HIGHWAY STANDARDS, GENERAL NOTES, AND COMMITMENTS
- 3 SUMMARY OF QUANTITIES
- 4 TYPICAL SECTIONS
- 5-7 SCHEDULES

STANDARDS

- 000001-06
- 001001-02
- 442201-03
- 701201-04
- 701301-04
- 701311-03
- 701336-06
- 701901-07
- 780001-05
- 781001-04

GENERAL NOTES

1 ILLINOIS STATE LAW REQUIRES A 48-HOUR NOTICE BE GIVEN TO ALL UTILITIES WITHIN THE PROJECT AREA BEFORE DIGGING. FIELD MARKING OF FACILITIES MAY BE OBTAINED BY CONTACTING J.U.L.I.E. OR FOR NON-MEMBERS, THE UTILITY COMPANY DIRECTLY. AGENCIES KNOWN TO HAVE FACILITIES WITHIN THE PROJECT AREA ARE AS FOLLOWS:

- * ALHAMBRA-GRANTFORK TELEPHONE CO.
- * AMEREN ILLINOIS
- * AT&T ILLINOIS
- * BOND MADISON WATER COMPANY
- * BUCKEYE PARTNERS L.P.--WOOD RIVER PIPELINE
- * ENABLE MIDSTREAM PARTNERS
- * VILLAGE OF HAMEL
- * HOME TELEPHONE COMPANY
- * LEVEL 3 COMMUNICATIONS, LLC
- * MADISON TELEPHONE COMPANY
- * MARATHON PIPE LINE, LLC
- * VILLAGE OF MARINE
- * PLAINES MARKETING, LP
- * SOUTHWESTERN ELECTRIC COOPERATIVE, INC.
- * TRANSCANADA KEYSTONE PIPELINE

MEMBERS OF J.U.L.I.E. CALL TOLL FREE (800) 892-0123 OR 811 AND ARE INDICATED BY *. NON- J.U.L.I.E. MEMBERS MUST BE NOTIFIED INDIVIDUALLY.

2 THE DEPARTMENT STRONGLY ENCOURAGES THE PRIME CONTRACTOR AND THEIR APPROVED SUB-CONTRACTORS TO HIRE MINORITY, WOMEN AND DISADVANTAGED INDIVIDUALS FROM ITS FEDERALLY FUNDED HIGHWAY CONSTRUCTION CAREERS TRAINING PROGRAM (HCCTP) TO HELP MEET WORKFORCE AND TRAINEE GOALS. THIS PROGRAM IS TRAINING MINORITIES, WOMEN AND DISADVANTAGED INDIVIDUALS IN HIGHWAY CONSTRUCTION-RELATED SKILLS, E.G., MATH FOR THE TRADES, JOB READINESS, TECHNICAL SKILLS COURSEWORK (CARPENTRY, CONCRETE FLATWORK, BLUEPRINT READING, SITE PLANS, SITE WORK, TOOLS USE, ETC.) AND OSHA 10 HOUR CERTIFICATION, TO PREPARE THEM FOR A CAREER IN THE HIGHWAY CONSTRUCTION TRADES. GRADUATES ARE WELL-TRAINED AND READY TO BECOME PRODUCTIVE ENTRY-LEVEL CONSTRUCTION WORKERS. CONTACT THE DISTRICT 8 EEO OFFICE AT 618-346-3360 AND/OR THE HCCTP COORDINATOR AT 618-874-6528 TO LEARN MORE ABOUT THE PROGRAM AND FOR ASSISTANCE IN MEETING WORKFORCE AND TRAINEE GOALS.

3 NO OVERNIGHT LANE CLOSURES WILL BE PERMITTED.

COMMITMENTS
NONE

MIX CHART

MIXTURE USE	PATCHING	PARTIAL DEPTH PATCHING
AC/PG	PG 64-22	PG 64-22
RAP % (MAX)	SEE SPECIAL PROVISION	SEE SPECIAL PROVISION
DESIGN AIR VOIDS	4.0% @Ndes=70	4.0%@Ndes=70
MIX COMPOSITION (GRADATION)	IL 19.0	IL 9.5
FRICTION AGG	MIXTURE "B"	MIXTURE "D"
QUALITY MGMT PROGRAM	QC/QA	QC/QA

ADT

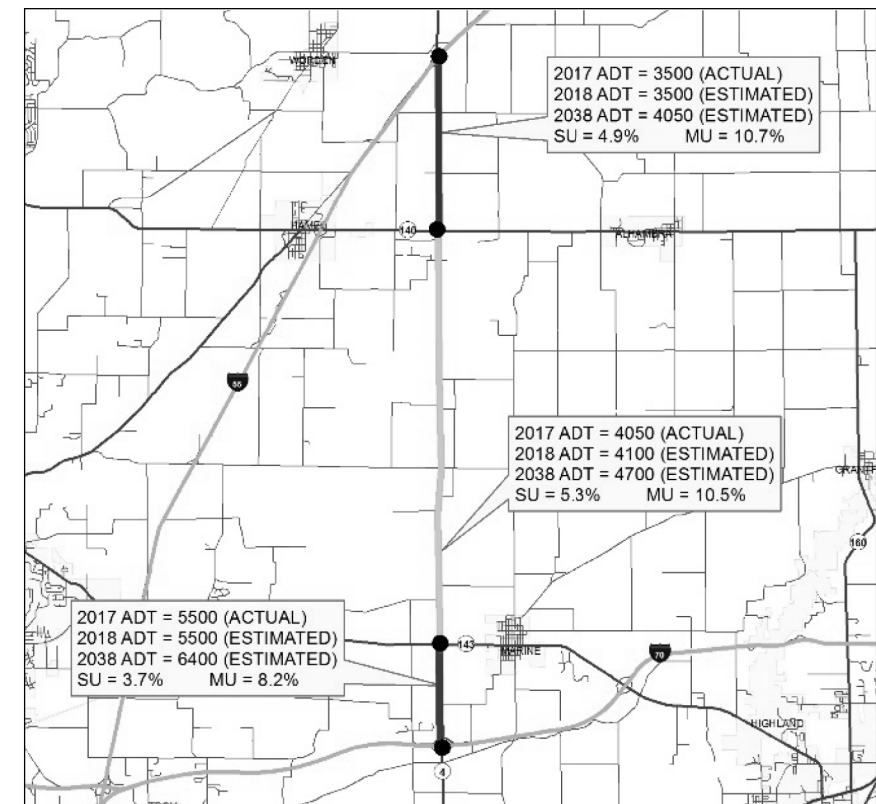

MODEL: Default
 FILE: \\nas0101\pub\illinois\dot\Documents\DOT_Offices\District 8\Projects\0876L59\CADD\data\CAD\sheet\0876L59-2-FH-gencor.dgn

USER NAME = challandeske	DESIGNED -	REVISED -
	DRAWN -	REVISED -
PLOT SCALE = 100,0000' / in.	CHECKED -	REVISED -
PLOT DATE = 3/12/2018	DATE -	REVISED -

STATE OF ILLINOIS
DEPARTMENT OF TRANSPORTATION

INDEX OF SHEETS, HIGHWAY STANDARDS
GENERAL NOTES, AND COMMITMENTS

SCALE: SHEET OF SHEETS STA. TO STA.

F.A.P. RTE.	SECTION	COUNTY	TOTAL SHEETS	SHEET NO.
314	(520,108,109,110)PP-1	MADISON	7	2
			CONTRACT NO. 76L59	
		ILLINOIS	FED. AID PROJECT	

CODE NO.	ITEM	UNIT	TOTAL QUANTITY	100% STATE
				CONSTR. CODE
				ROADWAY
				0006
				RURAL
44201789	CLASS D PATCHES, TYPE II, 12 INCH	SQ YD	207	207
44201794	CLASS D PATCHES, TYPE III, 12 INCH	SQ YD	116	116
44201796	CLASS D PATCHES, TYPE IV, 12 INCH	SQ YD	125	125
67100100	MOBILIZATION	L SUM	1	1
70100450	TRAFFIC CONTROL AND PROTECTION, STANDARD 701201	L SUM	1	1
70100600	TRAFFIC CONTROL AND PROTECTION, STANDARD 701336	L SUM	1	1
* 78000200	THERMOPLASTIC PAVEMENT MARKING - LINE 4"	FOOT	3881	3881
* 78100100	RAISED REFLECTIVE PAVEMENT MARKER	EACH	103	103
78300200	RAISED REFLECTIVE PAVEMENT MARKER REMOVAL	EACH	76	76
X4406030	PARTIAL DEPTH REMOVAL, TYPE I, 3"	SQ YD	184	184
X4406230	PARTIAL DEPTH REMOVAL, TYPE II, 3"	SQ YD	753	753
X4406430	PARTIAL DEPTH REMOVAL, TYPE III, 3"	SQ YD	302	302
X4406630	PARTIAL DEPTH REMOVAL, TYPE IV, 3"	SQ YD	871	871
X4421000	PARTIAL DEPTH PATCHING	TON	354.5	354.5

* SPECIALTY ITEM

MODEL: D:\MVA\... FILE NAME: P:\VILLAGEBID\STATEG... ILLINOIS\DOT CH\KCA\DISRCT... \Projects\087\559\CAD\KCA\Drawings\B37\6L59-SHS-500.dgn

USER NAME = challoandeske	DESIGNED -	REVISED -
PLOT SCALE = 100.0000' / in.	DRAWN -	REVISED -
PLOT DATE = 3/16/2018	CHECKED -	REVISED -
	DATE -	REVISED -

**STATE OF ILLINOIS
DEPARTMENT OF TRANSPORTATION**

SUMMARY OF QUANTITIES				
SCALE:	SHEET	OF	SHEETS	STA. TO STA.

F.A.P. RTE.	SECTION	COUNTY	TOTAL SHEETS	SHEET NO.
314	(520.108.109.110)PP-1	MADISON	7	3
ILLINOIS FED. AID PROJECT			CONTRACT NO. 76L59	

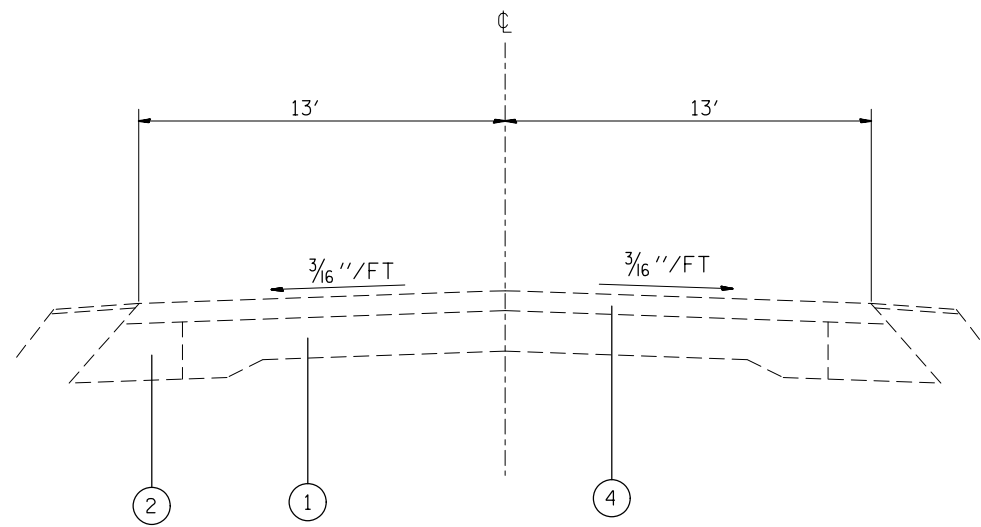

EXISTING TYPICAL SECTION

MILE 7.30 TO MILE 9.10
 MILE 9.21 TO MILE 9.46
 MILE 9.83 TO MILE 16.14
 MILE 16.32 TO MILE 18.80

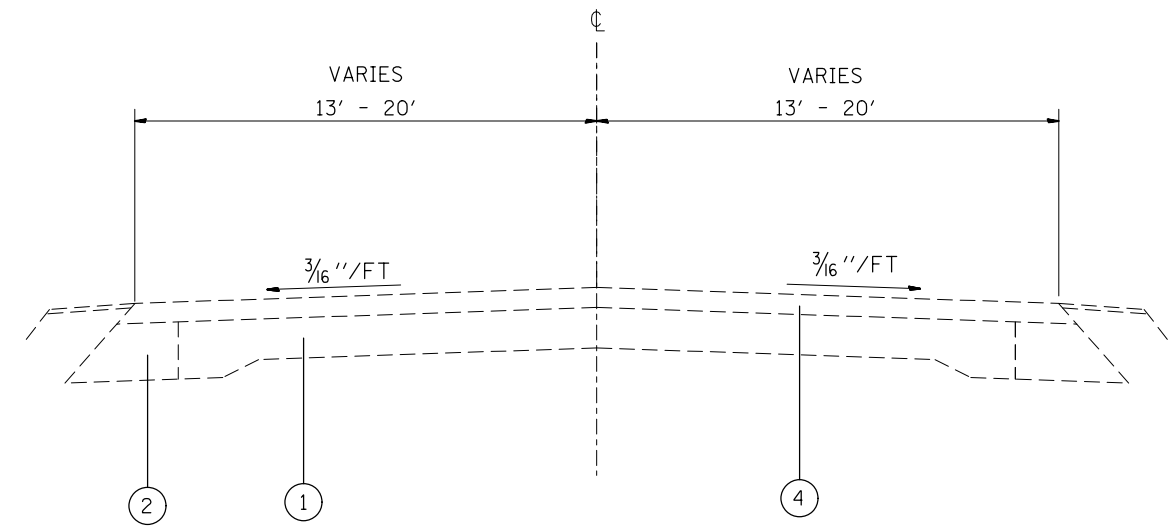

EXISTING TYPICAL SECTION

MILE 9.10 TO MILE 9.21
 MILE 16.14 TO MILE 16.32

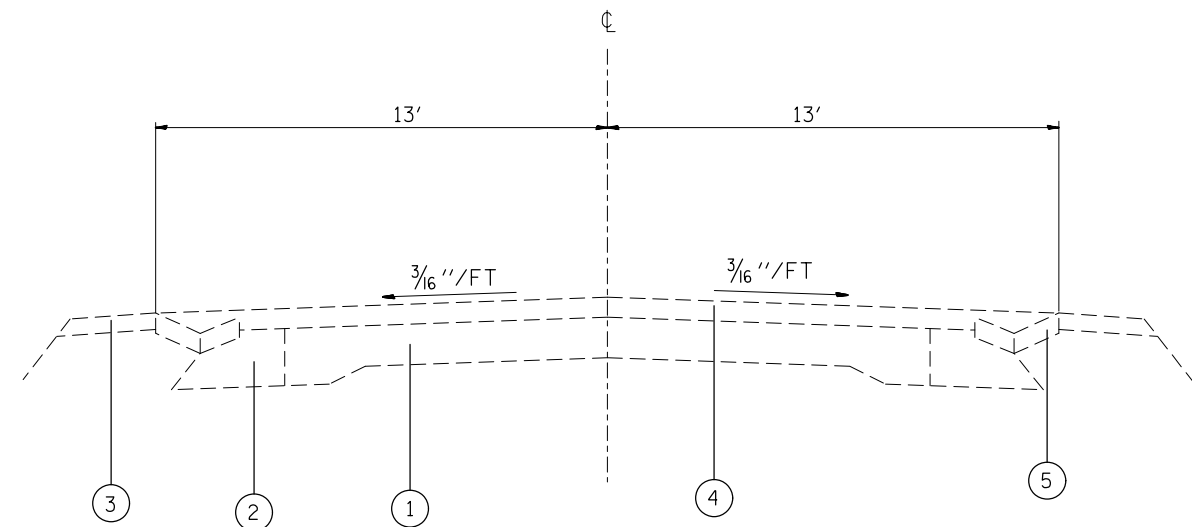

EXISTING TYPICAL SECTION

MILE 9.46 TO MILE 9.83

LEGEND

- ① EXISTING PCC PAVEMENT, 9-6-9
- ② EXISTING HOT-MIX ASPHALT BASE COURSE WIDENING, 9"
- ③ EXISTING SHOULDER
- ④ EXISTING HOT-MIX ASPHALT RESURFACING, 3/4" AND VARIES
- ⑤ EXISTING CONCRETE GUTTER, TYPE B

MODEL: Default
 FILE: \\nashville\pub\ill08\BID\NTEC\Illinois\gov\PI\DOT\Documents\DOT - Offices\Director\B\Projects\0876159\CAD\data\CAD\sheet\0876159-9-11-18.dgn

USER NAME = challandeske	DESIGNED -	REVISED -
	DRAWN -	REVISED -
PLOT SCALE = 100.0000' / in.	CHECKED -	REVISED -
PLOT DATE = 3/12/2018	DATE -	REVISED -

STATE OF ILLINOIS
 DEPARTMENT OF TRANSPORTATION

TYPICAL SECTION	
SCALE:	SHEET OF SHEETS STA. TO STA.

F.A.P. RTE.	SECTION	COUNTY	TOTAL SHEETS	SHEET NO.
314	(520,108,109,110)PP-1	MADISON	7	4
CONTRACT NO. 76L59			ILLINOIS FED. AID PROJECT	

FULL DEPTH PATCHING						
MILE POINT	DIRECTION	LENGTH	WIDTH	CLASS D PATCHES,	CLASS D PATCHES,	CLASS D PATCHES,
				TYPE II, 12"	TYPE III, 12"	TYPE IV, 12"
				SQ YD	SQ YD	SQ YD
7.30	NB	8	12	11		
9.35	NB	7	13	11		
9.40	NB	7	7	6		
9.45	NB	7	7	6		
10.65	NB	8	13	12		
10.65	SB	10	13		15	
11.28	NB	10	13		15	
11.28	SB	10	13		15	
11.50	NB	4	13	6		
13.59	NB	8	13	12		
13.59	SB	8	13	12		
13.60	SB	15	13		22	
13.88	NB	9	13	13		
14.05	SB	8	13	12		
14.08	SB	13	13		19	
14.10	SB	8	7	7		
15.20	SB	30	12			40
15.33	SB	13	13		19	
15.45	NB	25	13			37
15.45	SB	25	13			37
16.50	NB	8	13	12		
17.30	NB	10	7	8		
17.75	NB	8	13	12		
17.75	SB	8	13	12		
17.90	NB	8	13	12		
17.90	SB	8	13	12		
18.15	SB	8	13	12		
				188	105	114
10% FOR ANTICIPATED FAILURES				19	11	11
				207	116	125

PAVEMENT MARKING - FOR FULL DEPTH PATCHES						
MILE POINT	DIRECTION	LENGTH	WIDTH	THERMOPLASTIC		
				PAVEMENT MARKING-LINE 4"		RAISED REFLECTIVE
				YELLOW	WHITE	PAVEMENT MARKER
				FOOT	FOOT	EACH
7.30	NB	8	12	9	8	1
9.35	NB	7	13	8	7	1
9.40	NB	7	7	8	7	1
9.45	NB	7	7	8	7	1
10.65	NB	8	13	9	8	1
10.65	SB	10	13	11	10	1
11.28	NB	10	13	11	10	1
11.28	SB	10	13	11	10	1
11.50	NB	4	13	4	4	1
13.59	NB	8	13	9	8	1
13.59	SB	8	13	9	8	1
13.60	SB	15	13	16	15	1
13.88	NB	9	13	10	9	1
14.05	SB	8	13	9	8	1
14.08	SB	13	13	14	13	1
14.10	SB	8	7	9	8	1
15.20	SB	30	12	33	30	1
15.33	SB	13	13	14	13	1
15.45	NB	25	13	27	25	1
15.45	SB	25	13	27	25	1
16.50	NB	8	13	9	8	1
17.30	NB	10	7	11	10	1
17.75	NB	8	13	9	8	1
17.75	SB	8	13	9	8	1
17.90	NB	8	13	9	8	1
17.90	SB	8	13	9	8	1
18.15	SB	8	13	9	8	1
SUBTOTAL				317	291	
TOTAL				608		27

MODEL: Default
 FILE: \\mhc-pw\illinois\dot\Documents\DOT_Offices\Director\Projects\0876159\CAD\data\CAD\sheet\0876159-1-1-1.dgn

USER NAME = challeske	DESIGNED -	REVISED -
	DRAWN -	REVISED -
PLOT SCALE = 100,0000' / in.	CHECKED -	REVISED -
PLOT DATE = 3/16/2018	DATE -	REVISED -

STATE OF ILLINOIS
DEPARTMENT OF TRANSPORTATION

SCHEDULES			
SCALE:	SHEET	OF	SHEETS
	STA.	TO	STA.

F.A.P. RTE.	SECTION	COUNTY	TOTAL SHEETS	SHEET NO.
314	(520,108,109,110)PP-1	MADISON	7	5
			CONTRACT NO. 76L59	
		ILLINOIS	FED. AID PROJECT	

PARTIAL DEPTH PATCHING								
				PARTIAL DEPTH	PARTIAL DEPTH	PARTIAL DEPTH	PARTIAL DEPTH	PARTIAL DEPTH
				REMOVAL	REMOVAL	REMOVAL	REMOVAL	PATCHING
				TYPE I, 3"	TYPE II, 3"	TYPE III, 3"	TYPE IV, 3"	
M.P.	NB/SB	LENGTH	WIDTH	SQ YD	SQ YD	SQ YD	SQ YD	TON
7.50	NB	4	12	5.3				0.9
7.60	NB	4	12	5.3				0.9
8.10	NB	4	13	5.8				1.0
9.10	NB	4	4	1.8				0.3
9.10	NB	15	16		26.7			4.5
9.20	NB	25	14		38.9			6.5
9.30	NB	13	13		18.8			3.2
9.80	NB	4	13	5.8				1.0
9.85	NB	4	13	5.8				1.0
9.90	NB	4	13	5.8				1.0
10.00	NB	4	13	5.8				1.0
10.02	NB	13	13		18.8			3.2
10.06	NB	4	13	5.8				1.0
10.60	NB	50	13			72.2		12.1
10.67	NB	90	13				130.0	21.8
11.10	NB	13	13		18.8			3.2
11.60	NB	4	13	5.8				1.0
11.70	NB	4	13	5.8				1.0
13.80	NB	4	13	5.8				1.0
14.58	NB	25	13		36.1			6.1
14.60	NB	15	7		11.7			2.0
15.00	NB	6	13		8.7			1.5
15.00	NB	175	7				136.1	22.9
15.10	NB	4	13	5.8				1.0
15.20	NB	70	13				101.1	17.0
15.20	NB	4	13	5.8				1.0
15.50	NB	40	13			57.8		9.7
15.90	NB	30	13		43.3			7.3
17.70	NB	70	13				101.1	17.0
17.73	NB	60	13			86.7		14.6
18.10	NB	40	13			57.8		9.7

CONT .

PARTIAL DEPTH PATCHING								
				PARTIAL DEPTH	PARTIAL DEPTH	PARTIAL DEPTH	PARTIAL DEPTH	PARTIAL DEPTH
				REMOVAL	REMOVAL	REMOVAL	REMOVAL	PATCHING
				TYPE I, 3"	TYPE II, 3"	TYPE III, 3"	TYPE IV, 3"	
M.P.	NB/SB	LENGTH	WIDTH	SQ YD	SQ YD	SQ YD	SQ YD	TON
7.50	SB	4	12	5.3				0.9
7.60	SB	4	12	5.3				0.9
7.70	SB	20	13		28.9			4.9
9.10	SB	15	16		26.7			4.5
9.30	SB	13	13		18.8			3.2
9.80	SB	4	13	5.8				1.0
9.85	SB	70	6		46.7			7.8
9.90	SB	4	13	5.8				1.0
10.00	SB	4	13	5.8				1.0
10.02	SB	13	13		18.8			3.2
10.06	SB	4	13	5.8				1.0
10.20	SB	6	13		8.7			1.5
10.80	SB	4	13	5.8				1.0
11.10	SB	13	13		18.8			3.2
11.16	SB	4	13	5.8				1.0
11.40	SB	4	13	5.8				1.0
11.60	SB	4	13	5.8				1.0
11.70	SB	4	13	5.8				1.0
11.90	SB	30	13		43.3			7.3
12.90	SB	25	7		19.4			3.3
13.40	SB	13	13		18.8			3.2
13.45	SB	15	13		21.7			3.6
13.50	SB	8	13		11.6			1.9
13.80	SB	4	13	5.8				1.0
14.00	SB	13	13		18.8			3.2
14.12	SB	15	7		11.7			2.0
14.15	SB	7	7	5.4				0.9
14.58	SB	25	13		36.1			6.1
14.60	SB	15	7		11.7			2.0
14.62	SB	15	7		11.7			2.0
15.00	SB	175	7				136.1	22.9
15.10	SB	4	13	5.8				1.0
15.30	SB	4	13	5.8				1.0
15.50	SB	4	13	5.8				1.0
15.90	SB	10	13		14.4			2.4
16.50	SB	20	13		28.9			4.9
18.10	SB	130	13				187.8	31.5
18.30	SB	25	13		36.1			6.1
18.40	SB	8	13		11.6			1.9
				167	685	274	792	322.3
10% FOR ANTICIPATED FAILURES				17	68	27	79	32
TOTAL				184	753	302	871	354.5

MODEL: Default
FILE: \\p04u08a8e01dntec\illinois\gov\pwwdot\documents\1d01\offices\diarct 8\projects\0876159\CADD\data\CAD\hasset\0876159\pt-fschecul.dgn

USER NAME = challandeske	DESIGNED -	REVISED -
	DRAWN -	REVISED -
PLOT SCALE = 100,0000 ' / in.	CHECKED -	REVISED -
PLOT DATE = 3/16/2018	DATE -	REVISED -

**STATE OF ILLINOIS
DEPARTMENT OF TRANSPORTATION**

SCHEDULES

SCALE: SHEET OF SHEETS STA. TO STA.

F.A.P. RTE.	SECTION	COUNTY	TOTAL SHEETS	SHEET NO.
314	(520,108,109,110)PP-1	MADISON	7	6
ILLINOIS FED. AID PROJECT			CONTRACT NO. 76L59	

PAVEMENT MARKING - FOR PARTIAL DEPTH PATCHES

MILE POINT	DIRECTION	LENGTH	WIDTH	THERMOPLASTIC		RAISED REFLECTIVE	
				PAVEMENT MARKING - LINE 4"		RAISED REFLECTIVE	PAVEMENT MARKER
				YELLOW	WHITE	PAVEMENT MARKER	REMOVAL
				FOOT	FOOT	EACH	EACH
7.50	NB	4	12	4	4	1	1
7.60	NB	4	12	4	4	1	1
8.10	NB	4	13	4	4	1	1
9.10	NB	4	4	4	4	1	1
9.10	NB	15	16	16	15	1	1
9.20	NB	25	14	27	25	1	1
9.30	NB	13	13	14	13	1	1
9.80	NB	4	13	4	4	1	1
9.85	NB	4	13	4	4	1	1
9.90	NB	4	13	4	4	1	1
10.00	NB	4	13	4	4	1	1
10.02	NB	13	13	14	13	1	1
10.06	NB	4	13	4	4	1	1
10.60	NB	50	13	55	50	1	1
10.67	NB	90	13	98	90	2	2
11.10	NB	13	13	14	13	1	1
11.60	NB	4	13	4	4	1	1
11.70	NB	4	13	4	4	1	1
13.80	NB	4	13	4	4	1	1
14.58	NB	25	13	27	25	1	1
14.60	NB	15	7	16	15	1	1
15.00	NB	6	13	7	6	1	1
15.00	NB	175	7	191	175	3	3
15.10	NB	4	13	4	4	1	1
15.20	NB	70	13	76	70	1	1
15.20	NB	4	13	4	4	1	1
15.50	NB	40	13	44	40	1	1
15.90	NB	30	13	33	30	1	1
17.70	NB	70	13	76	70	1	1
17.73	NB	60	13	65	60	1	1
18.10	NB	40	13	44	40	1	1

CONT .

PAVEMENT MARKING - FOR PARTIAL DEPTH PATCHES

MILE POINT	DIRECTION	LENGTH	WIDTH	THERMOPLASTIC		RAISED REFLECTIVE	
				PAVEMENT MARKING - LINE 4"		RAISED REFLECTIVE	PAVEMENT MARKER
				YELLOW	WHITE	PAVEMENT MARKER	REMOVAL
				FOOT	FOOT	EACH	EACH
7.50	SB	4	12	4	4	1	1
7.60	SB	4	12	4	4	1	1
7.70	SB	20	13	22	20	1	1
9.10	SB	15	16	16	15	1	1
9.30	SB	13	13	14	13	1	1
9.80	SB	4	13	4	4	1	1
9.85	SB	70	6	76	70	1	1
9.90	SB	4	13	4	4	1	1
10.00	SB	4	13	4	4	1	1
10.02	SB	13	13	14	13	1	1
10.06	SB	4	13	4	4	1	1
10.20	SB	6	13	7	6	1	1
10.80	SB	4	13	4	4	1	1
11.10	SB	13	13	14	13	1	1
11.16	SB	4	13	4	4	1	1
11.40	SB	4	13	4	4	1	1
11.60	SB	4	13	4	4	1	1
11.70	SB	4	13	4	4	1	1
11.90	SB	30	13	33	30	1	1
12.90	SB	25	7	27	25	1	1
13.40	SB	13	13	14	13	1	1
13.45	SB	15	13	16	15	1	1
13.50	SB	8	13	9	8	1	1
13.80	SB	4	13	4	4	1	1
14.00	SB	13	13	14	13	1	1
14.12	SB	15	7	16	15	1	1
14.15	SB	7	7	8	7	1	1
14.58	SB	25	13	27	25	1	1
14.60	SB	15	7	16	15	1	1
14.62	SB	15	7	16	15	1	1
15.00	SB	175	7	191	175	3	3
15.10	SB	4	13	4	4	1	1
15.30	SB	4	13	4	4	1	1
15.50	SB	4	13	4	4	1	1
15.90	SB	10	13	11	10	1	1
16.50	SB	20	13	22	20	1	1
18.10	SB	130	13	142	130	2	2
18.30	SB	25	13	27	25	1	1
18.40	SB	8	13	9	8	1	1
SUBTOTAL				1707	1565		
TOTAL				3273		76	76

MODEL: Default
 FILE: \\u08a8e8d101ec.illinois.gov\pww\DOT\Documents\DOT - Offices\Director - Projects\0876L59\CAD\data\CAD\sheet\0876L59.rpt-schedule.dgn

USER NAME = challandeske	DESIGNED -	REVISED -
	DRAWN -	REVISED -
PLOT SCALE = 100.0000 ' / in.	CHECKED -	REVISED -
PLOT DATE = 3/16/2018	DATE -	REVISED -

**STATE OF ILLINOIS
DEPARTMENT OF TRANSPORTATION**

SCHEDULES			
SCALE:	SHEET	OF	SHEETS
	STA.	TO	STA.

F.A.P. RTE.	SECTION	COUNTY	TOTAL SHEETS	SHEET NO.
314	(520,108,109,110)PP-1	MADISON	7	7
			CONTRACT NO. 76L59	
		ILLINOIS	FED. AID PROJECT	