

06-15-2018 LETTING ITEM 026

STATE OF ILLINOIS  
DEPARTMENT OF TRANSPORTATION

F.A.P. R.T.E.	SECTION	COUNTY	TOTAL SHEETS	SHEET NO.
852	18-CLV	WILL	8	1
		ILLINOIS	CONTRACT NO. 62G24	

D-91-268-18

FOR INDEX OF SHEETS, SEE SHEET NO. 2

# PROPOSED HIGHWAY PLANS

FAP ROUTE 852 - US 52 (CEDAR RD.)  
AT DITCH 2.9 MI S. OF HOFF RD. (SN 099 - 0922)

SECTION 18 - CLV  
CULVERT REPAIR

PROJECT: NHPP-EGGN(309)  
WILTON TOWNSHIP

C-91-165-18

T 33 N

**TRAFFIC DATA**

EXISTING ADT = 4150  
POSTED SPEED LIMIT = 35 - 55 MPH

PROJECT IS LOCATED  
IN WILTON TOWNSHIP

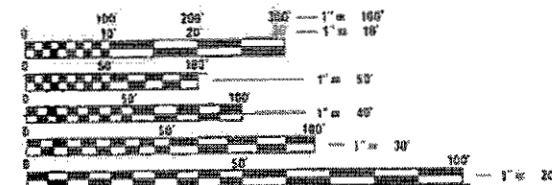
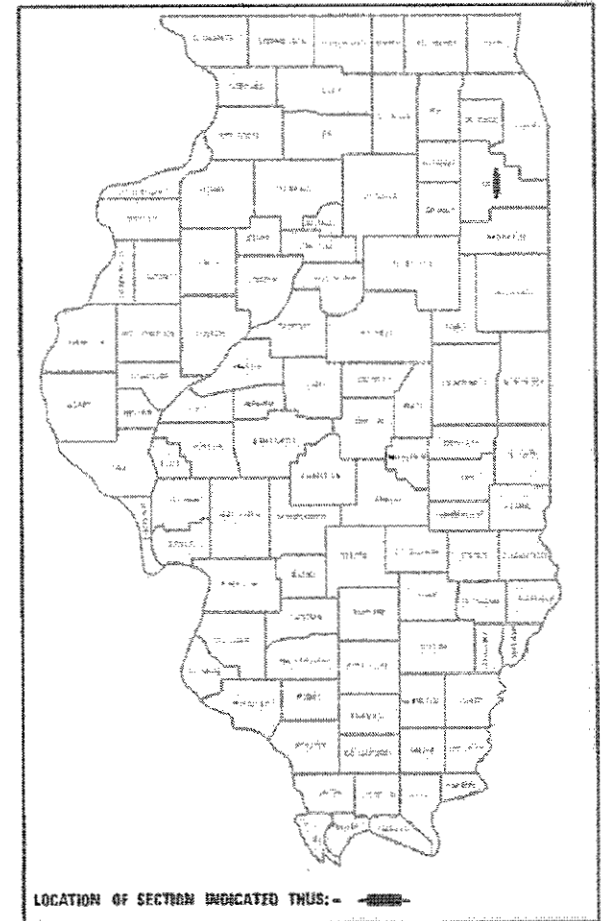

FULL SIZE PLANS HAVE BEEN PREPARED USING STANDARD ENGINEERING SCALES. REDUCED SIZED PLANS WILL NOT CONFORM TO STANDARD SCALES. IN MAKING MEASUREMENTS ON REDUCED PLANS, THE ABOVE SCALES MAY BE USED.

J.U.L.I.E.  
JOINT UTILITY LOCATION INFORMATION FOR EXCAVATION  
1-800-892-0123  
OR 811

PROJECT LOCATION  
SN 099-0922



WILTON TOWNSHIP

GROSS LENGTH = 31.9 FT. = 0.006 MILE

NET LENGTH = 31.9 FT. = 0.006 MILE

PROJECT ENGINEER: J. ALAIN MIDY (847) 221-3056  
PROJECT MANAGER: FAWAD AQUEEL (847) 705-4247

CONTRACT NO. 62G24

STATE OF ILLINOIS  
DEPARTMENT OF TRANSPORTATION

SUBMITTED March 13, 2018

Anthony J. Dwyer REGIONAL ENGINEER

May 11, 2018

ENGINEER-OF-DESIGN AND SUPERVISOR

Paul P. Chaf

DIRECTOR OF HIGHWAYS PROJECT IMPLEMENTATION

PRINTED BY THE AUTHORITY  
OF THE STATE OF ILLINOIS

**INDEX OF SHEETS**

<b>SHEET NO.</b>	<b>DESCRIPTION</b>
1.	TITLE SHEET
2.	INDEX OF SHEETS, STATE STANDARDS, AND GENERAL NOTES
3.	SUMMARY OF QUANTITIES
4	DETOUR PLAN
5-6	SLAB DETAILS (SN 099-0922)
7	DETOUR SIGNING FOR CLOSING STATE HIGHWAYS (TC-21)
8	ARTERIAL ROAD INFORMATION SIGN

**STATE STANDARDS**

701006-05	OFF-RD OPERATIONS, 2L, 2W, 15'(4.5M) TO 24" (600MM) FROM PAVEMENT EDGE
701011-04	OFF-RD MOVING OPERATIONS, 2L, 2W, DAY ONLY
701301-04	LANE CLOSURE, 2L, 2W, SHORT TIME OPERATIONS
701311-03	LANE CLOSURE 2L, 2W, MOVING OPERATIONS DAY ONLY
701901-07	TRAFFIC CONTROL DEVICES

**GENERAL NOTES**

- BEFORE STARTING ANY EXCAVATION, THE CONTRACTOR SHALL CALL "J.U.L.I.E." AT (800)892-0123 OR 811 FOR FIELD LOCATIONS OF BURIED ELECTRIC, TELEPHONE AND GAS UTILITIES. (48 HOUR NOTIFICATION IS REQUIRED).
- THE CONTRACTOR SHALL COORDINATE CONSTRUCTION ACTIVITIES WITH UTILITY COMPANIES, AND THE WILTON TOWNSHIP.
- THE CONTRACTOR WILL NOT BE ALLOWED TO SET UP A YARD OR FIELD OFFICE ON STATE PROPERTY WITHOUT WRITTEN PERMISSION FROM THE DEPARTMENT.
- IT SHALL BE THE CONTRACTOR'S RESPONSIBILITY TO VERIFY ALL DIMENSIONS AND CONDITIONS EXISTING IN THE FIELD PRIOR TO CONSTRUCTION AND ORDERING OF MATERIALS.
- THE CONTRACTOR SHALL CONTACT THE DISTRICT ONE TRAFFIC CONTROL SUPERVISOR AT (847)705-4470 A MINIMUM OF 72 HOURS IN ADVANCE OF BEGINNING WORK.
- THE CONTRACTOR SHALL BE REQUIRED TO PROVIDE ACCESS TO ABUTTING PROPERTY AT ALL TIMES DURING THE CONSTRUCTION OF THIS PROJECT.
- THE CONTRACTOR SHALL BE RESPONSIBLE FOR THE NOTIFICATION OF ALL EMERGENCY SERVICES, SCHOOL DISTRICTS, I.D.O.T.'S COMMUNICATIONS CENTER, SPRINGFIELD TRUCK PERMIT SECTION AND OTHER AGENCIES AFFECTED BY THE CLOSURE. THE CONTRACTOR SHALL ALSO BE RESPONSIBLE FOR POSTING SIGNS THAT WILL INDICATE THE DATES THE CLOSURE WILL BE IN PLACE.
- DO NOT SCALE PLANS FOR CONSTRUCTION DIMENSIONS.

USER NAME =	DESIGNED -	REVISED -	<b>STATE OF ILLINOIS DEPARTMENT OF TRANSPORTATION</b>	<b>US 52 OVER DITCH 2.9 MIS OF HOFF RD TRAFFIC DETOUR FOR STAGE 2</b>	F.A.P. RTE.	SECTION	COUNTY	TOTAL SHEETS	SHEET NO.	
	DRAWN -	REVISED -			852	18-CLV	WILL	8	2	
PLOT SCALE =	CHECKED -	REVISED -			<b>CONTRACT NO. 62G24</b>					
PLOT DATE =	DATE - 03/13/2018	REVISED -			SCALE:	SHEET NO.	OF	SHEETS	STA.	TO
ILLINOIS FED. AID PROJECT										



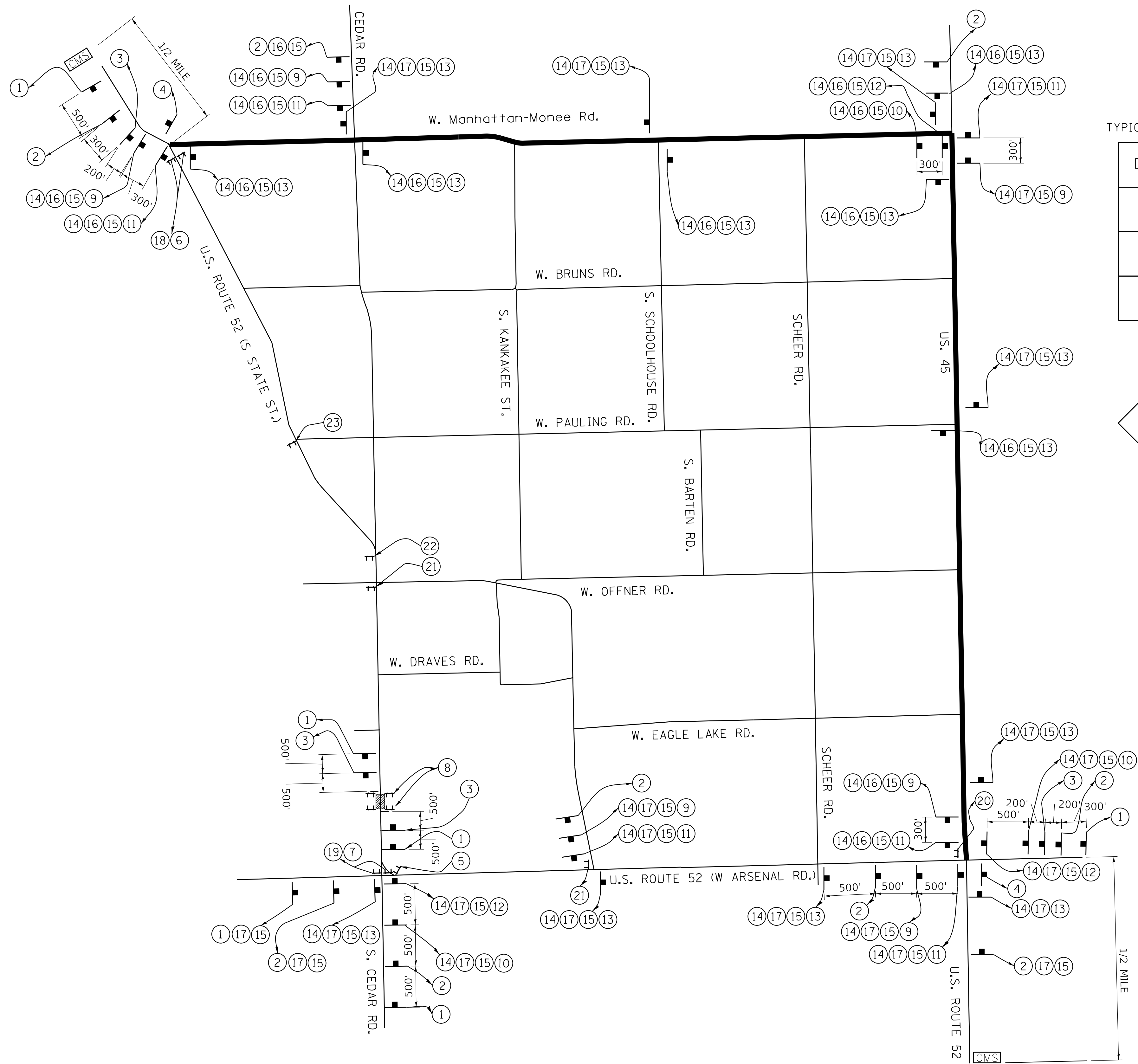

TYPICAL ASSEMBLY:

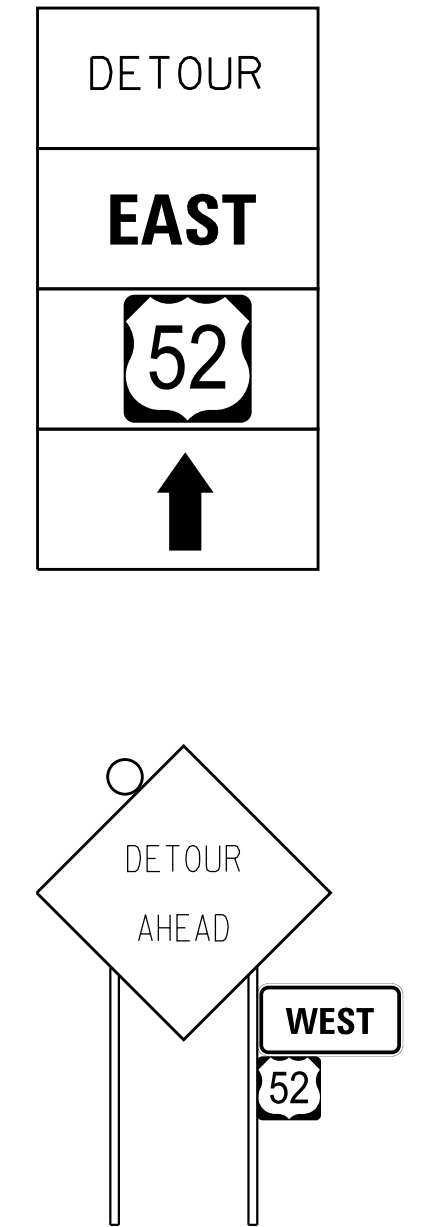

- 1 ROAD CLOSED AHEAD  
W20-310-48  
W/TYPE 2 FLASHING LIGHT
- 2 DETOUR AHEAD  
W20-210-48  
W/TYPE 2 FLASHING LIGHT
- 3 ROAD CLOSED 500 FT  
W20-310-48  
W/TYPE 2 FLASHING LIGHT
- 4 END DETOUR  
M4-8a 2418
- \* 5 ROAD CLOSED TO THRU TRAFFIC  
R11-4 6030
- \* 6 DETOUR (Left Arrow)  
M4-1L(O) 4818
- \* 7 DETOUR (Right Arrow)  
M4-1R(O) 4818
- \* 8 ROAD CLOSED  
R11-2B 4830
- 9 M5-1L(O) 2115
- 10 M5-1R(O) 2115
- 11 M6-1(O) 2115
- 12 M6-1(O) 2115
- 13 M6-3(O) 2115
- 14 DETOUR M4-8-2912
- 15 52 M1-40-2424
- 16 EAST M3-2-2412
- 17 WEST M3-4-2412
- 18 ROAD CLOSED 5 MILES AHEAD LOCAL TRAFFIC ONLY  
R11-3a-6030
- 19 ROAD CLOSED 1/2 MILES AHEAD LOCAL TRAFFIC ONLY  
R11-3a-6030
- 20 ROAD CLOSED 4.2 MILES AHEAD LOCAL TRAFFIC ONLY  
R11-3a-6030
- 21 ROAD CLOSED 1.7 MILES AHEAD LOCAL TRAFFIC ONLY  
R11-3a-6030
- 22 ROAD CLOSED 2 MILES AHEAD LOCAL TRAFFIC ONLY  
R11-3a-6030
- 23 ROAD CLOSED 3.1 MILES AHEAD LOCAL TRAFFIC ONLY  
R11-3a-6030

\* MOUNTED ABOVE TYPE III BARRICADES  
IF A TYPE III BARRICADE WITH AN ATTACHED SIGN PANEL WHICH MEETS NCHRP 350 REQUIREMENTS IS NOT AVAILABLE, THE SIGNS SHALL BE MOUNTED ABOVE THE BARRICADES ON SEPARATE SIGN SUPPORTS THAT MEET NCHRP 350 REQUIREMENTS.

- CMS
- MSG 1 US 52 CLOSED AHEAD
- MSG 2 FOLLOW DETOUR
- LEGEND
- WORK ZONE
  - SIGN PANEL
  - TYPE III BARRICADE WITH STEADY BURN LIGHTS EACH (2 OR MORE)

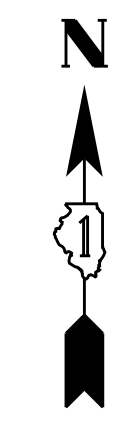

USER NAME =	DESIGNED -	REVISED -
	DRAWN -	REVISED -
PLOT SCALE =	CHECKED -	REVISED -
PLOT DATE	DATE - 03/13/2018	REVISED -

STATE OF ILLINOIS  
DEPARTMENT OF TRANSPORTATION

US 52 OVER DITCH 2.9 MI S OF HOFF RD  
TRAFFIC DETOUR FOR STAGE 2

SCALE:	SHEET NO.	OF	SHEETS	STA.	TO	STA.
--------	-----------	----	--------	------	----	------

F.A.P. RTE.	SECTION	COUNTY	TOTAL SHEETS	SHEET NO.
852	18-CLV	WILL	7	4
				CONTRACT NO. 62G24
ILLINOIS FED. AID PROJECT				

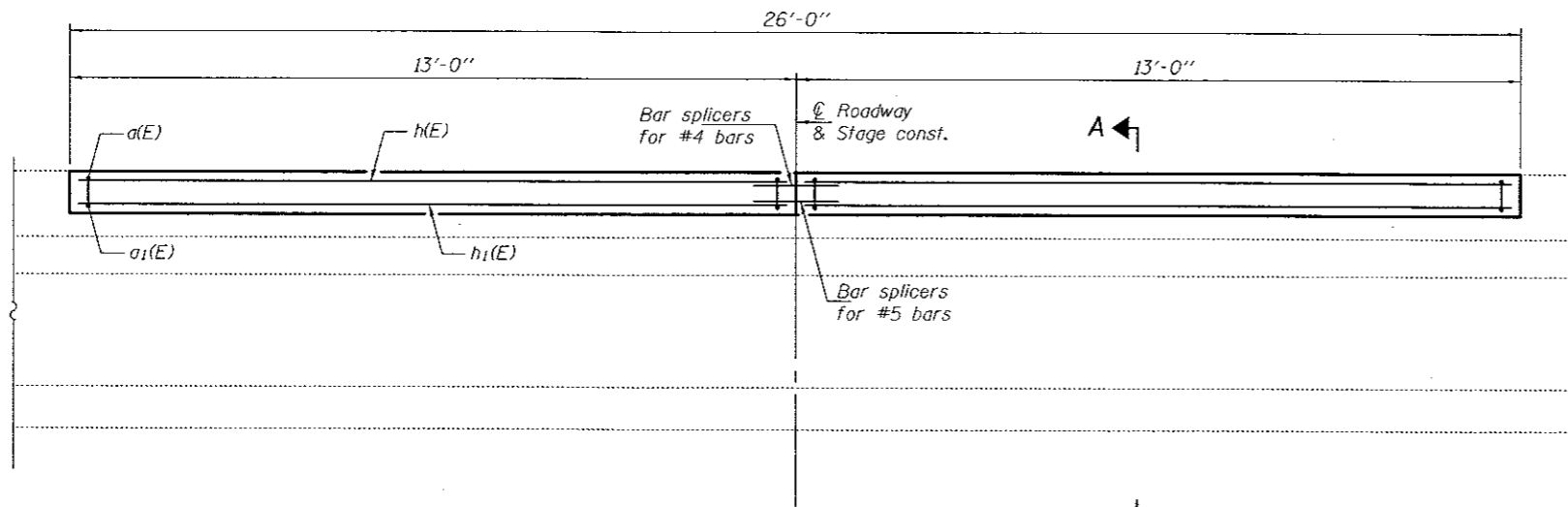

LONGITUDINAL SECTION

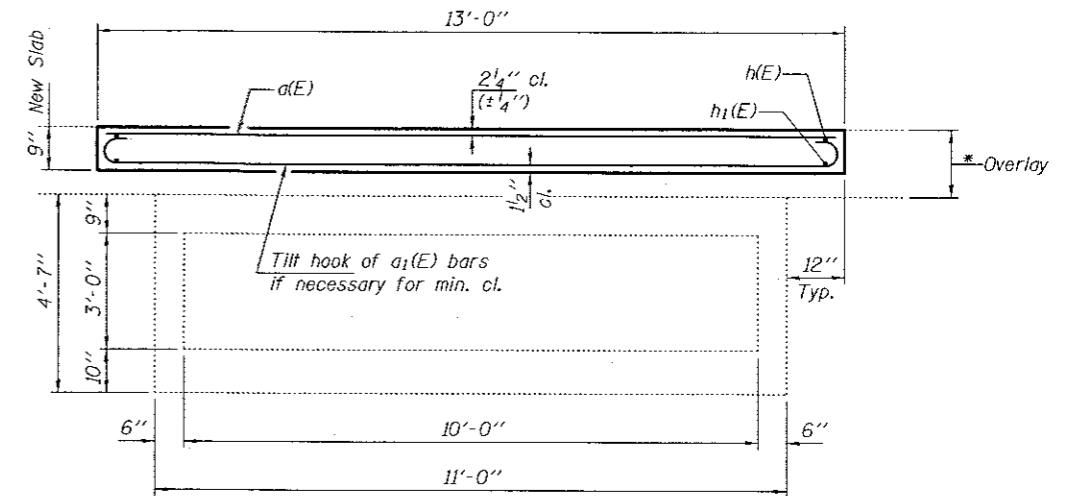

SECTION A-A

\* Remove 9" of existing HMA overlay and replace with 9" concrete slab as shown. Slope to match roadway. Cost of removal included with Hot-Mix Asphalt Surface Removal, 9".

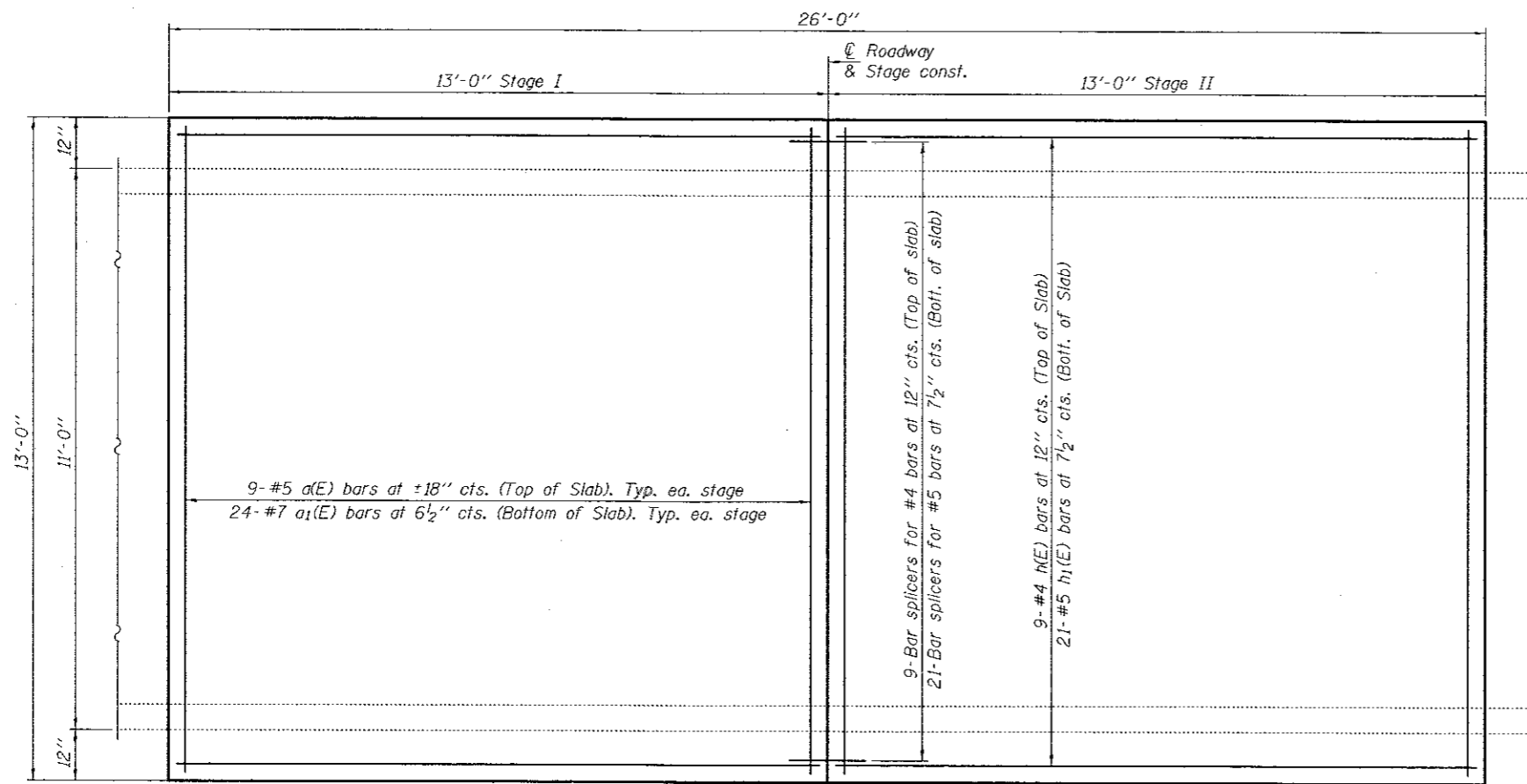

PLAN



GENERAL NOTES

Plan dimensions and details relative to existing plans are subject to nominal construction variations. The Contractor shall field verify existing dimensions and details affecting new construction and make necessary approved adjustments prior to construction or ordering of materials. Such variations shall not be cause for additional compensation for a change in scope of the work, however, the Contractor will be paid for the quantity actually furnished at the unit price bid for the work.

Reinforcement bars designated (E) shall be epoxy coated. The deck surface shall have its final finish lined according to Article 420.1(k)(1) of the Standard Specifications. Cost included with Concrete Superstructure.

BILL OF MATERIAL

Bar	No.	Size	Length	Shape	
a(E)	18	#5	12'-8"	—	
a1(E)	48	#7	14'-4"	⌋	
h(E)	18	#4	12'-8"	—	
h1(E)	42	#5	12'-8"	—	
Bar Splacers				Each	30
Hot-Mix Asphalt Surface Removal, 9"				Sq. Yds.	37.6
Reinforcement Bars, Epoxy Coated				Pound	2350
Concrete Superstructure				Cu. Yds.	9.4

DESIGN STRESSES

FIELD UNITS  
 $f'_c = 3,500$  psi  
 $f_y = 60,000$  psi (Reinf.)

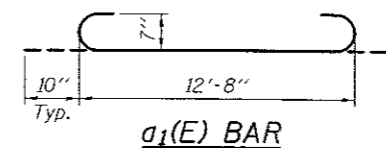

EXPIRES 11-30-2018

DESIGNED	Victor K. Vojta	EXAMINED	Tina A. DeB...	DATE	MAY 1, 2018
CHECKED	[Signature]	PASSED	[Signature]	REVISED	
DRAWN	baliva			REVISED	
CHECKED	VHF				

STATE OF ILLINOIS  
 DEPARTMENT OF TRANSPORTATION

SLAB DETAILS  
 FAP 852 (US 52)  
 SN 099-0922

SHEET NO. 1 OF 2 SHEETS

F.A.P. RTE.	SECTION	COUNTY	TOTAL SHEETS	SHEET NO.
852	18-CLV	WILL	8	5
CONTRACT NO. 62G24				

ILLINOIS FED. AID PROJECT

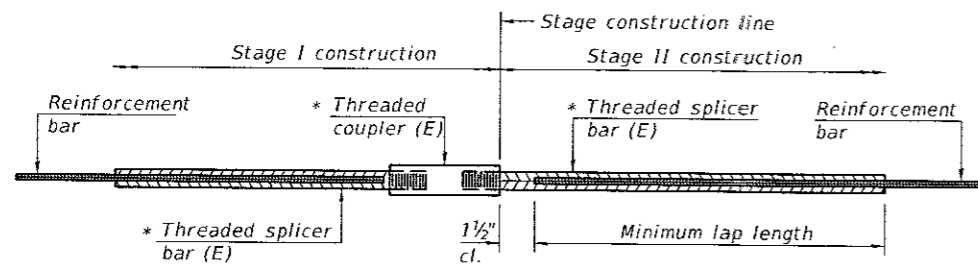

**STANDARD BAR SPLICER ASSEMBLY**

Threaded splicer bar length = min. lap length + 1 1/2" + thread length

\* Epoxy not required on Bar Splicer Assembly components used in conjunction with black bars.

Location	Bar size	No. assemblies required	Minimum lap length
Top of slab	#4	9	2'-7"
Bottom of slab	#5	21	3'-2"

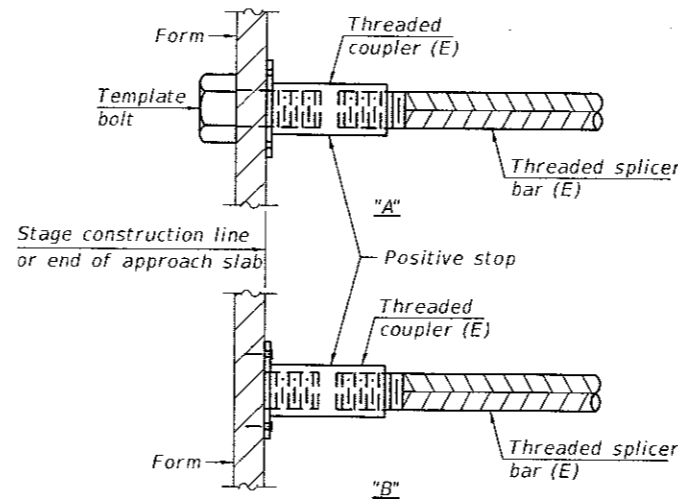

**INSTALLATION AND SETTING METHODS**

"A" : Set bar splicer assembly by means of a template bolt.

"B" : Set bar splicer assembly by nailing to wood forms or cementing to steel forms.

(E) : Indicates epoxy coating.

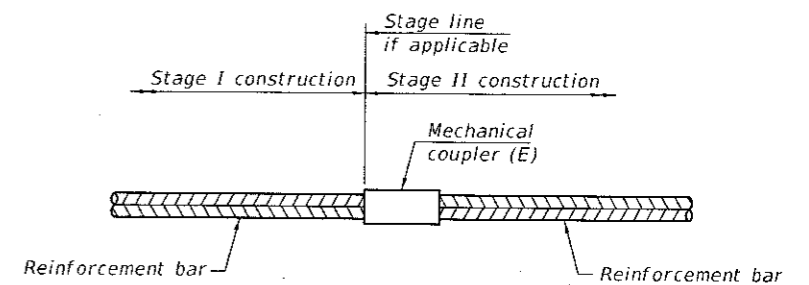

**STANDARD MECHANICAL SPLICER**

Location	Bar size	No. assemblies required

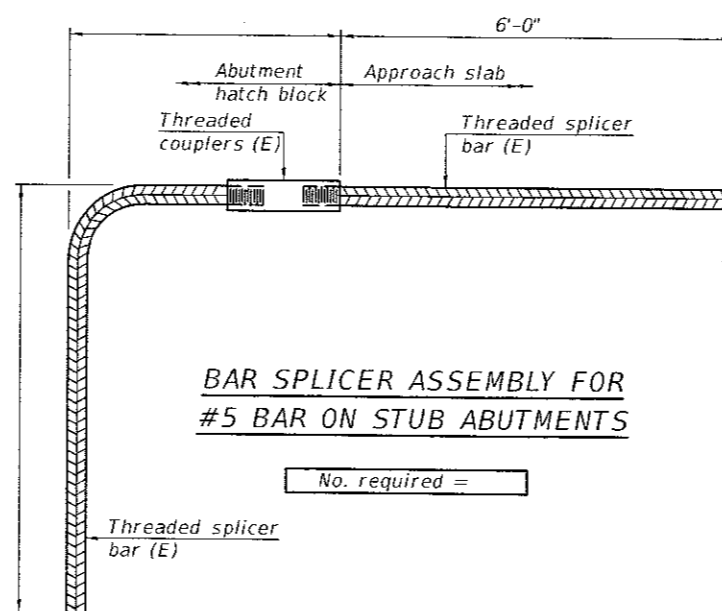

**BAR SPLICER ASSEMBLY FOR #5 BAR ON STUB ABUTMENTS**

No. required =

**NOTES**

Splicer bars shall be deformed with threaded ends and have a minimum 60 ksi yield strength.  
 All reinforcement shall be lapped and tied to the splicer bars.  
 Bar splicer assemblies shall be epoxy coated according to the requirements for reinforcement bars. See Section 508 of the Standard Specifications.  
 See approved list of bar splicer assemblies and mechanical splicers for alternatives.

BSD-1 2-17-2017

DESIGNED VHV	EXAMINED <i>Timothy A. ...</i>	DATE MAY 1, 2018
CHECKED DAB	PASSED <i>Carl ...</i>	REVISED
DRAWN <i>baliva</i>	ENGINEER OF BRIDGES AND STRUCTURES	REVISED
CHECKED VHV DAB		



STATE OF ILLINOIS  
DEPARTMENT OF TRANSPORTATION

BAR SPLICER ASSEMBLY AND MECHANICAL SPLICER DETAILS  
SN 099-0922





F.A.P. RTE. B52	SECTION 18-CLV	COUNTY WILL	TOTAL SHEETS 8	SHEET NO. 6
				CONTRACT NO. 62G24
ILLINOIS FED. AID PROJECT				

SHEET NO. 2 OF 2 SHEETS



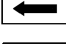

**ROUTE MARKERS**

-  FOR U.S. ROUTES  
M1-40-2424
-  FOR ILLINOIS ROUTES  
M1-50-2424
-  R.R. UNMARKED ROUTES  
SPECIAL 24" x 18" VARIABLE  
4" BLACK LETTERS ON WHITE  
REFLECTIVE BACKGROUND

**ARROWS SIGNS**

-  M5-1L-2115
-  M5-1R-2115
-  M6-1-2115
-  M6-2-2115

**CARDINAL DIRECTION & DETOUR SIGNS**

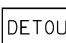
-  NORTH M3-1-2412
-  EAST M3-2-2412
-  SOUTH M3-3-2412
-  WEST M3-4-2412
-  DETOUR M4-8-2412

**STATE ROUTE**

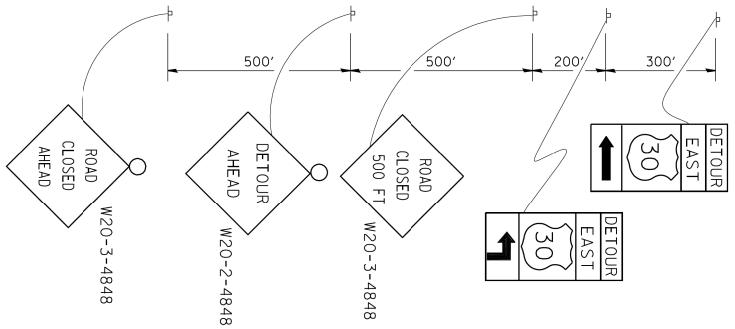

**COMPLETELY CLOSED PORTION**

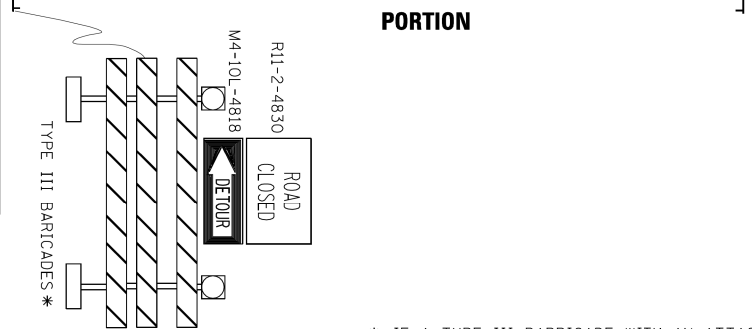

**PARTIALLY CLOSED PORTION**

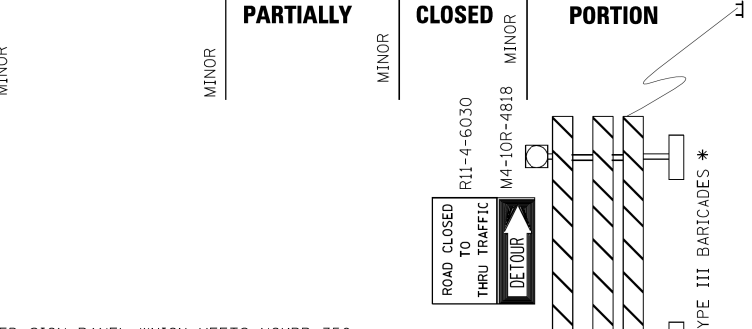

**STATE ROUTE**

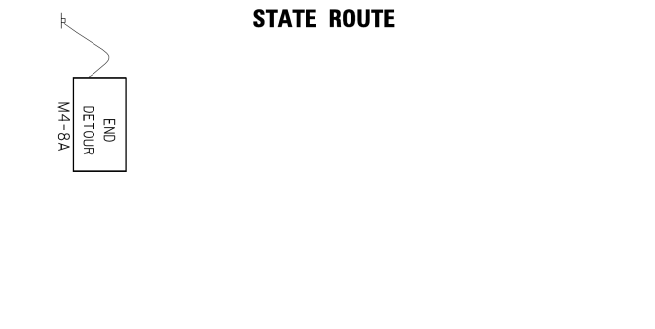

\* IF A TYPE III BARRICADE WITH AN ATTACHED SIGN PANEL WHICH MEETS NCHRP 350 REQUIREMENTS IS NOT AVAILABLE, THE SIGNS SHALL BE MOUNTED, ABOVE THE BARRICADES, ON SEPARATE SIGNS SUPPORTS THAT MEET NCHRP 350 REQUIREMENTS.

FILE NAME =	USER NAME = drivakosgn	DESIGNED -	REVISED - 10-18-02
c:\p\work\p\WID0T\DRIVAKOSGN\0108315\121.dgn		DRAWN -	REVISED - R. BORO 09-14-09
		PLOT SCALE = 49,9999' / IN.	REVISED -
		DATE - 9/14/2009	REVISED -

**STATE OF ILLINOIS  
DEPARTMENT OF TRANSPORTATION**

**DETOUR SIGNING  
FOR CLOSING STATE HIGHWAYS**

SCALE: SHEET NO. OF SHEETS STA. TO STA.

F.A.P. RTE.	SECTION	COUNTY	TOTAL SHEETS	SHEET NO.
852	18-CLV	WILL	8	7
CONTRACT NO. 62G24				
ILLINOIS FED. AID PROJECT				

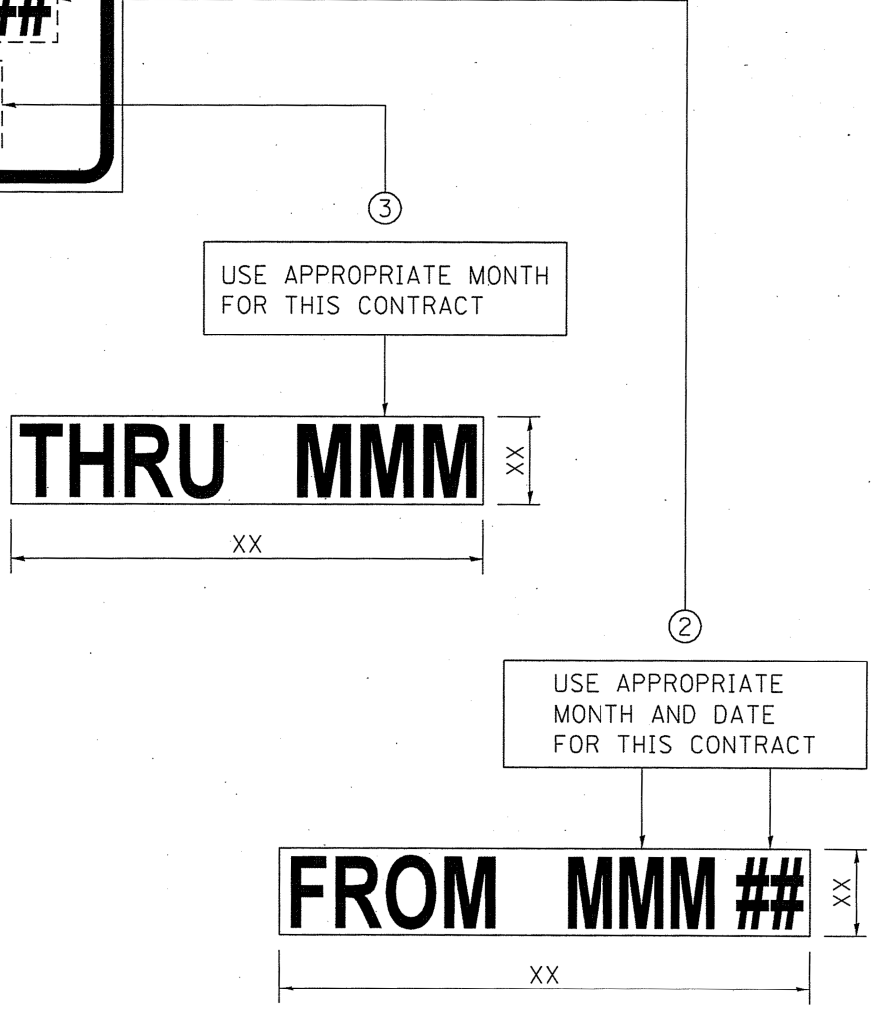
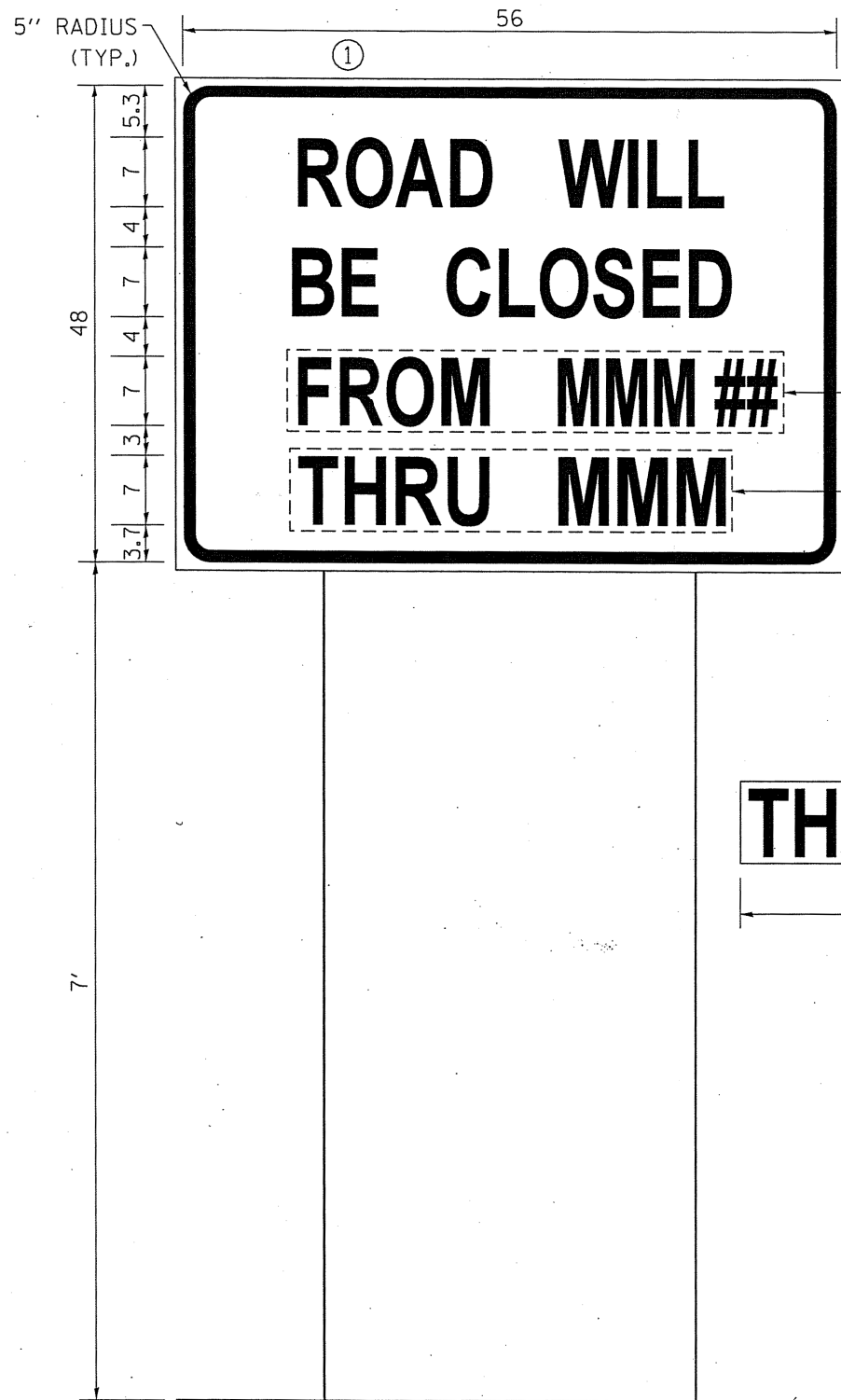
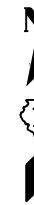

1. USE BLACK LETTERING ON ORANGE BACKGROUND. ALL LETTERING SHALL BE HIGHWAY C FONT.
2. ERECT SIGN ASSEMBLY (POST MOUNTED) WITH PANELS ② AND ③ IN PLACE ON ROAD TO BE CLOSED IN EACH DIRECTION NEAR POINT OF CLOSURE OR WITHIN SECTION TO BE FULLY CLOSED TWO (2) WEEKS PRIOR TO START DATE OF FULL CLOSURE. REMOVE SIGN AFTER CLOSURE
3. OVERLAY PANEL ② TO CONTAIN STARTING DATE OF FULL CLOSURE AND DETOUR IMPLEMENTATION. (EX. "FROM APR 2")
4. OVERLAY PANEL ③ TO CONTAIN ENDING MONTH OF FULL CLOSURE & DETOUR (EX. "THRU JULY"). OMIT THE DATE ON PANEL ③ ; MONTH ONLY.
5. SEE SPECIAL PROVISION FOR "TEMPORARY INFORMATION SIGNING" FOR ADDITIONAL INFORMATION.
6. ONE SIGN ASSEMBLY EQUALS 18.67 SQ. FT.
7. SHALL BE PAID FOR AS TEMPORARY INFORMATION SIGNING.

**ARTERIAL ROAD INFORMATION SIGN**

FOR ROADS TO BE FULLY CLOSED AND DETOURED

\* ALL DIMENSIONS ARE IN INCHES UNLESS SHOWN OTHERWISE.

USER NAME =	DESIGNED -	REVISED -	<b>STATE OF ILLINOIS DEPARTMENT OF TRANSPORTATION</b>	<b>ARTERIAL ROAD INFORMATION SIGN</b>	F.A.P. RTE.	SECTION	COUNTY	TOTAL SHEETS	SHEET NO.	
	DRAWN -	REVISED -			852	18-CLV	WILL	8	8	
PLOT SCALE =	CHECKED -	REVISED -			CONTRACT NO. 62G24					
PLOT DATE =	DATE - 03/13/2018	REVISED -			SCALE:	SHEET NO.	OF SHEETS	STA.	TO STA.	ILLINOIS FED. AID PROJECT