

**UN051**

REVISIONS		
NUMBER	BY	DATE

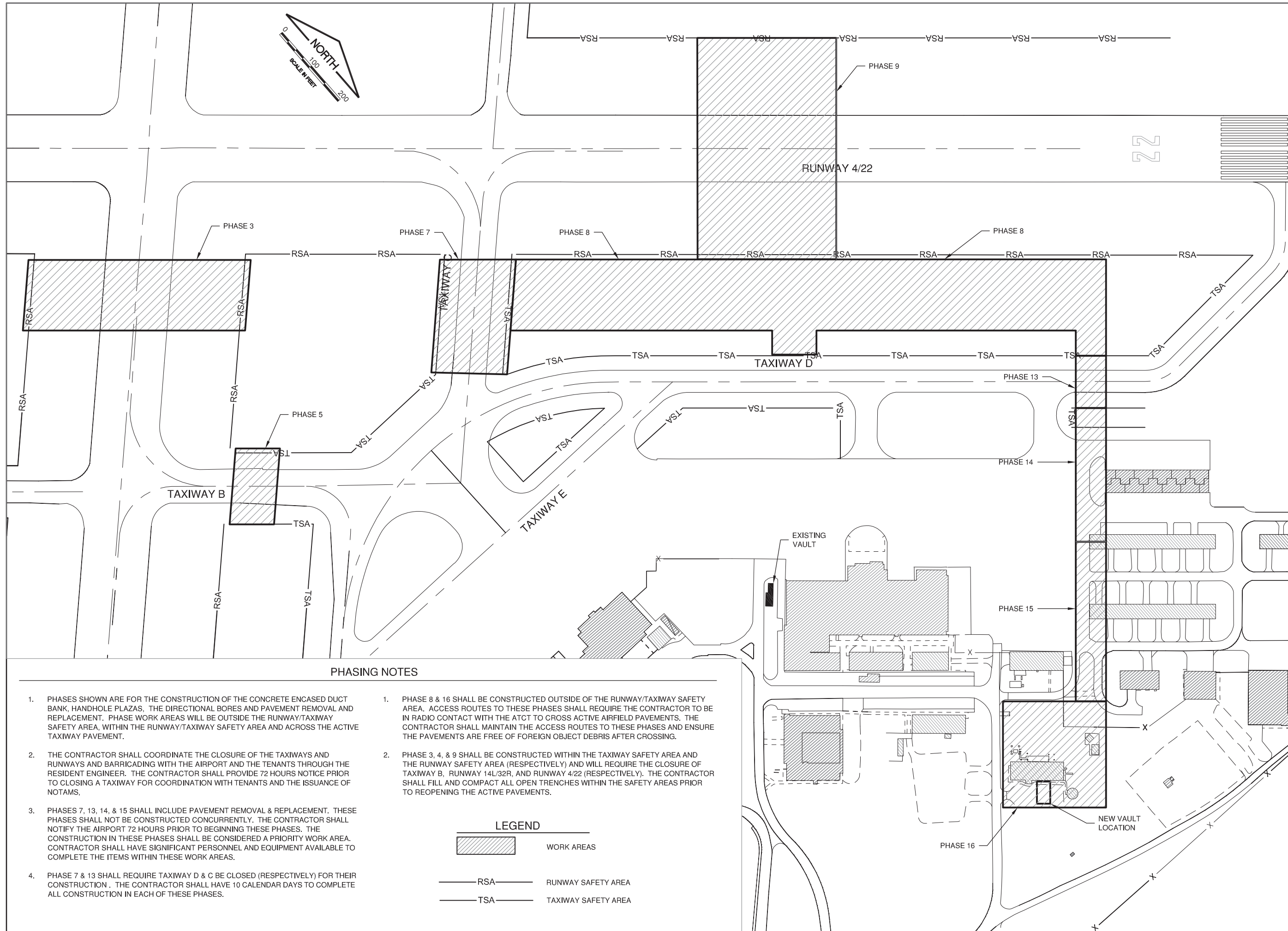
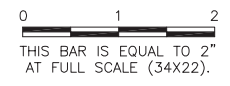

**PHASING NOTES**

- |   |  |
|---|--|
| <ol style="list-style-type: none"> <li>PHASES SHOWN ARE FOR THE CONSTRUCTION OF THE CONCRETE ENCASED DUCT BANK, HANDHOLE PLAZAS, THE DIRECTIONAL BORES AND PAVEMENT REMOVAL AND REPLACEMENT. PHASE WORK AREAS WILL BE OUTSIDE THE RUNWAY/TAXIWAY SAFETY AREA, WITHIN THE RUNWAY/TAXIWAY SAFETY AREA AND ACROSS THE ACTIVE TAXIWAY PAVEMENT.</li> <li>THE CONTRACTOR SHALL COORDINATE THE CLOSURE OF THE TAXIWAYS AND RUNWAYS AND BARRICADING WITH THE AIRPORT AND THE TENANTS THROUGH THE RESIDENT ENGINEER. THE CONTRACTOR SHALL PROVIDE 72 HOURS NOTICE PRIOR TO CLOSING A TAXIWAY FOR COORDINATION WITH TENANTS AND THE ISSUANCE OF NOTAMS.</li> <li>PHASES 7, 13, 14, &amp; 15 SHALL INCLUDE PAVEMENT REMOVAL &amp; REPLACEMENT. THESE PHASES SHALL NOT BE CONSTRUCTED CONCURRENTLY. THE CONTRACTOR SHALL NOTIFY THE AIRPORT 72 HOURS PRIOR TO BEGINNING THESE PHASES. THE CONSTRUCTION IN THESE PHASES SHALL BE CONSIDERED A PRIORITY WORK AREA. CONTRACTOR SHALL HAVE SIGNIFICANT PERSONNEL AND EQUIPMENT AVAILABLE TO COMPLETE THE ITEMS WITHIN THESE WORK AREAS.</li> <li>PHASE 7 &amp; 13 SHALL REQUIRE TAXIWAY D &amp; C BE CLOSED (RESPECTIVELY) FOR THEIR CONSTRUCTION. THE CONTRACTOR SHALL HAVE 10 CALENDAR DAYS TO COMPLETE ALL CONSTRUCTION IN EACH OF THESE PHASES.</li> </ol> | <ol style="list-style-type: none"> <li>PHASE 8 &amp; 16 SHALL BE CONSTRUCTED OUTSIDE OF THE RUNWAY/TAXIWAY SAFETY AREA. ACCESS ROUTES TO THESE PHASES SHALL REQUIRE THE CONTRACTOR TO BE IN RADIO CONTACT WITH THE ATCT TO CROSS ACTIVE AIRFIELD PAVEMENTS. THE CONTRACTOR SHALL MAINTAIN THE ACCESS ROUTES TO THESE PHASES AND ENSURE THE PAVEMENTS ARE FREE OF FOREIGN OBJECT DEBRIS AFTER CROSSING.</li> <li>PHASE 3, 4, &amp; 9 SHALL BE CONSTRUCTED WITHIN THE TAXIWAY SAFETY AREA AND THE RUNWAY SAFETY AREA (RESPECTIVELY) AND WILL REQUIRE THE CLOSURE OF TAXIWAY B, RUNWAY 14L/32R, AND RUNWAY 4/22 (RESPECTIVELY). THE CONTRACTOR SHALL FILL AND COMPACT ALL OPEN TRENCHES WITHIN THE SAFETY AREAS PRIOR TO REOPENING THE ACTIVE PAVEMENTS.</li> </ol> |
|---|--|

**LEGEND**

- |  |                         |
|--|-------------------------|
|  | WORK AREAS              |
|  | RSA RUNWAY SAFETY AREA  |
|  | TSA TAXIWAY SAFETY AREA |

WILLARD AIRPORT  
 UNIVERSITY OF ILLINOIS

NEW AIRFIELD LIGHTING VAULT  
 CONSTRUCTION ACTIVITY PLAN 2

© Copyright CMT, Inc.

**CMT**  
 CRAWFORD, MURPHY & TILLY, INC.  
 CONSULTING ENGINEERS  
 License No. 184-000613



DESIGN BY:	KLB
DRAWN BY:	CMT
CHECKED BY:	CBG
APPROVED BY:	CET
DATE:	APRIL 20, 2012
JOB No:	11059-03
IL PROJ. NO.	CMI-4100
AIP PROJ. NO.	3-17-0016-XX
SHEET	07 OF 60 SHEETS