

**UN051**

| REVISIONS |    |      |
|-----------|----|------|
| NUMBER    | BY | DATE |
|           |    |      |
|           |    |      |
|           |    |      |

0 1 2  
 THIS BAR IS EQUAL TO 2"  
 AT FULL SCALE (34X22).

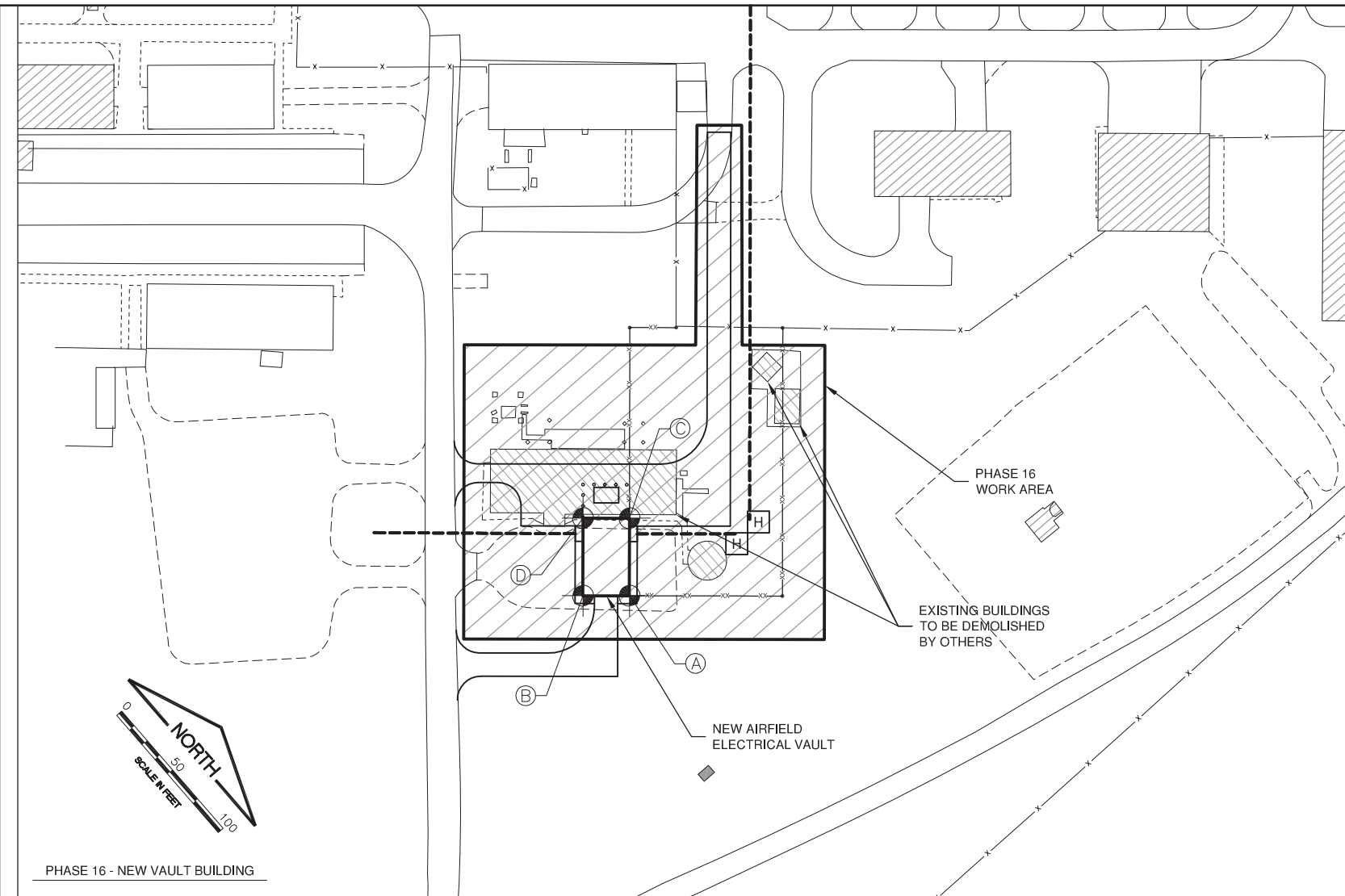

**NOTES:**

1. PHASE 16 SHALL INCLUDE THE DEMOLITION OF EXISTING BUILDINGS, CONSTRUCTION OF THE ELECTRICAL VAULT BUILDING WITH THE ASSOCIATED SITE WORK, AS WELL AS ALL DUCT INSTALLATION.
2. PHASE 18 SHALL INCLUDE THE CONSTRUCTION OF THE BEACON TOWER AND BEACON.
3. REMOVALS AND NEW CONSTRUCTION IN THESE PHASES SHALL BE CONCURRENT WITH THE CONSTRUCTION OF THE DUCT RUNS AND CABLING.
4. CONSTRUCTION IN THESE WORK AREAS WILL BE OUTSIDE OF THE RUNWAY/TAXIWAY SAFETY AREAS.

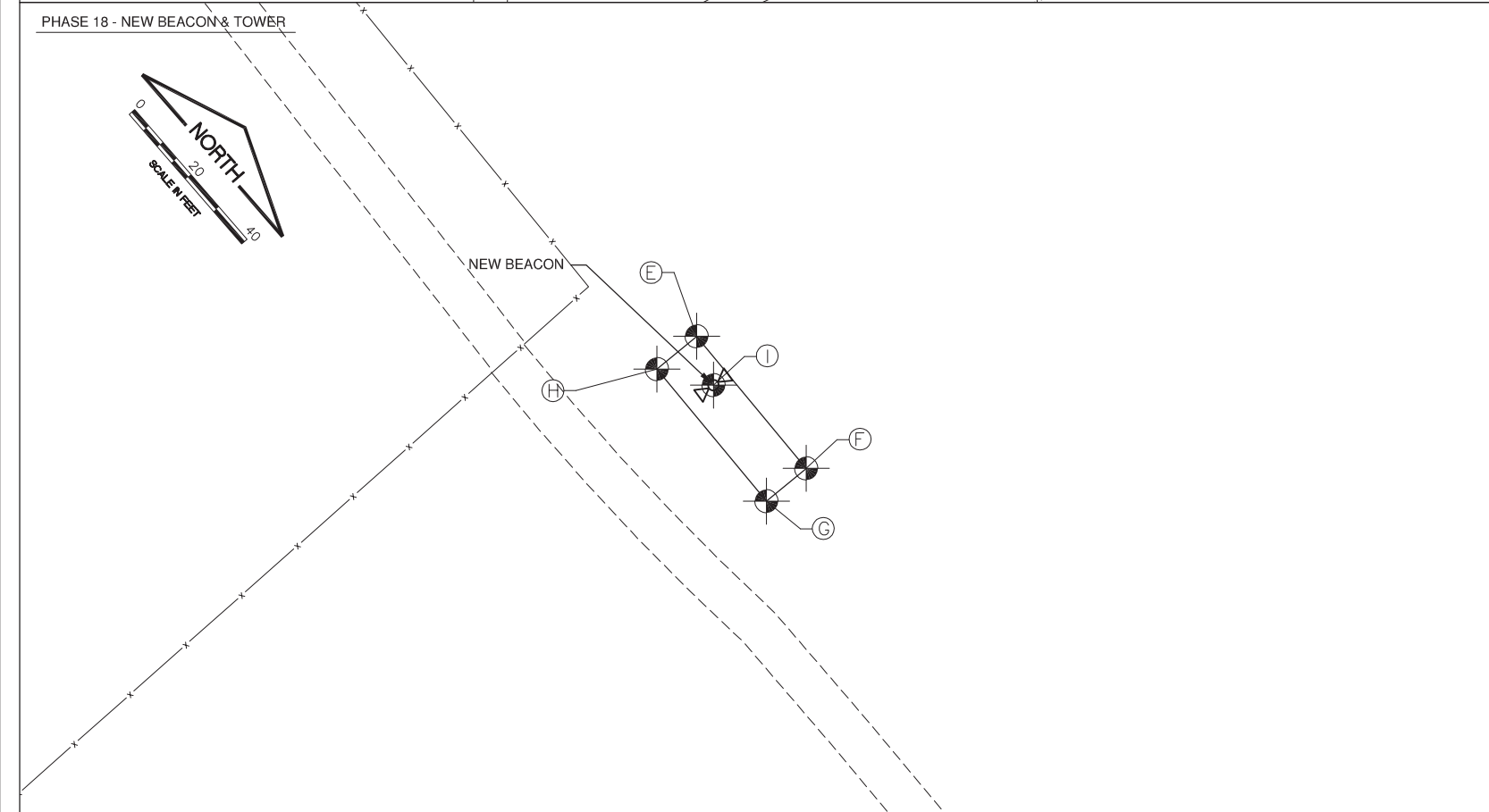

| CRITICAL POINTS |               |              |              |          |           |         |
|-----------------|---------------|--------------|--------------|----------|-----------|---------|
| POINT ID        | FIELD OBJECT  | LATITUDE     | LONGITUDE    | PROPOSED | STRUCTURE | OVERALL |
| A               | BLDG. CORNER  | 40°02'29.25" | 88°16'02.91" | 746.55   | 14.0'     | 760.55  |
| B               | BLDG. CORNER  | 40°02'29.03" | 88°16'03.16" | 746.55   | 14.0'     | 760.55  |
| C               | BLDG. CORNER  | 40°02'29.58" | 88°16'03.39" | 746.55   | 14.0'     | 760.55  |
| D               | BLDG. CORNER  | 40°02'29.35" | 88°16'03.65" | 746.55   | 14.0'     | 760.55  |
| E               | TOWER CORNER  | 40°02'23.30" | 88°17'06.58" | 751.00   | 0.0'      | 751.00  |
| F               | TOWER CORNER  | 40°02'23.29" | 88°17'06.06" | 751.00   | 0.0'      | 751.00  |
| G               | TOWER CORNER  | 40°02'23.17" | 88°17'06.07" | 751.00   | 0.0'      | 751.00  |
| H               | TOWER CORNER  | 40°02'23.18" | 88°17'06.58" | 751.00   | 0.0'      | 751.00  |
| I               | TOP OF BEACON | 40°02'23.26" | 88°17'06.44" | 751.00   | 25.0'     | 776.00  |

**WILLARD AIRPORT**  
**UNIVERSITY OF ILLINOIS**  
**NEW AIRFIELD LIGHTING VAULT**  
**CONSTRUCTION ACTIVITY PLAN 1**

© Copyright CMT, Inc.  
**CMT**  
 CRAWFORD, MURPHY & TILLY, INC.  
 CONSULTING ENGINEERS  
 License No. 184-000613



|               |                 |
|---------------|-----------------|
| DESIGN BY:    | KLB             |
| DRAWN BY:     | CMT             |
| CHECKED BY:   | CBG             |
| APPROVED BY:  | CET             |
| DATE:         | APRIL 20, 2012  |
| JOB No:       | 11059-03        |
| IL PROJ. NO.  | CMI-4100        |
| AIP PROJ. NO. | 3-17-0016-XX    |
| SHEET         | 06 OF 60 SHEETS |