

Job No. 086-09
 Scale: 1"=20'
 Drawn by: BEC
 Design by: BEC
 Approved by: CMB
 File Name: 810h Plans

ISSUE RECORD

DATE

DATE

DATE

DATE

DATE

DATE

DATE

DATE

DATE

DATE

DATE

DATE

DATE

DATE

DATE

DATE

DATE

DATE

DATE

DATE

DATE

DATE

DATE

DATE

DATE

DATE

DATE

DATE

DATE

DATE

DATE

DATE

Corporate Engineering Certificate # 000381
 CIVIL ENGINEER
 4/2012

CBB
 Crawford, Bunte, Brammeier
 Traffic and Transportation Engineers
 St. Louis, Missouri/Glen Carbon, Illinois
 314-878-6644 618-656-2612
 Fax: 314-878-5876 E-Mail: cbb@cbtraffic.com

PLAN/PROFILE SHEETS
 N. GREEN MOUNT ROAD & I-64
 E.B. RAMP, W.B. RAMP & REGENCY PARK/PIERCE BLVD
 SHILOH, ILLINOIS

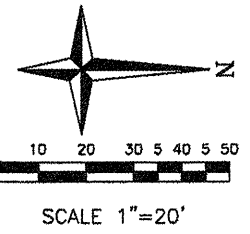

SSA INVESTMENTS LLC
 03-36.0-204-008
 496 REGENCY PARK
 LOT 3 - SHOPPES AT N. GREEN MOUNT

N. GREEN MOUNT CENTRE, LLC
 03-36.0-204-005
 1417 N N. GREEN MOUNT RD
 LOT 2A
 SHOPPES AT N. GREEN MOUNT

N. GREEN MOUNT CENTRE, LLC
 03-36.0-204-004
 1425 N N. GREEN MOUNT RD
 LOT 2
 SHOPPES AT N. GREEN MOUNT

N. GREEN MOUNT CENTRE, LLC
 03-36.0-204-003
 1433 N N. GREEN MOUNT RD
 LOT 1
 SHOPPES AT N. GREEN MOUNT

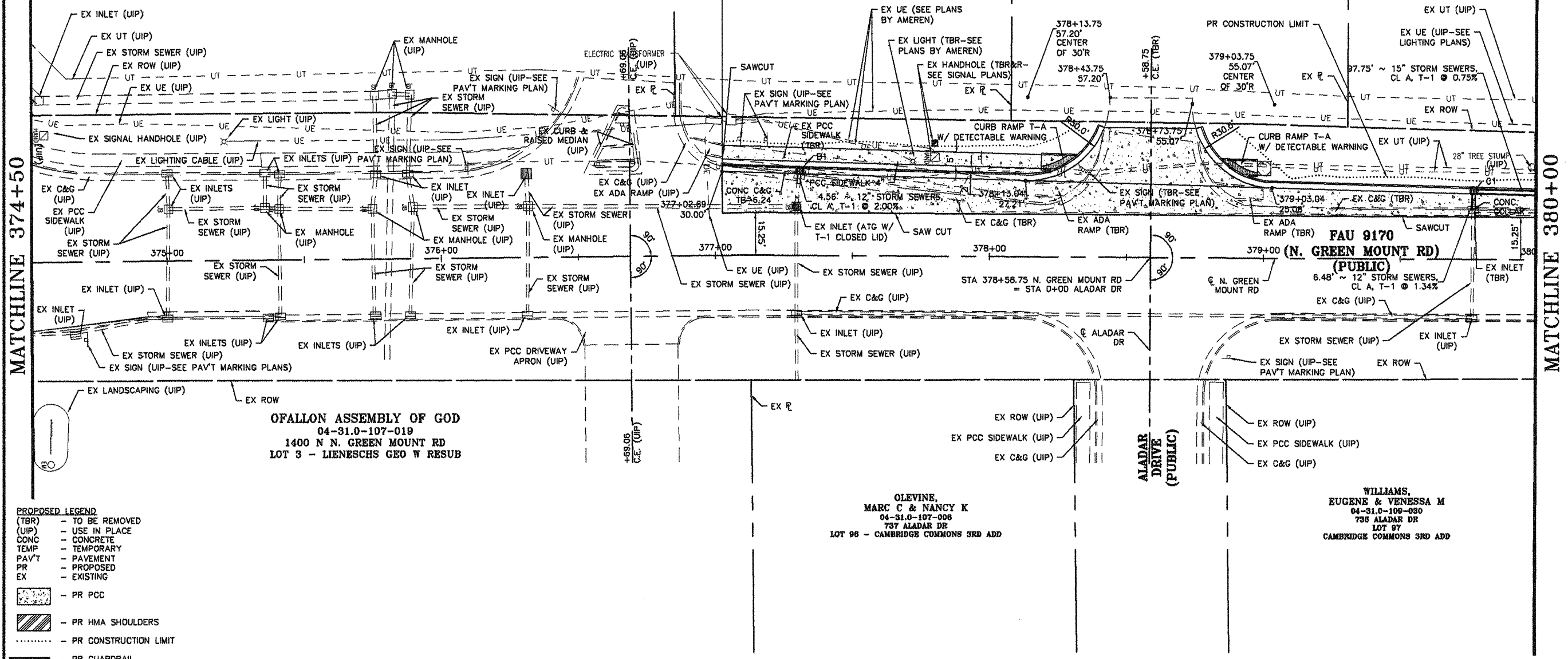

- PROPOSED LEGEND**
- (TBR) - TO BE REMOVED
 - (UIP) - USE IN PLACE
 - CONC - CONCRETE
 - TEMP - TEMPORARY
 - PAVT - PAVEMENT
 - PR - PROPOSED
 - EX - EXISTING
 - [Pattern] - PR PCC
 - [Pattern] - PR HMA SHOULDERS
 - [Dashed Line] - PR CONSTRUCTION LIMIT
 - [Line with Arrow] - PR GUARDRAIL

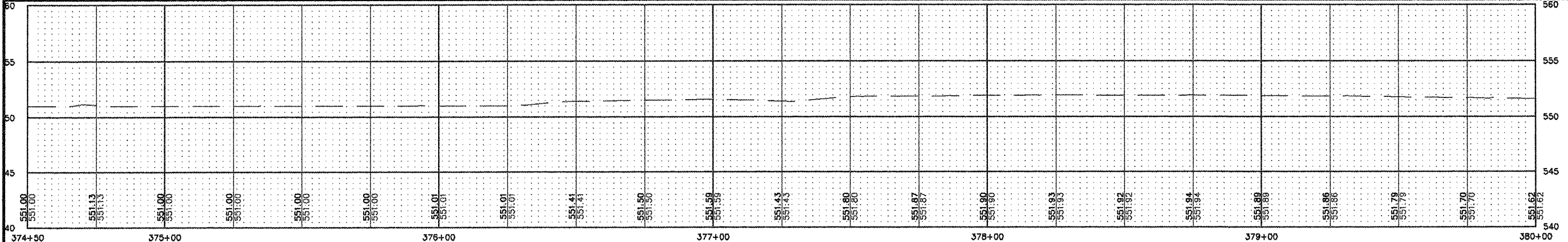

F.A.U. RTE.	SECTION	COUNTY
917D	08-00333-12-PW	ST. CLAIR
ILLINOIS	CONTRACT NO. 97492	