

Job No. 088-08
Scale: 1"=20'
Drawn by: BEC
Design by: BEC
Approved by: CMB
File Name: 8/10/12

ISSUE RECORD

| DATE | DESCRIPTION |
|--------------|-------------|
| PS&E 4/20/12 | |

Corporate Engineering Certificate # 000381

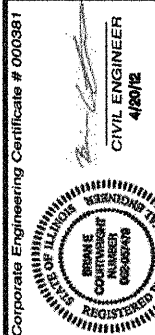

CBB
Crawford, Bunte, Brammeier
Traffic and Transportation Engineers

St. Louis, Missouri/Glen Carbon, Illinois
314-878-6644 618-656-2612
Fax: 314-878-5876 E-Mail: cbb@cbbrtraffic.com

PLAN/PROFILE SHEETS
N. GREEN MOUNT ROAD & I-64
E.B. RAMP, W.B. RAMP &
REGENCY PARK/PIERCE BLVD
SHILOH, ILLINOIS

MATCHLINE 353+00

MATCHLINE 358+50

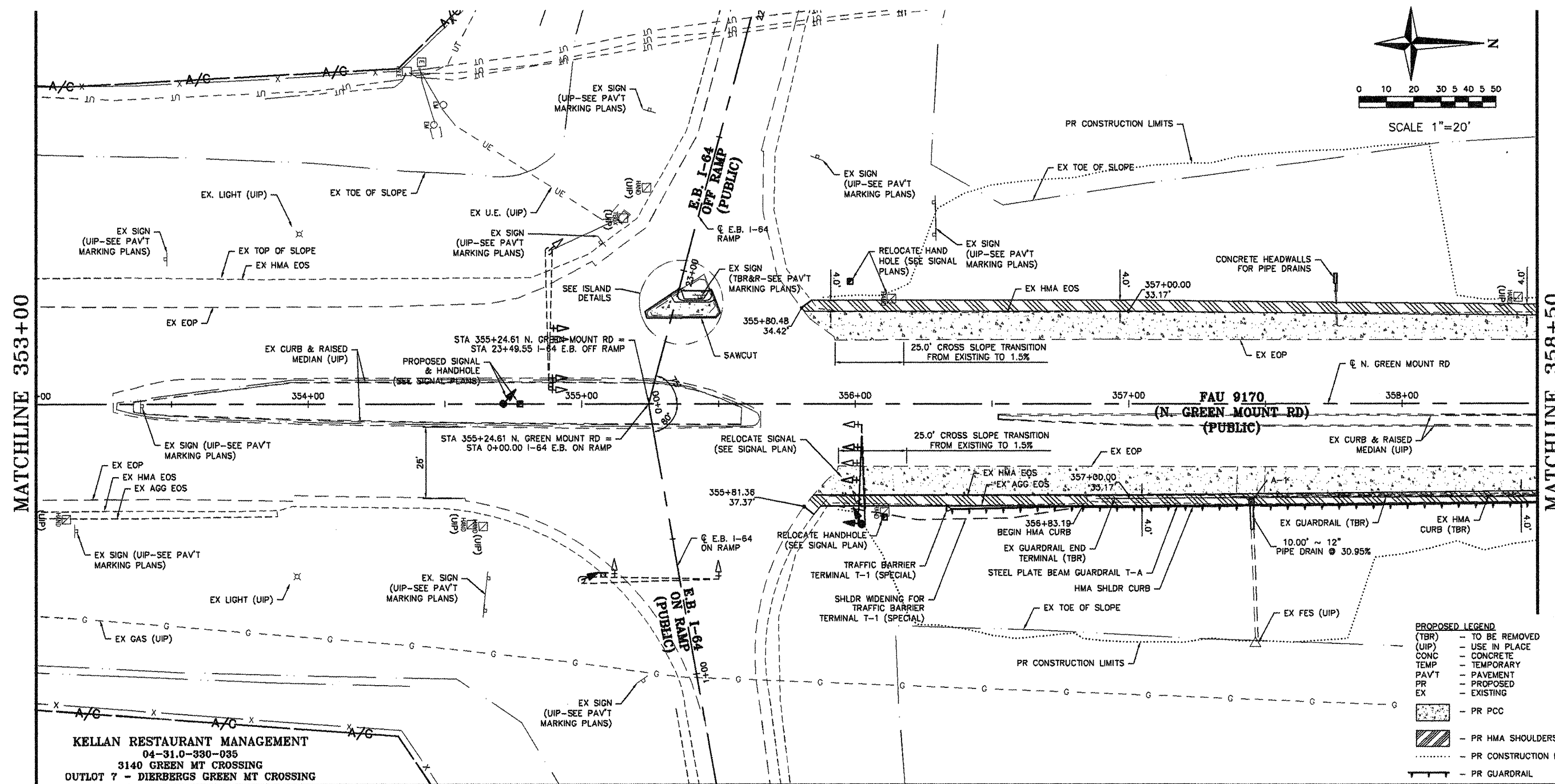
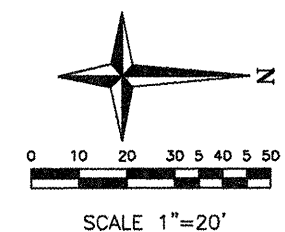

PROPOSED LEGEND

| | |
|---------------|-------------------------|
| (TBR) | - TO BE REMOVED |
| (UIP) | - USE IN PLACE |
| CONC | - CONCRETE |
| TEMP | - TEMPORARY |
| PAVT | - PAVEMENT |
| PR | - PROPOSED |
| EX | - EXISTING |
| [Pattern] | - PR PCC |
| [Pattern] | - PR HMA SHOULDERS |
| [Dashed Line] | - PR CONSTRUCTION LIMIT |
| [Symbol] | - PR GUARDRAIL |

KELLAN RESTAURANT MANAGEMENT
04-31.0-330-035
3140 GREEN MT CROSSING
OUTLOT 7 - DIERBERGS GREEN MT CROSSING

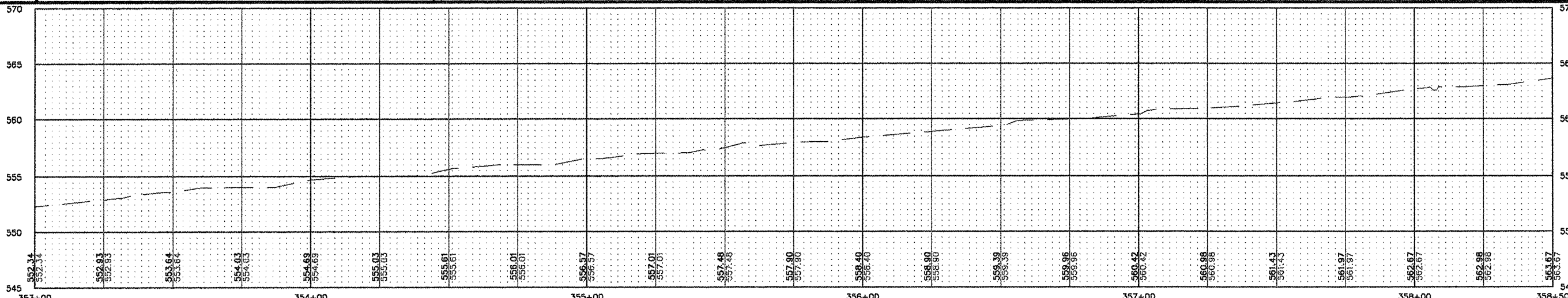

| FAU RTE. | SECTION | COUNTY |
|----------|--------------------|-----------|
| 9170 | 08-00333-12-PW | ST. CLAIR |
| ILLINOIS | CONTRACT NO. 97492 | |