

LEGEND	
TT T	TEMPORARY CONSTRUCTION EASEMENT
---	SAWED JOINT WITH NO TIE BARS OR DOWELS
[Cross-hatched]	SIDEWALK OR PAVEMENT REMOVAL
---	TRANSVERSE EXPANSION JOINT
---	LONGITUDINAL SAWED OR CONSTR. JOINT
[Diagonal lines]	HMA SURFACING
---	TRANSVERSE CONTRACTION JOINT
[Stippled]	AGGREGATE SURFACE COURSE, TY. A, B"

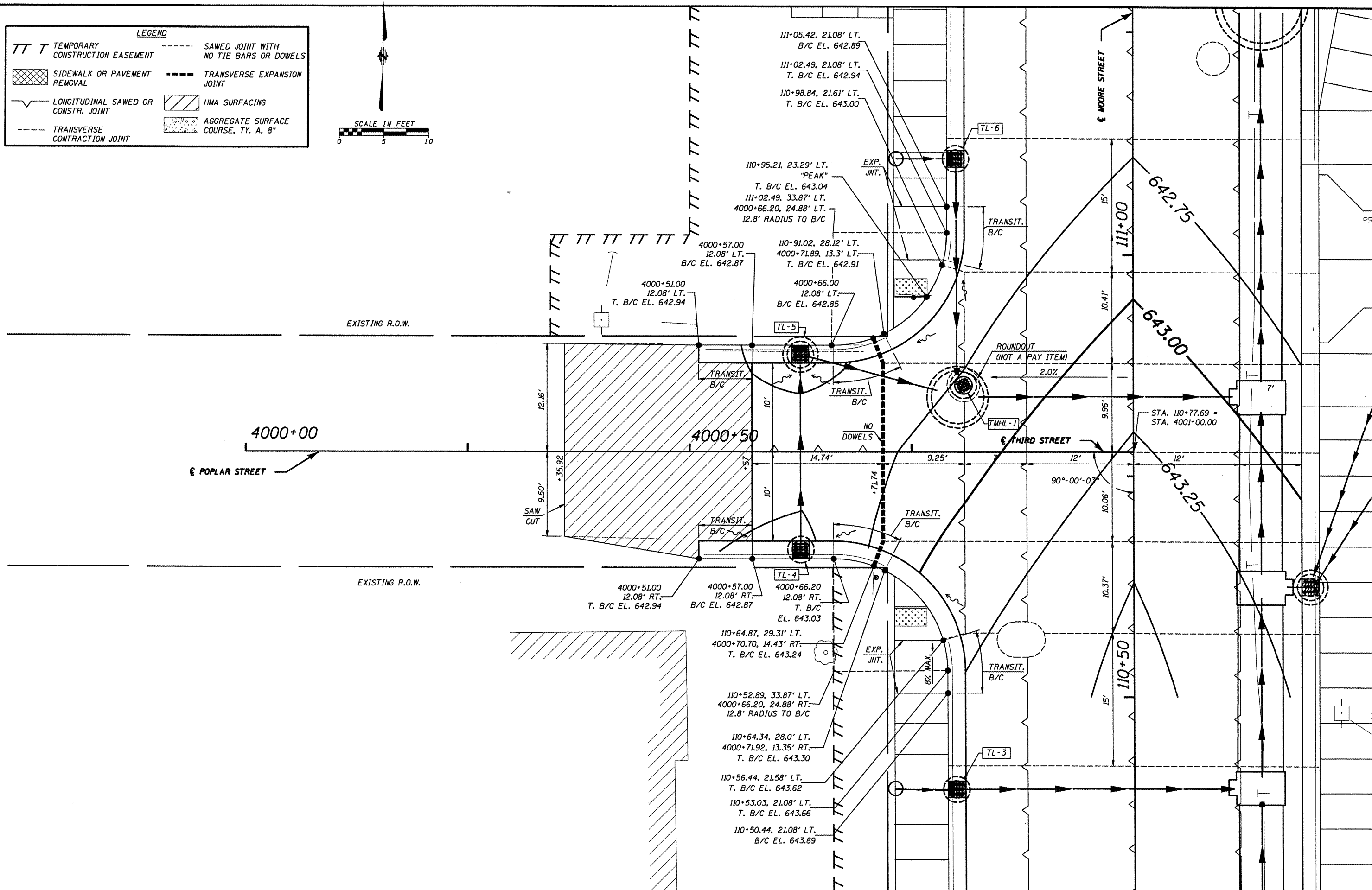
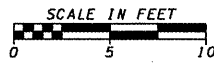

FILE NAME = 6185-Intersect11-poplar.dgn
 FILEL

USER NAME = *USER*	DESIGNED - HMG: CRW & EDW	REVISED -
PLOT SCALE = *SCALE*	DRAWN - HMG: CRW, EDW, & KOJ	REVISED -
PLOT DATE = *DATE*	CHECKED - HMG: CRW	REVISED -
	DATE -	REVISED -

STATE OF ILLINOIS
 DEPARTMENT OF TRANSPORTATION

INTERSECTION DETAIL
 POPLAR STREET

F.A. RTE. 9315	SECTION 06-00032-03-PV	COUNTY MONROE	TOTAL SHEETS 93	SHEET NO. 49
FED. ROAD DIST. NO.		ILLINOIS FED. AID PROJECT		

HMG ENGINEERS, INC., 1075 LAKE ROAD, PO BOX 70, CARLYLE, IL 62231 PHONE (618) 594-3711 WWW.HMGENGINEERS.COM