

Reinforcement ELEVATION Dimensions

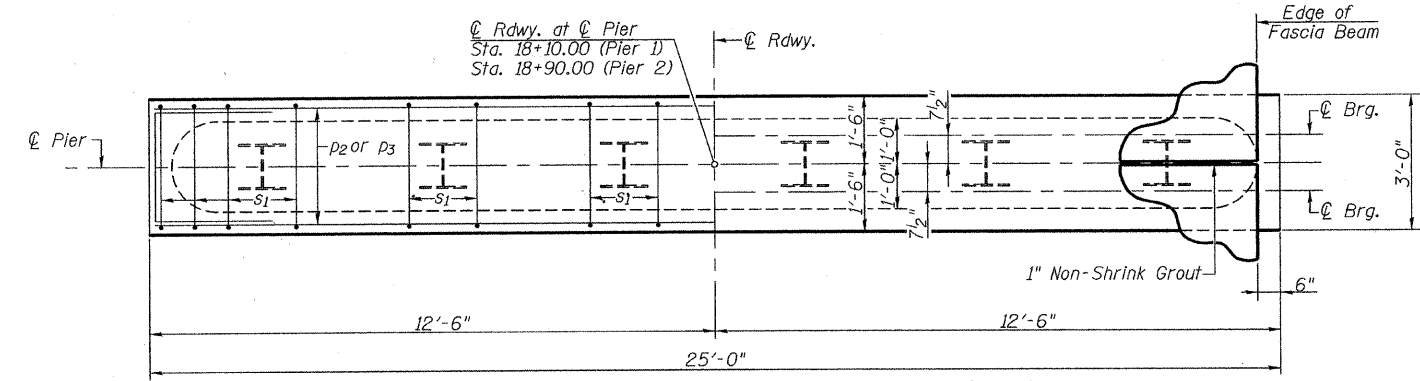

Reinforcement PLAN Dimensions

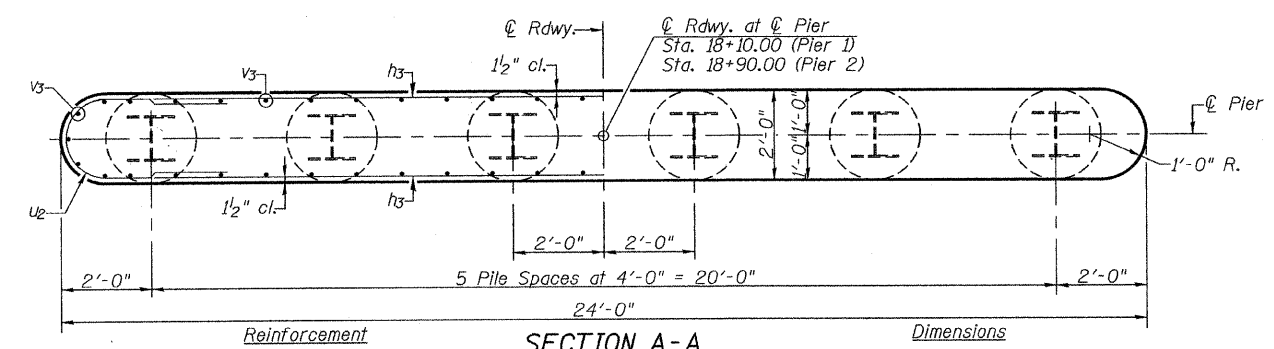

Reinforcement SECTION A-A Dimensions

PILE DATA

	Pier 1	Pier 2
Type:	Steel HP 12x53	Steel HP 12x53
Nominal Required Bearing:	419 Kips	419 Kips
Factored Resistance Available:	230 Kips	230 Kips
Estimated Pile Length:	25'	25'
Number of Production:	6	6
Number of Test Piles:	0	0

NOTES

The Steel H-Piles shall be according to AASHTO M270, Grade 50.
 All exposed edges shall have standard 3/4" chamfer except as noted.
 Space reinforcement in pier caps to miss beam anchor dowels.

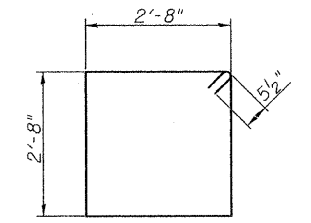

BAR s1

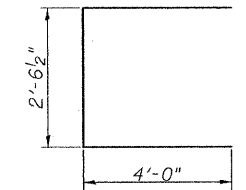

BAR u1

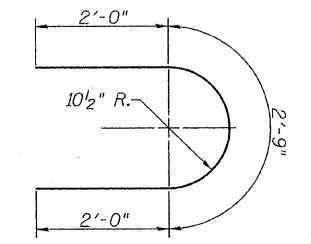

BAR u2

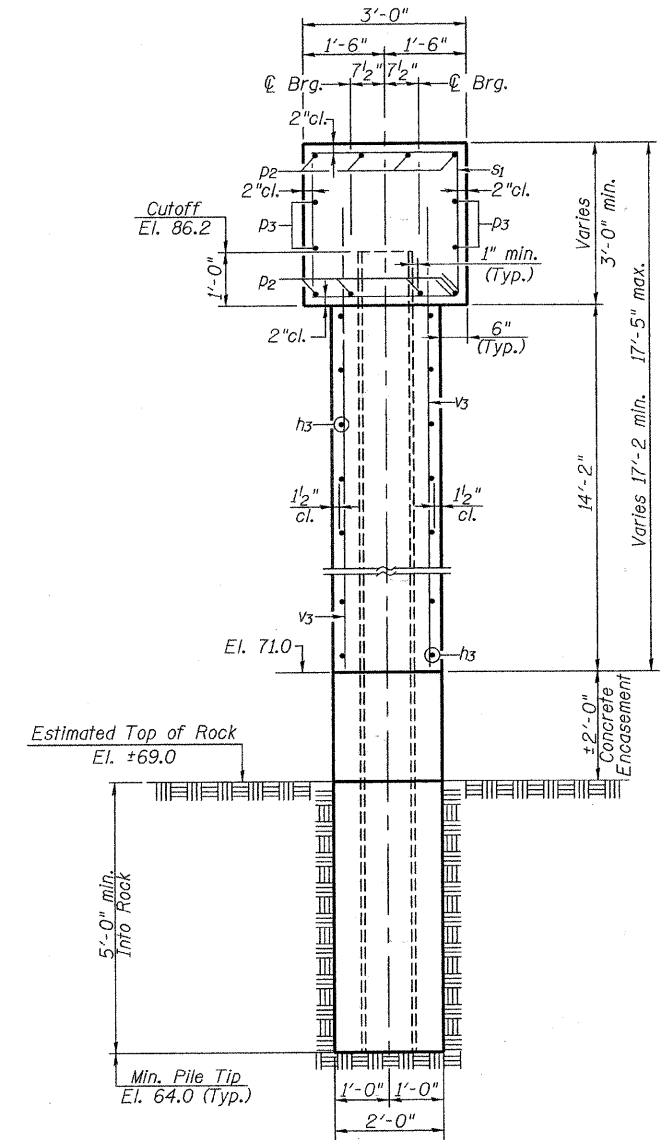

SECTION THRU PIER

TWO PIERS BILL OF MATERIAL

BAR NO.	SIZE	LENGTH	SHAPE
h3	#5	22'-0"	—
p2	#8	24'-8"	—
p3	#5	24'-8"	—
s1	#5	11'-7"	□
u1	#6	10'-7"	□
u2	#6	6'-9"	C
v3	#7	16'-1"	—
Concrete Structures			Cu. Yd. 66.9
Reinforcement Bars			Pound 7545
Furnishing Steel Piles, HP 12x53			Foot 300
Concrete Encasement			Cu. Yd. 2.8
Cofferdam Excavation			Cu. Yd. 86
Setting Piles in Rock			Each 12
Cofferdam (Type 2), Location 1			Each 1
Cofferdam (Type 2), Location 2			Each 1