

STATE OF ILLINOIS DEPARTMENT OF TRANSPORTATION

PLANS FOR PROPOSED HIGHWAY BRIDGE PROGRAM

**T.R. 272 OVER RICHLAND CREEK
SECTION 10-03114-00-BR
PROJECT BROS-0173(177)
SHELBY COUNTY
C-97-069-12**

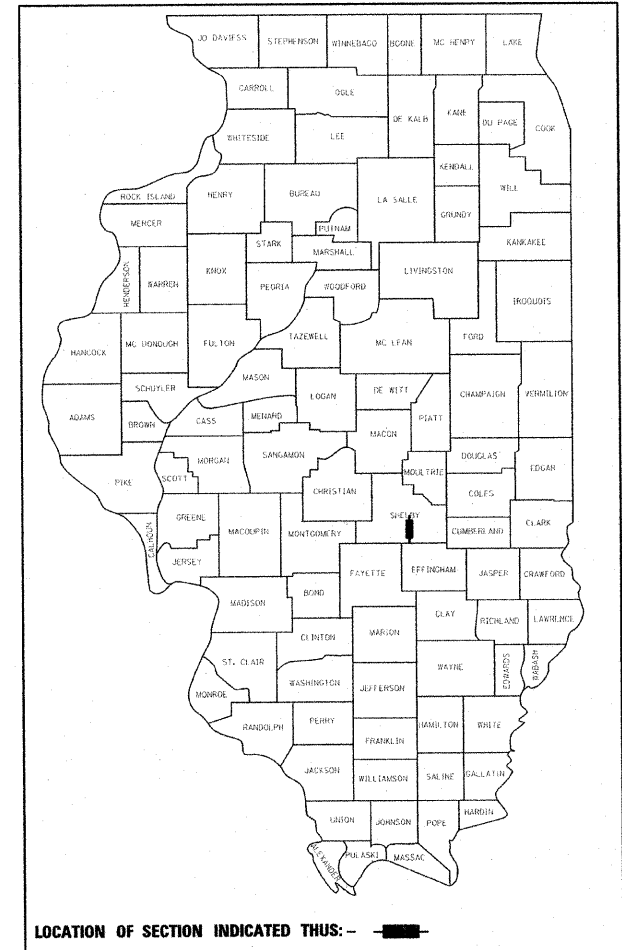

- INDEX OF SHEETS**
- 1 - TITLE SHEET
 - 2 - SUMMARY OF QUANTITIES, DETAILS, TYPICAL SECTIONS & SCHEDULES
 - 3 - DETAILS & TYPICAL SECTIONS
 - 4 - PLAN & PROFILE (T.R. 272)
 - 5 - PLAN & PROFILE (F.E. STA. 19+60)
 - 6 - GRADING PLAN
 - 7 & 8 - GENERAL PLAN & ELEVATION
 - 9 - 12 - SUPERSTRUCTURE
 - 13 - RAILING
 - 14 - ABUTMENTS
 - 15 - PIERS
 - 16 - STEEL H PILE DETAILS
 - 17 - 22 - CROSS SECTIONS (T.R. 272)
 - 23 & 24 - CROSS SECTIONS (F.E. STA. 19+60)
 - 25 - 27 - CROSS SECTIONS (RICHLAND CREEK)

STANDARDS

- STANDARD 000001-06
- STANDARD 280001-06
- STANDARD 515001-03
- STANDARD 635006-03
- STANDARD 701901-02
- STANDARD BLR 21-9

UTILITIES

- SHELBY ELECTRIC COOPERATIVE
NORTH ROUTE 128
SHELBYVILLE, ILLINOIS 62565
- CONSOLIDATED COMMUNICATIONS INC.
121 SOUTH 17TH STREET
MATTOON, ILLINOIS 61938-3915
217-234-9971
- LINCOLN PRAIRIE WATER COMPANY
ROUTE 128 NORTH
SHELBYVILLE, IL. 62565
217-774-3986

SCALE IN FEET

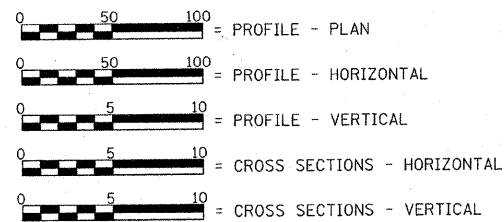

LAND SECTION - 23
LAND QUARTER SECTION - N.E.
FUNCTIONAL CLASSIFICATION: LOCAL ROAD (NON-URBAN)
A.D.T. - 50 (2009)
30 M.P.H. DESIGN SPEED

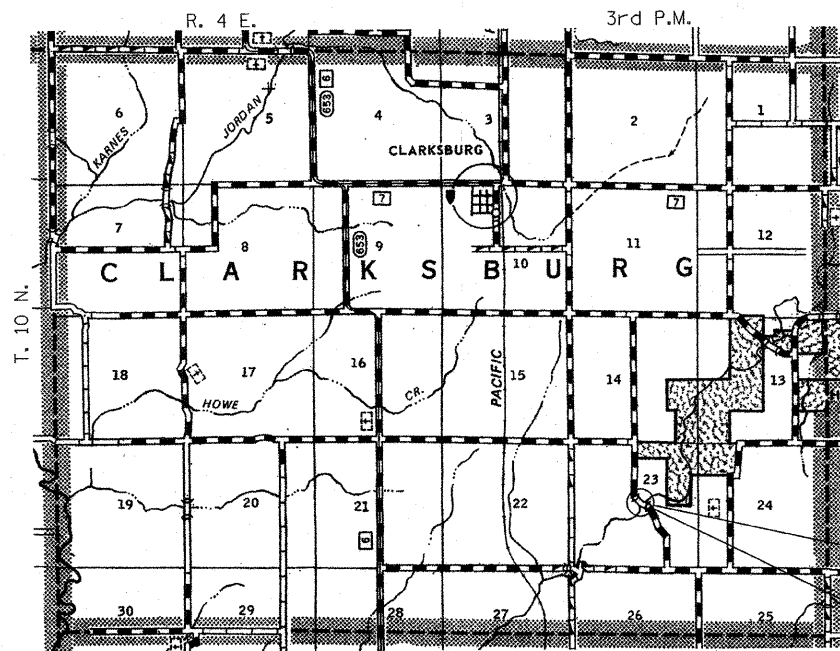

LOCATION PLAN

LENGTH OF SECTION - 740.00 FEET = 0.140 MILES

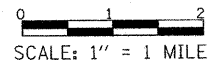

EXISTING STRUCTURE: TWO SPAN TIMBER DECK ON STEEL STRINGERS SUPPORTED BY CLOSED TIMBER ABUTMENTS WITH TIMBER WINGWALLS AND ONE TIMBER PILE BENT PIER. ±80'-0" BK.-BK. ABUTMENTS, ±17'-0" OUT.-OUT. DECK. STEEL RAILING. 0° SKEW.
EXISTING STRUCTURE NO. 087-3187

PROPOSED STRUCTURE: THREE SPAN PRECAST PRESTRESSED CONCRETE DECK BEAM (33") BRIDGE ON OPEN CONCRETE ABUTMENTS AND SOLID CONCRETE PIERS. 24'-0" OUT. TO OUT. DECK, 176'-0" BK. TO BK. ABUTMENTS. STEEL RAILING TYPE S-1. 0° SKEW
PROPOSED STRUCTURE NO. 087-3576

PROJECT BEGINS
STA. 14+00.00

PROJECT ENDS
STA. 21+40.00



Christopher P. Johnson 4/15/12
EXPIRATION: 11/30/2015

APPROVED <u>04-09</u> , 2012 <i>Robert Allen</i> TOWNSHIP HIGHWAY COMMISSIONER
APPROVED <u>04-10</u> , 2012 <i>S. W. Johnson</i> COUNTY ENGINEER
PASSED <u>4-23</u> , 2012 <i>M. Johnson</i> DISTRICT SEVEN ENGINEER OF LOCAL ROADS & STREETS
Releasing For Bid Based on Limited Review <u>4/23</u> , 2012 <i>Roger L. Orsheloff</i> DEPUTY DIRECTOR OF HIGHWAYS, REGION FOUR ENGINEER
STATE OF ILLINOIS DEPARTMENT OF TRANSPORTATION

TOLL FREE
"JOINT UTILITY LOCATION INFORMATION FOR EXCAVATORS"
(J.U.L.I.E.) TELEPHONE NUMBER
1-800-892-0123

CONTRACT NO. 95688

FILE NAME	USER NAME - \$USERS\$	DESIGNED -	REVISED -		Allen Henderson & Associates, Inc. Civil and Structural Engineers Springfield, IL 62708 Phone: (217)544-8033 IL Design Firm No. 184-001907	TITLE SHEET	T.R. RTE. 272	SECTION 10-03114-00-BR	COUNTY SHELBY	TOTAL SHEETS 27	SHEET NO. 1
#PLOT#	PLOT SCALE - \$SCALE\$	DRAWN	REVISED	SCALE: 1" = 1 MILE SHEET NO. 1 OF 27 SHEETS		STA. 14+00.00 TO STA. 21+40.00		STR. NO. 087-3576		CONTRACT NO. 95688	
	PLOT DATE - \$DATE\$	CHECKED	REVISED								
		DATE	REVISED								