

F.A.S. RTE.	SECTION	COUNTY	TOTAL SHEETS	SHEET NO.
206	04-00094-02-RS	MERCER COUNTY	18	12
STA. 114+50 TO STA. 121+40.01				
FED. ROAD DIST. NO. 7			ILLINOIS	

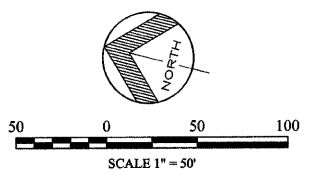

BENCHMARKS:  
 BM #1: CENTER OF EXISTING BRIDGE DECK  
 ELEV. 683.02

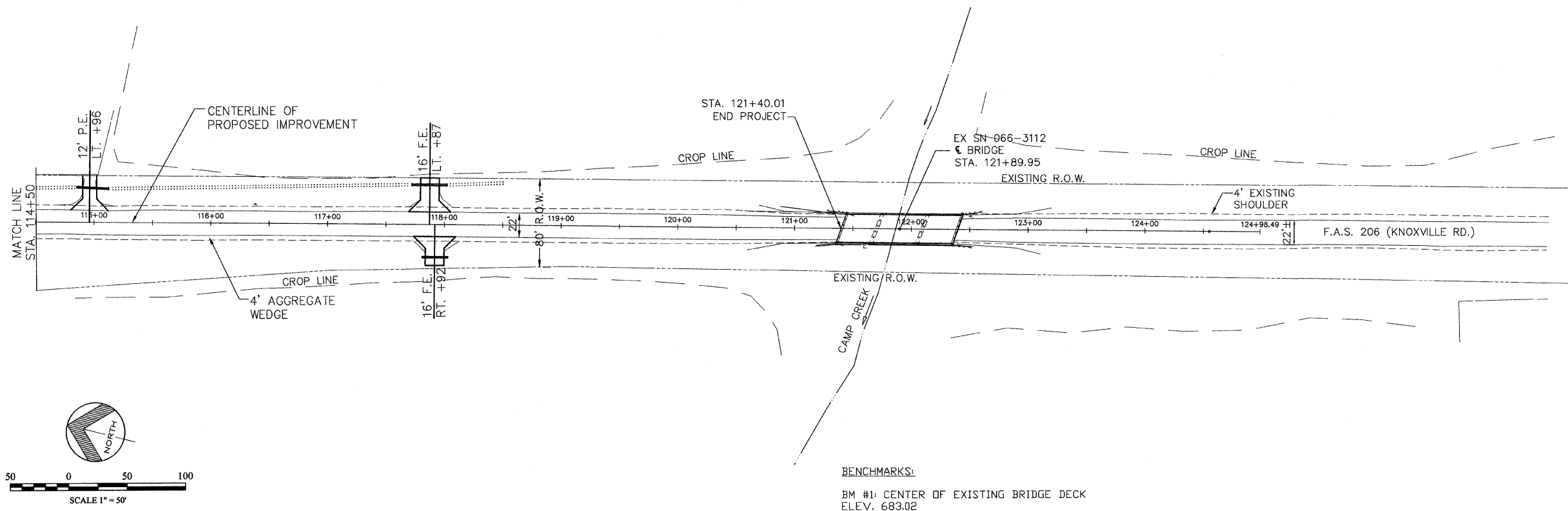
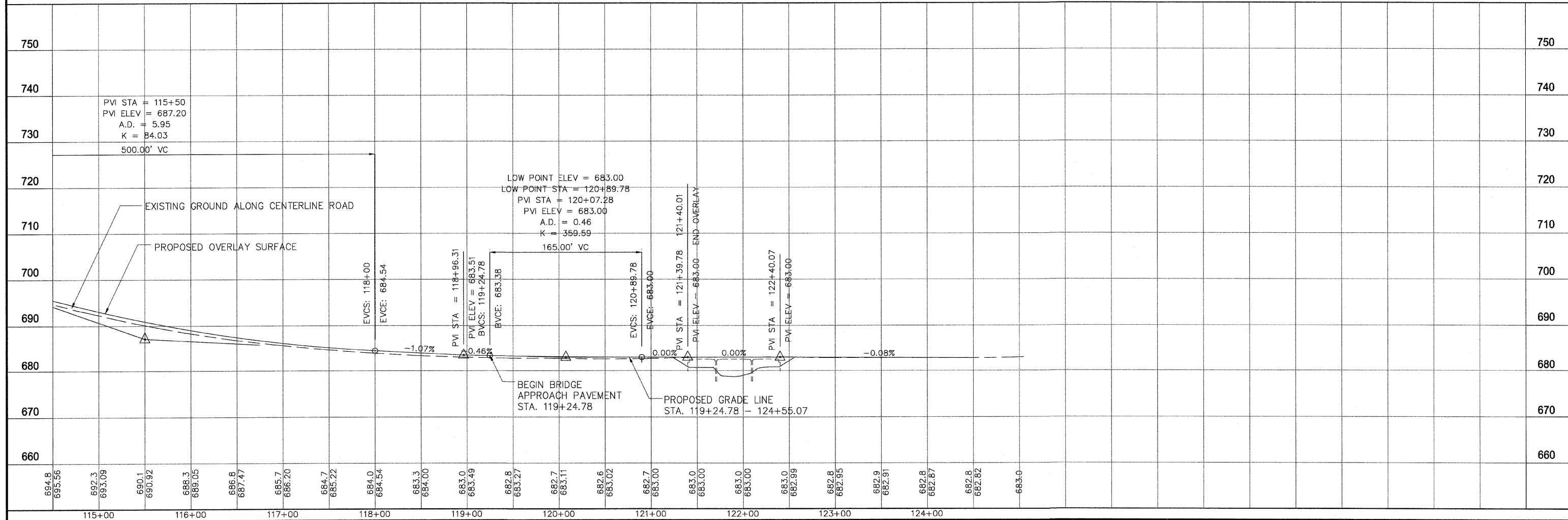

2025/04/01 10:11:00 AM C:\Users\jgibson\OneDrive\Documents\2025\04\01\101100\101100.dwg 114+50 - 121+40.01 12/27/2024 10:11:00 AM