

STATE OF ILLINOIS
DEPARTMENT OF TRANSPORTATION
DIVISION OF HIGHWAYS

**PROPOSED
HIGHWAY PLANS**

F.A.I. ROUTE 39 (I-39)
SECTION D5 PATCHING 2013-1

PAVEMENT PATCHING
MCLEAN COUNTY

C-95-011-12
PATCHING FROM I-55 TO WOODFORD COUNTY LINE

F.A.I. RTE.	SECTION	COUNTY	TOTAL SHEETS	SHEET NO.
39	D5 PATCHING 2013-1	MCLEAN	19	1
		ILLINOIS	CONTRACT NO. 70973	

D-95-011-12

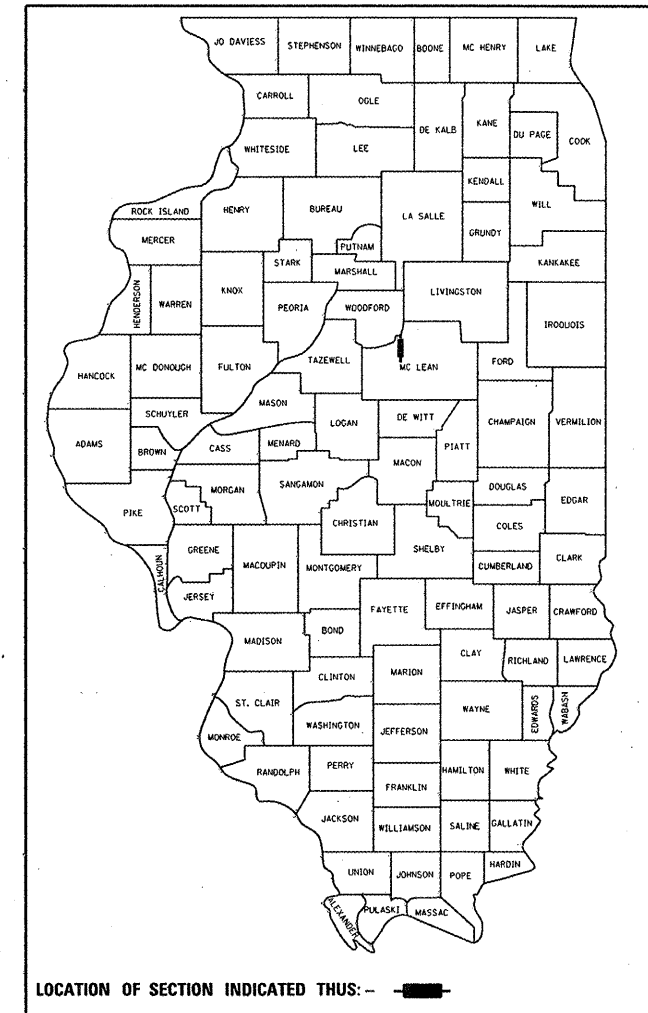

FOR INDEX OF SHEETS, SEE SHEET NO. 2
FOR SUMMARY OF QUANTITIES, SEE SHEET NO. 3 & 4

CURRENT TRAFFIC DATA

	LEG "A"	LEG "B"	LEG "C"	LEG "D"	LEG "E"
2011 ADT	11,700	14,800	19,900	18,800	17,200
P.U. %	52.1	61.5	69.9	67.9	66.4
S.U. %	6.0	5.1	4.0	4.2	4.0
M.U. %	41.9	33.4	26.1	27.9	29.6

LEG "A" IS FROM I-55 TO THE I-39 SB TO I-55 EB RAMP IN NORMAL.
LEG "B" IS FROM THE I-39 SB RAMP IN NORMAL TO US 51 BUS.
LEG "C" IS FROM US 51 BUS TO FAS 472.
LEG "D" IS FROM FAS 472 TO IL 251.
LEG "E" IS FROM IL 251 TO THE WOODFORD COUNTY LINE.

DESIGN DESIGNATION
N/A

PROJECT ENDS
STATION 557+87.88

STATION EQUATION
STA 377+24.54 (BK) =
STA 377+00.00 (AH)

BRIDGE OMISSION
SN 057-0203: 550+10.62 - 556+40.88

BRIDGE OMISSION
SN 057-0205 (NB): 341+60.22 - 345+25.49
SN 057-0206 (SB): 341+40.88 - 345+13.37

BRIDGE OMISSION
SN 057-0208 (SB): 303+74.53 - 305+83.48
SN 057-0209 (NB): 303+45.48 - 305+55.74

BRIDGE OMISSION
SN 057-0210 (NB): 291+42.55 - 292+72.66
SN 057-0211 (SB): 291+87.21 - 293+18.07

PROJECT BEGINS
STATION 41+92 I-39 NB
STATION 77+32 I-39 SB
STATION 30+00 RAMP A
STATION 10+00 RAMP B

STA. 198+61.67 RURAL
URBAN

BRIDGE OMISSION
SN 057-0216 (SB): 123+22.18 - 126+75.71
SN 057-0217 (NB): 123+24.61 - 126+77.61

BRIDGE OMISSION
SN 057-0215 (NB): 95+12.24 - 99+85.95

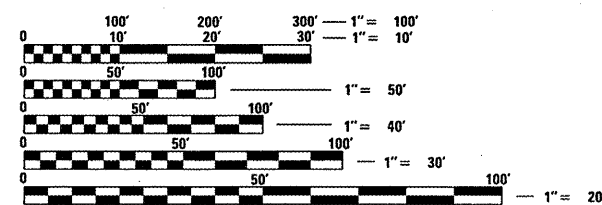

FULL SIZE PLANS HAVE BEEN PREPARED USING STANDARD ENGINEERING SCALES. REDUCED SIZED PLANS WILL NOT CONFORM TO STANDARD SCALES. IN MAKING MEASUREMENTS ON REDUCED PLANS, THE ABOVE SCALES MAY BE USED.

J.U.L.I.E.
JOINT UTILITY LOCATION INFORMATION FOR EXCAVATION
1-800-892-0123 (HUDSON & NORMAL TOWNSHIPS)
OR 811

PROJECT ENGINEER: NANCY FASIG
SQUAD LEADER: BRIAN J. HOGAN
DESIGNER: ANDREW BERGAN
(217) 465-4181
CONTRACT NO. 70973

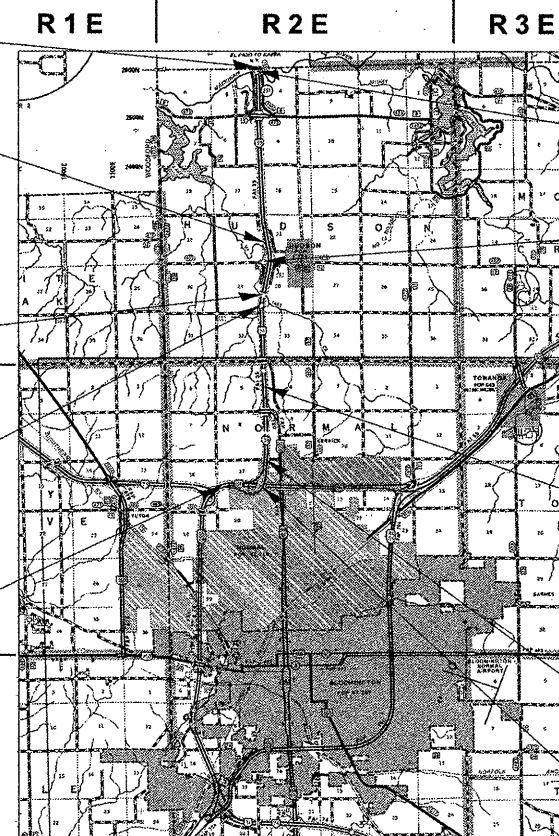

SCALE
0 5000 10000 15000 20000 25000 FEET
GROSS LENGTH = 51,620.42 FEET = 9.777 MILES
NET LENGTH = 49,457.81 FEET = 9.367 MILES

STATE OF ILLINOIS
DEPARTMENT OF TRANSPORTATION
DIVISION OF HIGHWAYS
SUBMITTED 03/23 20 12
Joseph F. Casare (CAG)
DEPUTY DIRECTOR OF HIGHWAYS, REGION ENGINEER
May 11 2012
John D. Baumgardner
ENGINEER OF DESIGN AND ENVIRONMENT
May 11 2012
William R. Freiler
DIRECTOR OF HIGHWAYS, CHIEF ENGINEER

PRINTED BY THE AUTHORITY
OF THE STATE OF ILLINOIS

INDEX OF SHEETS

SHEET NO.	DESCRIPTION
1	COVER SHEET
2	INDEX OF SHEETS
2	GENERAL NOTES
2	LIST OF STANDARDS
3-4	SUMMARY OF QUANTITIES
5-10	EXISTING TYPICAL SECTIONS
11-17	SCHEDULE OF QUANTITIES
18	P.C.C. PARTIAL DEPTH HOT-MIX ASPHALT PATCHING
19	DETAILS OF EXISTING JOINTED P.C.C. PAVEMENT (HINGE-JOINT) AND ADJACENT P.C.C. SHOULDER

HIGHWAY STANDARDS

STANDARD NUMBER	NAME OF STANDARD
000001-06	STANDARD SYMBOLS, ABBREVIATIONS AND PATTERNS
001001-02	AREAS OF REINFORCEMENT BARS
001006	DECIMAL OF AN INCH AND OF A FOOT
420001-07	PAVEMENT JOINTS
420101-04	24' (7.2m) JOINTED PCC PAVEMENT
420106-04	36' (10.8m) JOINTED PCC PAVEMENT
421001-02	BAR REINFORCEMENT FOR CRC PAVEMENT
421101-08	24' (7.2m) CRC PAVEMENT (WITH WIDE FLANGE BEAM TERMINAL JOINT)
442001-04	CLASS A PATCHES
442101-07	CLASS B PATCHES
701101-02	OFF-ROAD OPERATIONS, MULTILANE, 15' (4.5 m) TO 24" (600 mm) FROM PAVEMENT EDGE
701400-05	APPROACH TO LANE CLOSURE, FREEWAY / EXPRESSWAY
701401-06	LANE CLOSURE, FREEWAY / EXPRESSWAY
701411-08	LANE CLOSURE, MULTILANE, AT ENTRANCE OR EXIT RAMP, FOR SPEEDS \geq 45 MPH
701426-04	LANE CLOSURE, MULTILANE, INTERMITTENT OR MOVING OPERATIONS FOR SPEEDS \geq 45 MPH
701901-02	TRAFFIC CONTROL DEVICES

GENERAL NOTES

G.N.-100
ENGLISH UNITS OF MEASUREMENT SHALL GOVERN OVER AND SUPERSEDE ANY METRIC UNITS SHOWN IN THIS CONTRACT. WHERE INCLUDED, METRIC UNITS ARE FOR INFORMATION ONLY.

G.N.-100A
ELECTRONIC FILES AND/OR ELECTRONIC SURVEY INFORMATION INCLUDING CADD FILES WILL NOT BE AVAILABLE TO THE CONTRACTOR.

G.N.-406H -- MIXTURE REQUIREMENTS

Location	I-39
Mixture Use	P.D. Patch
AC/PG	PG 64-22
RAP % (Max)	10
Design Air Voids	4.0% @ Ndes=105
Mix Comp(Gradation)	IL 9.5
Friction Aggregate	Mix C

G.N.-442B -- PATCHING SCHEDULES
THE PATCHING SCHEDULES INCLUDED IN THE PLANS REPRESENT THE BEST INFORMATION AVAILABLE AT THE TIME OF COMPLETION OF THE PLANS FOR LETTING. VARIATIONS IN LOCATION AND SIZES OF BOTH FULL-DEPTH AND PARTIAL-DEPTH PATCHES MAY OCCUR.

G.N.-1004.01
COARSE AGGREGATE GRADATION CA-10 MAY BE USED WHENEVER COARSE AGGREGATE CA-6 IS SPECIFIED IN THE STANDARD SPECIFICATIONS.

NO COMMITMENTS

FILE NAME =	USER NAME = berganej	DESIGNED -	AJB	REVISED		STATE OF ILLINOIS DEPARTMENT OF TRANSPORTATION	INDEX OF SHEETS & LIST OF HIGHWAY STANDARDS	F.A.I. RTE.	SECTION	COUNTY	TOTAL SHEETS	SHEET NO.
ci:\pw_work\pwork\berga\0302063\057973-shr-gannote.dgn	DRAWN -	AJB	REVISED -		39			D5 PATCHING 2013-1	MCLEAN	19	2	
PLOT SCALE = 40.0000' / 1"	CHECKED -		REVISED -		CONTRACT NO. 70973							
PLOT DATE = 3/22/2012	DATE -	3/4/2011	REVISED -		ILLINOIS FED. AID PROJECT							
						SCALE: N/A	SHEET NO. 1 OF 1 SHEETS	STA. N/A TO STA. N/A				

SUMMARY OF QUANTITIES

LOCATION OF WORK:

FAI 39

FAI 39

URBAN

RURAL

INTERSTATE

INTERSTATE

MCLEAN COUNTY

MCLEAN COUNTY

STA 41+92.0 TO 198+61.67

STA 198+61.67 TO 557+87.88

FUNDING BREAKOUT:

100% STATE

100% STATE

CONSTRUCTION TYPE CODE:

0005

0005

CODE NO.	ITEM	UNIT	TOTAL QUANTITY	QUANTITY	QUANTITY
42001200	PAVEMENT FABRIC	SQ YD	100.0	70.0	30.0
44022029	PARTIAL DEPTH REMOVAL 3"	SQ YD	85.0	50.0	35.0
44200549	CLASS A PATCHES , TYPE I, 10 INCH	SQ YD	325.0	0.0	325.0
44200553	CLASS A PATCHES , TYPE II, 10 INCH	SQ YD	875.0	0.0	875.0
44200557	CLASS A PATCHES , TYPE III, 10 INCH	SQ YD	100.0	0.0	100.0
44200559	CLASS A PATCHES , TYPE IV, 10 INCH	SQ YD	275.0	0.0	275.0
44200982	CLASS B PATCHES , TYPE II, 11INCH	SQ YD	225.0	120.0	105.0
44200986	CLASS B PATCHES , TYPE III, 11 INCH	SQ YD	100.0	70.0	30.0
44201299	DOWEL BARS 11/2"	EACH	575.0	350.0	225.0
44213000	PATCHING REINFORCEMENT	SQ YD	1,575.0	0.0	1575.0
44213200	SAW CUTS	FOOT	12,950.0	1005.0	11945.0
44213204	TIE BARS 3/4"	EACH	575.0	0.0	575.0
67100100	MOBILIZATION	L SUM	1.0	0.3	0.7
70100420	TRAFFIC CONTROL AND PRTECTION, STANDARD 701411	EACH	13.0	8.0	5.0

* DENOTES SPECIALTY ITEM

FILE NAME =	USER NAME = bergana	DESIGNED - AJB	REVISED	STATE OF ILLINOIS DEPARTMENT OF TRANSPORTATION	SUMMARY OF QUANTITIES	F.A.I. RTE.	SECTION	COUNTY	TOTAL SHEETS	SHEET NO.
c:\pwwork\pwwork\bergena\09302063\0570973-sh.t-S00.dgn	DRAWN - AJB	REVISED -	39			D5 PATCHING 2013-1	MCLEAN	19	3	
PLOT SCALE = 40.0000' / 1"	CHECKED -	REVISED -	SCALE: N/A SHEET NO. 1 OF 2 SHEETS STA. N/A TO STA. N/A			CONTRACT NO. 70973				
PLOT DATE = 3/22/2012	DATE - 3/12/2012	REVISED -	ILLINOIS FED. AID PROJECT							

EXISTING TYPICAL SECTION F.A.I. 39

I-39 /-55 INTERCHANGE

TYPICAL I-39 RAMPS AND I-39 MAINLINE WITH AUXILIARY LANE

STA. 41+92.00 I-39 NB TO STA. 110+00.00 I-39 NB

STA. 77+32.00 I-39 SB TO STA. 110+00.00 I-39 SB

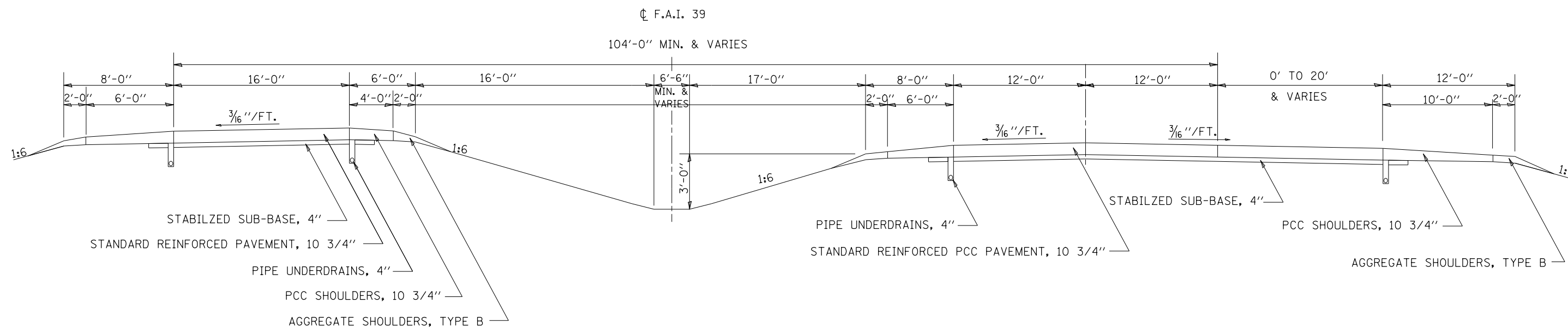

FILE NAME =	USER NAME = bergenej	DESIGNED -	AJB	REVISED -	_____
et:\pwork\pwork\bergenej\0302063\0570973-sht-typicel.dgn		DRAWN -	AJB	REVISED -	_____
	PLOT SCALE = 40.0000' / in.	CHECKED -		REVISED -	_____
	PLOT DATE = 3/22/2012	DATE -	3/12/2012	REVISED -	_____

STATE OF ILLINOIS
DEPARTMENT OF TRANSPORTATION

EXISTING TYPICAL SECTION

SCALE: N/A SHEET NO. 1 OF 6 SHEETS STA. N/A TO STA. N/A

F.A.I. RTE.	SECTION	COUNTY	TOTAL SHEETS	SHEET NO.
39	D5 PATCHING 2013-1	MCLEAN	19	5
CONTRACT NO. 70973				
ILLINOIS FED. AID PROJECT				

EXISTING TYPICAL SECTION F.A.I. 39

STA. 110 + 00.00 TO STA. 144 + 50.00

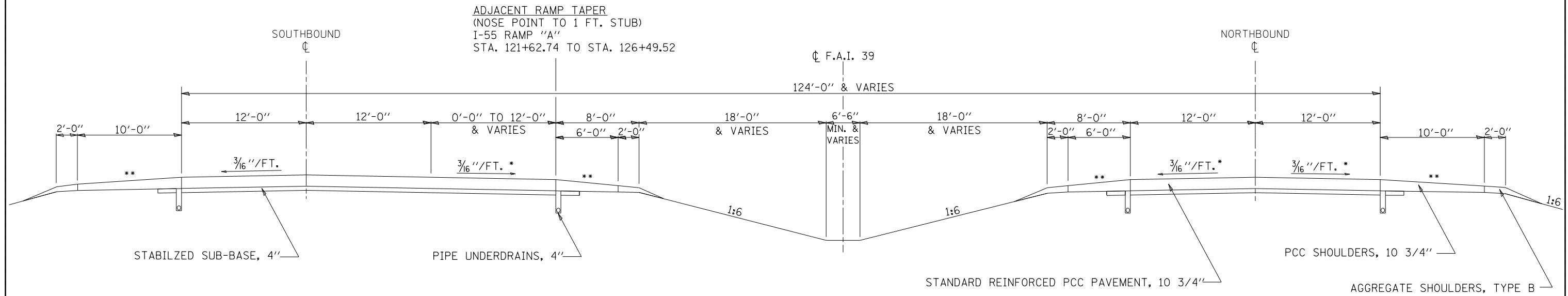

- * SLOPE VARIES FOR SUPERELEVATION IN CURVES
- ** SLOPE VARIES IN SUPERELEVATION WITH MAXIMUM OF 0.08 FT/FT DIFFERENCE

FILE NAME =	USER NAME = bergana.j	DESIGNED -	AJB	REVISED -	_____
et:\pwork\pwork\berganaj\0302063\0570973-sht-typical.dgn		DRAWN -	AJB	REVISED -	_____
	PLOT SCALE = 40.0000' / in.	CHECKED -		REVISED -	_____
	PLOT DATE = 3/22/2012	DATE -	3/12/2012	REVISED -	_____

STATE OF ILLINOIS
DEPARTMENT OF TRANSPORTATION

EXISTING TYPICAL SECTION

SCALE: N/A SHEET NO. 2 OF 6 SHEETS STA. N/A TO STA. N/A

F.A.I. RTE.	SECTION	COUNTY	TOTAL SHEETS	SHEET NO.
39	D5 PATCHING 2013-1	MCLEAN	19	6
CONTRACT NO. 70973				
ILLINOIS FED. AID PROJECT				

EXISTING TYPICAL SECTION F.A.I. 39

STA. 144 + 50.00 TO STA. 235 + 00.00

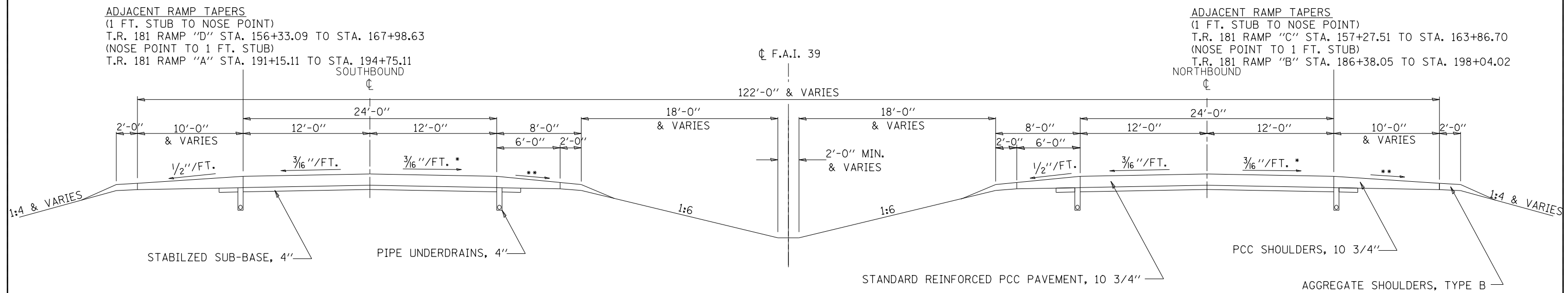

- * SLOPE VARIES FOR SUPERELEVATION IN CURVES
- ** SLOPE VARIES IN SUPERELEVATION WITH MAXIMUM OF 0.08 FT/FT DIFFERENCE

FILE NAME =	USER NAME = berganaj	DESIGNED -	AJB	REVISED -	_____
et:\pwork\pwork\berganaj\0302063\0570973-sht-typicel.dgn		DRAWN -	AJB	REVISED -	_____
	PLOT SCALE = 40.0000' / in.	CHECKED -	_____	REVISED -	_____
	PLOT DATE = 3/22/2012	DATE -	3/12/2012	REVISED -	_____

STATE OF ILLINOIS
DEPARTMENT OF TRANSPORTATION

EXISTING TYPICAL SECTION

SCALE: N/A SHEET NO. 3 OF 6 SHEETS STA. N/A TO STA. N/A

F.A.I. RTE.	SECTION	COUNTY	TOTAL SHEETS	SHEET NO.
39	D5 PATCHING 2013-1	MCLEAN	19	7
ILLINOIS FED. AID PROJECT			CONTRACT NO. 70973	

EXISTING TYPICAL SECTION F.A.I. 39

STA. 235 + 00.00 TO STA. 377 + 24.54

STATION EQUATION

STA. 377 + 24.54 (BK.) =

STA. 377 + 00.00 (AH.)

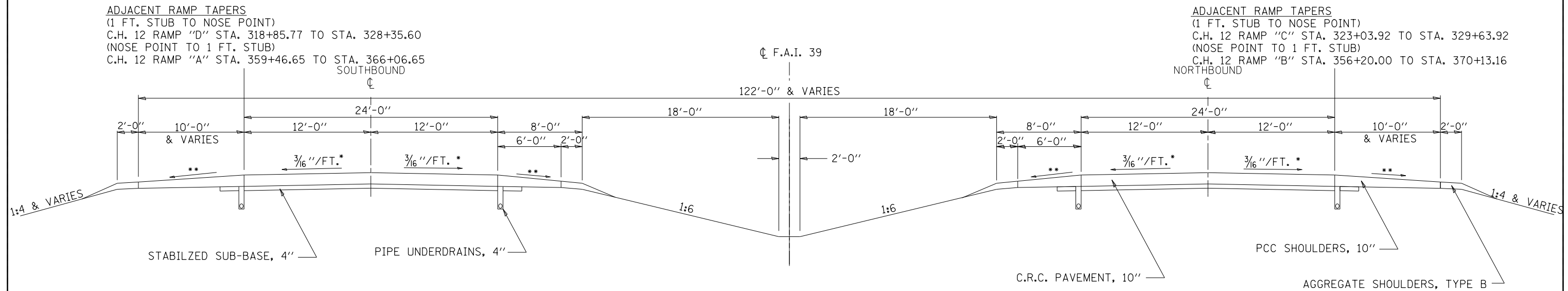

- * SLOPE VARIES FOR SUPERELEVATION IN CURVES
- ** SLOPE VARIES IN SUPERELEVATION WITH MAXIMUM OF 0.08 FT/FT DIFFERENCE

FILE NAME =	USER NAME = bergenej	DESIGNED -	AJB	REVISED -	_____
et:\pwork\pwork\bergenej\0302063\0570973-shr-typical.dgn		DRAWN -	AJB	REVISED -	_____
	PLOT SCALE = 40.0000' / in.	CHECKED -	_____	REVISED -	_____
	PLOT DATE = 3/22/2012	DATE -	3/12/2012	REVISED -	_____

STATE OF ILLINOIS
DEPARTMENT OF TRANSPORTATION

EXISTING TYPICAL SECTION

SCALE: N/A SHEET NO. 4 OF 6 SHEETS STA. N/A TO STA. N/A

F.A.I. RTE.	SECTION	COUNTY	TOTAL SHEETS	SHEET NO.
39	D5 PATCHING 2013-1	MCLEAN	19	8
ILLINOIS FED. AID PROJECT			CONTRACT NO. 70973	

EXISTING TYPICAL SECTION F.A.I. 39

STA. 377 + 00.00 TO STA. 511 + 11.00

STATION EQUATION

STA. 377 + 24.54 (BK.) =
STA. 377 + 00.00 (AH.)

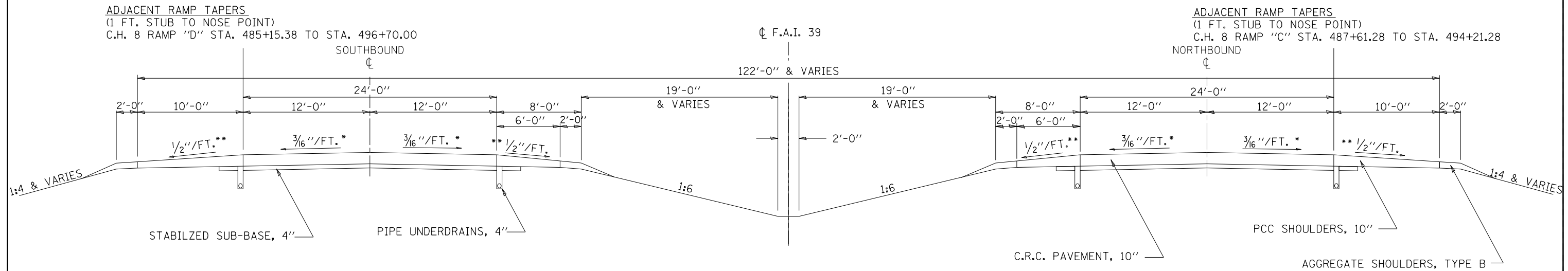

* SLOPE VARIES FOR SUPERELEVATION IN CURVES

** SLOPE VARIES IN SUPERELEVATION WITH MAXIMUM OF 0.08 FT/FT DIFFERENCE

FILE NAME =	USER NAME = bergenej	DESIGNED -	AJB	REVISED -	_____
et:\pwork\pwork\bergenej\0302063\0570973-sht-typical.dgn		DRAWN -	AJB	REVISED -	_____
	PLOT SCALE = 40.0000' / in.	CHECKED -		REVISED -	_____
	PLOT DATE = 3/22/2012	DATE -	3/12/2012	REVISED -	_____

STATE OF ILLINOIS
DEPARTMENT OF TRANSPORTATION

EXISTING TYPICAL SECTION

SCALE: N/A SHEET NO. 5 OF 6 SHEETS STA. N/A TO STA. N/A

F.A.I. RTE.	SECTION	COUNTY	TOTAL SHEETS	SHEET NO.
39	D5 PATCHING 2013-1	MCLEAN	19	9
CONTRACT NO. 70973				
ILLINOIS FED. AID PROJECT				

EXISTING TYPICAL SECTION F.A.I. 39

STA. 511 + 11.00 TO STA. 557 + 87.88

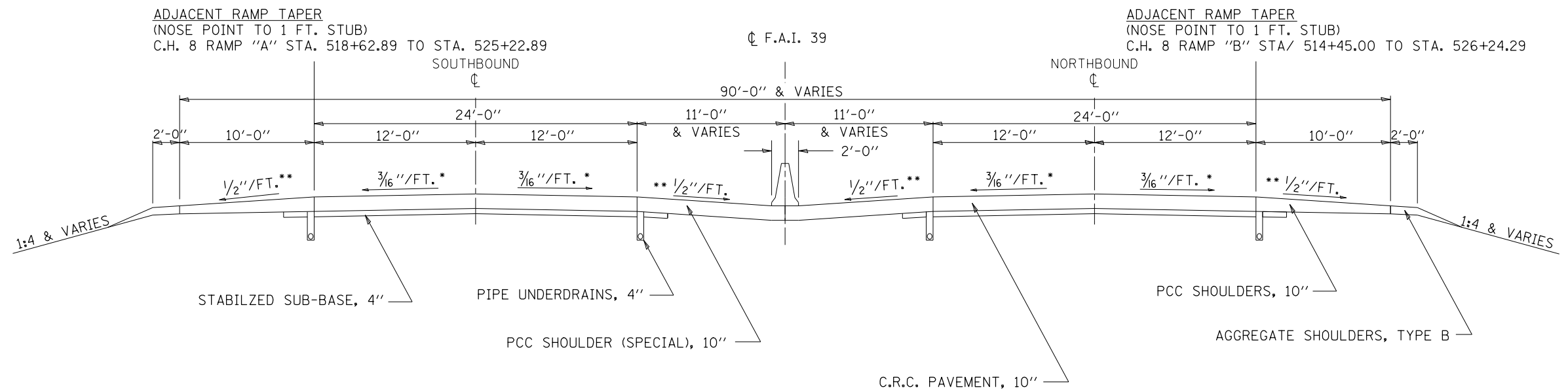

- * SLOPE VARIES FOR SUPERELEVATION IN CURVES
- ** SLOPE VARIES IN SUPERELEVATION WITH MAXIMUM OF 0.08 FT/FT DIFFERENCE

FILE NAME =	USER NAME = bergenej	DESIGNED - AJB	REVISED - _____
et:\pwork\pwork\bergenej\d0302063\0570973-sht-typical.dgn		DRAWN - AJB	REVISED - _____
		CHECKED - _____	REVISED - _____
		DATE - 3/12/2012	REVISED - _____

**STATE OF ILLINOIS
DEPARTMENT OF TRANSPORTATION**

EXISTING TYPICAL SECTION

SCALE: N/A SHEET NO. 6 OF 6 SHEETS STA. N/A TO STA. N/A

F.A.I. RTE.	SECTION	COUNTY	TOTAL SHEETS	SHEET NO.
39	D5 PATCHING 2013-1	MCLEAN	19	10
CONTRACT NO. 70973				
ILLINOIS FED. AID PROJECT				

SCHEDULE OF QUANTITIES

CLASS A PATCH 10" I 39 MAINLINE NORTHBOUND											
STATION	LOCATION	LANE	LENGTH	WIDTH	TYPE I	TYPE II	TYPE III	TYPE IV	SAWCUTS	TIE BARS 3/4"	PATCHING REINFORCEMENT
			(FT)	(FT)	44200549 (SQ. YD.)	44200553 (SQ. YD.)	44200557 (SQ. YD.)	44200559 (SQ. YD.)	44213200 (FT)	44213204 (EACH)	44213000 (SQ. YD.)
236+72	I-39 MAINLINE (RURAL)	NBDL	6.0	6.0	4.0				42.0		4.0
239+81	I-39 MAINLINE (RURAL)	NBDL	6.0	6.0	4.0				42.0		4.0
241+00	I-39 MAINLINE (RURAL)	NBDL	6.0	12.0		8.0			66.0		8.0
242+96	I-39 MAINLINE (RURAL)	NBDL	8.0	6.0		5.3			48.0		5.3
246+71	I-39 MAINLINE (RURAL)	NBDL	6.0	6.0	4.0				42.0		4.0
249+00	I-39 MAINLINE (RURAL)	NBDL	6.0	12.0		8.0			66.0		8.0
249+18	I-39 MAINLINE (RURAL)	NBDL	8.0	6.0		5.3			48.0		5.3
253+50	I-39 MAINLINE (RURAL)	NBDL	6.0	6.0	4.0				42.0		4.0
256+00	I-39 MAINLINE (RURAL)	NBDL	6.0	6.0	4.0				42.0		4.0
256+20	I-39 MAINLINE (RURAL)	NBDL	30.0	6.0			20.0		114.0	30.0	20.0
256+88	I-39 MAINLINE (RURAL)	NBDL	10.0	12.0		13.3			78.0		13.3
256+55	I-39 MAINLINE (RURAL)	NBDL	30.0	6.0			20.0		114.0	30.0	20.0
258+15	I-39 MAINLINE (RURAL)	NBDL	6.0	6.0	4.0				42.0		4.0
262+00	I-39 MAINLINE (RURAL)	NBDL	40.0	6.0				26.7	144.0	40.0	26.7
263+40	I-39 MAINLINE (RURAL)	NBDL	15.0	6.0		10.0			69.0		10.0
264+60	I-39 MAINLINE (RURAL)	NBDL	20.0	12.0				26.7	108.0	20.0	26.7
269+20	I-39 MAINLINE (RURAL)	NBDL	6.0	6.0	4.0				42.0		4.0
270+45	I-39 MAINLINE (RURAL)	NBDL	8.0	6.0		5.3			48.0		5.3
272+50	I-39 MAINLINE (RURAL)	NBDL	6.0	12.0		8.0			66.0		8.0
274+00	I-39 MAINLINE (RURAL)	NBDL	6.0	6.0	4.0				42.0		4.0
274+40	I-39 MAINLINE (RURAL)	NBDL	6.0	6.0	4.0				42.0		4.0
274+60	I-39 MAINLINE (RURAL)	NBDL	6.0	6.0	4.0				42.0		4.0
274+80	I-39 MAINLINE (RURAL)	NBDL	6.0	6.0	4.0				42.0		4.0
275+30	I-39 MAINLINE (RURAL)	NBDL	6.0	6.0	4.0				42.0		4.0
275+36	I-39 MAINLINE (RURAL)	NBDL	6.0	6.0	4.0				42.0		4.0
275+40	I-39 MAINLINE (RURAL)	NBDL	6.0	12.0		8.0			66.0		8.0
277+86	I-39 MAINLINE (RURAL)	NBDL	6.0	6.0	4.0				42.0		4.0
277+96	I-39 MAINLINE (RURAL)	NBDL	6.0	12.0		8.0			66.0		8.0
279+10	I-39 MAINLINE (RURAL)	NBDL	6.0	12.0		8.0			66.0		8.0
281+40	I-39 MAINLINE (RURAL)	NBDL	6.0	6.0	4.0				42.0		4.0
281+80	I-39 MAINLINE (RURAL)	NBDL	6.0	6.0	4.0				42.0		4.0
282+46	I-39 MAINLINE (RURAL)	NBDL	6.0	12.0		8.0			66.0		8.0
282+70	I-39 MAINLINE (RURAL)	NBDL	6.0	6.0	4.0				42.0		4.0
282+83	I-39 MAINLINE (RURAL)	NBDL	6.0	6.0	4.0				42.0		4.0
283+30	I-39 MAINLINE (RURAL)	NBDL	6.0	6.0	4.0				42.0		4.0
283+60	I-39 MAINLINE (RURAL)	NBDL	6.0	6.0	4.0				42.0		4.0
284+97	I-39 MAINLINE (RURAL)	NBDL	8.0	12.0		10.7			72.0		10.7
285+71	I-39 MAINLINE (RURAL)	NBDL	6.0	6.0	4.0				42.0		4.0
286+42	I-39 MAINLINE (RURAL)	NBDL	6.0	6.0	4.0				42.0		4.0
287+18	I-39 MAINLINE (RURAL)	NBDL	6.0	6.0	4.0				42.0		4.0
287+38	I-39 MAINLINE (RURAL)	NBDL	6.0	6.0	4.0				42.0		4.0
287+45	I-39 MAINLINE (RURAL)	NBDL	6.0	6.0	4.0				42.0		4.0
287+60	I-39 MAINLINE (RURAL)	NBDL	6.0	6.0	4.0				42.0		4.0
289+05	I-39 MAINLINE (RURAL)	NBDL	6.0	12.0		8.0			66.0		8.0
297+42	I-39 MAINLINE (RURAL)	NBDL	6.0	12.0		8.0			66.0		8.0
NORTHBOUND SUBTOTALS OF CLASS A PATCH, 10 INCH					104.0	122.0	40.0	53.3	2529.0	120.0	319.3

NOTE:

PATCHING QUANTITIES IN ADDITION TO THOSE SHOWN IN THE SCHEDULES HAVE BEEN INCLUDED IN THE SUMMARY OF QUANTITIES, TO BE PLACED AT LOCATIONS DETERMINED BY THE ENGINEER.

FILE NAME =	USER NAME = bergana_j	DESIGNED -	AJB	REVISED	STATE OF ILLINOIS DEPARTMENT OF TRANSPORTATION	SCHEDULE OF QUANTITIES			F.A.I. RTE.	SECTION	COUNTY	TOTAL SHEETS	SHEET NO.
		DRAWN -	AJB	REVISED -		39	D5 PATCHING 2013-1	MCLEAN	19	11			
		CHECKED -		REVISED -		CONTRACT NO. 70973			ILLINOIS FED. AID PROJECT				
		DATE -	3/12/2012	REVISED -		SCALE: N/A	SHEET NO. 1 OF 7 SHEETS	STA. N/A	TO STA. N/A				

SCHEDULE OF QUANTITIES

CLASS A PATCH 10" I 39 MAINLINE NORTHBOUND											
STATION	LOCATION	LANE	LENGTH	WIDTH	TYPE I	TYPE II	TYPE III	TYPE IV	SAWCUTS	TIE BARS 3/4"	PATCHING REINFORCEMENT
			(FT)	(FT)	44200549 (SQ. YD.)	44200553 (SQ. YD.)	44200557 (SQ. YD.)	44200559 (SQ. YD.)	44213200 (FT)	44213204 (EACH)	44213000 (SQ. YD.)
299+74	I-39 MAINLINE (RURAL)	NBDL	20.0	12.0				26.7	108.0	20.0	26.7
301+14	I-39 MAINLINE (RURAL)	NBDL	6.0	12.0		8.0			66.0		8.0
308+63	I-39 MAINLINE (RURAL)	NBDL	6.0	12.0		8.0			66.0		8.0
310+00	I-39 MAINLINE (RURAL)	NBDL	6.0	6.0	4.0				42.0		4.0
311+14	I-39 MAINLINE (RURAL)	NBDL	8.0	12.0		10.7			72.0		10.7
314+26	I-39 MAINLINE (RURAL)	NBDL	6.0	12.0		8.0			66.0		8.0
317+09	I-39 MAINLINE (RURAL)	NBDL	10.0	12.0		13.3			78.0		13.3
322+30	I-39 MAINLINE (RURAL)	NBDL	6.0	6.0	4.0				42.0		4.0
324+18	I-39 MAINLINE (RURAL)	NBDL	6.0	6.0	4.0				42.0		4.0
325+34	I-39 MAINLINE (RURAL)	NBDL	8.0	12.0		10.7			72.0		10.7
326+29	I-39 MAINLINE (RURAL)	NBDL	6.0	6.0	4.0				42.0		4.0
327+47	I-39 MAINLINE (RURAL)	NBDL	6.0	6.0	4.0				42.0		4.0
328+69	I-39 MAINLINE (RURAL)	NBDL	6.0	6.0	4.0				42.0		4.0
329+49	I-39 MAINLINE (RURAL)	NBDL	10.0	12.0		13.3			78.0		13.3
330+61	I-39 MAINLINE (RURAL)	NBDL	6.0	6.0	4.0				42.0		4.0
333+06	I-39 MAINLINE (RURAL)	NBDL	6.0	6.0	4.0				42.0		4.0
335+91	I-39 MAINLINE (RURAL)	NBDL	6.0	6.0	4.0				42.0		4.0
337+47	I-39 MAINLINE (RURAL)	NBDL	6.0	6.0	4.0				42.0		4.0
339+90	I-39 MAINLINE (RURAL)	NBDL	10.0	12.0		13.3			78.0		13.3
341+71	I-39 MAINLINE (RURAL)	NBDL	25.0	6.0			16.7		99.0	25.0	16.7
345+63	I-39 MAINLINE (RURAL)	NBDL	6.0	6.0	4.0				42.0		4.0
347+16	I-39 MAINLINE (RURAL)	NBDL	8.0	6.0		5.3			48.0		5.3
349+54	I-39 MAINLINE (RURAL)	NBDL	6.0	12.0		8.0			66.0		8.0
351+08	I-39 MAINLINE (RURAL)	NBDL	6.0	6.0	4.0				42.0		4.0
352+50	I-39 MAINLINE (RURAL)	NBDL	10.0	6.0		6.7			54.0		6.7
362+00	I-39 MAINLINE (RURAL)	NBDL	10.0	6.0		6.7			54.0		6.7
363+11	I-39 MAINLINE (RURAL)	NBDL	6.0	6.0	4.0				42.0		4.0
364+54	I-39 MAINLINE (RURAL)	NBDL	6.0	6.0	4.0				42.0		4.0
365+87	I-39 MAINLINE (RURAL)	NBDL	6.0	6.0	4.0				42.0		4.0
366+13	I-39 MAINLINE (RURAL)	NBDL	6.0	6.0	4.0				42.0		4.0
366+97	I-39 MAINLINE (RURAL)	NBDL	6.0	6.0	4.0				42.0		4.0
367+49	I-39 MAINLINE (RURAL)	NBDL	10.0	12.0		13.3			78.0		13.3
368+82	I-39 MAINLINE (RURAL)	NBDL	10.0	6.0		6.7			54.0		6.7
369+91	I-39 MAINLINE (RURAL)	NBDL	10.0	6.0		6.7			54.0		6.7
371+33	I-39 MAINLINE (RURAL)	NBDL	6.0	6.0	4.0				42.0		4.0
372+70	I-39 MAINLINE (RURAL)	NBDL	6.0	6.0	4.0				42.0		4.0
380+50	I-39 MAINLINE (RURAL)	NBDL	12.0	6.0		8.0			60.0		8.0
471+45	I-39 MAINLINE (RURAL)	NBDL	6.0	6.0	4.0				42.0		4.0
471+51	I-39 MAINLINE (RURAL)	NBDL	6.0	6.0	4.0				42.0		4.0
471+70	I-39 MAINLINE (RURAL)	NBDL	6.0	12.0		8.0			66.0		8.0
472+56	I-39 MAINLINE (RURAL)	NBDL	6.0	6.0	4.0				42.0		4.0
476+10	I-39 MAINLINE (RURAL)	NBDL	6.0	6.0	4.0				42.0		4.0
NORTHBOUND SUBTOTALS OF CLASS A PATCH, 10 INCH					92.0	154.7	16.7	26.7	2283.0	45.0	290.0
NORTHBOUND SUBTOTALS OF CLASS A PATCH, 10 INCH TOTALS					196.0	276.7	56.7	80.0	4812.0	165.0	609.3

NOTE:

PATCHING QUANTITIES IN ADDITION TO THOSE SHOWN IN THE SCHEDULES HAVE BEEN INCLUDED IN THE SUMMARY OF QUANTITIES, TO BE PLACED AT LOCATIONS DETERMINED BY THE ENGINEER.

SCHEDULE OF QUANTITIES

CLASS A PATCH 10" I 39 MAINLINE SOUTHBOUND											
STATION	LOCATION	LANE	LENGTH	WIDTH	TYPE I	TYPE II	TYPE III	TYPE IV	SAWCUTS	TIE BARS 3/4"	PATCHING REINFORCEMENT
			(FT)	(FT)	44200549 (SQ. YD.)	44200553 (SQ. YD.)	44200557 (SQ. YD.)	44200559 (SQ. YD.)	44213200 (FT)	44213204 (EACH)	44213000 (SQ. YD.)
236+25	I-39 MAINLINE (RURAL)	SBDL	10.0	6.0		6.7			54.0		6.7
237+50	I-39 MAINLINE (RURAL)	SBDL	10.0	6.0		6.7			54.0		6.7
237+60	I-39 MAINLINE (RURAL)	SBDL	15.0	6.0		10.0			69.0		10.0
239+35	I-39 MAINLINE (RURAL)	SBDL	25.0	6.0			16.7		99.0	25.0	16.7
239+40	I-39 MAINLINE (RURAL)	SBDL	10.0	12.0		13.3			78.0		13.3
239+50	I-39 MAINLINE (RURAL)	SBDL	20.0	6.0		13.3			84.0	20.0	13.3
241+00	I-39 MAINLINE (RURAL)	SBDL	15.0	6.0		10.0			69.0		10.0
242+70	I-39 MAINLINE (RURAL)	SBDL	6.0	6.0	4.0				42.0		4.0
243+50	I-39 MAINLINE (RURAL)	SBDL	6.0	6.0	4.0				42.0		4.0
246+90	I-39 MAINLINE (RURAL)	SBDL	6.0	12.0		8.0			66.0		8.0
247+00	I-39 MAINLINE (RURAL)	SBDL	6.0	12.0		8.0			66.0		8.0
248+50	I-39 MAINLINE (RURAL)	SBPL	40.0	6.0				26.7	144.0	40.0	26.7
253+00	I-39 MAINLINE (RURAL)	SBDL	15.0	6.0		10.0			69.0		10.0
254+50	I-39 MAINLINE (RURAL)	SBDL	6.0	12.0		8.0			66.0		8.0
258+13	I-39 MAINLINE (RURAL)	SBDL	6.0	12.0		8.0			66.0		8.0
260+00	I-39 MAINLINE (RURAL)	SBDL	6.0	6.0	4.0				42.0		4.0
278+50	I-39 MAINLINE (RURAL)	SBDL	6.0	6.0	4.0				42.0		4.0
279+00	I-39 MAINLINE (RURAL)	SBDL	6.0	6.0	4.0				42.0		4.0
280+15	I-39 MAINLINE (RURAL)	SBDL	6.0	12.0		8.0			66.0		8.0
282+60	I-39 MAINLINE (RURAL)	SBDL	6.0	6.0	4.0				42.0		4.0
284+75	I-39 MAINLINE (RURAL)	SBDL	30.0	6.0			20.0		114.0	30.0	20.0
285+00	I-39 MAINLINE (RURAL)	SBDL	20.0	6.0		13.3			84.0	20.0	13.3
286+00	I-39 MAINLINE (RURAL)	SBDL	6.0	6.0	4.0				42.0		4.0
289+00	I-39 MAINLINE (RURAL)	SBDL	8.0	6.0		5.3			48.0		5.3
290+00	I-39 MAINLINE (RURAL)	SBDL	15.0	6.0		10.0			69.0		10.0
302+06	I-39 MAINLINE (RURAL)	SBDL	6.0	12.0		8.0			66.0		8.0
312+60	I-39 MAINLINE (RURAL)	SBDL	10.0	12.0		13.3			78.0		13.3
317+65	I-39 MAINLINE (RURAL)	SBDL	70.0	6.0				46.7	234.0	70.0	46.7
318+50	I-39 MAINLINE (RURAL)	SBDL	6.0	6.0	4.0				42.0		4.0
325+50	I-39 MAINLINE (RURAL)	SBDL	20.0	6.0		13.3			84.0	20.0	13.3
327+15	I-39 MAINLINE (RURAL)	SBDL	10.0	12.0		13.3			78.0		13.3
331+15	I-39 MAINLINE (RURAL)	SBDL	6.0	12.0		8.0			66.0		8.0
334+90	I-39 MAINLINE (RURAL)	SBDL	8.0	6.0		5.3			48.0		5.3
336+50	I-39 MAINLINE (RURAL)	SBDL	6.0	6.0	4.0				42.0		4.0
338+16	I-39 MAINLINE (RURAL)	SBDL	6.0	12.0		8.0			66.0		8.0
343+86	I-39 MAINLINE (RURAL)	SBDL	6.0	12.0		8.0			66.0		8.0
346+81	I-39 MAINLINE (RURAL)	SBDL	20.0	12.0				26.7	108.0	20.0	26.7
350+50	I-39 MAINLINE (RURAL)	SBDL	6.0	6.0	4.0				42.0		4.0
351+25	I-39 MAINLINE (RURAL)	SBDL	10.0	12.0		13.3			78.0		13.3
352+16	I-39 MAINLINE (RURAL)	SBDL	20.0	6.0		13.3			84.0	20.0	13.3
352+94	I-39 MAINLINE (RURAL)	SBDL	6.0	6.0	4.0				42.0		4.0
353+42	I-39 MAINLINE (RURAL)	SBDL	8.0	6.0		5.3			48.0		5.3
354+16	I-39 MAINLINE (RURAL)	SBDL	15.0	6.0		10.0			69.0		10.0
355+17	I-39 MAINLINE (RURAL)	SBDL	10.0	12.0		13.3			78.0		13.3
356+74	I-39 MAINLINE (RURAL)	SBDL	6.0	6.0	4.0				42.0		4.0
SOUTHBOUND SUBTOTALS OF CLASS A PATCH, 10 INCH					48.0	271.0	36.7	100.0	3120.0	265.0	456.0

NOTE:

PATCHING QUANTITIES IN ADDITION TO THOSE SHOWN IN THE SCHEDULES HAVE BEEN INCLUDED IN THE SUMMARY OF QUANTITIES, TO BE PLACED AT LOCATIONS DETERMINED BY THE ENGINEER.

FILE NAME =	USER NAME = bergana_j	DESIGNED -	AJB	REVISED	STATE OF ILLINOIS DEPARTMENT OF TRANSPORTATION	SCHEDULE OF QUANTITIES			F.A.I. RTE.	SECTION	COUNTY	TOTAL SHEETS	SHEET NO.	
		DRAWN -	AJB	REVISED -						39	D5 PATCHING 2013-1	MCLEAN	19	13
		PLOT SCALE =	40.0000' / in.	CHECKED -			SCALE: N/A	SHEET NO. 3 OF 7 SHEETS	STA. N/A	TO STA. N/A	CONTRACT NO. 70973			
		PLOT DATE =	3/22/2012	DATE -		3/12/2012					ILLINOIS FED. AID PROJECT			

SCHEDULE OF QUANTITIES

CLASS B PATCH 11" I 39 MAINLINE NORTHBOUND												
STATION	LOCATION	LANE	LENGTH	WIDTH	TYPE I	TYPE II	TYPE III	TYPE IV	DOWEL BARS	SAWCUTS	TIE BARS 3/4"	PAVEMENT FABRIC
			(FT)	(FT)	44200549 (SQ. YD.)	44200553 (SQ. YD.)	44200557 (SQ. YD.)	44200559 (SQ. YD.)	44201299 (EACH)	44213200 (FT)	44213204 (EACH)	42001200 (sq. yd)
115+23	I-39 MAINLINE (URBAN)	NBDL	15.0	12.0			20.0		20.0	81.0		20.0
152+19	I-39 MAINLINE (URBAN)	NBDL	6.0	12.0		8.0			20.0	54.0		
164+51	I-39 MAINLINE (URBAN)	NBDL	10.0	12.0		13.3			20.0	66.0		
186+90	I-39 MAINLINE (URBAN)	NBDL	6.0	12.0		8.0			20.0	54.0		
204+87	I-39 MAINLINE (RURAL)	NBDL	6.0	12.0		8.0			20.0	54.0		
230+75	I-39 MAINLINE (RURAL)	NBDL	6.0	12.0		8.0			20.0	54.0		
NORTHBOUND SUBTOTALS OF CLASS B PATCH, 11 INCH						45.3	20.0		120.0	363.0		20.0

CLASS B PATCH 11" I 39 MAINLINE SOUTHBOUND												
STATION	LOCATION	LANE	LENGTH	WIDTH	TYPE I	TYPE II	TYPE III	TYPE IV	DOWEL BARS	SAWCUTS	TIE BARS 3/4"	PAVEMENT FABRIC
			(FT)	(FT)	44200549 (SQ. YD.)	44200553 (SQ. YD.)	44200557 (SQ. YD.)	44200559 (SQ. YD.)	44201299 (EACH)	44213200 (FT)	44213204 (EACH)	42001200 (sq. yd)
114+90	I-39 MAINLINE (URBAN)	SBDL	15.0	12.0			20.0		20.0	81.0		20.0
127+25	I-39 MAINLINE (URBAN)	SBDL	6.0	12.0		8.0			20.0	54.0		
127+25	I-39 MAINLINE (URBAN)	SBPL	6.0	12.0		8.0			20.0	54.0		
137+65	I-39 MAINLINE (URBAN)	SBDL	6.0	12.0		8.0			20.0	54.0		
137+95	I-39 MAINLINE (URBAN)	SBDL	6.0	12.0		8.0			20.0	54.0		
146+00	I-39 MAINLINE (URBAN)	SBDL	6.0	12.0		8.0			20.0	54.0		
147+65	I-39 MAINLINE (URBAN)	SBDL	6.0	12.0		8.0			20.0	54.0		
148+55	I-39 MAINLINE (URBAN)	SBDL	6.0	12.0		8.0			20.0	54.0		
156+75	I-39 MAINLINE (URBAN)	SBDL	6.0	12.0		8.0			20.0	54.0		
158+65	I-39 MAINLINE (URBAN)	SBDL	6.0	12.0		8.0			20.0	54.0		
175+10	I-39 MAINLINE (URBAN)	SBDL	12.0	12.0			16.0		20.0	72.0		16.0
186+95	I-39 MAINLINE (URBAN)	SBDL	6.0	12.0		8.0			20.0	54.0		
187+80	I-39 MAINLINE (URBAN)	SBDL	6.0	12.0		8.0			20.0	54.0		
205+90	I-39 MAINLINE (RURAL)	SBDL	6.0	12.0		8.0			20.0	54.0		
210+90	I-39 MAINLINE (RURAL)	SBDL	15.0	12.0			20.0		20.0	81.0		20.0
215+50	I-39 MAINLINE (RURAL)	SBDL	10.0	12.0		13.3			20.0	66.0		
220+30	I-39 MAINLINE (RURAL)	SBDL	6.0	12.0		8.0			20.0	54.0		
222+85	I-39 MAINLINE (RURAL)	SBPL	6.0	12.0		8.0			20.0	54.0		
224+55	I-39 MAINLINE (RURAL)	SBDL	6.0	12.0		8.0			20.0	54.0		
225+15	I-39 MAINLINE (RURAL)	SBDL	6.0	12.0		8.0			20.0	54.0		
234+25	I-39 MAINLINE (RURAL)	SBPL	6.0	12.0		8.0			20.0	54.0		
235+00	I-39 MAINLINE (RURAL)	SBPL	10.0	12.0		13.3			20.0	66.0		
SOUTHBOUND SUBTOTALS OF CLASS B PATCH, 11 INCH						162.7	56.0		440.0	1284.0		56.0

NOTE:

PATCHING QUANTITIES IN ADDITION TO THOSE SHOWN IN THE SCHEDULES HAVE BEEN INCLUDED IN THE SUMMARY OF QUANTITIES, TO BE PLACED AT LOCATIONS DETERMINED BY THE ENGINEER.

SCHEDULE OF QUANTITIES

PARTIAL DEPTH PATCHING I 39 MAINLINE NORTHBOUND						
STATION	LOCATION	LANE	LENGTH	WIDTH	PARTIAL DEPTH REMOVAL 3"	PARTIAL DEPTH PATCHING
			(FT)	(FT)	44022029 (SQ YD)	X4421000 (TON)
133+67	I-39 MAINLINE (URBAN)	NBDL	2.0	12.0	2.7	0.5
169+34	I-39 MAINLINE (URBAN)	NBDL	2.0	12.0	2.7	0.5
171+39	I-39 MAINLINE (URBAN)	NBDL	2.0	12.0	2.7	0.5
200+18	I-39 MAINLINE (RURAL)	NBDL	2.0	12.0	2.7	0.5
212+57	I-39 MAINLINE (RURAL)	NBDL	2.0	12.0	2.7	0.5
221+07	I-39 MAINLINE (RURAL)	NBDL	2.0	12.0	2.7	0.5
NORTHBOUND SUBTOTALS OF PARTIAL DEPTH PATCHES					16.2	3.0

PARTIAL DEPTH PATCHING I 39 MAINLINE SOUTHBOUND						
STATION	LOCATION	LANE	LENGTH	WIDTH	PARTIAL DEPTH REMOVAL 3"	PARTIAL DEPTH PATCHING
			(FT)	(FT)	44022029 (SQ YD)	X4421000 (TON)
127+40	I-39 MAINLINE (URBAN)	SBDL	2.0	12.0	2.7	0.5
134+90	I-39 MAINLINE (URBAN)	SBDL	2.0	12.0	2.7	0.5
135+30	I-39 MAINLINE (URBAN)	SBPL	2.0	12.0	2.7	0.5
137+50	I-39 MAINLINE (URBAN)	SBDL	2.0	12.0	2.7	0.5
137+80	I-39 MAINLINE (URBAN)	SBDL	2.0	12.0	2.7	0.5
138+10	I-39 MAINLINE (URBAN)	SBDL	2.0	12.0	2.7	0.5
147+50	I-39 MAINLINE (URBAN)	SBDL	2.0	12.0	2.7	0.5
147+95	I-39 MAINLINE (URBAN)	SBPL	2.0	12.0	2.7	0.5
150+15	I-39 MAINLINE (URBAN)	SBDL	2.0	12.0	2.7	0.5
158+50	I-39 MAINLINE (URBAN)	SBDL	2.0	12.0	2.7	0.5
158+80	I-39 MAINLINE (URBAN)	SBDL	2.0	12.0	2.7	0.5
183+60	I-39 MAINLINE (URBAN)	SBDL	2.0	12.0	2.7	0.5
187+35	I-39 MAINLINE (URBAN)	SBDL	2.0	12.0	2.7	0.5
191+80	I-39 MAINLINE (URBAN)	SBDL	2.0	12.0	2.7	0.5
211+75	I-39 MAINLINE (RURAL)	SBPL	2.0	12.0	2.7	0.5
212+20	I-39 MAINLINE (RURAL)	SBDL	2.0	12.0	2.7	0.5
219+80	I-39 MAINLINE (RURAL)	SBDL	2.0	12.0	2.7	0.5
221+80	I-39 MAINLINE (RURAL)	SBPL	2.0	12.0	2.7	0.5
224+35	I-39 MAINLINE (RURAL)	SBDL	2.0	12.0	2.7	0.5
224+80	I-39 MAINLINE (RURAL)	SBDL	2.0	12.0	2.7	0.5
234+10	I-39 MAINLINE (RURAL)	SBDL	2.0	12.0	2.7	0.5
234+55	I-39 MAINLINE (RURAL)	SBDL	2.0	12.0	2.7	0.5
234+70	I-39 MAINLINE (RURAL)	SBPL	2.0	12.0	2.7	0.5
SOUTHBOUND SUBTOTALS OF PARTIAL DEPTH PATCHES					62.1	11.5

NOTE:

PATCHING QUANTITIES IN ADDITION TO THOSE SHOWN IN THE SCHEDULES HAVE BEEN INCLUDED IN THE SUMMARY OF QUANTITIES, TO BE PLACED AT LOCATIONS DETERMINED BY THE ENGINEER.

FILE NAME =	USER NAME = berganaj	DESIGNED -	AJB	REVISED	STATE OF ILLINOIS DEPARTMENT OF TRANSPORTATION	SCHEDULE OF QUANTITIES		F.A.I. RTE.	SECTION	COUNTY	TOTAL SHEETS	SHEET NO.
et:\pwork\pwork\dot\berganaj\0302063\0570973-sht-schedule.dgn	DRAWN -	AJB	REVISED -					39	D5 PATCHING 2013-1	MCLEAN	19	16
PLOT SCALE = 40.0000' / in.	CHECKED -		REVISED -					CONTRACT NO. 70973				
PLOT DATE = 3/22/2012	DATE -	3/12/2012	REVISED -					ILLINOIS FED. AID PROJECT				
						SCALE: N/A	SHEET NO. 6 OF 7 SHEETS	STA. N/A TO STA. N/A				

SCHEDULE OF QUANTITIES

CLASS A PATCH, 10" TOTALS		TYPE I	TYPE II	TYPE III	TYPE IV	SAWCUTS	TIE BARS 3/4"	PATCHING REINFORCEMENT
		44200549	44200553	44200557	44200559	44213200	44213204	44213000
		(SQ. YD.)	(SQ. YD.)	(SQ. YD.)	(SQ. YD.)	(FT)	(EACH)	(SQ. YD.)
NORTHBOUND	RURAL	196.0	276.7	56.7	80.0	4812.0	165.0	609.3
*NB ADDITIONAL QUANTITY	RURAL	0.0	82.7	0.0	0.0	648.0	0.0	82.7
SOUTHBOUND	RURAL	108.0	383.0	36.7	173.3	4860.0	395.0	701.3
*SB ADDITIONAL QUANTITY	RURAL	0.0	117.3	0.0	0.0	930.0	0.0	117.3
TOTAL		304.0	859.7	93.3	253.3	11250.0	560.0	1510.7
ROUNDED TOTALS		325.0	875.0	100.0	275.0	11300.0	575.0	1575.0



*ADDITIONAL QUANTITY NOT SHOWN IN SCHEDULE SHALL BE ADDED BY ENGINEER'S JUDGEMENT

CLASS B PATCH, 11" TOTALS		TYPE I	TYPE II	TYPE III	TYPE IV	SAWCUTS	TIE BARS 3/4"	DOWEL BARS	PAVEMENT FABRIC
		44200978	44200982	44200986	44200988	44213200	44213204	44201299	42001200
		(SQ. YD.)	(SQ. YD.)	(SQ. YD.)	(SQ. YD.)	(FT)	(EACH)	(EACH)	(SQ. YD.)
NORTHBOUND	URBAN	0.0	29.3	20.0	0.0	255.0	0.0	80.0	20.0
	RURAL	0.0	16.0	0.0	0.0	108.0	0.0	40.0	0.0
	TOTAL	0.0	45.3	20.0	0.0	363.0	0.0	120.0	20.0
SOUTHBOUND	URBAN	0.0	88.0	36.0	0.0	747.0	0.0	260.0	36.0
	RURAL	0.0	74.7	20.0	0.0	537.0	0.0	180.0	20.0
	TOTAL	0.0	162.7	56.0	0.0	1284.0	0.0	440.0	56.0
URBAN TOTAL		0.0	117.3	56.0	0.0	1002.0	0.0	340.0	56.0
RURAL TOTAL		0.0	90.7	20.0	0.0	645.0	0.0	220.0	20.0
FINAL TOTAL		0.0	208.0	76.0	0.0	1647.0	0.0	560.0	76.0
ROUNDED TOTALS		0.0	225.0	100.0	0.0	1650.0	0.0	575.0	100.0

PARTIAL DEPTH PATCHING TOTALS		PARTIAL DEPTH REMOVAL 3"	PARTIAL DEPTH PATCHING
		44022029	X4421000
		(SQ YD)	(TON)
NORTHBOUND	URBAN	8.1	1.5
	RURAL	8.1	1.5
	TOTAL	16.2	3.0
SOUTHBOUND	URBAN	37.8	7.0
	RURAL	24.3	4.5
	TOTAL	62.1	11.5
URBAN TOTAL		45.9	8.5
RURAL TOTAL		32.4	6.0
FINAL TOTAL		78.3	14.5
ROUNDED TOTALS		85.0	15.0

NOTE:

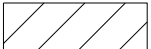
PATCHING QUANTITIES IN ADDITION TO THOSE SHOWN IN THE SCHEDULES HAVE BEEN INCLUDED IN THE SUMMARY OF QUANTITIES, TO BE PLACED AT LOCATIONS DETERMINED BY THE ENGINEER.

 +
 
 = PARTIAL DEPTH REMOVAL
 (of the thickness specified)

MILL MACHINE
 AND/OR WHEEL
 SAW REMOVAL

AIR EQUIPMENT
 OR MECHANICAL
 SWEEPER REMOVAL
 OF LOOSE AND/OR
 UNSOUND CONCRETE

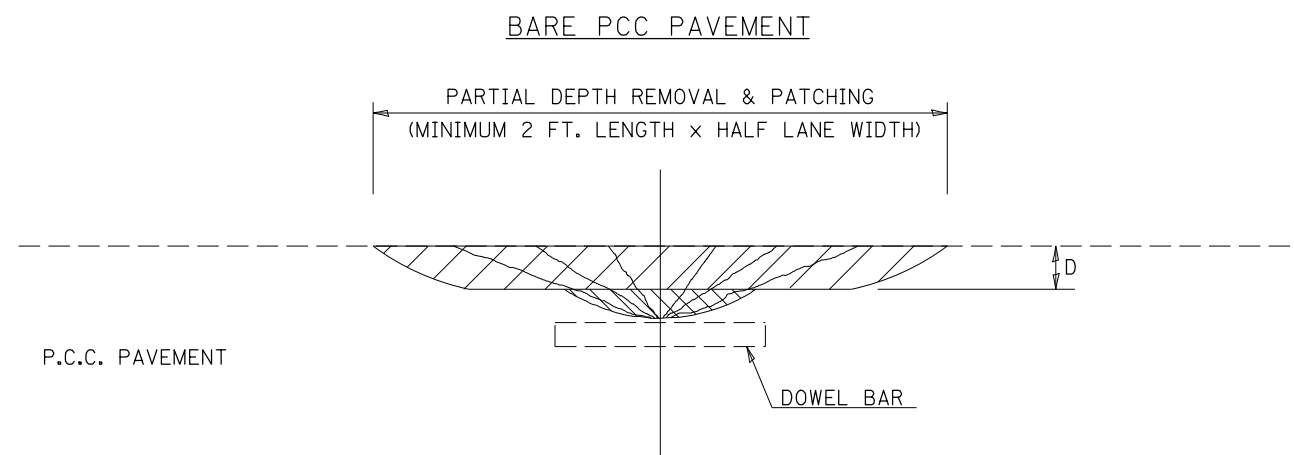

GENERAL NOTES

ALL VOLUME OF PARTIAL DEPTH REMOVAL SHALL BE REPLACED WITH HOT-MIX ASPHALT (HMA) AND PAID FOR AT THE CONTRACT UNIT PRICE PER TON FOR PARTIAL DEPTH PATCHING.

GENERAL NOTE 406H SHALL INCLUDE MIXTURE REQUIREMENTS FOR PARTIAL DEPTH PATCHING.

HMA REPLACEMENT IN RESURFACED PCC PAVEMENT LOCATIONS SHALL BE ACCORDING TO SECTION 406 OF THE STANDARD SPECIFICATIONS.

D = DEPTH OF PARTIAL DEPTH REMOVAL INTO EXISTING PCC PAVEMENT.
 (3" (75 mm) ± OR TO SOUND CONCRETE)

TRANSVERSE CONTRACTION JOINT SHOWN - OTHER LOCATIONS SIMILAR.

Note: All dimensions are in INCHES (millimeters) unless otherwise shown.

FILE NAME =	USER NAME = bergenej	DESIGNED - ___	REVISED - 11/06
et:\pwork\pwork\bergenej\0302063\0570973-sht-details.dgn		DRAWN - ___	REVISED - 10/10
	PLOT SCALE = 40.0000' / in.	CHECKED - ___	REVISED - ___
	PLOT DATE = 3/22/2012	DATE - ___	REVISED - ___

**STATE OF ILLINOIS
 DEPARTMENT OF TRANSPORTATION**

PCC PARTIAL DEPTH HOT-MIX ASPHALT PATCHING

SCALE: _____ SHEET NO. 1 OF 1 SHEETS STA. _____ TO STA. _____

F.A.I. RTE.	SECTION	COUNTY	TOTAL SHEETS	SHEET NO.
39	D5 PATCHING 2013-1	MCLEAN	19	18
FED. ROAD DIST. NO. - ILLINOIS FED. AID PROJECT				CONTRACT NO. 70973

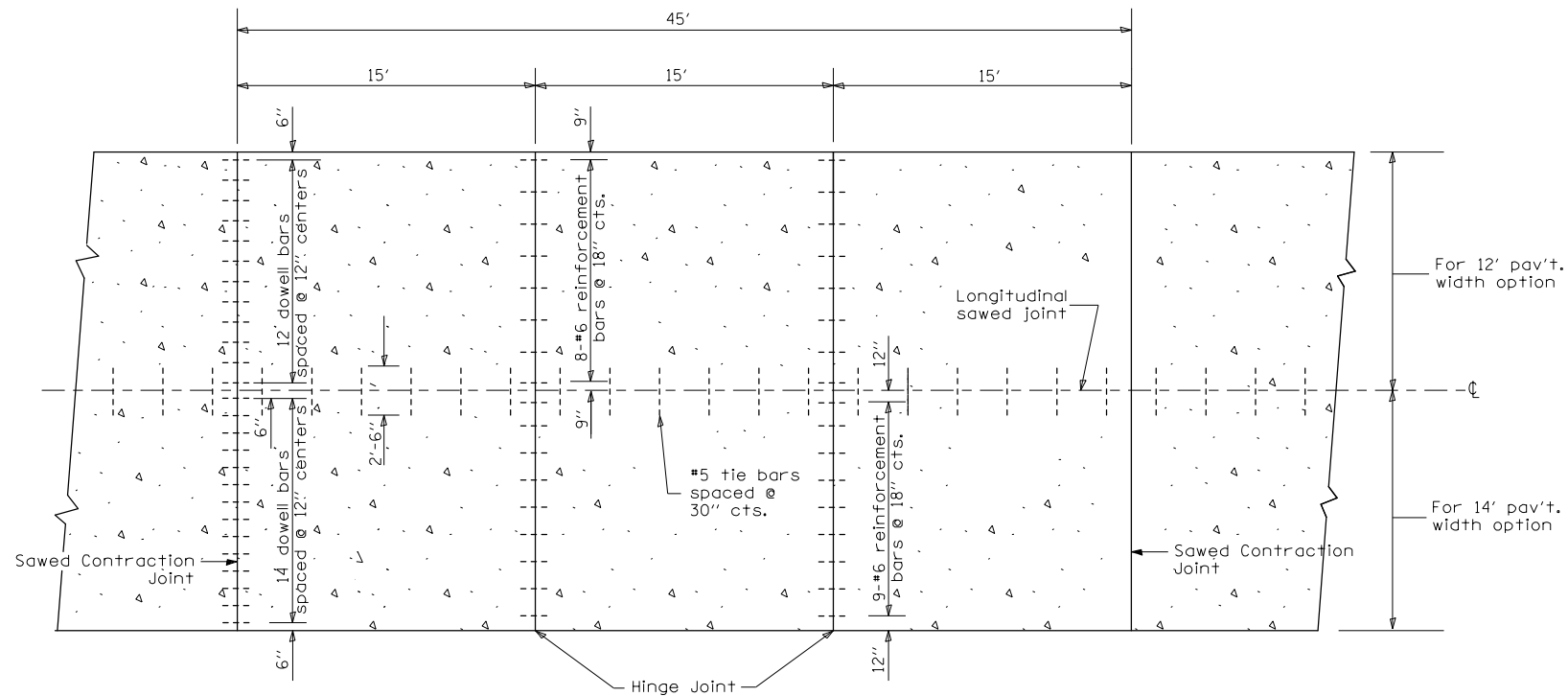

PLAN
EXISTING JOINTED PORTLAND CEMENT CONCRETE PAVEMENT

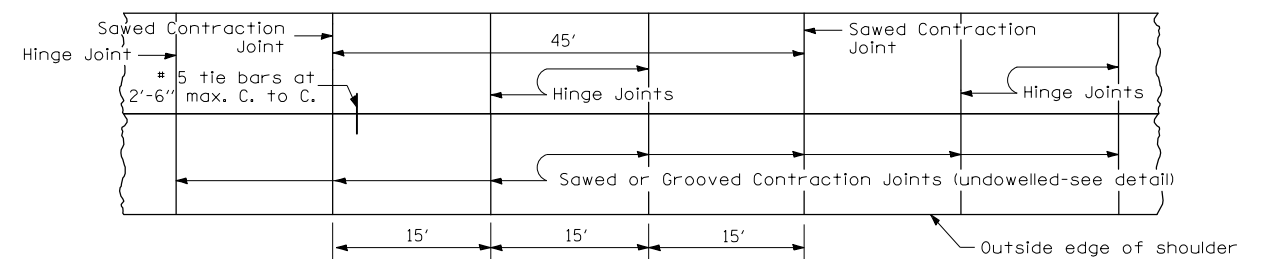

PLAN
TYPICAL P.C.C. PAVED SHOULDER ADJACENT TO JOINTED PAVEMENT

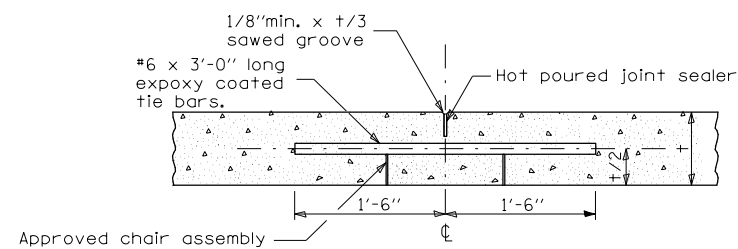

DETAIL OF HINGE JOINT

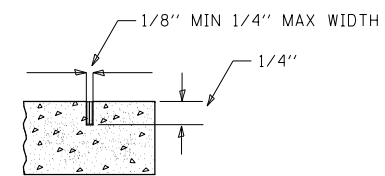

DETAIL OF
Sawed or Grooved
Contraction Joint
For
TYPICAL P.C.C. PAVED SHOULDER

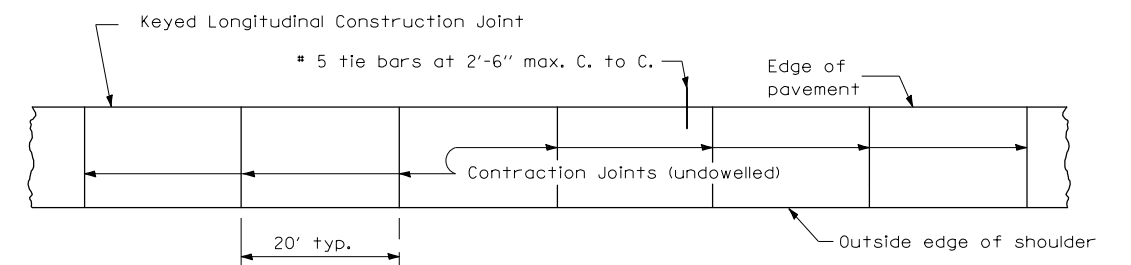

PLAN
TYPICAL P.C.C. PAVED SHOULDER ADJACENT TO CONTINUOUSLY REINFORCED PAVEMENT

GENERAL NOTE

#4 tie bars may be used when the pavement is less than 9" thick.

FILE NAME =	USER NAME = bergana.j	DESIGNED -	REVISED -
et:\pw\work\p\idot\bergana.j\d0302063\0570973-sht-details.dgn		DRAWN -	REVISED -
PLOT SCALE = 40.0000' / in.		CHECKED -	REVISED -
PLOT DATE = 3/22/2012		DATE -	REVISED -

STATE OF ILLINOIS
DEPARTMENT OF TRANSPORTATION

DETAILS OF EXISTING JOINTED P.C.C. PAVEMENT (HINGE-JOINTED)
AND ADJACENT P.C.C. SHOULDER

SCALE: N/A SHEET NO. 1 OF 1 SHEETS STA. N/A TO STA. N/A

F.A.I. RTE.	SECTION	COUNTY	TOTAL SHEETS	SHEET NO.
39	D5 PATCHING 2013-1	MCLEAN	19	19
CONTRACT NO. 70973				
ILLINOIS FED. AID PROJECT				