

NOTE: ALL STATIONING AND ELEVATIONS WILL BE VERIFIED AND ADJUSTED AS NECESSARY IN THE FIELD.

SEC. 8, T 19 N, R 12 W, 2ND PM

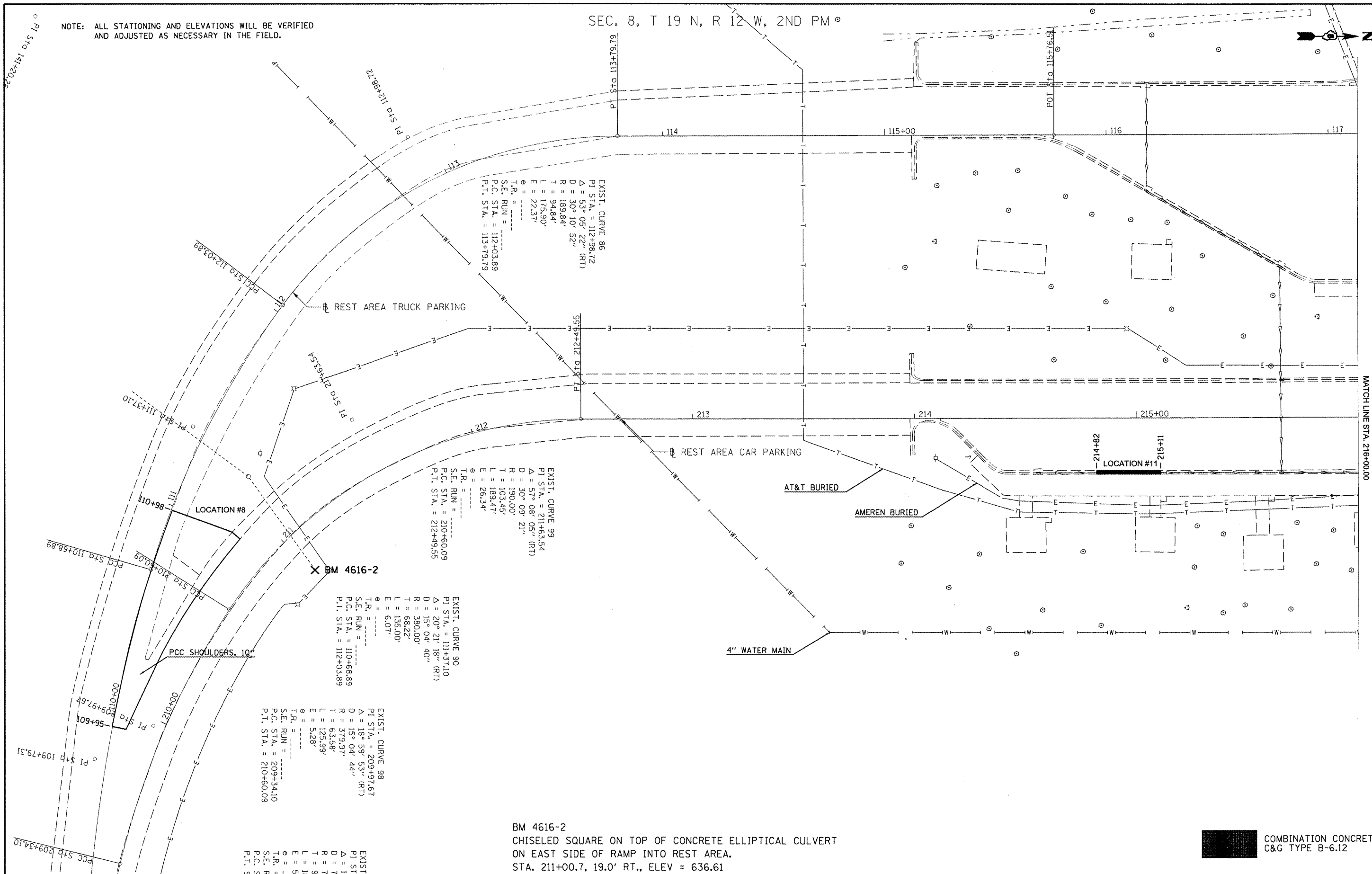

EXIST. CURVE 86
 PI STA. = 112+98.72
 $\Delta = 53^\circ 05' 22''$ (RT)
 $D = 30^\circ 10' 52''$
 $R = 189.84'$
 $T = 94.84'$
 $L = 175.90'$
 $E = 22.37'$
 $\theta = \dots$
 T.R. = \dots
 S.E. RUN = \dots
 P.C. STA. = 112+03.89
 P.T. STA. = 113+79.79

EXIST. CURVE 99
 PI STA. = 211+63.54
 $\Delta = 30^\circ 09' 21''$
 $D = 30^\circ 09' 21''$
 $R = 190.00'$
 $T = 103.45'$
 $L = 189.47'$
 $E = 26.34'$
 $\theta = \dots$
 T.R. = \dots
 S.E. RUN = \dots
 P.C. STA. = 210+60.09
 P.T. STA. = 212+49.55

EXIST. CURVE 90
 PI STA. = 111+37.10
 $\Delta = 20^\circ 21' 18''$ (RT)
 $D = 15^\circ 04' 40''$
 $R = 380.00'$
 $T = 68.22'$
 $L = 135.00'$
 $E = 6.07'$
 $\theta = \dots$
 T.R. = \dots
 S.E. RUN = \dots
 P.C. STA. = 110+68.89
 P.T. STA. = 112+03.89

EXIST. CURVE 98
 PI STA. = 209+97.67
 $\Delta = 18^\circ 59' 53''$ (RT)
 $D = 15^\circ 04' 44''$
 $R = 379.97'$
 $T = 63.58'$
 $L = 125.99'$
 $E = 5.28'$
 $\theta = \dots$
 T.R. = \dots
 S.E. RUN = \dots
 P.C. STA. = 209+34.10
 P.T. STA. = 210+60.09

EXIST. CURVE 97
 PI STA. = 110+68.89
 $\Delta = 15^\circ 04' 44''$
 $D = 15^\circ 04' 44''$
 $R = 760'$
 $T = 90.4'$
 $L = 180'$
 $E = 5.3'$
 $\theta = \dots$
 T.R. = \dots
 S.E. RUN = \dots
 P.C. STA. = 110+68.89
 P.T. STA. = 112+03.89

BM 4616-2
 CHISELED SQUARE ON TOP OF CONCRETE ELLIPTICAL CULVERT
 ON EAST SIDE OF RAMP INTO REST AREA.
 STA. 211+00.7, 19.0' RT., ELEV = 636.61

COMBINATION CONCRETE
 C&G TYPE B-6.12

FILE NAME =	USER NAME = hogenbj	DESIGNED = BJH 2/9/2012	REVISED = BJH 4/9/2012	STATE OF ILLINOIS DEPARTMENT OF TRANSPORTATION	PLAN SHEET	F.A.L. RTE. =	SECTION =	COUNTY =	TOTAL SHEETS =	SHEET NO. =
ct:\pwork\pwork\hogenbj\8294537\057669-sht-plan.dgn	PLOT SCALE = 40.0000' / 1"	DRAWN =	REVISED =			74	REST AREA REPAIR 2012-2	VERMILION	19	13
PLOT DATE = 4/9/2012	CHECKED =	REVISED =	REVISED =			CONTRACT NO. 70969				
	DATE =	REVISED =	REVISED =			ILLINOIS FED. AID PROJECT				

SCALE: SHEET 1 OF 2 SHEETS STA. 209+24.04 TO STA. 216+00