

INDEX OF SHEETS

06-15-12 LETTING ITEM 213

STATE OF ILLINOIS

DEPARTMENT OF TRANSPORTATION

DIVISION OF HIGHWAYS

**PROPOSED
HIGHWAY PLANS**

FAI ROUTE 57 (I-57)
SECTION D3 PAVEMENT PATCHING 2013-3

CRC PAVEMENT PATCHING
FORD COUNTY

C-93-115-12

F.A.I. RTE.	SECTION	COUNTY	TOTAL SHEETS	SHEET NO.
57	*	FORD	10	1
		ILLINOIS	CONTRACT NO. 66C23	

#D3 PAVEMENT PATCHING 2013-3

D-93-002-12

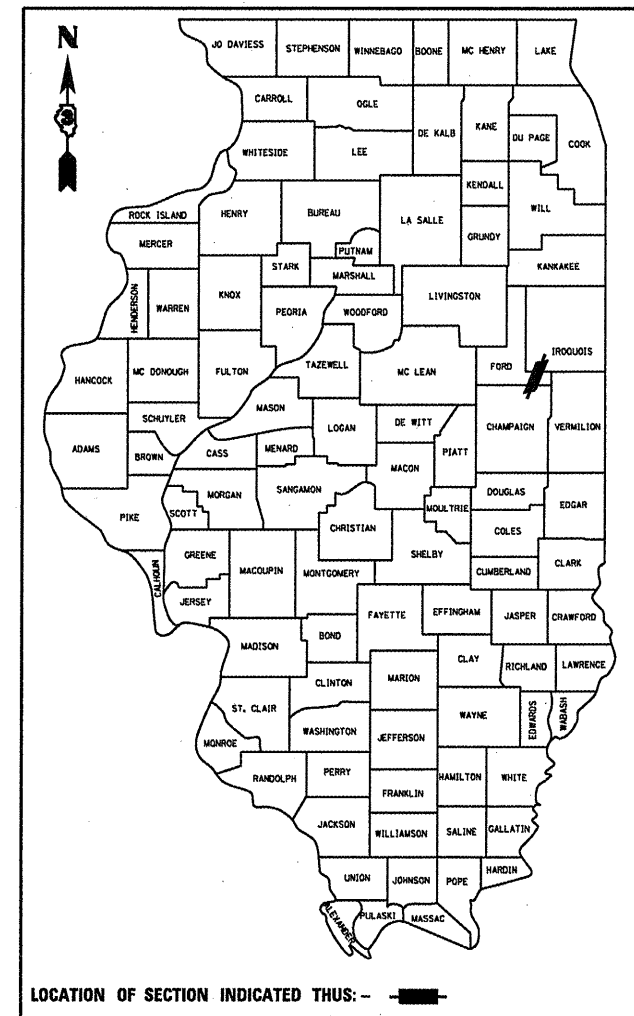

FUNCTIONAL CLASSIFICATION
RURAL - INTERSTATE
FAI RTE. 57 (I-57)
2011 ADT 16300
P.V 64.05% M.U. 28.37% S.U. 7.58%

STATE OF ILLINOIS
DEPARTMENT OF TRANSPORTATION
DIVISION OF HIGHWAYS

SUBMITTED 4/6 20 12
Eric S. Threlkeld
DEPUTY DIRECTOR OF HIGHWAYS, REGION ENGINEER

May 11 20 12
John D. Baranzelli, P.E.
acting ENGINEER OF DESIGN AND ENVIRONMENT

May 11 20 12
William R. Freyler
acting DIRECTOR OF HIGHWAYS, CHIEF ENGINEER

**PRINTED BY THE AUTHORITY
OF THE STATE OF ILLINOIS**

- COVER SHEET
- GENERAL NOTES
- SUMMARY OF QUANTITIES
- TYPICAL SECTIONS
- PATCHING SCHEDULE- NBL
- PATCHING SCHEDULE - SBL
- PAVEMENT MARKING SCHEDULES
- TRAFFIC CONTROL AND PROTECTION, STANDARD 701400 (SPECIAL)
- CLASS A PATCHING DETAILS
- TYPICAL PAVEMENT MARKINGS

STANDARDS

- 000001-06 STANDARD SYMBOLS, ABBREVIATIONS AND PATTERNS
- 001001-02 AREAS OF REINFORCEMENT BARS
- 001006 DECIMAL OF AN INCH AND OF A FOOT
- 421001-02 BAR REINFORCEMENT FOR CRC PAVEMENT
- 701001-02 OFF-ROAD OPERATIONS 2L, 2W, MORE THAN 15' (4.5 m) AWAY
- 701006-03 OFF-ROAD OPERATIONS 2L, 2W, 15' (4.5 m) TO 24" (600 mm) FROM PAVEMENT EDGE
- 701101-02 OFF-ROAD OPERATIONS MULTILANE, 15' (4.5 m) TO 24" (600 mm) FROM PAVEMENT EDGE
- 701106-02 OFF-ROAD OPERATIONS, MULTILANE, MORE THAN 15' (4.5 m) AWAY
- 701401-06 LANE CLOSURE, FREEWAY/EXPRESSWAY
- 701411-08 LANE CLOSURE, MULTILANE, AT ENTRANCE OR EXIT RAMP FOR SPEEDS ≥ 45 MPH
- 701426-04 LANE CLOSURE, MULTILANE INTERMITTENT OR MOVING OPERATION, FOR SPEEDS ≥ 45 MPH
- 701901-02 TRAFFIC CONTROL DEVICES

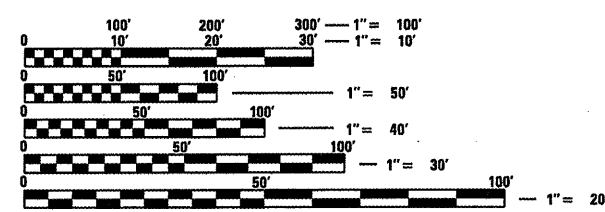
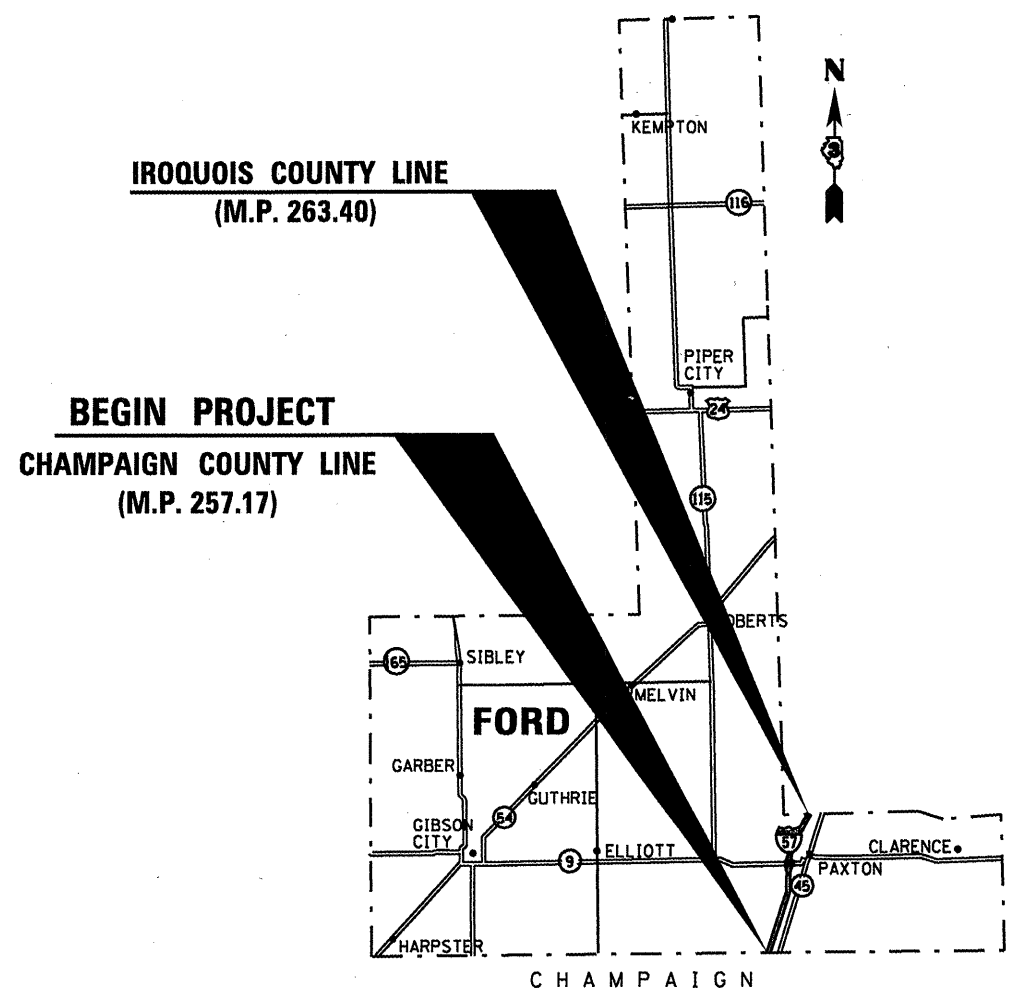

FULL SIZE PLANS HAVE BEEN PREPARED USING STANDARD ENGINEERING SCALES. REDUCED SIZED PLANS WILL NOT CONFORM TO STANDARD SCALES. IN MAKING MEASUREMENTS ON REDUCED PLANS, THE ABOVE SCALES MAY BE USED.

J.U.L.I.E.
JOINT UTILITY LOCATION INFORMATION FOR EXCAVATION
1-800-892-0123
OR 811

PROJECT ENGINEER **JOE KANNEL, P.E.**
UNIT CHIEF **RON WOODSHANK**
TOWNSHIPS **VARIOUS**
CONTRACT NO. **66C23**

GROSS LENGTH = 32,894 FT. = 6.23 MILE

GENERAL NOTES

PLAN DIMENSIONS AND DETAILS RELATIVE TO EXISTING ROADWAY OR STRUCTURE HAVE BEEN TAKEN FROM EXISTING PLANS AND ARE SUBJECT TO NOMINAL CONSTRUCTION VARIATIONS. IT SHALL BE THE CONTRACTOR'S RESPONSIBILITY TO VERIFY SUCH DIMENSIONS AND DETAILS IN THE FIELD AND TO MAKE NECESSARY APPROVED ADJUSTMENTS PRIOR TO CONSTRUCTION OR ORDERING OF MATERIALS. SUCH VARIATIONS SHALL NOT BE CAUSE FOR ADDITIONAL COMPENSATION FOR A CHANGE IN THE SCOPE OF THE WORK, HOWEVER, THE CONTRACTOR WILL BE PAID FOR THE QUANTITY ACTUALLY FURNISHED AT THE UNIT BID FOR THE WORK.

FOR STABILIZATION, ALL TYPE III BARRICADES SHALL REQUIRE A MINIMUM OF FOUR SAND BAGS PER BARRICADE.

ABANDONED UNDERGROUND UTILITIES THAT CONFLICT WITH CONSTRUCTION SHALL BE DISPOSED OF OUTSIDE THE LIMITS OF THE RIGHT OF WAY ACCORDING TO ARTICLE 202.03 OF THE STANDARD SPECIFICATIONS AND AS DIRECTED BY THE ENGINEER. THIS WORK WILL NOT BE PAID FOR SEPARATELY BUT SHALL BE INCLUDED IN THE COST OF CLASS A PATCHING.

ANY REFERENCE TO A STANDARD IN THESE PLANS SHALL BE INTERPRETED TO MEAN THE EDITION AS INDICATED BY THE SUBNUMBER LISTED ON THE INDEX OF SHEETS OR THE COPY OF THE STANDARD INCLUDED IN THESE PLANS.

EXISTING REINFORCEMENT BARS EXTENDING INTO REMOVAL AREA SHALL BE CLEANED, STRAIGHTENED AND INCORPORATED INTO THE NEW CONSTRUCTION. ANY REINFORCEMENT BARS THAT ARE DAMAGED DURING CONCRETE REMOVAL SHALL BE REPLACED WITH AN APPROVED BAR SPLICER OR ANCHORAGE SYSTEM. COST INCLUDED WITH CONCRETE REMOVAL.

THE CONTRACTOR SHALL CONTACT JULIE AT LEAST 48 HOURS PRIOR TO EXCAVATION TO DETERMINE WHICH UTILITIES ARE IN THE AREA.

DATE: 4-6-12

PREPARED BY: Don Bonvil
DISTRICT STUDIES & PLANS ENGINEER

EXAMINED BY: Herbert Khusse
DISTRICT CONSTRUCTION ENGINEER

Wayne J. Phillips
DISTRICT MATERIALS ENGINEER

Bruce A. Anderson
DISTRICT OPERATIONS ENGINEER

FILE NAME =	USER NAME = potelyj	DESIGNED - RON WOODSHANK	REVISED -	STATE OF ILLINOIS DEPARTMENT OF TRANSPORTATION	GENERAL NOTES	F.A.I. RTE.	SECTION	COUNTY	TOTAL SHEETS	SHEET NO.
c:\pwwork\pwwork\potelyj\d0300084\036623-shr-details.dgn	DRAWN - RON WOODSHANK	REVISED -	57			*	FORD	10	2	
PLOT SCALE = 100.0000' / 1" =	CHECKED -	REVISED -	*D3 PAVEMENT PATCHING 2013-3				CONTRACT NO. 66C23			
PLOT DATE = 4/5/2012	DATE -	REVISED -	ILLINOIS							
				SCALE:	SHEET NO. 1 OF 1 SHEETS	STA.	TO STA.			

CODE NO.	ITEM	UNIT	TOTAL QUANTITY	CONSTR. CODE
				STATE FUNDS 100% STATE ROADWAY 0005 RURAL
44200565	CLASS A PATCHES, TYPE II, 11 INCH	SQ YD	424	424
44213000	PATCHING REINFORCEMENT	SQ YD	222	222
44213200	SAW CUTS	FOOT	3084	3084
67100100	MOBILIZATION	L SUM	1	1
70100420	TRAFFIC CONTROL AND PROTECTION, STANDARD 701411	EACH	4	4
70103815	TRAFFIC CONTROL SURVEILLANCE	CAL DA	20	20
78009004	MODIFIED URETHANE PAVEMENT MARKING - LINE 4"	FOOT	242	242
78009006	MODIFIED URETHANE PAVEMENT MARKING - LINE 6"	FOOT	93	93
X0326907	PORTABLE, VEHICLE MOUNTED, CHANGEABLE MESSAGE SIGN	CAL MO	0.5	0.5
X0326880	MESSAGE BOARD VEHICLE DRIVER	HOUR	120	120
X7010805	TRAFFIC CONTROL AND PROTECTION, STANDARD 701401 (SPECIAL)	L SUM	1	1

• SPECIALITY ITEMS

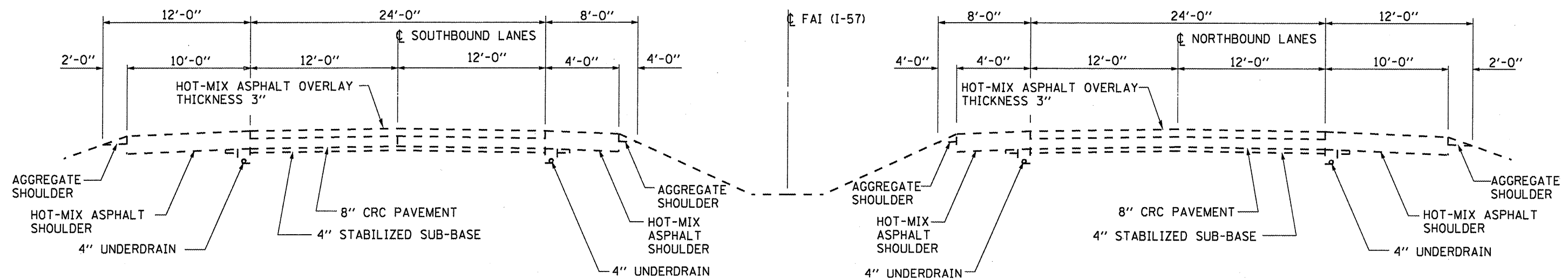

**TYPICAL SECTIONS
M.P. 257.14 TO M.P. 263.49
FORD COUNTY**

FILE NAME =	USER NAME = petelyj	DESIGNED - RON WOODSHANK	REVISED -
o:\pwork\pwork\petelyj\d0300064\0366	23-ht-details.dgn	DRAWN - RON WOODSHANK	REVISED -
	PLOT SCALE = 100.0000 ' / in.	CHECKED -	REVISED -
	PLOT DATE = 4/5/2012	DATE -	REVISED -

**STATE OF ILLINOIS
DEPARTMENT OF TRANSPORTATION**

TYPICAL SECTIONS

SCALE: SHEET NO. 1 OF 1 SHEETS STA. TO STA.

F.A.I. RTE.	SECTION	COUNTY	TOTAL SHEETS	SHEET NO.
57	*	FORD	10	4
*03 PAVEMENT PATCHING 2013-3			CONTRACT NO. 66C23	
ILLINOIS				

PATCHING SCHEDULE - NBL									
LOCATION BY MILE POST	PASS LANE	DRIVE LANE	PASSING LANE			DRIVING LANE			REMARKS
			11" TYPE II SQ YD	PATCH REINF. SQ YD	SAW CUTS FOOT	11" TYPE II SQ YD	PATCH REINF. SQ YD	SAW CUTS FOOT	
257.17									CHAMPAIGN COUNTY LINE
258.15		6				8	8	60	
258.51		6				8	8	60	
258.70		6				8	8	60	
260.00		6				8	8	60	
260.65		6				8	8	60	
260.70		6				8	8	60	
260.85		6				8	8	60	
260.87		6				8	8	60	
260.87		6				8	8	60	
260.90		6				8	8	60	
263.45		6				8	8	60	
263.40									IROQUOIS COUNTY LINE
TOTALS						88	88	660	

FILE NAME =	USER NAME = petelyj	DESIGNED - RON WOODSHANK	REVISED -
c:\pwork\pedit\petelyj\d0300064\0366	23-sht-details.dgn	DRAWN - RON WOODSHANK	REVISED -
	PLOT SCALE = 100.0000' / 1"	CHECKED -	REVISED -
	PLOT DATE = 4/5/2012	DATE -	REVISED -

STATE OF ILLINOIS
DEPARTMENT OF TRANSPORTATION

PATCHING SCHEDULES - NBL

SCALE: SHEET NO. 1 OF 1 SHEETS STA. TO STA.

F.A.I. RTE.	SECTION	COUNTY	TOTAL SHEETS	SHEET NO.
57	*	FORD	10	5
*03 PAVEMENT PATCHING 2013-3			CONTRACT NO. 66C23	
ILLINOIS				

PATCHING SCHEDULE - SBL									
LOCATION BY MILE POST	PASS LANE	DRIVE LANE	PASSING LANE			DRIVING LANE			REMARKS
			11" TYPE II SQ YD	PATCH REINF. SQ YD	SAW CUTS FOOT	11" TYPE II SQ YD	PATCH REINF. SQ YD	SAW CUTS FOOT	
263.40									IROQUOIS COUNTY LINE
263.10		6				8	8	60	
263.08		6				8	8	60	
263.05		6				8	8	60	
263.02		6				8	8	60	
263.00	6		8	8	60				
262.90		6				8	8	60	
262.85		6				8	8	60	
262.83	6		8	8	60				
262.80		6				8	8	60	
262.78		6				8	8	60	
262.77		6				8	8	60	
262.75		6				8	8	60	
262.55		10				13	13	68	
262.30	6	6	8	8	60	8	8	60	
262.10		6				8	8	60	
262.08		10				13	13	68	
262.00	6		8	8	60				
261.97	6	6	8	8	60	8	8	60	
261.70		6				8	8	60	
261.70		6				8	8	60	
261.90	10		13	13	68				
261.68		6				8	8	60	
261.60	6	6	8	8	60	8	8	60	
261.55	6	6	8	8	60	8	8	60	
261.53	6	6	8	8	60	8	8	60	
261.40		6				8	8	60	
261.15		6				8	8	60	
258.75		6				8	8	60	
258.73		6				8	8	60	
258.65		6				8	8	60	
257.25	6	6	8	8	60	8	8	60	
257.25	6		8	8	60				
257.24	6		8	8	60				
257.18		6				8	8	60	
257.17									CHAMPAIGN COUNTY LINE
TOTALS			101	101	728	235	235	1696	

PAVEMENT MARKING SCHEDULE - NBL			
LOCATION MILE POST	MODIFIED URETHANE PAVEMENT MARKING LINE 4"		MODIFIED URETHANE PAVEMENT MARKING LINE 6"
	FEET		FEET
	YELLOW	WHITE	WHITE
258.15		6	2
258.51		6	2
258.70		6	2
260.00		6	2
260.65		6	2
260.70		6	2
260.85		6	2
260.87		6	2
260.87		6	2
260.90		6	2
263.45		6	2
SUBTOTAL		66	
TOTAL		66	22

PAVEMENT MARKING SCHEDULE - SBL			
LOCATION MILE POST	URETHANE PAVEMENT MARKING LINE 4"		URETHANE PAVEMENT MARKING LINE 6"
	FEET		FEET
	YELLOW	WHITE	WHITE
263.10		6	2
263.08		6	2
263.05		6	2
263.02		6	2
263.00	6		2
262.90		6	2
262.85		6	2
262.83	6		2
262.80		6	2
262.78		6	2
262.77		6	2
262.75		6	2
262.55		10	3
262.30	6	6	2
262.10		6	2
262.08		10	3
262.00	6		2
261.97	6	6	2
261.70		6	2
261.70		6	2
261.90	10		3
261.68		6	2
261.60	6	6	2
261.55	6	6	2
261.53	6	6	2
261.40		6	2
261.15		6	2
258.75		6	2
258.73		6	2
258.65		6	2
257.25	6	6	2
257.25	6		2
257.24	6		2
257.18		6	2
SUBTOTAL		176	
TOTAL		176	71

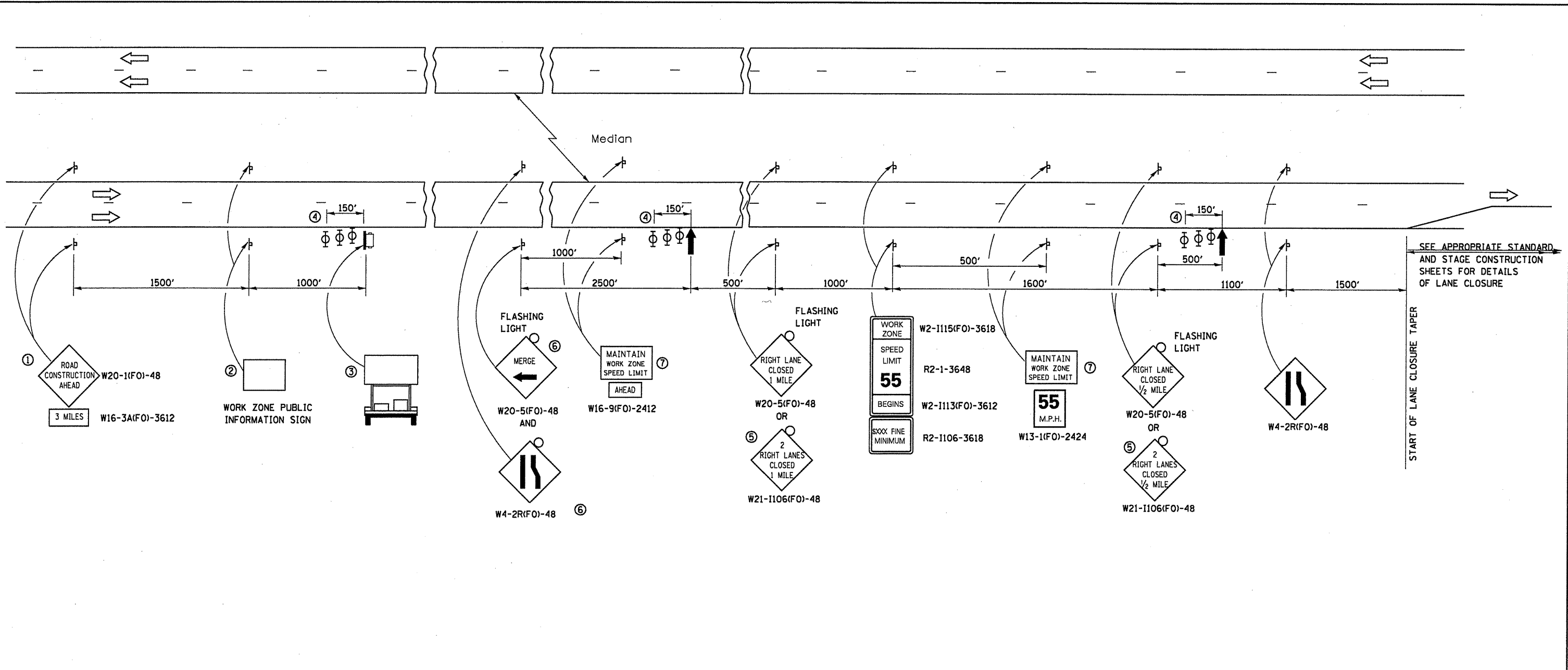

- ① THE ROAD CONSTRUCTION AHEAD SIGN SHALL BE LOCATED 3 MILES IN ADVANCE OF THE PROJECT LIMITS.
- ② THE MESSAGE AND SIZE OF THE WORK ZONE PUBLIC INFORMATION SIGN SHALL BE AS SPECIFIED BY THE DEPARTMENT.
- ③ TO BE PLACED IN THE MEDIAN WHEN FEASIBLE. THE MESSAGE BOARD SHALL BE USED TO DISPLAY STATUS OF LANES WITHIN THE PROJECT. THE PRIMARY MESSAGES SHALL BE:
 "RIGHT LANE CLOSED" / " x MILES AHEAD"
 "LEFT LANE CLOSED" / " x MILES AHEAD"
 "ALL LANES OPEN"
- ④ THREE, TYPE II BARRICADES, DRUMS, OR VERTICAL BARRICADES AT 50' CENTERS.
- ⑤ THIS SIGN SHALL BE USED WHEN 2 LANES ARE CLOSED.
- ⑥ WHEN THE LEFT LANE IS CLOSED, SWITCH THESE TWO SIGNS AND THE DIRECTION OF THE MERGE ARROW.

⑦ 48"x36" FLUORESCENT ORANGE SIGN WITH BLACK LETTERS.
48"

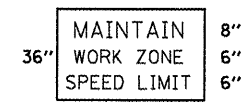

- ↑ ARROW BOARD
- ☐ PORTABLE CHANGEABLE MESSAGE SIGN
- ⊥ SIGN
- ⊕ TYPE II BARRICADE, DRUM, OR VERTICAL BARRICADE WITH MONODIRECTIONAL FLASHING LIGHT

GENERAL NOTE:

THIS STANDARD IS USED WHERE AT ANY TIME A LANE IS CLOSED ON A FREEWAY/EXPRESSWAY.

WHEN THE LEFT LANE IS CLOSED, LEFT LANE CLOSED SIGNS SHALL BE SUBSTITUTED FOR THE RIGHT LANE CLOSED SIGNS.

THE FIRST TWO SIGNS AND THE MESSAGE BOARD ARE STATIONARY. THE OTHER SIGNS AND ARROWBOARDS SHALL BE MOVED AS NECESSARY TO MAINTAIN THE REQUIRED DISTANCE FROM THE START OF THE LANE CLOSURE TAPER(S).

SEE SPECIAL PROVISIONS.

ALL DIMENSIONS ARE IN INCHES UNLESS OTHERWISE SHOWN.

FILE NAME =	USER NAME = patelij	DESIGNED - RON WOODSHANK	REVISED -	STATE OF ILLINOIS DEPARTMENT OF TRANSPORTATION	TRAFFIC CONTROL AND PROTECTION STANDARD 701400 (SPECIAL) DETAILS	F.A.I. RTE.	SECTION	COUNTY	TOTAL SHEETS	SHEET NO.
ci:\pw\work\p\ridot\patelij\0300064\036623-sht-details.dgn	DRAWN - RON WOODSHANK	REVISED -	*			FORD	10	8		
PLOT SCALE = 100.0000' / 1in.	CHECKED -	REVISED -	#D3 PAVEMENT PATCHING 2013-3			CONTRACT NO. 66C23				
PLOT DATE = 4/5/2012	DATE -	REVISED -	ILLINOIS							
					SCALE:	SHEET NO. 1 OF 1 SHEETS	STA.	TO STA.		

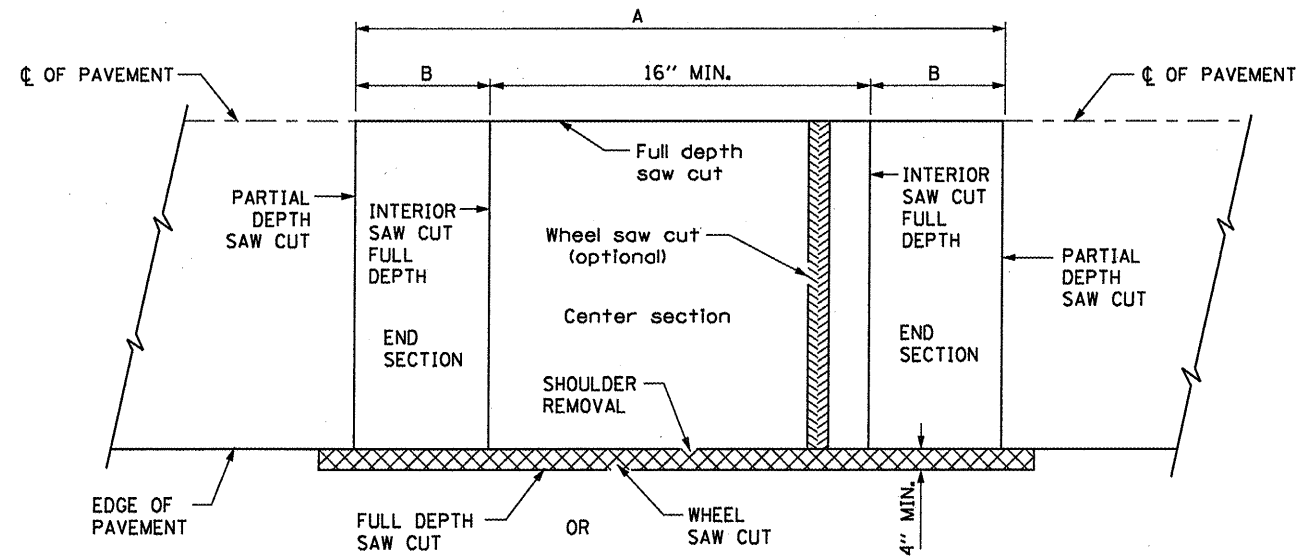

EXISTING PAVEMENT SAWING DETAIL
(AGAINST BITUMINOUS SHOULDER)

EXISTING LONGITUDINAL REINFORCEMENT BARS	A (min.)	B (min.)	C (min.)
No. 6	6'-0"	24"	19"

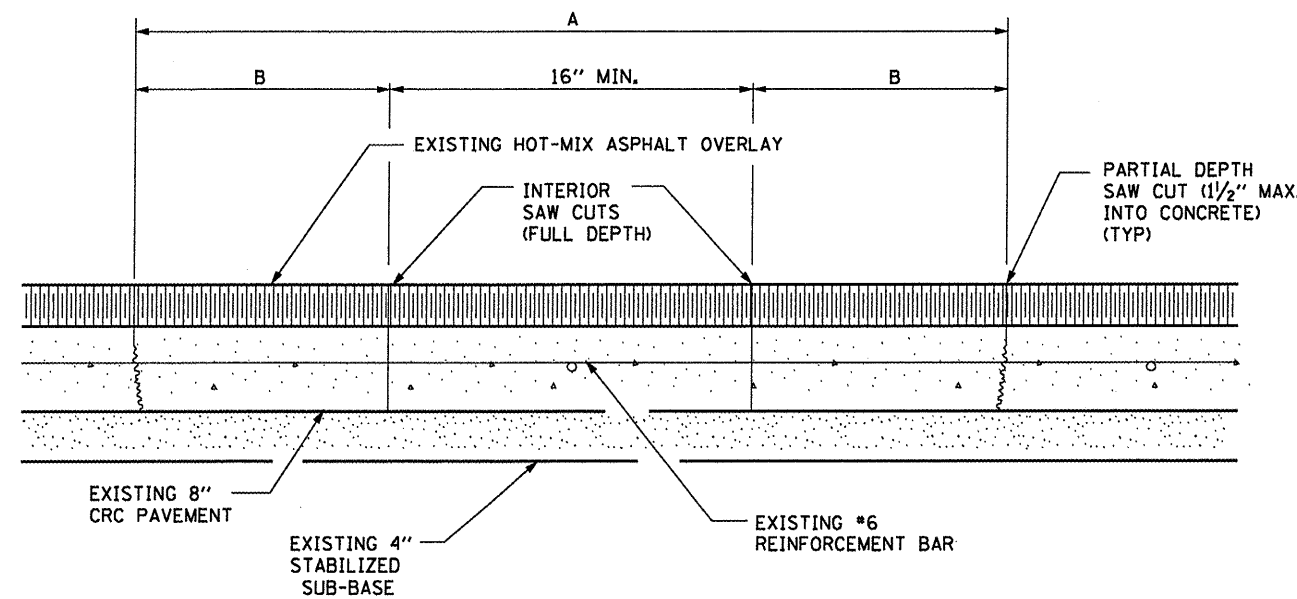

EXISTING PAVEMENT SAW CUTTING DETAIL

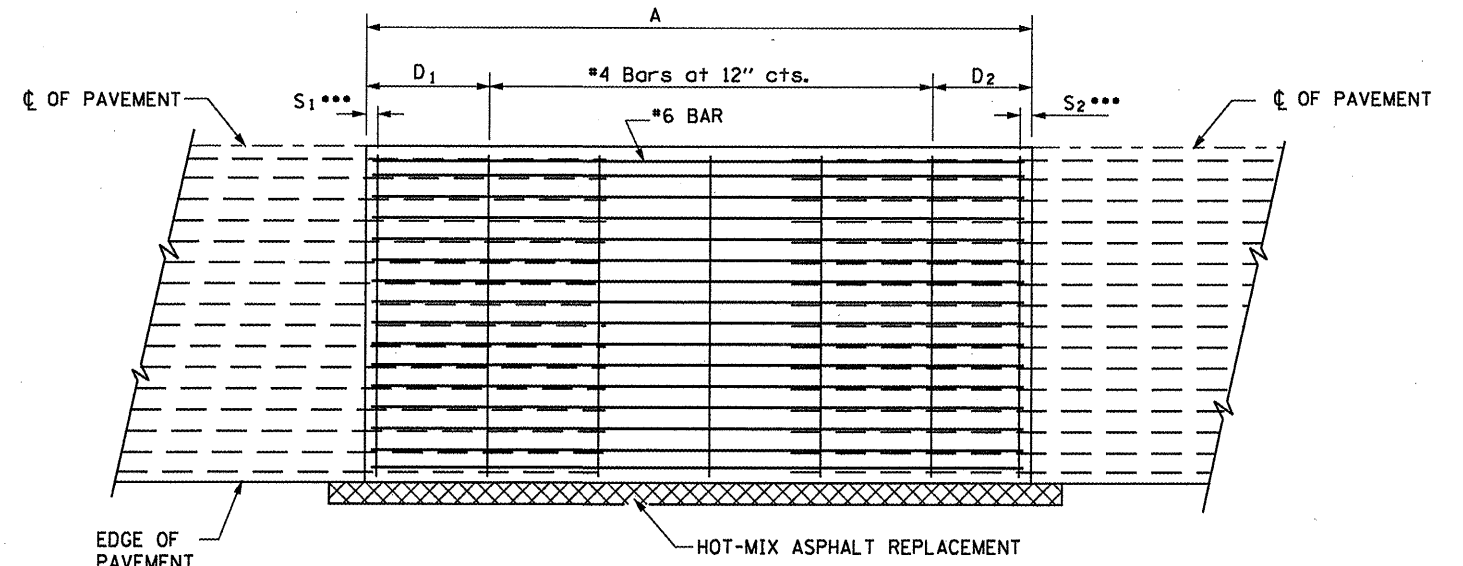

PROPOSED PAVEMENT DETAIL
(AGAINST BITUMINOUS SHOULDER)

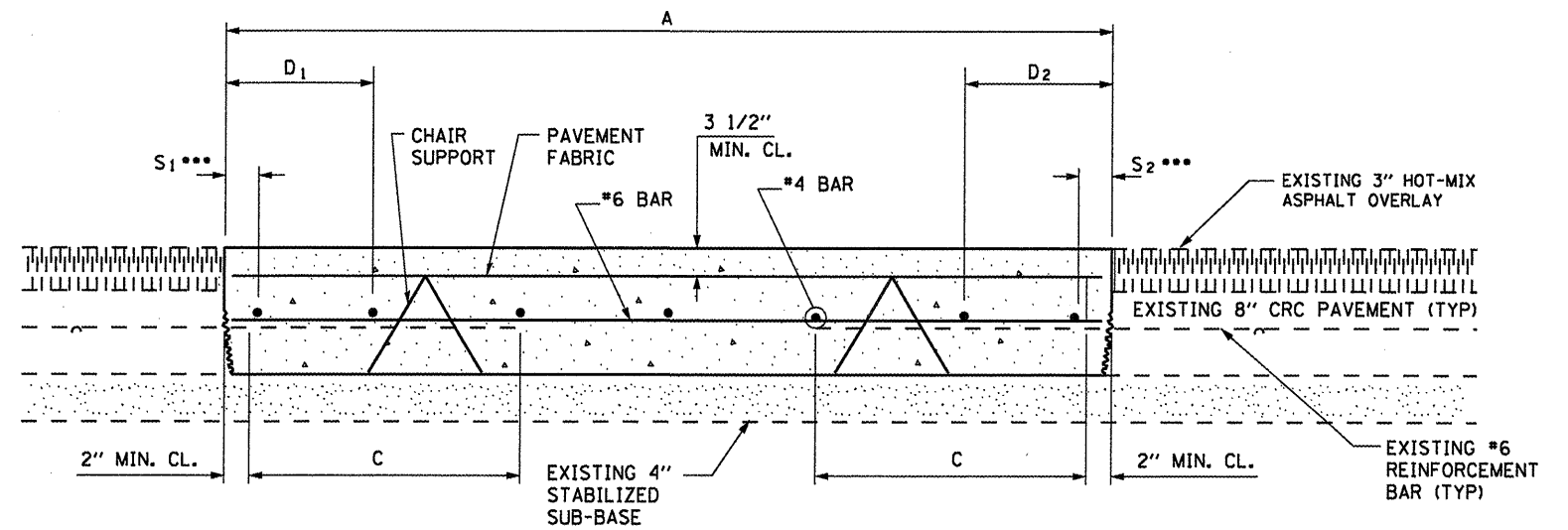

PROPOSED CLASS A PATCHING DETAIL

NOTES:

- EVERY 3rd INTERSECTION MUST BE TIED
- LAP NEW REINFORCEMENT WITH EXISTING LONGITUDINAL REINFORCEMENT
- VARIABLES: WHERE S_1 AND S_2 ARE $2\frac{1}{2}$ " MIN. AND 12" MAX. $D_1 = 2(S_1)$ AND $D_2 = 2(S_2)$

FILE NAME =	USER NAME = petelyj	DESIGNED - RON WOODSHANK	REVISED -
c:\pwork\pwidot\petelyj\08300864\0366	23-shr-details.dgn	DRAWN - RON WOODSHANK	REVISED -
	PLOT SCALE = 100.0000' / in.	CHECKED -	REVISED -
	PLOT DATE = 4/5/2012	DATE -	REVISED -

STATE OF ILLINOIS
DEPARTMENT OF TRANSPORTATION

CLASS A PATCHING DETAIL

SCALE: SHEET NO. 1 OF 1 SHEETS STA. TO STA.

F.A.L. RTE. 57	SECTION *	COUNTY FORD	TOTAL SHEETS 10	SHEET NO. 9
*D3 PAVEMENT PATCHING 2013-3		CONTRACT NO. 66C23		
ILLINOIS				

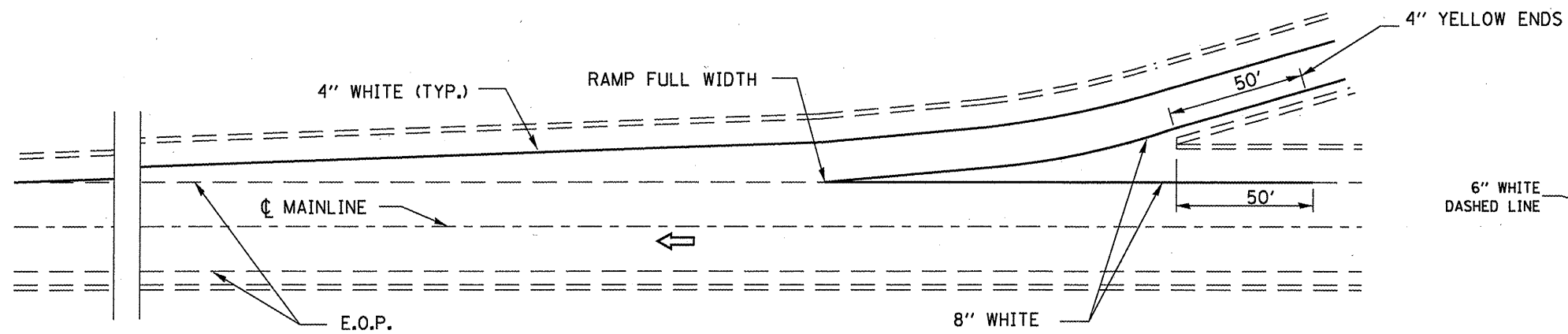

TYPICAL PAVEMENT MARKING FOR ENTRANCE RAMP TERMINALS

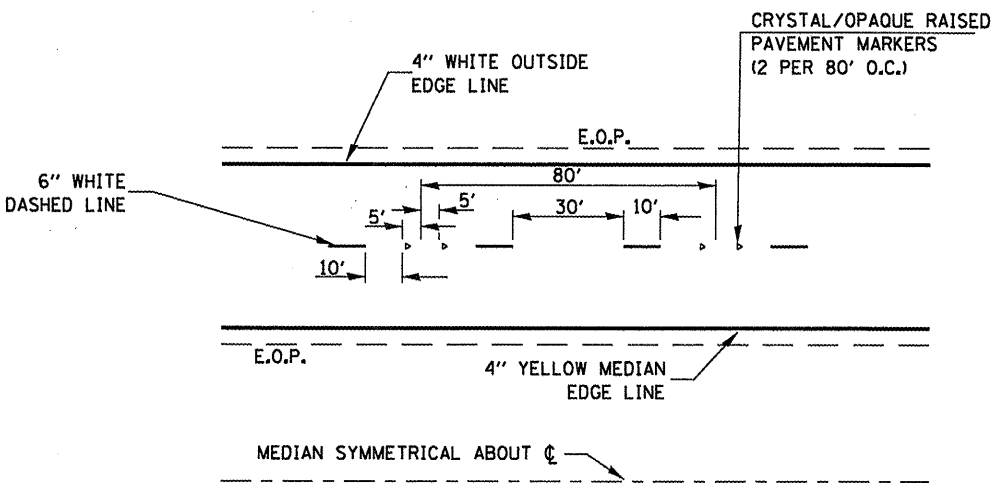

**TYPICAL PAVEMENT MARKINGS
FAI 57**

NOTE:
 WHEN PATCHING IS ADJACENT TO 8" PAVEMENT MARKING LINE
 THE 8" STRIP SHALL BE REPLACED WITH TWO 4" LINES.
 RAISED REFLECTIVE PAVEMENT MARKERS THAT FALL WITHIN
 PATCHED BOUNDARIES WILL NOT BE REPLACED.

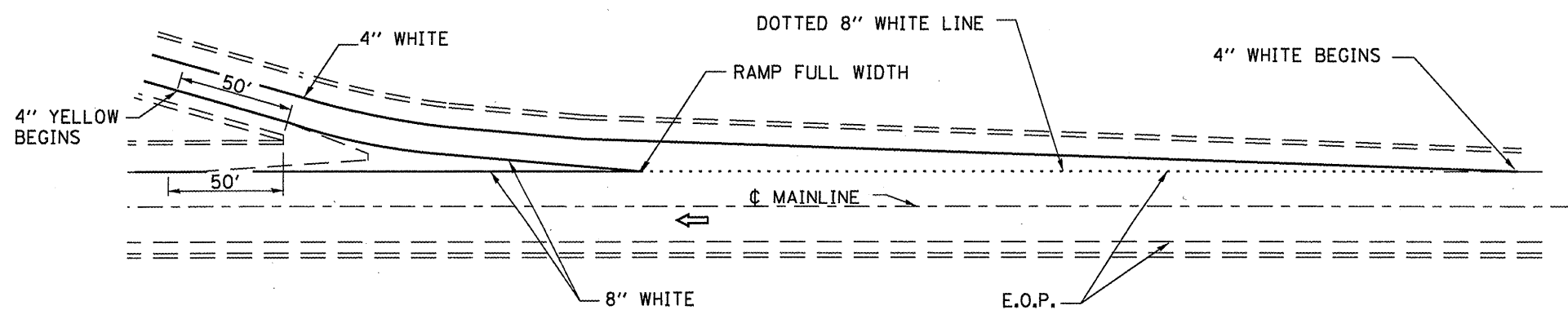

TYPICAL PAVEMENT MARKINGS FOR EXIT RAMP TERMINALS

FILE NAME =	USER NAME = petelj	DESIGNED - RON WOODSHANK	REVISED -	STATE OF ILLINOIS DEPARTMENT OF TRANSPORTATION	TYPICAL PAVEMENT MARKING	F.A.I. RTE.	SECTION	COUNTY	TOTAL SHEETS	SHEET NO.
ct\pwwork\pwwork\petelj\d0300064\0366	23-shr-details.dgn	DRAWN - RON WOODSHANK	REVISED -			57	*	FORD	10	10
	PLOT SCALE = 100.0000' / 1"	CHECKED -	REVISED -			*03 PAVEMENT PATCHING 2013-3		CONTRACT NO. 66C23		
	PLOT DATE = 4/5/2012	DATE -	REVISED -			ILLINOIS				
				SCALE:	SHEET NO. 1 OF 1 SHEETS	STA.	TO STA.			