

EXISTING PAVEMENT SAWING DETAIL
(AGAINST BITUMINOUS SHOULDER)

EXISTING LONGITUDINAL REINFORCEMENT BARS	A (min.)	B (min.)	C (min.)
No. 6	6'-0"	24"	19"

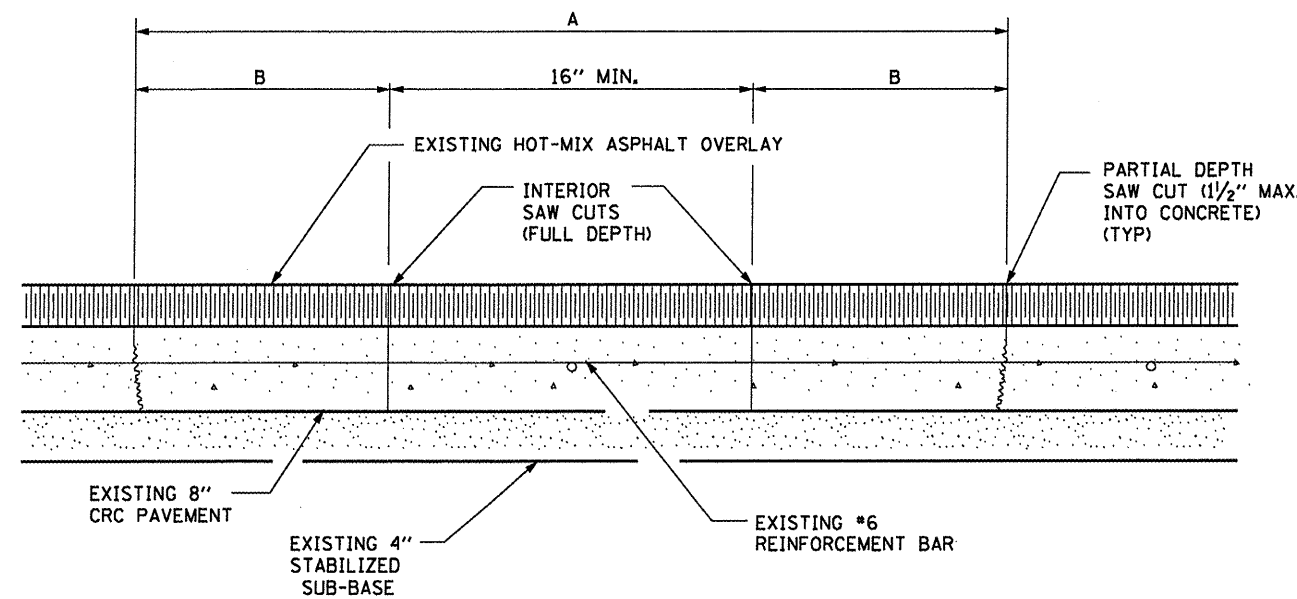

EXISTING PAVEMENT SAW CUTTING DETAIL

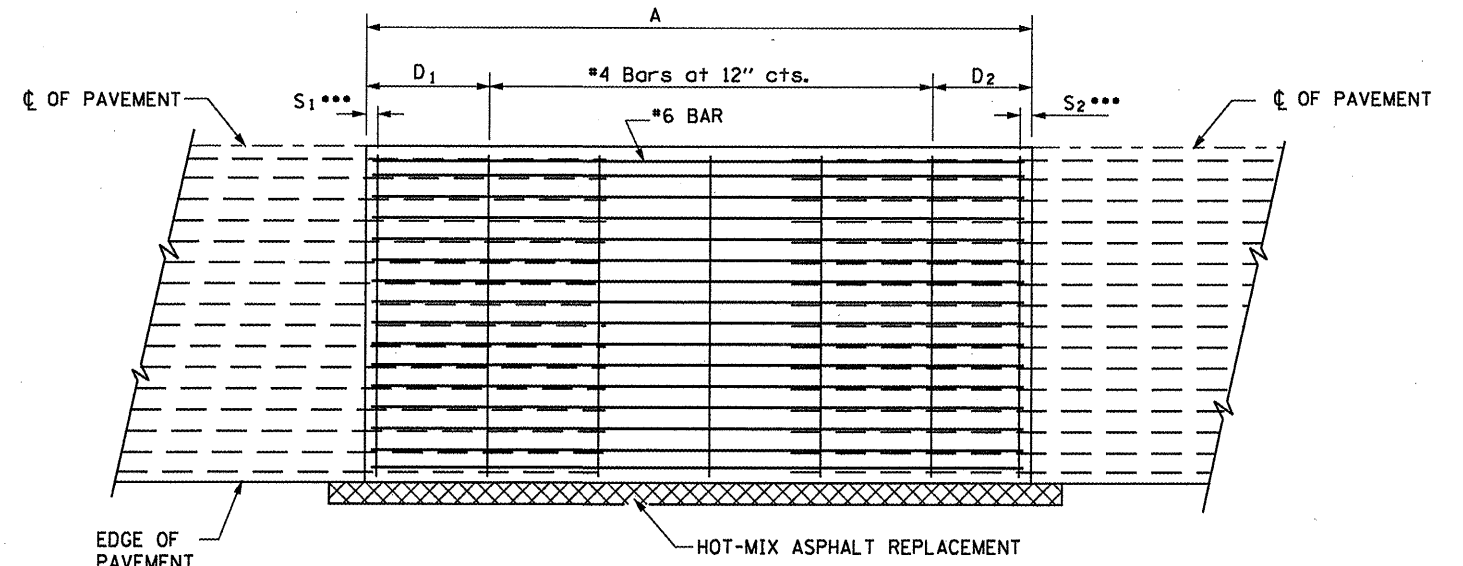

PROPOSED PAVEMENT DETAIL
(AGAINST BITUMINOUS SHOULDER)

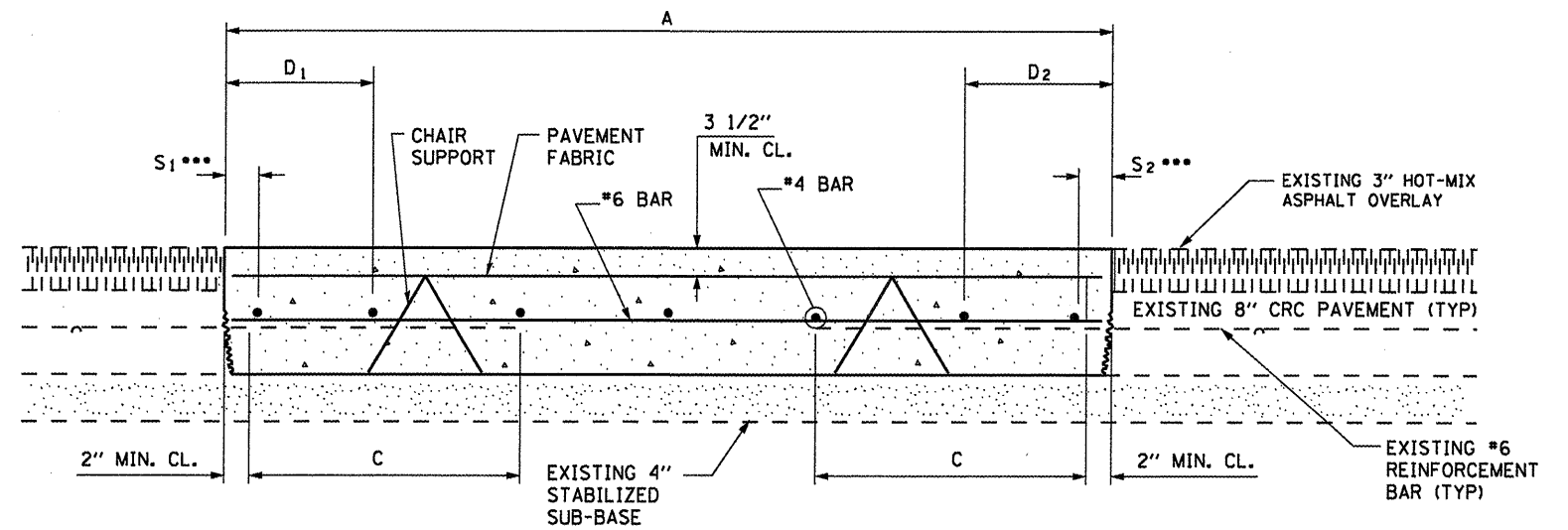

PROPOSED CLASS A PATCHING DETAIL

NOTES:

- EVERY 3rd INTERSECTION MUST BE TIED
- LAP NEW REINFORCEMENT WITH EXISTING LONGITUDINAL REINFORCEMENT
- VARIABLES: WHERE S_1 AND S_2 ARE $2\frac{1}{2}$ " MIN. AND 12" MAX. $D_1 = 2(S_1)$ AND $D_2 = 2(S_2)$

FILE NAME =	USER NAME = petelyj	DESIGNED - RON WOODSHANK	REVISED -
c:\pwwork\pwwork\petelyj\08300864\0366	23-shr-details.dgn	DRAWN - RON WOODSHANK	REVISED -
	PLOT SCALE = 100.0000' / in.	CHECKED -	REVISED -
	PLOT DATE = 4/5/2012	DATE -	REVISED -

STATE OF ILLINOIS
DEPARTMENT OF TRANSPORTATION

CLASS A PATCHING DETAIL

SCALE: SHEET NO. 1 OF 1 SHEETS STA. TO STA.

F.A.L. RTE. 57	SECTION *	COUNTY FORD	TOTAL SHEETS 10	SHEET NO. 9
*D3 PAVEMENT PATCHING 2013-3		CONTRACT NO. 66C23		
ILLINOIS				