

| | | |
|------|------------------------------|------|
| PLAN | SURVEYED | DATE |
| | PLOTTED | BY |
| | GRADES CHECKED | |
| | STRUCTURE NOT AT THIS OFFICE | |
| | NO. _____ | |
| | FILE NAME | |

| | | |
|---------|------------------------------|------|
| PROFILE | SURVEYED | DATE |
| | PLOTTED | BY |
| | GRADES CHECKED | |
| | STRUCTURE NOT AT THIS OFFICE | |
| | NO. _____ | |
| | FILE NAME | |

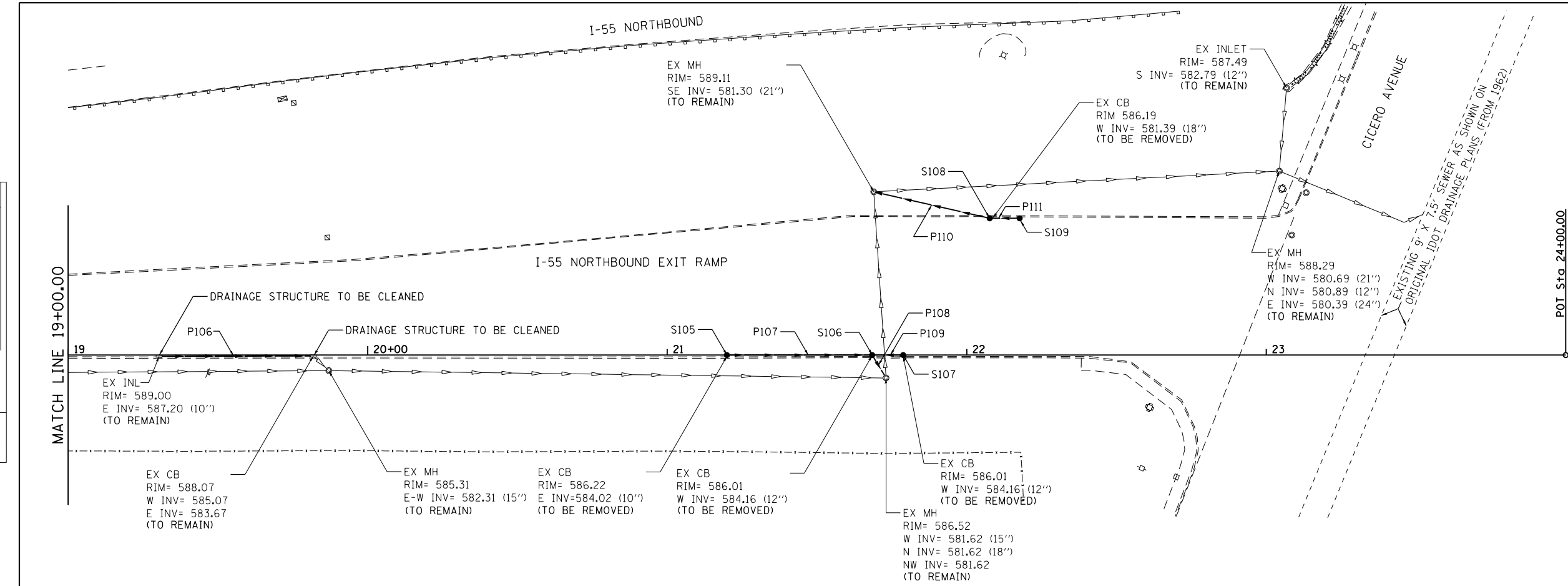

- NOTES:
- *1. CONTRACTOR TO VERIFY UPSTREAM AND DOWNSTREAM INVERTS OF STRUCTURES AND PIPES BEFORE CONSTRUCTION.
 2. THE ENVIRONMENTAL FIRM IS REQUIRED TO CONTINUOUSLY MONITOR FOR WORKER PROTECTION AND SOIL CONTAMINATION AT SEVERAL AREAS. SEE SPECIAL PROVISION AND SUPPLEMENTAL SPECIFICATIONS FOR DETAILS.
 3. CONNECT TO EXISTING STORM SEWER WITH CONCRETE COLLAR (INCIDENTAL TO STORM SEWER).

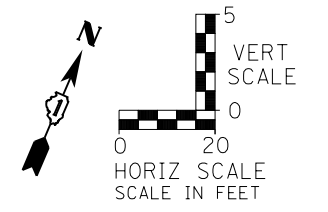

610

| STORM SEWER STRUCTURE | | | | | | |
|-----------------------|----|----------|-------|---------|-------------|------------------------------|
| ID | TY | STA. | OFF. | RIM EL. | CASTING TY. | TYPE OF WORK TO BE COMPLETED |
| S105 | CB | 21+19.93 | 1.08 | 586.22 | TY 24 | CB, TY C, 2' DIA. |
| S106 | CB | 21+68.44 | 0.92 | 586.01 | TY 24 | CB, TY A, 4' DIA. |
| S107 | CB | 21+78.79 | 0.96 | 586.01 | TY 24 | CB, TY C, 2' DIA. |
| S108 | CB | 22+07.66 | 46.48 | 586.19 | TY 24 | CB, TY A, 4' DIA. |
| S109 | CB | 22+17.66 | 46.48 | 586.30 | TY 24 | CB, TY C, 2' DIA. |

| STORM SEWER PIPE | | | | | | |
|------------------|-----------------|-----------|-------------|------------------|------------|-----------|
| ID | MATERIAL | SIZE (IN) | LENGTH (FT) | INVERT ELEVATION | | SLOPE (%) |
| | | | | UPSTREAM | DOWNSTREAM | |
| P106 | SS, CL A, TY II | 10 | 50 | 587.2 | 585.07 | 4.26 |
| P107 | SS, CL A, TY II | 10 | 49 | 584.02 | 582.00 | 4.12 |
| P108 | SS, CL A, TY II | 12 | 8 | 581.9 | 581.62 | 3.50 |
| P109 | SS, CL A, TY II | 10 | 11 | 583.88 | 583.35 | 4.82 |
| P110 | SS, CL A, TY II | 18 | 40 | 581.48 | 581.30 | 0.45 |
| P111 | SS, CL A, TY II | 12 | 10 | 582.07 | 582.02 | 0.45 |

| LEGEND | | |
|------------------------|----------|----------|
| BOUNDARY LINES/SYMBOLS | EXISTING | PROPOSED |
| DITCH & SWALE BOTTOM | --- | --- |
| ROADWAY DITCH FLOW | ~ | ~ |
| SUMMIT | | ~ |
| STORM SEWER | — — | — — |
| CATCH BASIN | ○ | ● |
| INLET | □ | ■ |
| MANHOLE | ○ | ⊙ |

610

600

590

580

570

600

590

580

570

FILE NAME = SA:\JUL163800-6399\6346\035\Micro\CA00D_Sheets\101608039-shr-drains.dgn

| | | | | | | | | | | | | | | | |
|--------|--------|--------|--------|--------|--------|--------|--------|---|--|--|---|----------|--------|--------------|-----------|
| 19+00 | 19+50 | 20+00 | 20+50 | 21+00 | 21+50 | 22+00 | 22+50 | STATE OF ILLINOIS DEPARTMENT OF TRANSPORTATION | I-55 NORTHBOUND EXIT RAMP DRAINAGE & GRADING PLAN & PROFILE | SCALE: 1" = 20' SHEET 3 OF 3 SHEETS STA. 19+00.00 TO STA. 24+00.00 | F.A.I. RTE. | SECTION | COUNTY | TOTAL SHEETS | SHEET NO. |
| 589.31 | 588.68 | 587.84 | 587.19 | 586.46 | 586.06 | 586.30 | 586.85 | | | | 55 | 112-636T | COOK | 36 | 21 |
| | | | | | | | | | | | CONTRACT NO. 60T37 | | | | |
| | | | | | | | | | | | FED. ROAD DIST. NO. 1 ILLINOIS FED. AID PROJECT | | | | |

STRAND ASSOCIATES
 1170 SOUTH HOUBOLT ROAD
 JOLIET, ILLINOIS 60431
 (815) 744-4200

| | | |
|-----------------------------|----------------|-----------|
| USER NAME = dennisw | DESIGNED - TJS | REVISED - |
| PLOT SCALE = 40.0000' / in. | DRAWN - DJW | REVISED - |
| PLOT DATE = 4/2/2012 | CHECKED - MAG | REVISED - |
| | DATE - 4-2-12 | REVISED - |