

LEGEND

	TEMPORARY PAVEMENT		DRUM WITH STEADY BURN BI-DIRECTIONAL LIGHT
	CONSTRUCTION WORK ZONE		TYPE I OR II BARRICADE WITH FLASHING LIGHTS
	DIRECTION OF TRAFFIC FLOW		DOUBLE VERTICAL PANEL WITH STEADY BURN BI-DIRECTIONAL LIGHT
	ARROW BOARD		TYPE III BARRICADE WITH FLASHING LIGHTS
			FLASHING MONO-DIRECTIONAL LIGHT

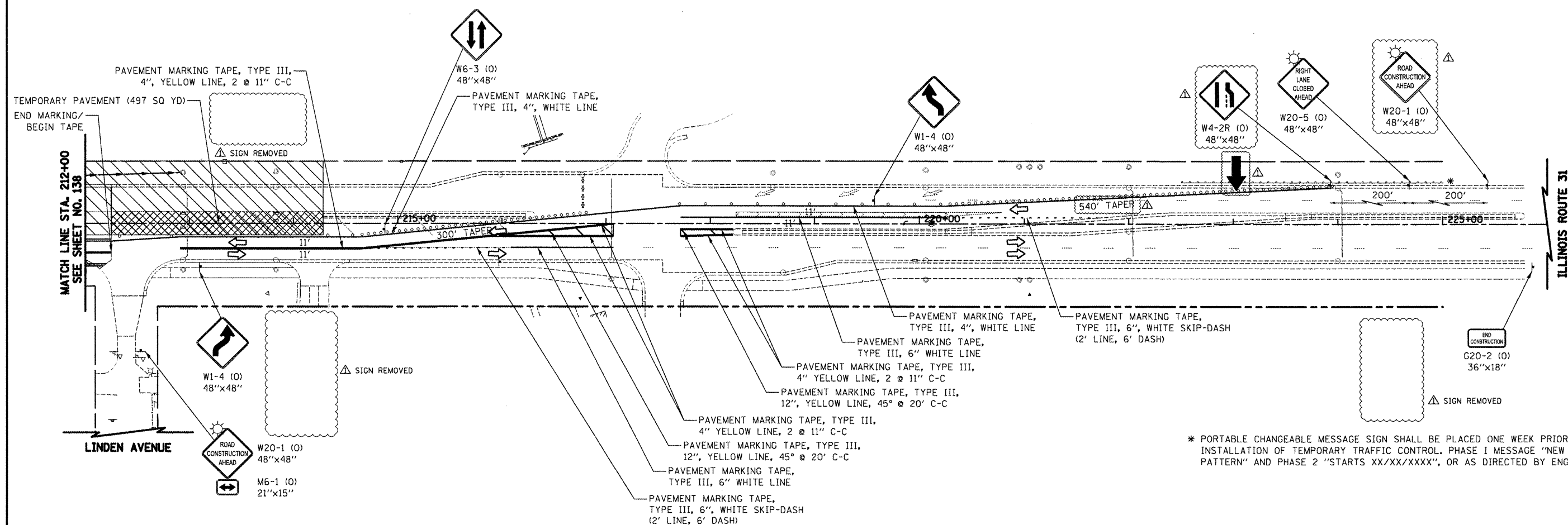

* PORTABLE CHANGEABLE MESSAGE SIGN SHALL BE PLACED ONE WEEK PRIOR TO INSTALLATION OF TEMPORARY TRAFFIC CONTROL. PHASE 1 MESSAGE "NEW TRAFFIC PATTERN" AND PHASE 2 "STARTS XX/XX/XXXX", OR AS DIRECTED BY ENGINEER.

ILLINOIS ROUTE 31



ADDENDUM A REV. 5/21/2012 JES

FILE NAME =
...\\08-MOT\0160F72-sh-t-MOT-37.dgn

USER NAME = oth
PLOT SCALE = 100.0000' / in.
PLOT DATE = 5/24/2012

DESIGNED - KWH
DRAWN - AKW
CHECKED - GAB
DATE - 5/3/2012

REVISED - 5/21/2012
REVISED -
REVISED -
REVISED -

STATE OF ILLINOIS
DEPARTMENT OF TRANSPORTATION

MAINTENANCE OF TRAFFIC - STAGE 4A

SCALE: 1" = 50' SHEET NO. 37 OF 47 SHEETS STA. 212+00 TO STA. 226+00

O.R. RTE.	SECTION	COUNTY	TOTAL SHEETS	SHEET NO.
0003	18A-2	MCHENRY	825	139
CONTRACT NO. 60F72				
FED. ROAD DIST. NO. 1 ILLINOIS FED. AID PROJECT				