

LEGEND

	TEMPORARY PAVEMENT		DRUM WITH STEADY BURN BI-DIRECTIONAL LIGHT
	CONSTRUCTION WORK ZONE		TYPE I OR II BARRICADE WITH FLASHING LIGHTS
	DIRECTION OF TRAFFIC FLOW		DOUBLE VERTICAL PANEL WITH STEADY BURN BI-DIRECTIONAL LIGHT
	ARROW BOARD		TYPE III BARRICADE WITH FLASHING LIGHTS
			FLASHING MONO-DIRECTIONAL LIGHT

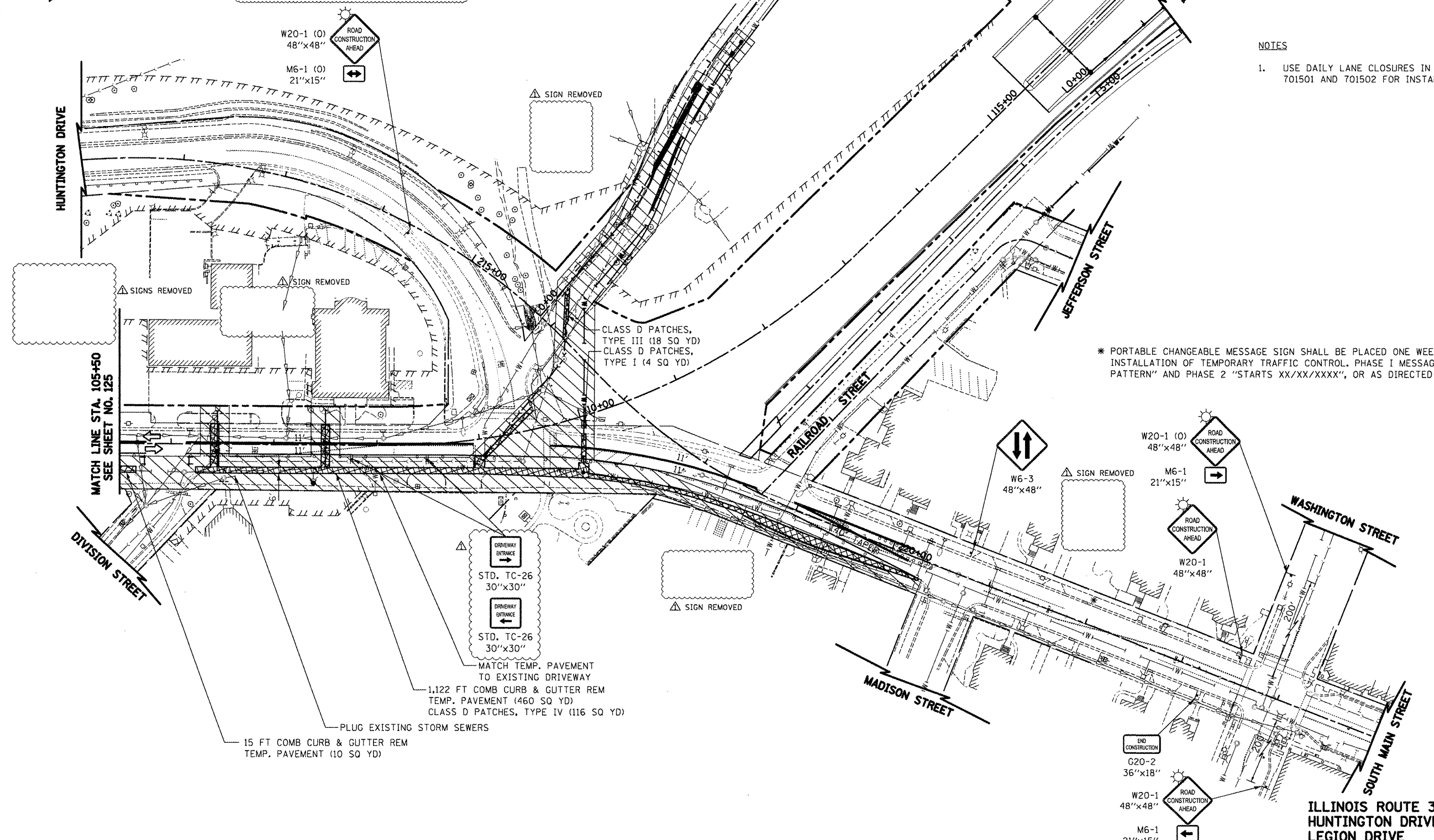

NOTES

- USE DAILY LANE CLOSURES IN ACCORDANCE WITH IDOT STANDARD 701501 AND 701502 FOR INSTALLATION OF UNDERGROUND UTILITIES.

* PORTABLE CHANGEABLE MESSAGE SIGN SHALL BE PLACED ONE WEEK PRIOR TO INSTALLATION OF TEMPORARY TRAFFIC CONTROL. PHASE I MESSAGE "NEW TRAFFIC PATTERN" AND PHASE 2 "STARTS XX/XX/XXXX", OR AS DIRECTED BY ENGINEER.



FILE NAME = ...\\08-MOT\DI60F72-shr-MOT-24.dgn	USER NAME = ctb	DESIGNED - KWH	REVISED - 5/21/2012	STATE OF ILLINOIS DEPARTMENT OF TRANSPORTATION	MAINTENANCE OF TRAFFIC - STAGE 3A	SCALE: 1" = 50'	SHEET NO. 24 OF 47 SHEETS	STA. 105+50 TO STA. -----	O.R. RTE.	SECTION	COUNTY	TOTAL SHEETS	SHEET NO.
		DRAWN - AKW	REVISED -						0003	18A-2	MCHENRY	825	126
		CHECKED - GAB	REVISED -						CONTRACT NO. 60F72				
		DATE - 5/3/2012	REVISED -						FED. ROAD DIST. NO. 1 ILLINOIS FED. AID PROJECT				