

# LEGEND

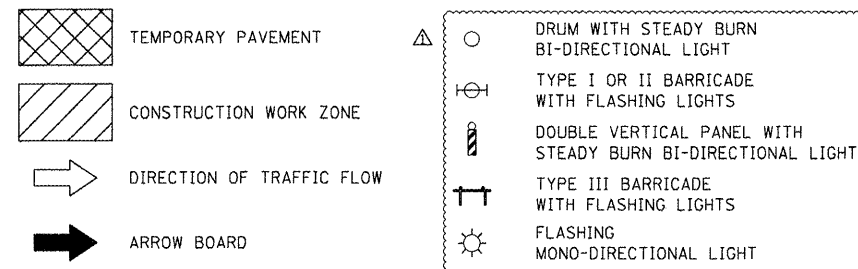

## NOTES

- USE DAILY LANE CLOSURES IN ACCORDANCE WITH IDOT STANDARD 701501 AND 701502 FOR INSTALLATION OF UNDERGROUND UTILITY CROSSINGS.

## TEMPORARY DRAINAGE NOTES

① PLUG WATER MAIN 6"

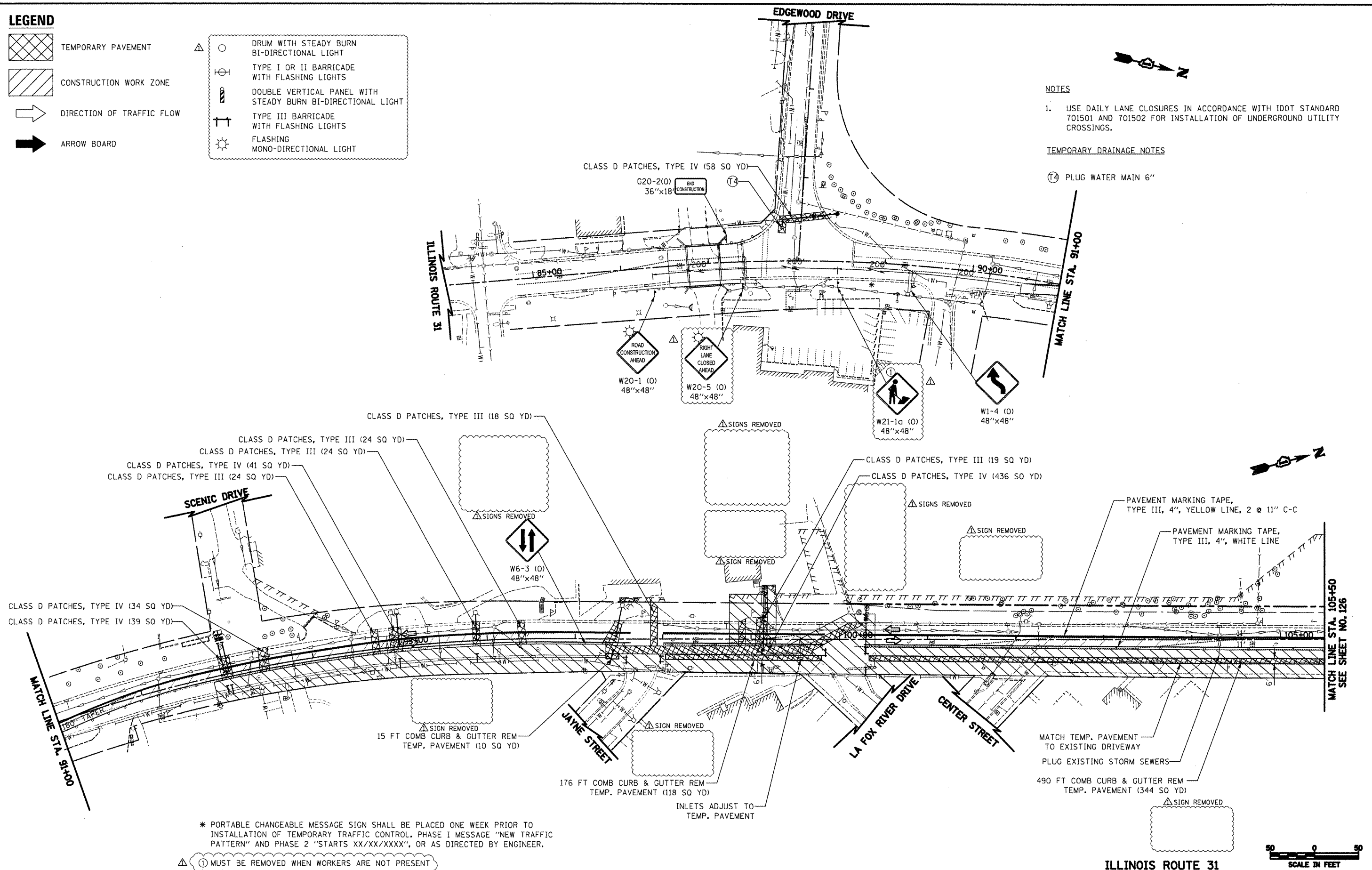

ILLINOIS ROUTE 31

SCALE IN FEET

ADDENDUM REV. 5/21/2012 JES

FILE NAME =	USER NAME =	DESIGNED -	REVISED -
...\\08-MOT\160F72-sh-t-MOT-23.dgn	otb	KWH	5/21/2012
		DRAWN -	REVISED -
		AKW	
		CHECKED -	REVISED -
		GAB	
		DATE -	REVISED -
		5/3/2012	

STATE OF ILLINOIS  
DEPARTMENT OF TRANSPORTATION

MAINTENANCE OF TRAFFIC - STAGE 3A

SCALE: 1" = 50' SHEET NO. 23 OF 47 SHEETS STA. 91+00 TO STA. 105+50

O.R. RTE.	SECTION	COUNTY	TOTAL SHEETS	SHEET NO.
0003	18A-2	MCHENRY	825	125
CONTRACT NO. 60F72				
FED. ROAD DIST. NO. 1 ILLINOIS FED. AID PROJECT				