

LEGEND

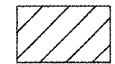

TEMPORARY PAVEMENT



CONSTRUCTION WORK ZONE

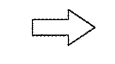

DIRECTION OF TRAFFIC FLOW



ARROW BOARD

- △ ○ DRUM WITH STEADY BURN BI-DIRECTIONAL LIGHT
- ⊥ TYPE I OR II BARRICADE WITH FLASHING LIGHTS
- ⊥ DOUBLE VERTICAL PANEL WITH STEADY BURN BI-DIRECTIONAL LIGHT
- ⊥ TYPE III BARRICADE WITH FLASHING LIGHTS
- ⊙ FLASHING MONO-DIRECTIONAL LIGHT

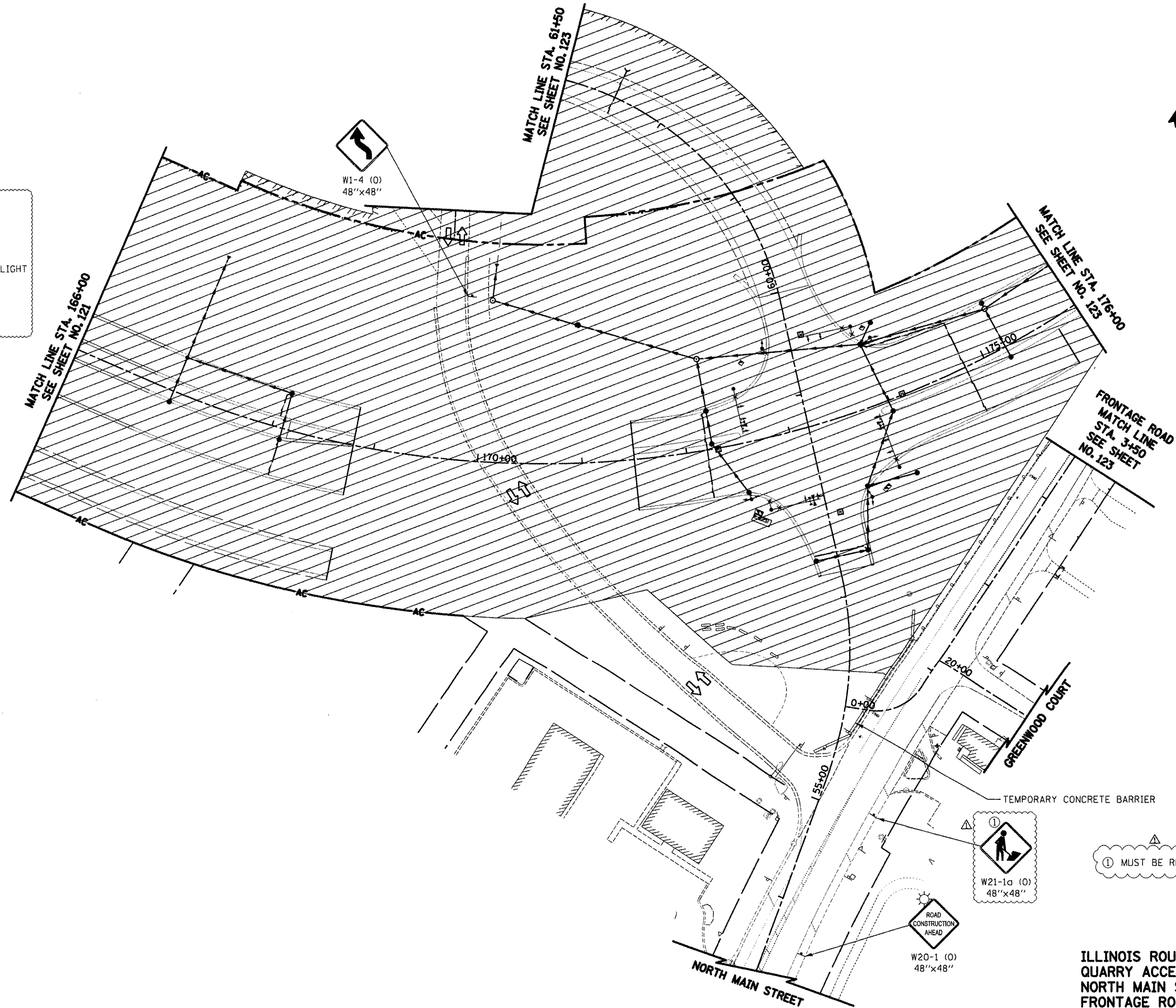

① MUST BE REMOVED WHEN WORKERS ARE NOT PRESENT

ILLINOIS ROUTE 31
QUARRY ACCESS
NORTH MAIN STREET
FRONTAGE ROAD
GREENWOOD COURT

SCALE IN FEET
50 0 50

ADDENDUM △ REV. 5/21/2012 JES

FILE NAME =	USER NAME = ctb	DESIGNED - KWH	REVISED - 5/21/2012 △
...\\08-MOT\DI60F72-sht-MOT-20.dgn		DRAWN - AKW	REVISED -
	PLOT SCALE = 100.0000' / in.	CHECKED - GAB	REVISED -
	PLOT DATE = 5/24/2012	DATE - 5/3/2012	REVISED -

STATE OF ILLINOIS
DEPARTMENT OF TRANSPORTATION

MAINTENANCE OF TRAFFIC - STAGE 2A

SCALE: 1" = 50' SHEET NO. 20 OF 47 SHEETS STA. 166+00 TO STA. 175+50

O.R. RTE.	SECTION	COUNTY	TOTAL SHEETS	SHEET NO.
0003	18A-2	MCHENRY	825	122
CONTRACT NO. 60F72				
FED. ROAD DIST. NO. 1 ILLINOIS FED. AID PROJECT				