

901 SEEDING NOTES

THE PROPOSED SEEDING SHALL BE ACCOMPLISHED IN ACCORDANCE WITH ITEM 901 "SEEDING" AS STATED ON PAGE 120 OF THE SUPPLEMENTAL SPECIFICATIONS AND RECURRING SPECIAL PROVISIONS, ADOPTED JULY 1, 2004.

ALL DISTURBED AREAS LOCATED WITHIN THE PROPOSED GRADING AND SEEDING LIMITS WILL BE SEEDED IN ACCORDANCE WITH THE ABOVE NOTED SPECIFICATION. ALL AREAS OUTSIDE THE DESIGNATED GRADING AND SEEDING LIMITS WILL ALSO BE SEEDED BUT AT THE CONTRACTOR'S OWN EXPENSE.

ALL MATERIALS AND/OR DEBRIS RESULTING FROM THE SEEDING OPERATIONS WILL BE REMOVED FROM THE PAVEMENTS AND MISCELLANEOUS STRUCTURES PRIOR TO OPENING THE RUNWAY AND TAXIWAY.

901-3.4 MAINTENANCE OF SEEDED AREAS. DELETE THE SECOND PARAGRAPH OF THIS SECTION AND ADD THE FOLLOWING:

"THE CONTRACTOR WILL BE REQUIRED TO ESTABLISH A GOOD STAND OF GRASS OF UNIFORM COLOR AND DENSITY TO THE SATISFACTION OF THE RESIDENT ENGINEER. IF AT THE TIME WHEN THE CONTRACT HAS BEEN OTHERWISE COMPLETED, IT IS NOT POSSIBLE TO MAKE AN ADEQUATE DETERMINATION OF COLOR, DENSITY, AND UNIFORMITY OF SUCH STAND OF GRASS, THE ITEM OF WORK WILL BE REVIEWED AT A LATER DATE DETERMINED BY THE ILLINOIS DIVISION OF AERONAUTICS."

DATE SEEDING COMPLETED _____

THE PROPOSED SEEDING WILL BE PAID FOR UNDER ITEMS: AR901510 SEEDING _____ 11 ACRES

908 MULCHING NOTES

THE PROPOSED MULCHING SHALL BE ACCOMPLISHED IN ACCORDANCE WITH ITEM 908 "MULCHING" AS STATED ON PAGE 127 OF THE SUPPLEMENTAL SPECIFICATIONS AND RECURRING SPECIAL PROVISIONS, ADOPTED JULY 1, 2004.

THIS ITEM SHALL CONSIST OF THE FURNISHING, TRANSPORTING, AND PLACING MULCH OVER THE SEEDED AREA. DISTURBED AREAS OUTSIDE THE GRADING LIMITS SHALL ALSO BE MULCHED AND PARTICIPATION WILL BE THE SAME AS FOR SEEDED AREAS.

908-2.1 MULCH MATERIAL: THE CONTRACTOR MAY EITHER FURNISH STRAW OR HYDROMULCH AS THE TYPE OF MULCH MATERIAL TO BE USED ON THIS PROJECT.

908-3.1 MULCHING: THE HYDRAULIC MULCH SHALL BE APPLIED AS A SLURRY OF 2,500 POUNDS OF MULCH AND NOT LESS THAN 2,500 GALLONS OF WATER PER ACRE.

908-3.4 STRUCTURE CLEANING: AFTER THE PROPOSED MULCH HAS BEEN APPLIED, THE CONTRACTOR WILL CLEAN THE MULCH OFF ALL STRUCTURES (DRAINAGE, ELECTRICAL, LIGHTS, ETC.).

DATE MULCHING COMPLETED _____

THE PROPOSED MULCHING WILL BE PAID FOR UNDER ITEMS: AR908510 MULCHING _____ 11 ACRES

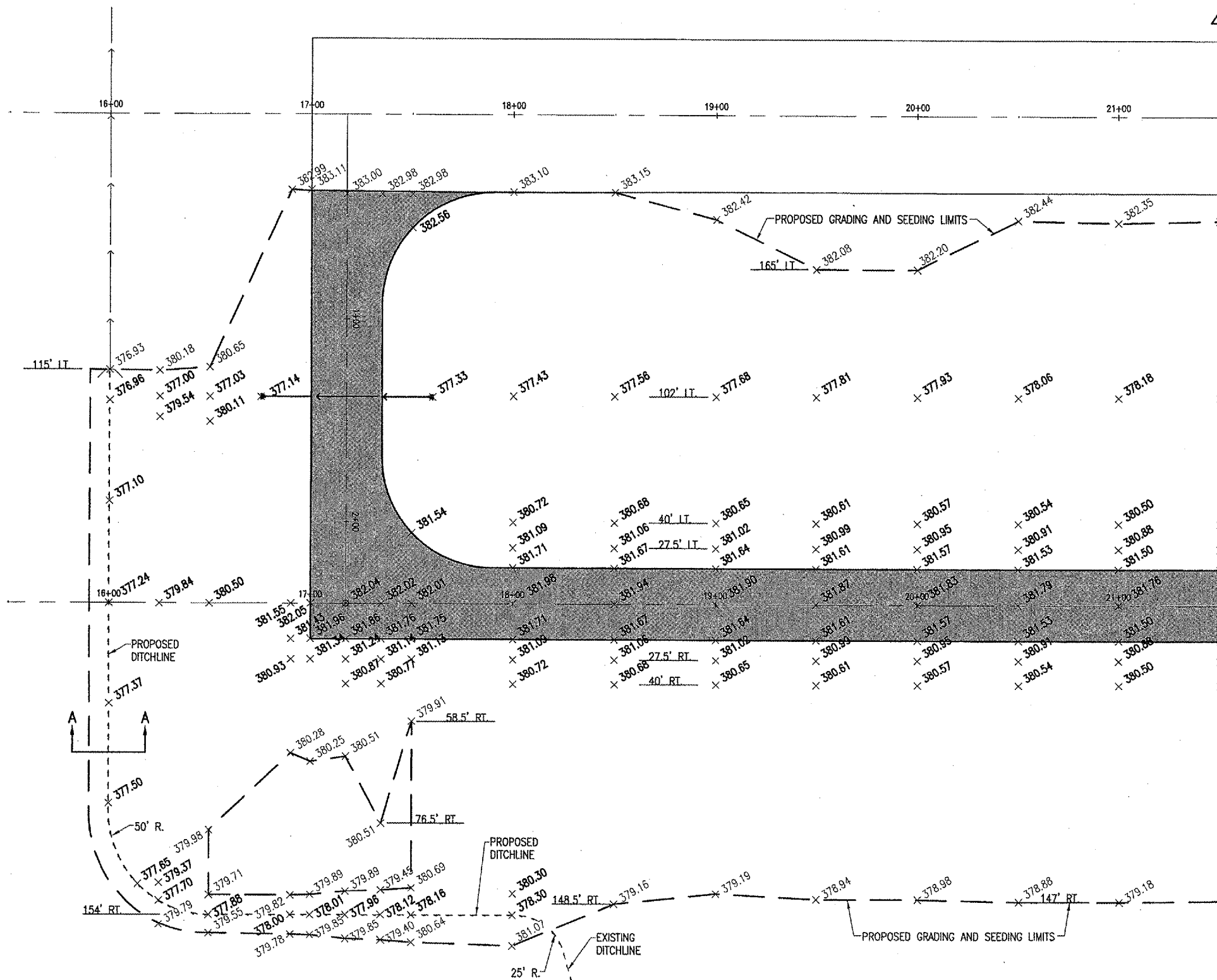
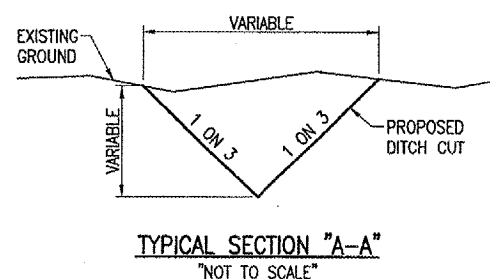

- LEGEND
EXISTING PAVEMENT
PROPOSED PAVEMENT
PROPOSED GRADING AND SEEDING LIMITS
PROPOSED 18" RCP
EXISTING GRADE
PROPOSED GRADE
PROPOSED FLARED END SECTION

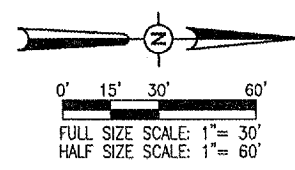
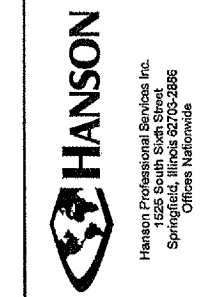

Table with columns for REVISION, DATE, and BY.

CARMi MUNICIPAL AIRPORT
CARMi, ILLINOIS
MATCHLINE STA. 21+50

Table with columns for LAYOUT, DRAWN, REVIEWED, and dates.



EXTEND PARTIAL PARALLEL TAXIWAY
PROPOSED STAKING PLAN
STA. 15+90 TO STA. 21+50

APR 27, 2007 7:39 AM BAK
I:\AIRPORTS\CARMi\801-07TXX\AIRPORT\SHEETS\R-191STK.DWG -- STA. 16+50 TO STA. 21+50