

STATE OF ILLINOIS

DEPARTMENT OF TRANSPORTATION

DIVISION OF HIGHWAYS

PLANS FOR PROPOSED HIGHWAY BRIDGE PROGRAM

ROUTE NO.	SECTION	COUNTY	TOTAL SHEETS	SHEET NO.
T.R. 79A	04-01177-00-BR	UNION	15	1
FED. ROAD DIST. NO.		ILLINOIS	CONTRACT NO. 99275	

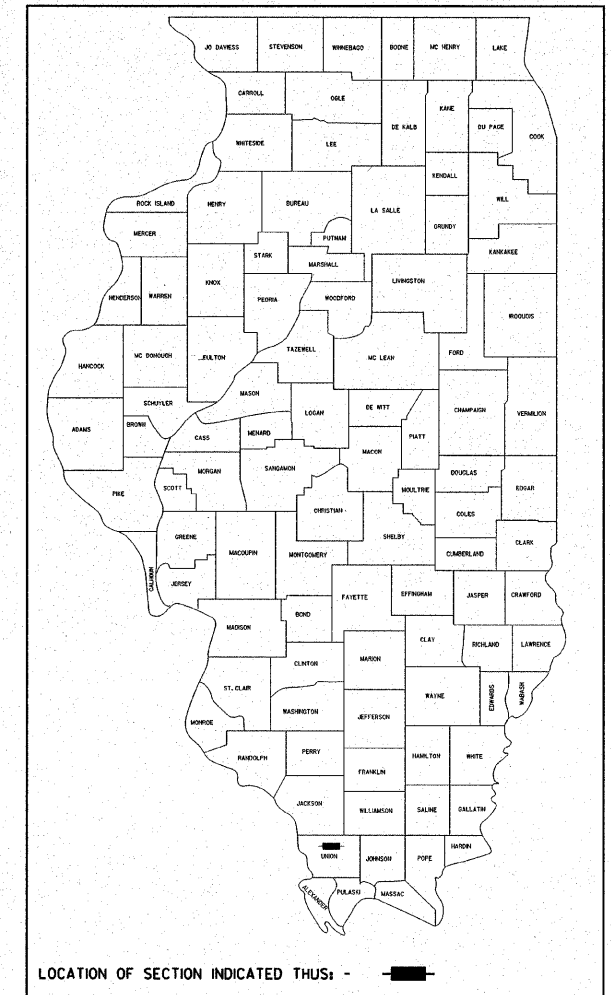

SCALES	}	PLAN	0' = 50'
		PROFILE HORIZ.	0' = 50'
		PROFILE VERT.	0' = 5'
		CROSS SECTIONS	0' = 5'

PROJECT BROS-181(040)

SECTION 04-01177-00-BR

UNION COUNTY

T.R. 79A / MOUNTAIN GLEN ROAD

C-99-544-04

INDEX OF SHEETS

1. COVER SHEET
2. SUMMARY OF QUANTITIES AND GENERAL NOTES
3. TYPICAL SECTIONS
4. PLAN AND PROFILE
- 5.-8. STATION CROSS SECTIONS
- 9.-14. BRIDGE PLANS
15. BORINGS

HIGHWAY STANDARDS:

- 515001-02 NAME PLATE FOR BRIDGES
- 630301-04 SHOULDER WIDENING FOR TYPE 1 (SPECIAL) GUARDRAIL TERMINALS
- 631026-03 REFLECTOR AND TERMINAL MARKER PLACEMENT
- 702001-06 TRAFFIC CONTROL DEVICES
- BLR 21-6 TYPICAL APPLICATION OF TRAFFIC CONTROL DEVICES FOR CONSTRUCTION ON RURAL LOCAL HIGHWAYS

UTILITIES

SOUTHERN ILLINOIS ELECTRIC CO-OP
7420 U.S. HIGHWAY 51 SOUTH
DONGOLA, ILLINOIS 62926

VERIZON
608 WEST UNION
MARION, ILLINOIS 62959

DESIGN FUNCTIONAL CLASSIFICATION:
LOCAL COLLECTOR <400 ADT
DESIGN TRAFFIC: 325 ADT (2005)
DESIGN SPEED: 30 M.P.H.

CONTRACT NO. 99275

STA. 10+05 - SPECIAL BRIDGE DESIGN
PRECAST PRESTRESSED CONCRETE DECK BEAM
BRIDGE. SINGLE SPAN @ 51'-0", 27'-0" RDWY.
SKEW = 30°
PROPOSED STRUCTURE NO. 091-3222

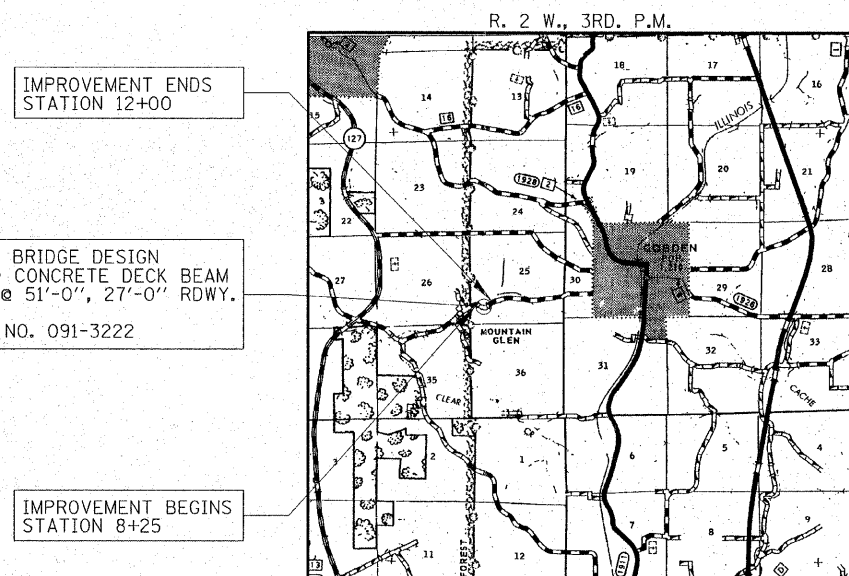

LAYOUT

APPROXIMATE SCALE: 0 = 1 MILE

NET LENGTH OF SECTION = 375 FEET = 0.071 MILES



AGENCY RESPONSIBLE FOR LETTING	
APPROVED	<i>April 10 2007</i> COUNTY ENGINEER
PASSED	<i>April 11 2007</i> DISTRICT NINE ENGINEER OF LOCAL ROADS & STREETS
Releasing For Bid Based on Limited Review	<i>April 11 2007</i> DEPUTY DIRECTOR OF HIGHWAYS REGION FIVE ENGINEER
STATE OF ILLINOIS DEPARTMENT OF TRANSPORTATION	

DATE: *April 3, 2007*

BY: *Steven W. MeGINSON*

LICENSE EXPIRES: NOVEMBER 30, 2007

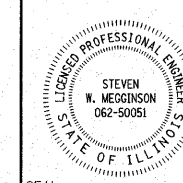

HAMPTON, LENZINI & RENWICK, INC.
CIVIL & STRUCTURAL ENGINEERS

HLR

3085 STEVENSON DRIVE, SUITE 201
SPRINGFIELD, ILLINOIS 62703
(217) 546-3400

ELGIN • SPRINGFIELD

PROJECT NUMBER: 12-92-0007-1 DATE: 04/03/07