

F.A.I. RTE.	SECTION	COUNTY	TOTAL SHEETS	SHEET NO.
57	0X1-6-2HBR	WILLIAMSON	272	73
STA.	TO STA.			
FED. ROAD DIST. NO. 9	ILLINOIS	FED. AID PROJECT		

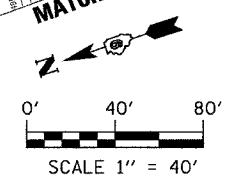
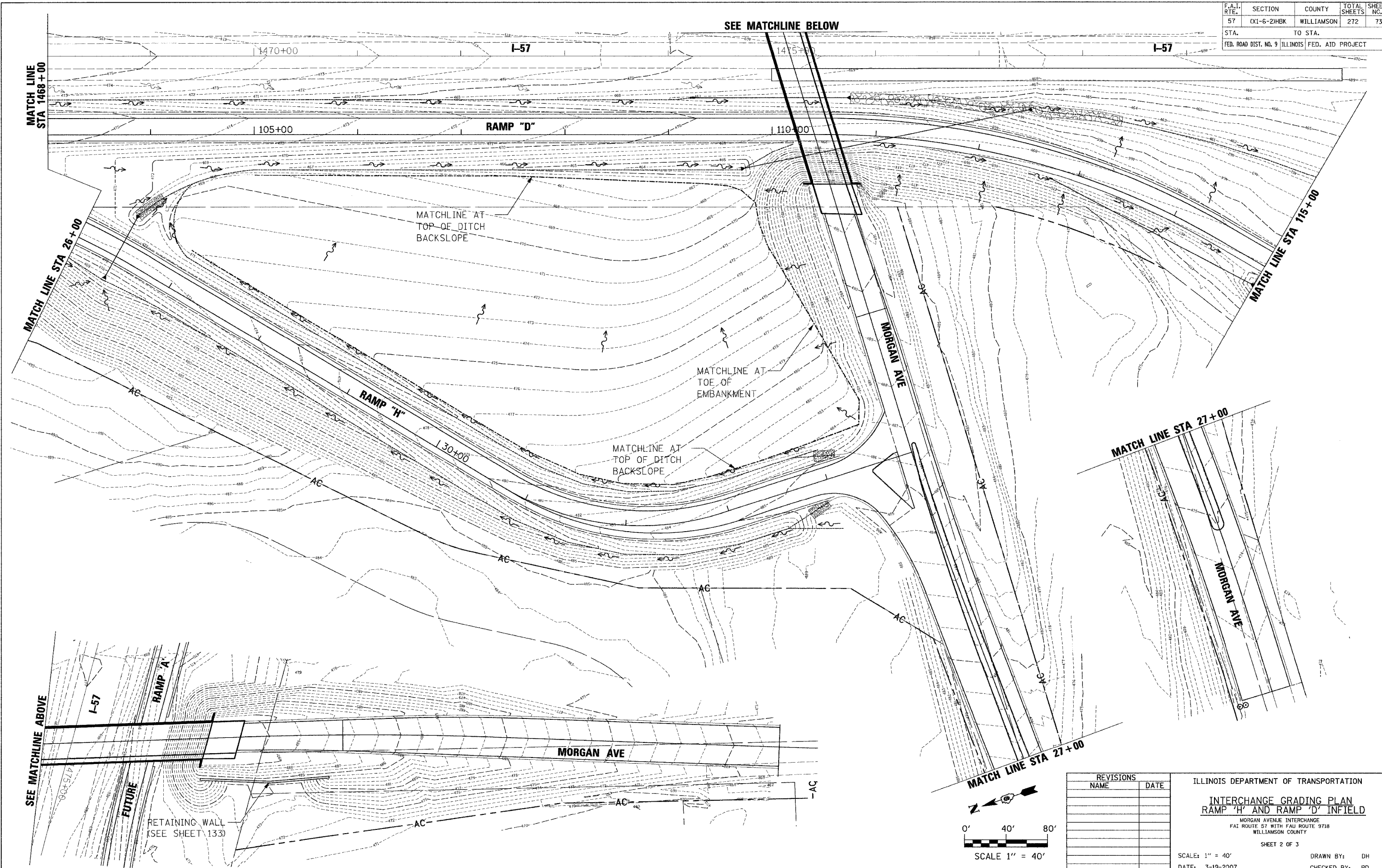

REVISIONS	
NAME	DATE

ILLINOIS DEPARTMENT OF TRANSPORTATION  
**INTERCHANGE GRADING PLAN**  
**RAMP 'H' AND RAMP 'D' INFIELD**  
 MORGAN AVENUE INTERCHANGE  
 FAI ROUTE 57 WITH FAI ROUTE 9718  
 WILLIAMSON COUNTY  
 SHEET 2 OF 3  
 SCALE: 1" = 40'  
 DATE: 3-19-2007  
 DRAWN BY: DH  
 CHECKED BY: RD

PLOT DATE = 3/20/2007  
 FILE NAME = P:\040620\040620.dgn  
 PLOT SCALE = 48.0000 / 1"  
 USER NAME = dhorrer