

PLOT DATE: 3/07

SECTION NO.	COUNTY HIGHWAY	COUNTY	SHEET OF SHEETS
02-00161-02-BR	C.H.34	ST. CLAIR	17 of 22
FHWA REG. NO. 7	ILLINOIS	PROJ: BRM-5011(188)	
STA 199+20 TO 201+50		CONTRACT 97280	

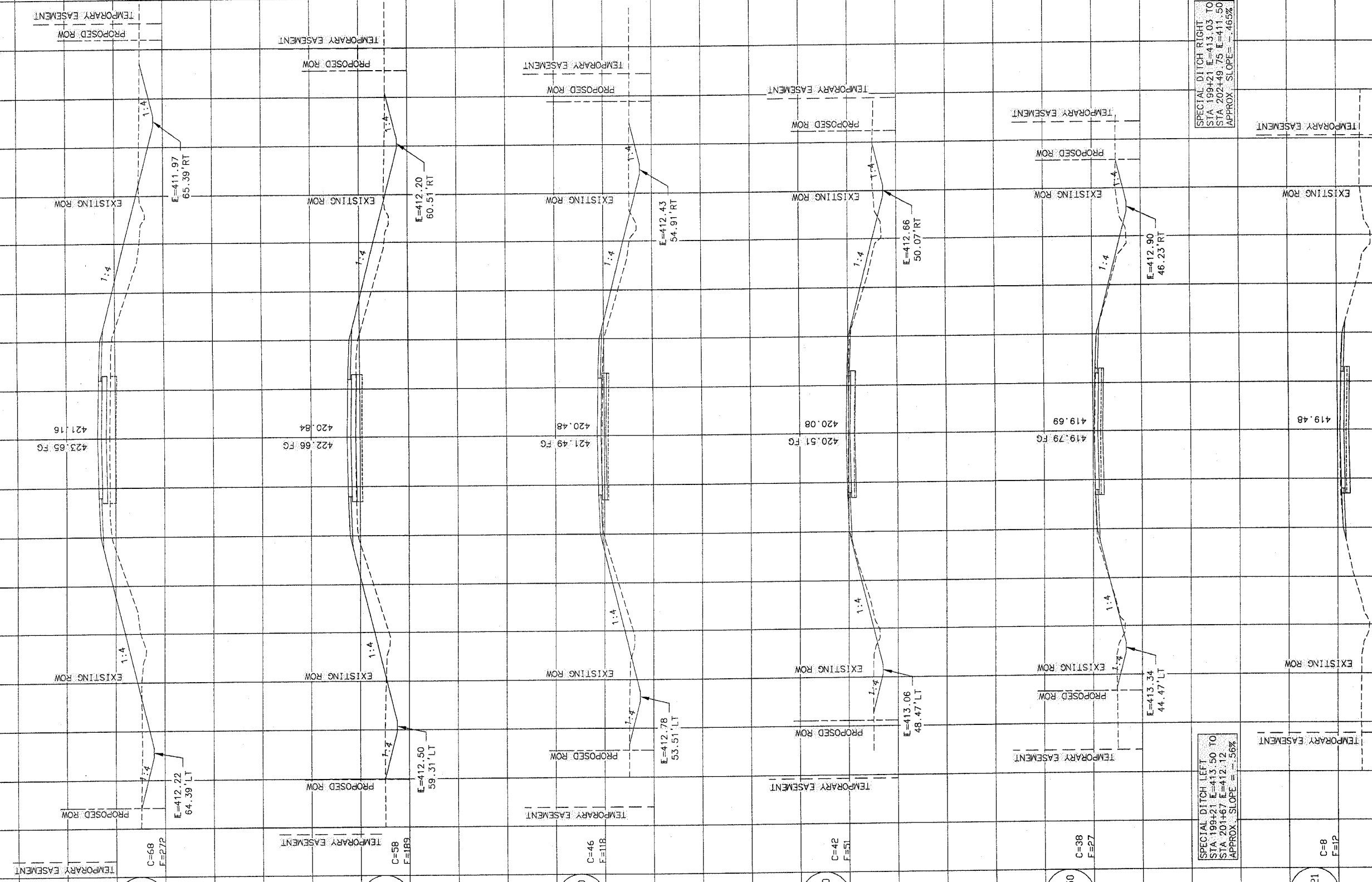

SPECIAL DITCH RIGHT
 STA 199+21 E=413.03 TO
 STA 202+49.75 E=411.50
 APPROX. SLOPE = -.465%

SPECIAL DITCH LEFT
 STA 199+21 E=413.50 TO
 STA 201+67 E=412.12
 APPROX. SLOPE = -.56%

SCALE: VERTICAL 1"=10'
 HORIZONTAL 1"=10'